

Event Permit

Event Name:

Fort Myers Marathon

Applicant:

Eident Racing

Contact:

Larry Baldwin 941.416.1838

Location:

Downtown Ft. Myers - N. Ft. Myers; Crossing the Caloosahatchee & Edison Bridges with lane closures. Specific street listings and site plans attached.

Valid only for the Following date(s):

November 9, 2014

Valid only for the Following Time(s):

6:30 am to 1:00 pm



Permit Number

14-110914CP

Permit Type

- Special Event
- Use of County Property
- Sell & consume Alcohol
- Consume Alcohol only
- Film Permit

Permit Conditions:

- Applicant must meet all event application requirements, including requirements of the sign-off agencies.
- The premises is to be left in the same condition as it was prior to the event.
- This permit is to be readily available for inspection during the entire event.
- County-issued alcohol permits: Alcoholic beverages must not be sold/consumed 1½ hours prior to the conclusion of the event & vacating the facility.

Board of County Commissioners
Lee County, Florida

A handwritten signature in blue ink, appearing to read "A. ...".

County Manager

11-5-14

Date

APPLICATION FOR A SPECIAL EVENT PERMIT

Name of Applicant: EIDENT RACING

Address of Applicant: 9128 STRADA PL. # 10115
NAPLES, FL 34108

Phone Number of Applicant: 239-314-7672

Name of Contact Person: LARRY BALDWIN

Phone Number of Contact Person: 941-416-1838

Date/Dates of Event: Sunday Nov. 9, 2014

Hours of Operation: 6:30 AM - 1:00 PM

Estimated/Anticipated Number of Person Per Day: 1,500 - 2,500

Type of Event Planned:

- (Detailed Description, Including Each Activity, When Each Activity Takes Place, etc.):

FT. MYERS MARATHON, HALF MARATHON AND 5K
RACES. EVENT WILL START-FINISH AT PINCHERS MARINA
ON W. 1ST Street. RACES BEGIN at 7:05 AM AND 7:15 AM.
(SEE ROUTE FOR DETAILS)

Location of Event:

FT. MYERS DOWNTOWN, FT. MYERS HIGH NEIGHBORHOOD, N. FT. MYERS

Strap Number of the Parcel: COUNTY AND CITY STREETS

Owner of the Premises where the Event is to be Held:

- (Please Submit a Written Notarized Statement from Owner Indicating Consent to Have the Event on the Premises)

What is the Zoning Classification of the Premises? Lee County / City of Ft. Myers

Please Submit a Sketch Plan of the Site with All Proposed Facilities and Activities Identified, Including All Parking Areas.

Type of Structure(s) at Site of Event: CITY AND COUNTY STREETS

Are Any Temporary Structures to be Installed for Event? Yes No

Do You Have Appropriate Permits for Temporary Structure/Structures? Yes No

YOU MUST MEET WITH THE LEE COUNTY RISK MANAGER TO ESTABLISH THE AMOUNTS OF INSURANCE REQUIRED FOR YOUR EVENT. A CERTIFICATE OF INSURANCE IN THESE AMOUNTS, NAMING LEE COUNTY AS ADDITIONAL INSURED, SHALL BE ATTACHED TO YOUR APPLICATION.

Insurance Company Insuring the Event:

Policy Amounts of Liability Insurance: _____

Policy Amounts of Property Insurance: _____

Bonding Company Bonding this Event (Name and Address):

Will Vehicles be Used as Part of This Event? Yes No

- ◆ (If Yes, Automobile Coverage Shall be Included on the Certificate of Insurance)

Is Food Going to be Available at this Event? Yes No

- ◆ (If Yes, Products Liability Coverage Shall be Included on the Certificate of Insurance)

Name and Address of Organization Providing Food:

By PINEHEDS RESTAURANT ON PREMISE

Type of Food to be Served:

PINCHERS RESTAURANT will provide food and
BEVERAGE ON THEIR PREMISES for this
EVENT

Alcoholic Beverages at Event: Yes No

NOTE: ANY SIGNS AND MARKINGS IN CONNECTION WITH THIS EVENT SHALL BE TEMPORARY AND REMOVABLE. PAINTINGS ON ROADWAYS, TREES OR ANY OTHER FIXED OBJECT IS STRICTLY PROHIBITED.

The applicant does acknowledge and hereby affirms that any and all information is accurate to the best of his knowledge. The applicant/permittee agrees to assume full responsibility and liability for and indemnify and save the County harmless from and against all liability, claims for damages, and suits for or by reason of any injury to any person or damages to any property of the parties hereto or of the third persons for any and all cause or causes whatsoever or in any way connected with the holding of said event or any act or omission or thing in any manner related to said event and its operation irrespective of negligence, actual or claimed, upon the part of the County, their agents or employees.

Ann Blalock
WITNESS

Mary Saldaña
APPLICANT'S SIGNATURE

JUNE 27, 2014
DATE



Fort Myers Marathon Overview

Race Date: Sunday, November 9, 2014

- Race will begin and finish on West 1st Street in Downtown Fort Myers in front of the Pinchers Marina Restaurant. Marathon and Half Marathon will go off at approximately 7:05am and 5k Race at 7:15am. Marathon and Half will proceed over Caloosahatchee Bridge, run through North Fort Myers and back across Edison Bridge.

* ~~Marathon Loops around 2nd Street to Seaboard to 1st Street and back north over Edison Bridge up to Mariana Avenue and back across Edison Bridge.~~

- Both races will go north on Edwards Drive to West 1st to Johnson Street. There, runners cross over McGregor down 41 South to Edison. There runners go south to Maravella and loop back to Cortez to Clifford across McGregor and back to Pinchers Finish line.

- 5k will proceed East on West 1st to Edwards to Edison Bridge and proceed up bridge approximately 500 yards and will turn around and head back same route to finish line.

- Volunteers at water station approximately every 2 miles

- Course to remain open for six hours to 1pm for timing, hydration and medical transportation for all runners. At this point all runners will have entered the McGregor neighborhood area and can easily walk/jog the remainder of the course. *RUNNERS IN ALONG W. FIRST STREET.*

- Bob's Barricades will cone two lanes on Edison Bridge and one lane on Cleveland Ave Bridge

- o Right lane will be coned on Cleveland to Judd; and Marianna to Edison Bridge on both sides of US-41 Business
- o Lane coned on 2nd street-Scaboard-1st Street Loop
- o Pondella right lane between Bus-41 and Plincy Ave

* Race now has two loops on Cleveland Ave to Pondella to Eusegrena. KACR will also run on east side of Bus-41-TIAMIANI TRAIL ON BROOKS RD. LAURA LANE, EVALENA AND MARIANNA AVE. see sketch to monitor ALL INTERSECTIONS in N. FT. MYERS.

FIRE DEPARTMENT
(The Fire Department Serving The Area Where The Event Is To Be Held)

AFTER REVIEWING THE APPLICATION, PLEASE INDICATE BELOW WHAT ARRANGEMENTS YOUR ORGANIZATION WILL REQUIRE THE APPLICANT TO COMPLY WITH FOR THEIR EVENT.

Fire Guards (How Many?): 0

Fee: 0

Flammable Vegetation: N/A

First Aid Equipment: 0

Fire Extinguishing: 0

Special Arrangements: N/A

John Meredith
PRINT NAME of PERSON SIGNING

John C Meredith
SIGNATURE

Assistant Chief of D. Fi. Myers Fire Dept.
TITLE

9-7-14
DATE

**PUBLIC SAFETY
14752 SIX MILE CYPRESS PARKWAY
FORT MYERS, FL 33912
(239) 533-3911**

AFTER REVIEWING THE APPLICATION, PLEASE INDICATE BELOW WHAT ARRANGEMENTS YOUR ORGANIZATION WILL REQUIRE THE APPLICANT TO COMPLY WITH FOR THEIR EVENT.

Safety Requirements: MB

Comments: MB

Handwritten: Scott Titte

SCOTT TITTE

PRINT NAME of PERSON SIGNING

[Signature]

SIGNATURE

Deputy Director Public Safety

TITLE

10/27/14

DATE

**EMERGENCY MEDICAL SERVICES
14752 SIX MILE CYPRESS PARKWAY
FORT MYERS, FL 33912
(239) 533-3911**

**AFTER REVIEWING THE APPLICATION, PLEASE INDICATE
BELOW WHAT ARRANGEMENTS YOUR ORGANIZATION WILL
REQUIRE THE APPLICANT TO COMPLY WITH FOR THEIR EVENT.**

Treatment Facilities: _____

Medical Personnel: _____

Medical Supplies/Equipment: _____

Special Arrangements: one dedicated ambulance for event.

(7) Seven hours in event (1) hour set up / take down

Fee For Services: \$160.00 per hour x 8 hours = \$1,280.00. pt.
is billed separately at time of service

SCOTT TITZ
PRINT NAME of PERSON SIGNING

[Signature]
SIGNATURE

Deputy Director Public Safety
TITLE

10/27/14
DATE

LEE COUNTY RISK MANAGEMENT
COUNTY ADMINISTRATION BUILDING – 4TH FLOOR
2115 SECOND STREET
FORT MYERS, FLORIDA 33901
(239) 533-2221

AFTER REVIEWING THE APPLICATION, PLEASE INDICATE
BELOW WHAT ARRANGEMENTS YOUR ORGANIZATION WILL
REQUIRE THE APPLICANT TO COMPLY WITH FOR THEIR EVENT.

Insurance Requirements: _____

**Commercial general liability insurance with minimum limits of One Million Dollars
\$1,000,000 per occurrence to protect against bodily injury and/or property damage relative
to applicants use of aforementioned event within Lee County.**

Special Arrangements: _____

**A certificate of insurance shall be submitted as evidence of the required coverage listing
Lee County Board of County Commissioners, P.O. Box 398, Fort Myers, FL 33902 as the
certificate holder and as an additional insured.**

Subject to proof of insurance.

Mike Figueroa

PRINT NAME of PERSON SIGNING



SIGNATURE

Risk Program Manager

TITLE

July 2, 2014

DATE

Lee County Parks & Recreation
Terry Park Administrative Office
3410 Palm Beach Blvd.
Ft. Myers, FL 33916
Office: 239-533-7451
Cell: 239-229-0488
Fax: 239-485-2300
www.leeparks.org
Join our online public forum at www.leecountytownhall.com

Please note: Florida has a very broad public records law. Most written communications to or from County Employees and officials regarding County business are public records available to the public and media upon request. Your email communication may be subject to public disclosure.

Under Florida law, email addresses are public records. If you do not want your email address released in response to a public records request, do not send electronic mail to this entity. Instead, contact this office by phone or in writing.

From: Larry Baldwin [<mailto:larry@eidentracing.com>]
Sent: Monday, June 30, 2014 4:05 PM
To: Flanjack, Alise
Subject: Fwd: lee county permit for Marathon Nov. 9th

Ms. Flanjack:

Enclosed please find the special permit application sheet for you to approve for the Ft. Myers Marathon on Nov. 9th. Please e-mail signature page to me at your earliest convenience.

Thanks,

Larry Baldwin
Eident racing

*Eident Racing
Ft. Marathon
Nov. 9, 2014*

LEE COUNTY PARKS AND RECREATION
3410 PALM BEACH BOULEVARD
FORT MYERS, FLORIDA 33916
(239) 533-7275

AFTER REVIEWING THE APPLICATION, PLEASE INDICATE
BELOW WHAT ARRANGEMENTS YOUR ORGANIZATION WILL
REQUIRE THE APPLICANT TO COMPLY WITH FOR THEIR EVENT.

Illumination: N/A

Parking Areas: Event is not utilizing any Lee County Parks
and Recreation's property.

Other: _____

Alise Flanigan
PRINT NAME OF PERSON SIGNING

Alise Flanigan
SIGNATURE

P/R Manager
TITLE

July 3, 2014
DATE

From: "Jansen, Stephen" <JANSENSJ@leegov.com>
Subject: RE: Marathon
Date: October 31, 2014 3:09:50 PM EDT
To: Larry Baldwin <larry@eidentracing.com>

1 Attachment, 48 KB

I would have liked to see a little better M.O.T., but the Sheriff is well involved, and I'll leave the details to the men and women on the scene.

Stephen M. Jansen, P.E., P.T.O.E.
Lee County DOT, Traffic Section
1500 Monroe St
Fort Myers, FL 33901
(239)533-8503 office
(239)229-4006 mobile
(239)485-8520 fax

jansensj@leegov.com

-----Original Message-----

From: Larry Baldwin [mailto:larry@eidentracing.com]
Sent: Friday, October 31, 2014 1:51 PM
To: Jansen, Stephen
Subject: Marathon

Mr Jansen,

What other information do i need to provide regarding the marathon race.

Larry Baldwin

Please note: Florida has a very broad public records law. Most written communications to or from County Employees and officials regarding County business are public records available to the public and media upon request. Your email communication may be subject to public disclosure.

Under Florida law, email addresses are public records. If you do not want your email address released in response to a public records request, do not send electronic mail to this entity. Instead, contact this office by phone or in writing.

DEPARTMENT OF TRANSPORTATION
1500 MONROE STREET
FORT MYERS, FL 33901
(239) 533-8580

AFTER REVIEWING THE APPLICATION, PLEASE INDICATE
BELOW WHAT ARRANGEMENTS YOUR ORGANIZATION WILL
REQUIRE THE APPLICANT TO COMPLY WITH FOR THEIR EVENT.

Parking: All vehicles parked on County streets shall park in a manner as not to block the free flow of traffic or block sight distance at intersections and driveways.

Ingress and Egress: Intersections of public streets shall be controlled by the Sheriff.
Properly trained and attired personnel controlling private driveways shall not overly detain traffic from entering or exiting those sites.

Special Arrangements: The traffic signals on US 41 are under the control of TCD for construction.
Any revisions needed to those signals for proper operation during the event need to be approved.

through the FDOT project manager. Drivers on the highways are not to be extraordinarily delayed at intersections, even if this means slowing some runners on occasion. Traffic control personnel are expected to remain at their stations for the duration of the event.

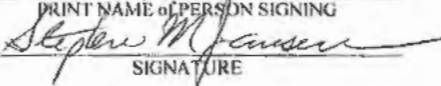
Stephen M. Jansen
PRINT NAME of PERSON SIGNING

SIGNATURE
County Traffic Engineer
TITLE
October 31, 2014
DATE



City of Fort Myers, Florida

Down Fellows- Engineering
2200 Second St.
FORT MYERS, FLORIDA
33901-2217

(239) 321-7453
FAX (239) 344-5943
dfellows@cityftmyers.com

October 1, 2014

Florida FDOT
Dave Smith
P.O. Box 1249
Bartow, FL 33831-1249

RE: Fort Myers 5K, ½ Marathon and Marathon
November 9, 2014
7am to 1pm

Dear Mr. Dave Smith,

I am submitting the application for temporary road closure for the Fort Myers 5K, ½ Marathon and Marathon to be held on the streets and bridges between City of Fort Myers and North Fort Myers in Lee County. The event is being put on by Eident Racing and will be held on November 9th starting at Virginia Ave. and West First St. at 7am with the last runners crossing the finish line 6 hours later around 1pm. This is a first time event and I apologize for the lateness of the permit as it has been a challenge to get the distance and the traffic safety to work together while thinking of the homeowners, businesses and traffic being effected.

The route for this event will be a circle and they will be completing the route twice for the ½ marathon and 3 times for the marathon on the bridges. The routes are as follows for each:

- 5K- Will start at 7am for all groups on Virginia Ave. proceed north to West First St. turn right onto West First St. Proceed on West First St. to Monroe St. turn left onto Monroe Street using the west lane of the southbound part of Monroe. Turn from Monroe right onto Edwards Dr. heading east to Fowler St. Turn left onto the southbound Edison Bridge, proceed to the top of the bridge, turn around and return the same way back to the finish on Virginia Ave. by Pinchers Crab Shack. This part should take 2 hours max.
- ½ Marathon and Marathon will also start at 7am on Virginia Ave. turn right onto West First St. and proceed east to Monroe St. turn left onto Monroe St. and



City of Fort Myers, Florida

Dawn Fellows- Engineering
2200 Second St.
FORT MYERS, FLORIDA
33901-2217

(239) 321-7453
FAX (239) 344-5943
dfellows@cityofmyers.com

continue north to Edwards Drive. Turn right onto Edwards Dr. and head east to Lee St. There will be a turnaround at Lee St. to bring the ½ marathon and marathon back to Monroe St. then right onto West First St. and a quick left onto Heitman Street. Southbound on Heitman to Main Street turn right into the onramp for the Caloosahatchee Bridge. They should be entering the Caloosahatchee Bridge between 7:30 and 8am to head north to North Fort Myers. (MOT map #1) They will continue into Lee County territory on US 41 north. They will have Bob's Barricades closing a lane on US 41 (S. Cleveland Ave.) all the way to Pine Island Rd. where the runners will enter the neighborhood to the right and come out more south onto Business US 41. (Since this is outside the city limits I do not have a map or exact streets they will be on.) (See MOT Map#2) They reenter onto Pondella Rd. and head east to Business US 41 and will turn right onto Business US 41 and head south to the Edison Bridge. The runners will cross over the Edison Bridge (1 ½ lanes will be coned off placing traffic in left hand lane to continue onto Fowler St. (MOT Map #3) and at the base of the bridge in Fort Myers they will turn right onto Edwards Drive. They will continue this route a second time around Edwards to Monroe to Heitman, Main St. and onto the Caloosahatchee Bridge. This time when they exit the Caloosahatchee Bridge Bob's Barricades will begin to remove the cones behind the last runner and reopen the bridge. We hope this will be completed by 10:30am. The second time when the runners come over the southbound Edison Bridge at the base of the bridge the ½ marathon and marathon will divide with the Marathon going left onto First St. eastbound and the ½ marathon going to the right onto Edwards Dr. The ½ marathon will continue back to Monroe St. to West First St. and back to the finish at Virginia Ave.

- The marathon will continue eastbound on First St. to Park Ave. where the runners will turn left onto the Northbound Edison Bridge. (MOT map #4) On the 2 coned off lanes on the west side of the bridge with traffic to the far right hand lane. The marathon will continue back into North Fort Myers where the Lee County Sheriff's Office will pick up the runners and they will run through some roads on the right side of Business US 41 before exiting back onto Business US 41 and heading south back to the Edison Bridge. (MOT maps #5 & #6) The runners will then come over the bridge and turn right onto Edwards Dr. to Monroe to West First St. and the finish line on Virginia Ave. All runners should be back by 1pm, any others will have to move onto the sidewalks to complete the race. The cones and barricades closing the roads will begin to be removed and reopened after 1pm.
- Fort Myers Police Department will handle the road closures and intersections within the City of Fort Myers jurisdiction and the Lee County Sheriff's



City of Fort Myers, Florida

Dawn Fellows- Engineering
2200 Secnd St.
FORT MYERS, FLORIDA
33901-2217

(239) 321-7453
FAX (239) 344-5943
cfellows@cityftmyers.com

Department will handle traffic in the North Fort Myers area. These departments have been attending the event meetings so everyone is on the same page.

- The barricades and cones on the bridges, North Fort Myers and on First St. will be handled by Bob's Barricades and the barricades on the rest of the route will be handled by the City of Fort Myers traffic division. All closure will follow the Florida Maintenance of Traffic guidelines.

Have a great day!!

A handwritten signature in blue ink that reads "Dawn Fellows".

Dawn Fellows
Permit Coordinator
Engineering Division

Permit # 2014-F-192-14

Rule 14-65, F.A.C.

STATE OF FLORIDA DEPARTMENT OF TRANSPORTATION

850-040-65
MAINTENANCE
03/06

REQUEST FOR TEMPORARY CLOSING/SPECIAL USE OF STATE ROAD

REC. 10/6/14

- Instructions: 1. Obtain signatures of local law enforcement and city/county officials.
- 2. This form must be submitted by the local governmental authority to FDOT to obtain written approval. Allow adequate time for the review.
- 3. Attach any necessary maps or supporting documents.

NAME OF ORGANIZATION Eident Racing		PERSON IN CHARGE Larry Baldwin		DATE 10-1-14
ADDRESS OF ORGANIZATION 9128 Strada Place #10115 Naples, Fl. 34108				TELEPHONE NUMBER
TITLE OF EVENT Fort Myers 5K, 1/2 Marathon and Marathon				
DATE OF EVENT 11-9-14	STARTING TIME OF EVENT 7am	DURATION OF EVENT (APPROX) 6 hours	ACTUAL CLOSING TIME (INCLUDING SETTING UP BARRIERS, ETC.) 5:30 or 6am to 2pm	
PROPOSED ROUTE (INCLUDE STATE ROAD NUMBER, SPECIFIC LOCATION, ETC. - INCLUDE MAPS) See attached map, MOT maps and letter explaining the routes				
DETOUR ROUTE (INCLUDE ALTERNATE ROUTES - INCLUDE MAPS) No need for detours we are just closing down 1 to 2 lanes on the bridges and allowing traffic to still pass in one lane.				
NAME OF DEPT. RESPONSIBLE FOR TRAFFIC CONTROL, ETC. (CITY POLICE, SHERIFF'S DEPT., FLORIDA HWY. PATROL, ETC.) (INCLUDE PRECINCT NO.) Fort Myers Police Department will cover City of Fort Myers side and Lee County Sherriff's Department will cover North Fort Myers.				
SPECIAL CONDITIONS Fort Myers Police Department will cover the bridges and Bob's Barricades will provide the cones and the MOT maps attached. Traffic Control shall comply with the Federal Manual on Uniform Traffic Control Devices (MUTCD) and FDOT Design Standards 800 Series.				
THIS SECTION IS TO BE COMPLETED WHEN PERMITTING SPECIAL USE OF A STATE ROAD FOR FILMING				
LICENSED PYROTECHNICS OPERATOR _____		LICENSE NO _____		
APPROVAL OF LOCAL FIRE DEPARTMENT _____				
LIABILITY INSURANCE CARRIER _____		POLICY EFFECTIVE DATE _____		
COVERAGE AMOUNT _____ (\$1,000,000 MINIMUM)				
LENGTH OF COVERAGE _____ DAYS				
FEDERAL AVIATION ADMINISTRATION APPROVAL FOR LOW FLYING FILMING _____				
ADDITIONAL LIABILITY INSURANCE AMOUNT _____ (\$5,000,000 MINIMUM)				
TYPED NAME AND TITLE (INCLUDE BADGE NO IF APPROPRIATE) Police Chief Doug Baker		SIGNATURE OF CHIEF OF LAW ENFORCEMENT AGENCY <i>[Signature]</i>		DATE SIGNED 10/2/14
TYPED NAME AND TITLE OF CITY/COUNTY OFFICIAL City Manager William Mitchell		SIGNATURE OF CITY/COUNTY OFFICIAL <i>[Signature]</i>		DATE SIGNED 10/2/14

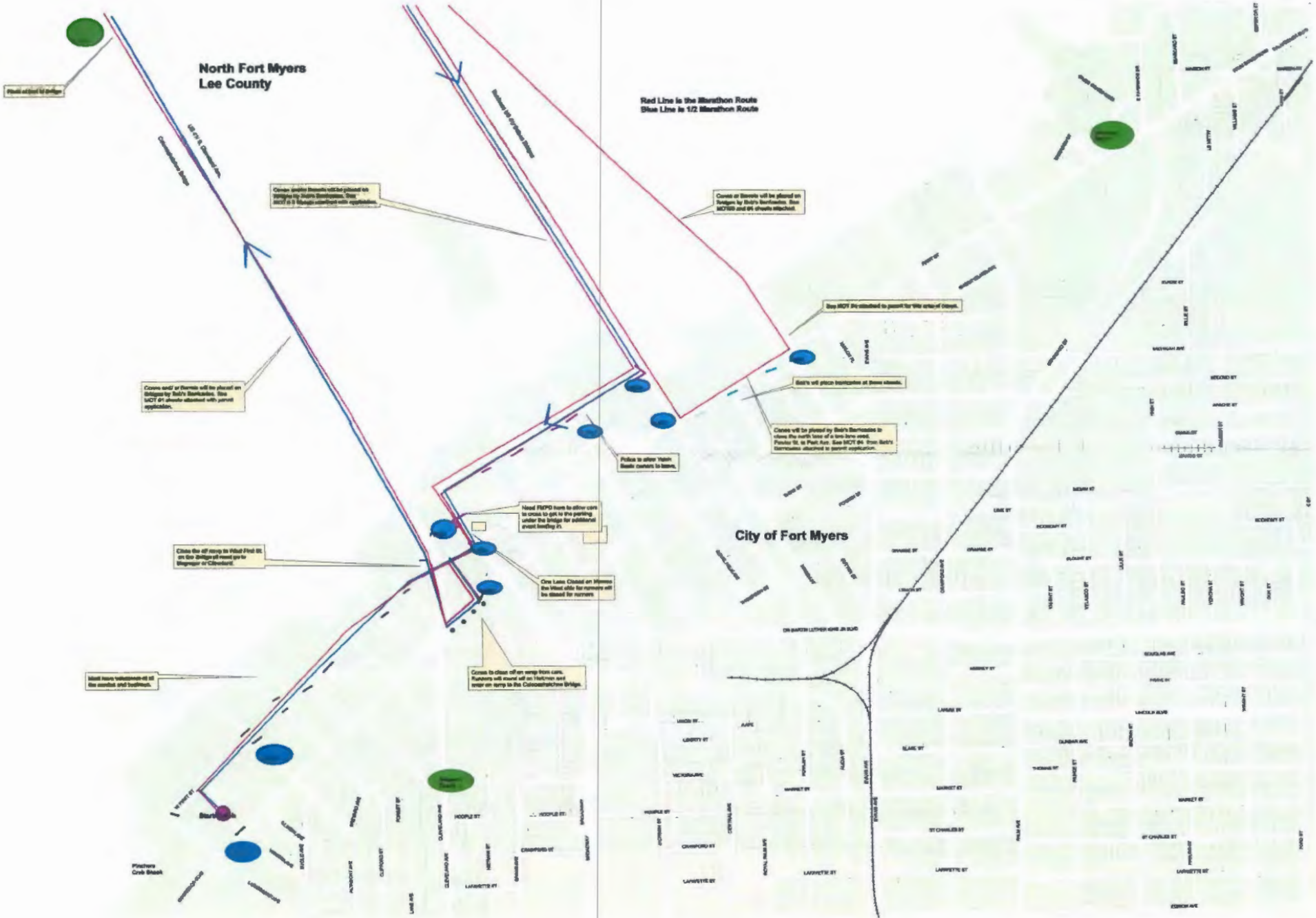

**North Fort Myers
Lee County**

Red Line is the Marathon Route
Blue Line is 1/2 Marathon Route

City of Fort Myers

Small section of bridge

Colosseum Bridge

**North Fort Myers
Lee County**

Crosswalks should only be placed on bridges by State Department. See sheet 03 for additional information with application.

Crosswalks will be placed on bridges by State Department. See MCT 04 and 06 sheets attached.

Crosswalks or barriers will be placed on bridges by State Department. See MCT 04 sheets attached with permit application.

See MCT 04 attached to permit for this area of closure.

Bar's will place barricades at these locations.

Crosswalks will be placed by State Department to close the north lane of a two-lane road. See sheet 03, 04, 05, 06, 07, 08, 09, 10, 11, 12, 13, 14, 15, 16, 17, 18, 19, 20, 21, 22, 23, 24, 25, 26, 27, 28, 29, 30, 31, 32, 33, 34, 35, 36, 37, 38, 39, 40, 41, 42, 43, 44, 45, 46, 47, 48, 49, 50, 51, 52, 53, 54, 55, 56, 57, 58, 59, 60, 61, 62, 63, 64, 65, 66, 67, 68, 69, 70, 71, 72, 73, 74, 75, 76, 77, 78, 79, 80, 81, 82, 83, 84, 85, 86, 87, 88, 89, 90, 91, 92, 93, 94, 95, 96, 97, 98, 99, 100. See MCT 04. From Bar's Departmental approval to permit application.

Police to close lanes. State camera to lane.

Local FPFD team to offer cars to crash to get to the parking under the bridge for additional event handling in.

Crosswalks will be placed on bridges by State Department. See MCT 04 sheets attached with permit application.

Crosswalks Closed on Highway. See sheet 04 for roadway will be closed for runners.

Small section of bridge

Crosswalks will be placed on bridges by State Department. See MCT 04 sheets attached with permit application.

Peterson Creek Beach

CLAYTON ST

CLAYTON ST

CLAYTON ST

CLAYTON ST

CLAYTON ST

CLAYTON ST

CLAYTON ST

CLAYTON ST

CLAYTON ST

CLAYTON ST

CLAYTON ST

CLAYTON ST

CLAYTON ST

CLAYTON ST

CLAYTON ST

CLAYTON ST

CLAYTON ST

CLAYTON ST

CLAYTON ST

CLAYTON ST

CLAYTON ST

CLAYTON ST

CLAYTON ST

CLAYTON ST

CLAYTON ST

CLAYTON ST

CLAYTON ST

CLAYTON ST

CLAYTON ST

CLAYTON ST

CLAYTON ST

CLAYTON ST

CLAYTON ST

CLAYTON ST

CLAYTON ST

CLAYTON ST

CLAYTON ST

CLAYTON ST

CLAYTON ST

CLAYTON ST

CLAYTON ST

CLAYTON ST

CLAYTON ST

CLAYTON ST

CLAYTON ST

CLAYTON ST

CLAYTON ST

CLAYTON ST

CLAYTON ST

CLAYTON ST

CLAYTON ST

CLAYTON ST

CLAYTON ST

CLAYTON ST

CLAYTON ST

CLAYTON ST

CLAYTON ST

CLAYTON ST

CLAYTON ST

CLAYTON ST

CLAYTON ST

CLAYTON ST

CLAYTON ST

CLAYTON ST

CLAYTON ST

CLAYTON ST

CLAYTON ST

CLAYTON ST

CLAYTON ST

CLAYTON ST

CLAYTON ST

CLAYTON ST

CLAYTON ST

CLAYTON ST

CLAYTON ST

CLAYTON ST

CLAYTON ST

CLAYTON ST

CLAYTON ST

CLAYTON ST

CLAYTON ST

CLAYTON ST

CLAYTON ST

CLAYTON ST

CLAYTON ST

CLAYTON ST

CLAYTON ST

CLAYTON ST

CLAYTON ST

CLAYTON ST

CLAYTON ST

CLAYTON ST

CLAYTON ST

CLAYTON ST

CLAYTON ST

CLAYTON ST

CLAYTON ST

CLAYTON ST

CLAYTON ST

CLAYTON ST

CLAYTON ST

CLAYTON ST

CLAYTON ST

CLAYTON ST

CLAYTON ST

CLAYTON ST

CLAYTON ST

CLAYTON ST

CLAYTON ST

CLAYTON ST

CLAYTON ST

CLAYTON ST

CLAYTON ST

CLAYTON ST

CLAYTON ST

CLAYTON ST

CLAYTON ST

CLAYTON ST

CLAYTON ST

CLAYTON ST

CLAYTON ST

CLAYTON ST

CLAYTON ST

CLAYTON ST

CLAYTON ST

CLAYTON ST

CLAYTON ST

CLAYTON ST

CLAYTON ST

CLAYTON ST

CLAYTON ST

CLAYTON ST

CLAYTON ST

CLAYTON ST

CLAYTON ST

CLAYTON ST

CLAYTON ST

CLAYTON ST

CLAYTON ST

CLAYTON ST

CLAYTON ST

CLAYTON ST

CLAYTON ST

CLAYTON ST

CLAYTON ST

CLAYTON ST

CLAYTON ST

CLAYTON ST

CLAYTON ST

CLAYTON ST

CLAYTON ST

CLAYTON ST

CLAYTON ST

CLAYTON ST

CLAYTON ST

CLAYTON ST

CLAYTON ST

CLAYTON ST

CLAYTON ST

CLAYTON ST

CLAYTON ST

CLAYTON ST

CLAYTON ST

CLAYTON ST

CLAYTON ST

CLAYTON ST

CLAYTON ST

CLAYTON ST

CLAYTON ST

CLAYTON ST

CLAYTON ST

CLAYTON ST

CLAYTON ST

CLAYTON ST

CLAYTON ST

CLAYTON ST

CLAYTON ST

CLAYTON ST

CLAYTON ST

CLAYTON ST

CLAYTON ST

CLAYTON ST

CLAYTON ST

CLAYTON ST

CLAYTON ST

CLAYTON ST

CLAYTON ST

CLAYTON ST

CLAYTON ST

CLAYTON ST

CLAYTON ST

CLAYTON ST

CLAYTON ST

CLAYTON ST

CLAYTON ST

CLAYTON ST

CLAYTON ST

CLAYTON ST

CLAYTON ST

CLAYTON ST

CLAYTON ST



All American Barricades
 3355 NW 154th Terrace
 Miami Gardens, FL 33054-2465
 305-685-6124
 Fax 305-685-6125

QUOTATION

Quote Date	Quote ID
10/21/2014	Ft Myers Marath

Valid Through: 11/9/2014

Eident racing
 Larry Baldwin

Job Location:
 Ft Myers
 Ft Myers
 Quote Created By: Ruben Santos
 Estimated Days: 1

Phone: 941-416-1838

Email: larry@eidentracing.com

Item Description	Price	UOM	Qty/Day	Days	Total Qty.	Total
36" Traffic Cone - Rental	\$1.00	Per Each	1600	1	1600	\$1,600.00
Lane Closure/Set Up	\$150.00	Per Each	5	1	5	\$750.00
(9) Man Labor (After/Weekend Hours)	\$38.00	Per Hour	180	1	180	\$6,840.00
Lump Sum Special Events Travel	\$2,000.00	Per Each	1	1	1	\$2,000.00

Note: The * indicates taxable items.

EQUIPMENT	\$3,600.00
ONE TIME CHARGES	\$0.00
LABOR	\$7,590.00
SUBTOTAL	\$11,190.00
SALES TAX (6%)	\$0.00
QUOTE TOTAL	\$11,190.00

Event: Ft Myers Marathon
 Date: Sunday November 9, 2014
 Race Starts: 7 AM Set up @ 3 AM
 Location: Ft Myers, FL
 VMS boards not included on this quote

Included: Delivery, Setup, Takedown and Pickup

Add'l Terms: Setup according to approved traffic control plan (TCP) only.

Customer holds All American Barricades, Corp. harmless of all liability resulting from any arising claims as set forth in section 725.06 of the Florida statutes.

Any additional equipment added to the job site will be billed separately.

PAYMENT IN FULL IS DUE 1-WEEK BEFORE EVENT!

 Ruben Santos
 All American Barricades

10/21/2014
 Date

Accepted By: _____ 10/20/14
 Signature: *John Mathews*
 Print Name: John Mathews
 Title: President
 Company: Eident Racing

Visit Our Website at www.barricades.com

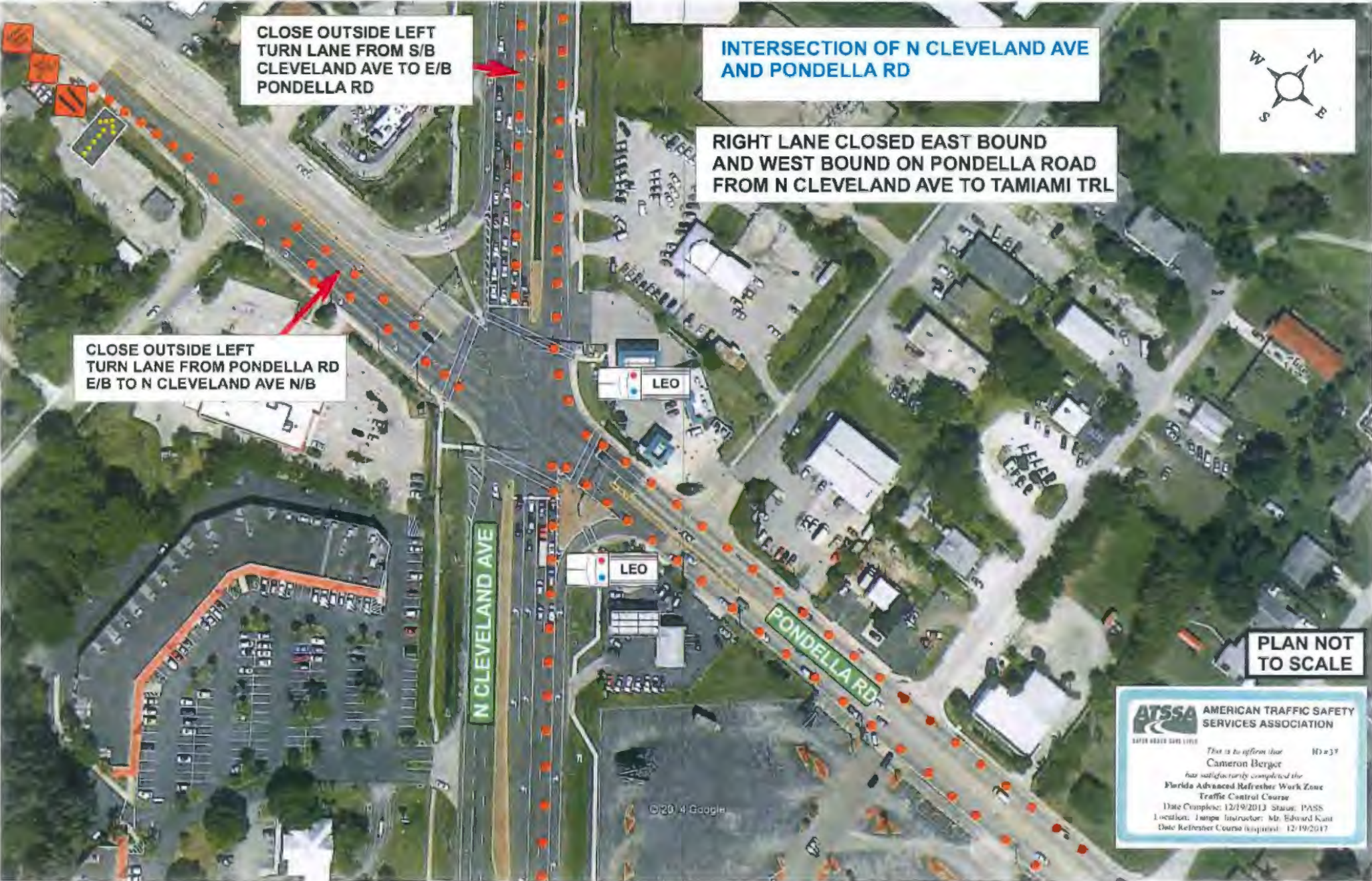

CLOSE OUTSIDE LEFT TURN LANE FROM S/B CLEVELAND AVE TO E/B PONDELLA RD

INTERSECTION OF N CLEVELAND AVE AND PONDELLA RD

RIGHT LANE CLOSED EAST BOUND AND WEST BOUND ON PONDELLA ROAD FROM N CLEVELAND AVE TO TAMiami TRL



CLOSE OUTSIDE LEFT TURN LANE FROM PONDELLA RD E/B TO N CLEVELAND AVE N/B

LEO

LEO

N CLEVELAND AVE

PONDELLA RD

PLAN NOT TO SCALE

ATSSA AMERICAN TRAFFIC SAFETY SERVICES ASSOCIATION

This is to affirm that Cameron Berger has satisfactorily completed the Florida Advanced Refresher Work Zone Traffic Control Course Date Completed: 12/19/2013 Status: PASS Location: Tampa Instructor: Mr. Edward Kant Date Refresher Course Issued: 12/19/2013

INTERSECTION OF N TAMiami TRl AND PONDELLA RD

**RIGHT LANE ON PONDELLA RD
EAST AND WEST-BOUND TO BE CLOSED
FROM TAMiami TRl TO N CLEVELAND AVE**

**VEHICLE TRAFFIC
TO USE LEFT LANES ON PONDELLA RD**

**RUNNERS USING RIGHT
LANE ON TAMiami TRl
NORTH AND SOUTHBOUND
VEHICLE TRAFFIC USING TWO
LEFT LANES ON NORTH AND
SOUTHBOUND**



**LAW ENFORCEMENT OFFICERS
TO ASSIST**

**CLOSE OUTSIDE LEFT TURN LANE
ON N/B TAMiami TRl TURNING WEST ON
PONDELLA RD.**

**PLAN NOT
TO SCALE**

ATSSA AMERICAN TRAFFIC SAFETY SERVICES ASSOCIATION
SAFER ROAD. SAFE LIVES.

This is to affirm that
Cameron Bergar ID#37
has satisfactorily completed the
**Florida Advanced Refresher Work Zone
Traffic Control Course**
Date Complete: 12/19/2013 Status: PASS
Location: Tampa Instructor: Mr. Edward Kani
Date Refresher Course Required: 12/19/2017

EDISON BRIDGE SOUTH END

41

EDISON BRIDGE

EDWARDS DR



RUNNERS USING RIGHT TWO LANES ON EDISON BRIDGE VEHICLE TRAFFIC USING LEFT LANE

RIGHT TWO LANES TO BE CLOSED TO SECOND ST

PLAN NOT TO SCALE

ATSSA AMERICAN TRAFFIC SAFETY SERVICES ASSOCIATION
EDUCATION DEPT. 1011

This is to affirm that ID # J1
Cameron Berger
has successfully completed the
Florida Advanced Refresher Work Zone Traffic Control Course
Date Complete: 12/19/2013 Status: PASS
Location: Tampa Instructor: Mr. Edward Kant
Date Refresher Course Required: 12/19/2017

© 2014 Google



**FIRST ST, FOWLER ST
AND PARK AVE INTERSECTIONS**

**RUNNERS USING RIGHT TWO LANES
ON BOTH BRIDGES, VEHICLE TRAFFIC USING
LEFT LANE**



LAW ENFORCEMENT OFFICER
TO ASSIST WITH STOPPING
VEHICLE TRAFFIC WHEN RUNNERS
ARE CROSSING ONTO FIRST ST
FROM BRIDGES

RUNNER USING LEFT
LANE ON FIRST ST
VEHICLE TRAFFIC USING
RIGHT LANE

CLOSING THE OUTSIDE RIGHT
TURN LANE ALLOWING VEHICLE
TRAFFIC TO ONLY USE THE CENTER
LANE THAT IS AN OPTIONAL THROUGH
OR RIGHT TURN LANE

FOWLER ST

FIRST ST

LEO

ROAD
CLOSED

ROAD
CLOSED

ROAD
CLOSED

ROAD
CLOSED

LAW ENFORCEMENT OFFICER
TO ASSIST WITH STOPPING
VEHICLE TRAFFIC WHEN RUNNERS
ARE CROSSING ONTO FIRST ST
FROM BRIDGES

CLOSING THE LEFT LANE
UTILIZING FDOT INDEX 613

PLAN NOT
TO SCALE

HOUGH ST

WOODFORD AVE

POINSTITIA AVE

PARK AVE

ATSSA AMERICAN TRAFFIC SAFETY
SERVICES ASSOCIATION

This is to affirm that
Cameron Berger ID #37
has satisfactorily completed the
**Florida Advanced Refresher Work Zone
Traffic Control Course**
Date Complete: 12/19/2013 State: FLAAS
Location: Tampa Instructor: Mr. Edward Kutt
Date Refresher Course Required: 12/19/2017

**REFER TO THE PARK AVE AND FIRST ST
PAGE OF THE PLAN FOR THIS CLOSURE**

Google earth

**S CLEVELAND AVE AND
MAIN ST RAMP**



**RUNNERS TO USE RIGHT LANE
ON S CLEVELAND AVE N/B
VEHICLE TRAFFIC TO US LEFT LANE**

**VARIABLE MESSAGE BOARD
TO BE PLACED ON N/B TAMiami TrL
(S CLEVELAND AVE) SOUTH OF EDISON AVE**

**RIGHT LANE CLOSURE TO CONTINUE
TO JUST BEFORE MARIANA AVE**



RAMP CLOSED TO VEHICLE TRAFFIC

**LAW ENFORCEMENT
OFFICER TO ASSIST WITH RUNNERS
ENTERING BRIDGE.**



PANEL 1

**CAUTION
MARATHON
AHEAD**

PANEL 2

**RUNNERS
ON
ROADWAY**

**PLAN NOT
TO SCALE**



**AMERICAN TRAFFIC SAFETY
SERVICES ASSOCIATION**

This is to attest that ID: 437

Cameron Berger

*has satisfactorily completed the
Florida Advanced Refresher Work Zone
Traffic Control Course*

*Disc Complete: 12/19/2013 Status: PASS
Location: Tampa Instructor: Mr. Edward Kant
Date Refresher Course Required: 12/19/2017*

**EDISON BRIDGE
NORTH END
TRANSITIONS**

THIS CONFIGURATION OF THE TWO
RIGHT LANES BEING CLOSED ON THE
S/B EDISON BRIDGE FOR RUNNERS
WILL CONTINUE TO SECOND ST



RUNNERS WILL BEGIN USING
THE TWO RIGHT LANES ON S/B
TAMIAMI TRL JUST NORTH OF E NORTH
SHORE AVE.

RUNNERS WILL BE USING THE TWO
RIGHT LANES ON N/B TAMIAMI TRL TO
JUST NORTH OF E. NORTH SHORE AVE

**PLAN NOT
TO SCALE**

ATSSA AMERICAN TRAFFIC SAFETY SERVICES ASSOCIATION
SAFER BUILT SAFE LIVES

This is to affirm that **ID #37**
Cameron Berger
has satisfactorily completed the
**Florida Advanced Refresher Work Zone
Traffic Control Course**
Date Complete: 12/19/2013 Status: PASS
Location: Tampa Instructor: Mr. Edward Kant
Date Refresher Course Required: 12/19/2017

From: donaldmatuszak@comcast.net
Subject: Marathon map
Date: October 28, 2014 11:44:38 AM EDT
To: "Baldwin, Larry" <larry@eidentracing.com>

† Attachment, 293 KB

Larry
Attached is the Marathon map. Not done with half yet..

Thanks
Don

Ft Myers Marathon



Ft Myers Marathon

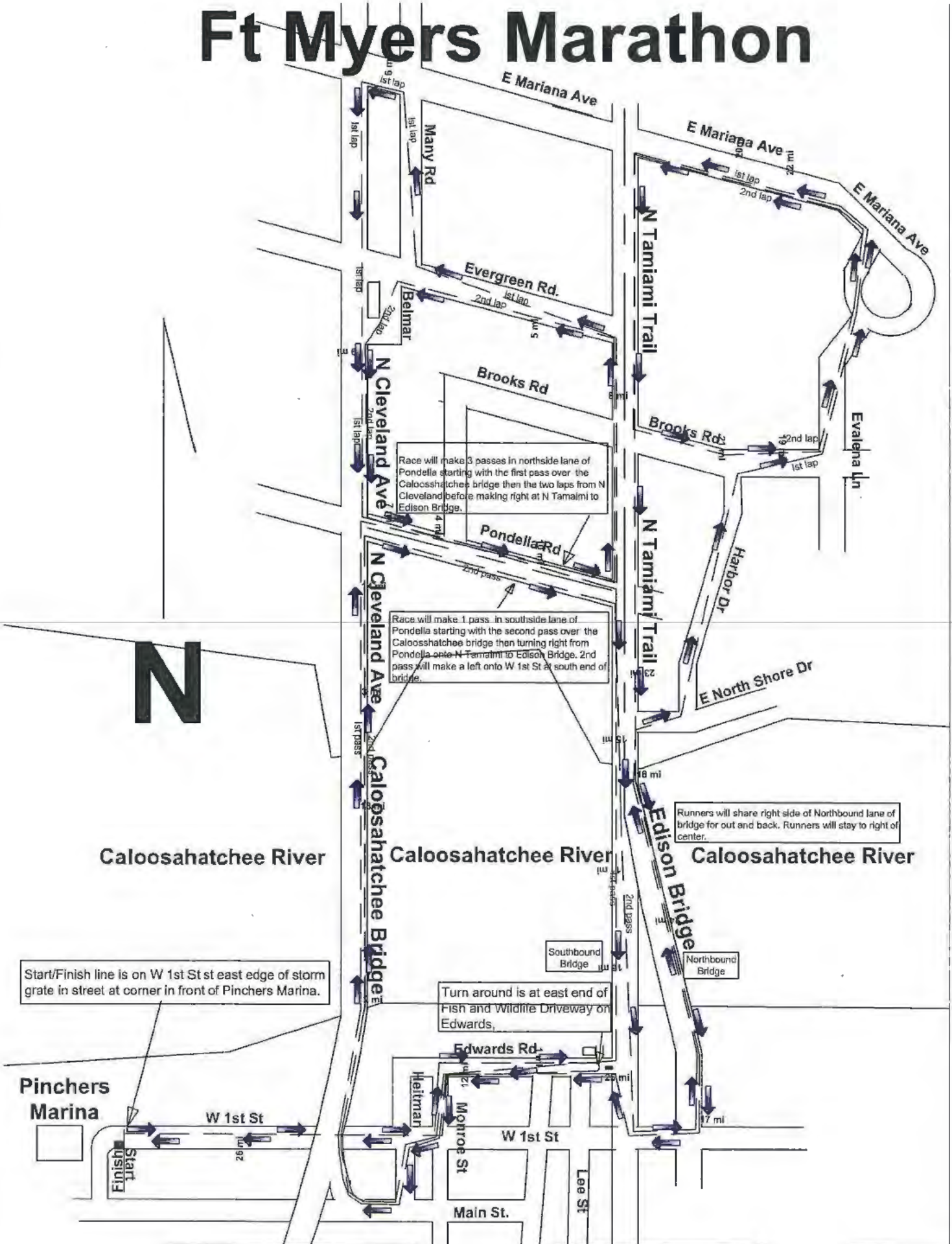

N

Caloosahatchee River

Caloosahatchee River

Caloosahatchee River

Start/Finish line is on W 1st St east edge of storm grate in street at corner in front of Pinchers Marina.

Turn around is at east end of Fish and Wildlife Driveway on Edwards.

Runners will share right side of Northbound lane of bridge for out and back. Runners will stay to right of center.

Race will make 3 passes in northside lane of Pondella starting with the first pass over the Caloosahatchee bridge then the two laps from N Cleveland before making right at N Tamiami to Edison Bridge.

Race will make 1 pass in southside lane of Pondella starting with the second pass over the Caloosahatchee bridge then turning right from Pondella onto N Tamiami to Edison Bridge. 2nd pass will make a left onto W 1st St at south end of bridge.

Pinchers Marina

W 1st St

Edwards Rd

Heitman

Montroe St

W 1st St

Main St

Lee St

E Marianna Ave

Many Rd

Evergreen Rd

Belmar

Brooks Rd

N Cleveland Ave

Pondella Rd

N Cleveland Ave

E Marianna Ave

E Marianna Ave

N Tamiami Trail

Brooks Rd

Evalena Ln

N Tamiami Trail

Harbor Dr

E North Shore Dr

Edison Bridge

Southbound Bridge

Northbound Bridge



2014 FORT MYERS MARATHON TURN-BY-TURN DIRECTIONS

1. Start at Pinchers head East on West First St. to Monroe St.
2. Take a left onto Monroe St. Proceed to Edwards Dr.
3. Take a right onto Edwards Dr.
4. Follow Edwards Drive to the marathon turnaround, which will be marked so
5. Take a left onto Monroe St.
6. Take a right onto West First St.
7. Follow for 1 block then take a left onto Heitman Ave.
8. Follow for 1 block then take a right onto Main St.
9. Proceed onto bridge ramp.
10. Stay on bridge and follow Cleveland Ave. to Pondella Rd.
11. Crossover the intersection of Pondella Rd. and Cleveland and take a right turn onto Pondella Rd. and head East toward Business 41/Tamiami Trail.
12. Take a left onto Business 41/Tamiami Trail
13. Take a left onto Evergreen Avenue
14. Proceed to Many Ave and take a right
15. Take a left onto Mariana Ave.
16. Take a left onto Cleveland Ave.
17. Proceed approximately 1.1 miles and take a left onto Pondella Rd. for 2nd loop (approximately mile marker 7.0).
18. Take a left onto Business 41/Tamiami Tr.
19. Take a left onto Evergreen Ave.
20. Take a left onto Betmar Blvd.
21. Take a left onto Cleveland Ave.
22. Take left at Pondella Rd. (mile marker 9.6)
23. At Business 41/Tamiami Tr. take a right crossover Pondella Rd. and head south over Edison Bridge
24. Take right onto Edwards Dr.
25. Take left onto Monroe St.

26. Take right onto First St.
27. Take left onto Heitman Ave.
28. Take a right onto Main St.
29. Proceed onto bridge ramp again.
30. Stay on bridge and follow Cleveland Ave. to Pondella Rd.
31. Take a sharp right onto Pondella Rd.
32. Take a right onto Business 41/Tamiami Trail and go over Edison Bridge for a second time.
33. Take a left onto First St.
34. Take on a left onto Park Ave. and go over the Edison Bridge East Span.
35. Take a right onto North Shore Avenue (mile marker 18.5).
36. In one block take a quick left onto Harbour Dr.
37. Take a right onto Brooks Rd.
38. Take a left onto Evalena Ln.
39. Stay left on Evalena Ln. until it merges onto East Mariana Ave.
40. Take a left onto Business 41/Tamiami Tr.
41. Take a left onto Brooks Rd. (mile marker 21).
42. Take a left onto Evalena Ln.
43. Take a left onto East Mariana Ave.
44. Take a left onto Buisness 41/Tamiami Tr.
45. Go past Brooks Rd. (approximately mile marker 23) and head towards East Span of Edison Bridge.
46. (Note: at the intersection of North Shore Ave. & Business41/Tamiami Tr. will start when runners are on the same side of the bridge span running both directions)
47. Proceed south over bridge.
48. Take a right onto First St.
49. Take a right onto Fowler St.
50. Take a left onto Edwards Dr.
51. Take a left onto Monroe St.
52. Take a right onto West First St.
53. Go straight on West First Street to FINISH LINE.



2014 FORT MYERS HALF MARATHON TURN-BY-TURN DIRECTIONS

1. Start at Pinchers head East on West First St. to Monroe St.
2. Take a left onto Monroe St. Proceed to Edwards Dr.
3. Take a right onto Edwards Dr.
4. Follow Edwards Dr. to the half marathon turnaround, which will be after the marathon turnaround.
5. Take a left onto Monroe St.
6. Take a right onto First St.
7. Follow for 1 block then take a left onto Heitman Ave.
8. Follow for 1 block then take a right onto Main St.
9. Proceed onto bridge ramp.
10. Stay on bridge and follow Cleveland Ave. to Pondella Rd.
11. Crossover the intersection of Pondella Rd. and Cleveland and take right turn onto Pondella Rd. and head East toward Business 41/Tamiami Tr.
12. Take a left onto Business 41/Tamiami Trail
13. Take a left onto Evergreen Avenue
14. Take a right onto Many Ave.
15. Take a left at Mariana Ave.
16. Take a left at Cleveland Ave.
17. Proceed approx. 1.1 miles and take a left onto Pondella Rd. for 2nd loop (approx. Mile 7.0).
18. Take a left onto Business 41/Tamiami Tr.
19. Take a left onto Evergreen Ave.
20. Take a left onto Betmar Blvd.
21. Take a left onto Cleveland Ave.
22. Take left at Pondella Rd. (approximately mile marker 9.6).
23. At Business 41/Tamiami Tr. take a right crossover Pondella Rd. and head south over Edison Bridge
24. Take right onto Edwards Dr.
25. Take left onto Monroe St.
26. Take right onto First St. and proceed to the FINISH LINE.



2014 FORT MYERS 5K TURN-BY-TURN DIRECTIONS

1. Start at Pinchers head East on West First St. to Monroe St.
2. Take a left onto Monroe St. Proceed to Edwards Dr.
3. Take a right onto Edwards Dr.
4. Follow Edwards Drive to the entrance of the Edison Bridge and take a left onto the bridge.
5. There will be a turnaround at the top of the bridge.
6. Make a right onto Edwards Dr.
7. Left onto Monroe St.
8. Right onto West First St.
9. Proceed to the FINISHLINE



Division of Public Resources

LEE COUNTY

SOUTHWEST FLORIDA

Date 10/3 Year 14

Received From LARRY Baldwin

Suppl. \$ _____

Video \$ _____ # _____

Permits \$ 75.00 cp event

Copies \$ _____

Other _____ \$ _____

Amount Paid \$ 75.00

Cash Check # 4837

Cashier's Signature [Signature]

LAWRENCE R. BALDWIN
525 KETCH DR
NAPLES, FL 34103

4837
63-751/631 11209
109000788538

Date 11/3/14

Pay to the Order of Lee County BOCC \$ 75.00
Smart Life and 10/100 Dollars

Wells Fargo Bank, N.A. Florida wells Fargo.com

For [Signature]



**MEMORANDUM
FROM
THE DIVISION OF PUBLIC RESOURCES**

DATE: November 5, 2014
TO: County Management
FROM: Samantha Westen, Administrative Assistant
RE: Event Permit for Signature

Attached is a Special Event application submitted by **Eident Racing** for the **“Fort Myers Marathon”** event which will take place in **Downtown Fort Myers to North Fort Myers Crossing the Caloosahatchee and Edison Bridges with lane closures (site plans and street listings are attached.)** on **November 9, 2014 from 6:30 am to 1:00 pm.**

All needed sign-off sheets are included as well as the insurance certificate and site plan.

Please sign the permit and return to Public Resources after review.

If you have any questions or concerns, please call me at 533-2112.

Thank you,

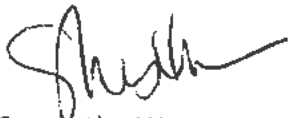

Samantha Westen

Attachment