



# EVENT PERMIT

Ordinance 17-08



## American Veterans Traveling Tribute

**PERMIT NUMBER:** TMP2025-00066

**Date(s) of Event:** March 26, 2025 - March 29, 2025

**Property Owner:** LEE COUNTY

**Applicant:** Bob Sheehan  
239-258-2686

**Description:** American Veterans traveling tribute is 80% replicas of the Vietnam Memorial Wall and also includes memorial plaques honoring our Fallen Military and First Responder Hero's.  
March 26, 2026 through March 29, 2025 from 9:00AM until 5:00PM

**Location of event:** 11500 FENWAY SOUTH DR, FORT MYERS, FL 33913  
**JetBlue Park**

Will the event be attended by 1000 or more people ?	No
Will the event be held on County Owned Property ?	Yes
Will there be alcohol consumed or sold at the event ?	No
Will a bond be posted for this event ?	No

**Permit Conditions:**

- \* Applicant must meet all event application requirements, including requirements of the sign-off agencies.
- \* The premises is to be left in the same condition as it was prior to the event.
- \* The permit is to be readily available for inspection during the entire event.
- \* If this approval includes the sale or consumption of alcoholic beverages, no alcoholic beverages may be consumed 1 1/2 hours prior to the conclusion of the event and vacating the facility/property.

Board of County Commissioners  
Lee County, Florida

 3/17/25  
County Manager Date



Lee County  
*Southwest Florida*

# Event Application

Special Event

Use of  
County  
Property

Alcohol  
within Lee  
County  
Facilities

Film, Video  
&  
Photography

TMP 2025-00066

American Veterans Traveling Tribute



# Lee County Event Permit Application



## Event Application

Check the appropriate box(es) below:

- ☒ SPECIAL EVENT PERMIT  
☐ USE OF COUNTY PROPERTY PERMIT  
☐ PERMIT TO SELL AND CONSUME ALCHOLIC BEVERAGES WITHIN LEE COUNTY FACILITIES  
☐ FILM PERMIT

Section I - GENERAL INFORMATION (All Permit Types)	
Title of Event / Name of Production	American Veterans Traveling Tribute
Date(s) of Event / Production:	March 26th thru March 29th 2025
Location(s) of Event:	Jet Blue Park
Name of Applicant:	Hope Hospice and Community Services
Applicant Address:	9470 HealthPark Circle Fort Myers, FL 33908
Applicant Phone Number:	239-258-2686
Contact Person: (If different from applicant)	Bob Sheehan
Contact Phone Number: (If different from applicant)	cell phone= 239-258-2686
Email Address:	bob.sheehan@hopehcs.org
Estimated Attendance:	500
Event Description: Include each activity, when activities take place, etc.	The American Veterans Traveling Tribute is an 80% replica of the Vietnam Memorial Wall and also includes memorial plaques honoring our Fallen Military and First Responder Heroes. The event will begin with the arrival of the memorial panels aboard the AVTT 1 of railer at Lee County Sheriff's headquarters on Six Mile Cypress Wednesday March 26th at 10am. A procession will depart from LCSO headquarters at 10:30am lead by LCSO escort, including LCSO, South Trail Fire & Rescue, Rolling Thunder Motorcycle Riders via Six Mile Cypress Pkwy east to Metro Pkwy north to Daniels Pkwy east to Jet Blue Park. Upon arrival the panels will be unloaded and the memorial wall set up with the Blessing of Wall in the afternoon. The Memorial will be on display to the public at no charge Thursday and Friday 9am to 5pm. A dedication ceremony will take place Saturday at 10am including the LCSO Honor Guard, Guns & Hoses Bag Pipe Band, South Trail Fire & Rescue, Guest Speaker and Dignitaries to commemorate the 50th Anniversary of the end of the Vietnam War on March 29, 1975. The ceremony will conclude with a final Blessing of the memorials honoring all of the Fallen Heroes. The exhibit will close at 5pm.
Hours of Operation:	9AM to 5PM
STRAP # of Parcel:	24-45-25-02-00006.0000
Owner of Premises*:	Lee County

\*Notarized statement from the property owner specifically consenting to the proposed use required.



## Lee County Event Permit Application



What is the Zoning Classification of the premises? Lee County/Government Property

Are any temporary structures to be installed for the event? ☒ Yes ☐ No Type: replica wall panels

Do you have the appropriate permits for the temporary structures? ☐ Yes ☐ No

\* For a 'Special Event' and 'Use of County Property' permit, submit a site plan with all proposed facilities and activities identified, including all parking areas.

Insurance Company Insuring the Event: Marsh & McLennan Agency

Note: Certificate of Insurance must be submitted at time of application

Surety Company Bonding this Event (Name and Address): see COI attached

Will Vehicles be Used as Part of This Event?

☐ Yes ☒ No

If yes, automobile coverage must be included on the certificate of insurance.

Will Food be Available at this Event?

☐ Yes ☒ No

If yes, products liability coverage must be included on the certificate of insurance.

Will Alcoholic Beverages be served/consumed at this Event?

☐ Yes ☒ No

If yes, liquor liability coverage must be included on the certificate of insurance.

Name & Address of Organization Providing Food: n/a

Type of Food being Served: n/a

### Section II - USE OF COUNTY PROPERTY PERMIT

Organization Sponsoring the Event: Hope Hospice & Community Services, Inc.

### Section III - SALE/CONSUMPTION OF ALCHOLIC BEVERAGES PERMIT

Is alcohol being sold/consumed on County Property? Yes ☒ No

If Yes, then a "Lee County Alcohol Permit" is required. Only non-profit organizations can sell alcohol on County Property.

Non-profit certificate/registration number:

(Required if alcohol is to be **SOLD** at the event)

**Please note:** A permit from the State of Florida Division of Alcoholic Beverages and Tobacco may also be required; please call (239) 344-0885 for further details



# Lee County Event Permit Application



Type of Production (choose all that apply):

<input type="checkbox"/> TV Movie or Special	<input type="checkbox"/> TV Series / Pilot	<input type="checkbox"/> TV Commercial	<input type="checkbox"/> Still Photos
<input type="checkbox"/> Public Service Announcement	<input type="checkbox"/> Industrial / Documentary	<input type="checkbox"/> Other: _____	

Will any of the following be needed or included\*?

Street Closure	<input type="checkbox"/> Yes	<input checked="" type="checkbox"/> No
Traffic / Crowd Control	<input type="checkbox"/> Yes	<input checked="" type="checkbox"/> No
Fire or Burning	<input type="checkbox"/> Yes	<input checked="" type="checkbox"/> No
Explosives or Pyrotechnics	<input type="checkbox"/> Yes	<input checked="" type="checkbox"/> No
Animals, Large or Small	<input type="checkbox"/> Yes	<input checked="" type="checkbox"/> No
Construction of Any Kind	<input type="checkbox"/> Yes	<input checked="" type="checkbox"/> No
Large and/or Numerous Vehicles	<input type="checkbox"/> Yes	<input checked="" type="checkbox"/> No
Helicopters, Boats, etc.	<input type="checkbox"/> Yes	<input checked="" type="checkbox"/> No
Stunts	<input type="checkbox"/> Yes	<input checked="" type="checkbox"/> No
Other	<input type="checkbox"/> Yes	<input checked="" type="checkbox"/> No

\* For any marked Yes, provide further details below:

Special Parking Requirements:

n/a

City or County Services Required: (Personnel, equipment, facilities, etc.)

Use of restroom facilities and soccer field to display the memorial wall exhibit.

The following information is required for local and state records on production in Florida to track the economic impact of the industry. If exact figures are not available, please estimate as closely as possible.

Number in Cast: _____	Number in Crew: <u>6</u>	Number of locals hired: <u>volunteers</u>
Total budget: <u>\$20,000.00</u>	Estimate amount spent in Lee County: <u>\$10,000.00</u>	
Hotel room nights: <u>24</u> <small>number of rooms x number of nights</small>	Number of shooting days: <u>6</u>	

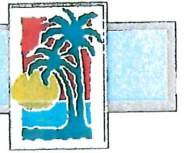

## **SECTION I - SAFETY**

The Applicant agrees to provide adequate traffic and crowd control, emergency medical services and any other items, at the Applicant's expense, required by Lee County to protect the health, safety and welfare of the public. Lee County shall have the power to review the proposal and require, as necessary, detailed plans, diagrams, and explanations to clearly outline to Lee County, exactly what the Applicant is proposing.

## **SECTION II - INSURANCE**

The Applicant, at its sole expense, agrees to procure and maintain in force during the entire term of the application, liability insurance in the amounts determined by Lee County Risk Management to protect against damages or other claims arising from use of County property by the applicant or its guests. Other limits may also be established by Lee County Risk Management for events which will be serving or consuming alcoholic beverages at approved County property. The insurance policy must also include coverage for Applicant's contingent liability on damages, claims or losses. "Lee County Board of County Commissioners" must be named as "additional insured" on the Certificate of Insurance, and the Certificate must be delivered to Lee County prior to Applicant's use of the property. The Insurance may not be canceled during the term of the event, if this occurs, the County has the right to revoke approvals related to use of the County property for the event, without recourse by the applicant.

## **SECTION III - INDEMNIFICATION**

The Applicant agrees to indemnify, release and save harmless Lee County against any and all claims, costs, demands, damages, judgments or injuries of any nature arising from the conduct or management of, or from any work or thing whatsoever done in or about said Lee County property or any building or structure appurtenant thereto or equipment thereof during the term of this Permit, or arising during such term from any act of negligence of the Applicant, Applicant's agents, contractors, or employees, or arising from any accident, injury, or damage whatsoever, however caused, to any person or persons, or to any property of any person, persons, corporation or corporations, occurring during the term of this agreement on, in, or about said Lee County property, and from and against all costs, attorney's fees, expenses and liabilities occurring in connection with any such claim or any action or proceeding brought thereon.

For film permit applicants: The permittee shall have on-site a responsible representative empowered with authority over the filming director, filming crews, participants and filming operation. Permittee shall indemnify, defend and hold harmless the county, its officers, agents and employees from and against all claims, suits, actions, damages, liabilities, expenditures or causes of action of any kind arising out of or occurring during the activities of the permittee, and resulting or occurring from any negligent act, omission or error of permittee, resulting in or relating to injuries to body, life, limb or property sustained in, about or upon the permitted premises or improvement thereto, or arising from the use of the premises.

## **SECTION IV - DELIVERY, ACCEPTANCE AND SURRENDER OF PREMISES**

The Applicant agrees to accept the County property on possession as being in a satisfactory state of repair and in sanitary condition.

The Applicant must surrender the premises to Lee County in the same condition as when Applicant takes possession, allowing for reasonable use and wear, and damage by acts of God. Applicant agrees to remove all business signs or symbols placed on the premises by the Applicant before redelivery of the premises to Lee County, and restore the premises to the condition in which it existed before their placement. Any signs and markings created or used in connection with this event must be temporary and removable; painting roadways, trees or any other fixed object is strictly prohibited. Applicant agrees to clear the Lee County property of litter at the close of the event.



## Lee County Event Permit Application



### SECTION V - AGREEMENT

The Applicant agrees that Lee County can, at its sole discretion, terminate and cancel its permit to use Lee County property at any time without prejudice. Applicant further agrees to waive, release, save and hold harmless Lee County from any and all claims, demands or cause of actions based upon Lee County's cancellation or termination of said permit.

The Applicant agrees that the Lee County permit does not provide Applicant with any property rights in the County property in question or in the permit itself.

The applicant does acknowledge and hereby affirms that any and all information is accurate to the best of his/her knowledge.

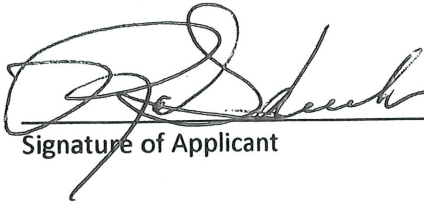
  
Signature of Applicant

Bob Sheehan, Director of Community Engagement

Print Name of Applicant and Title

  
Witness

  
Print Name of Witness

  
Date

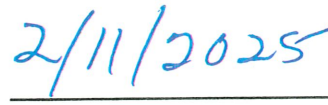
  
Date



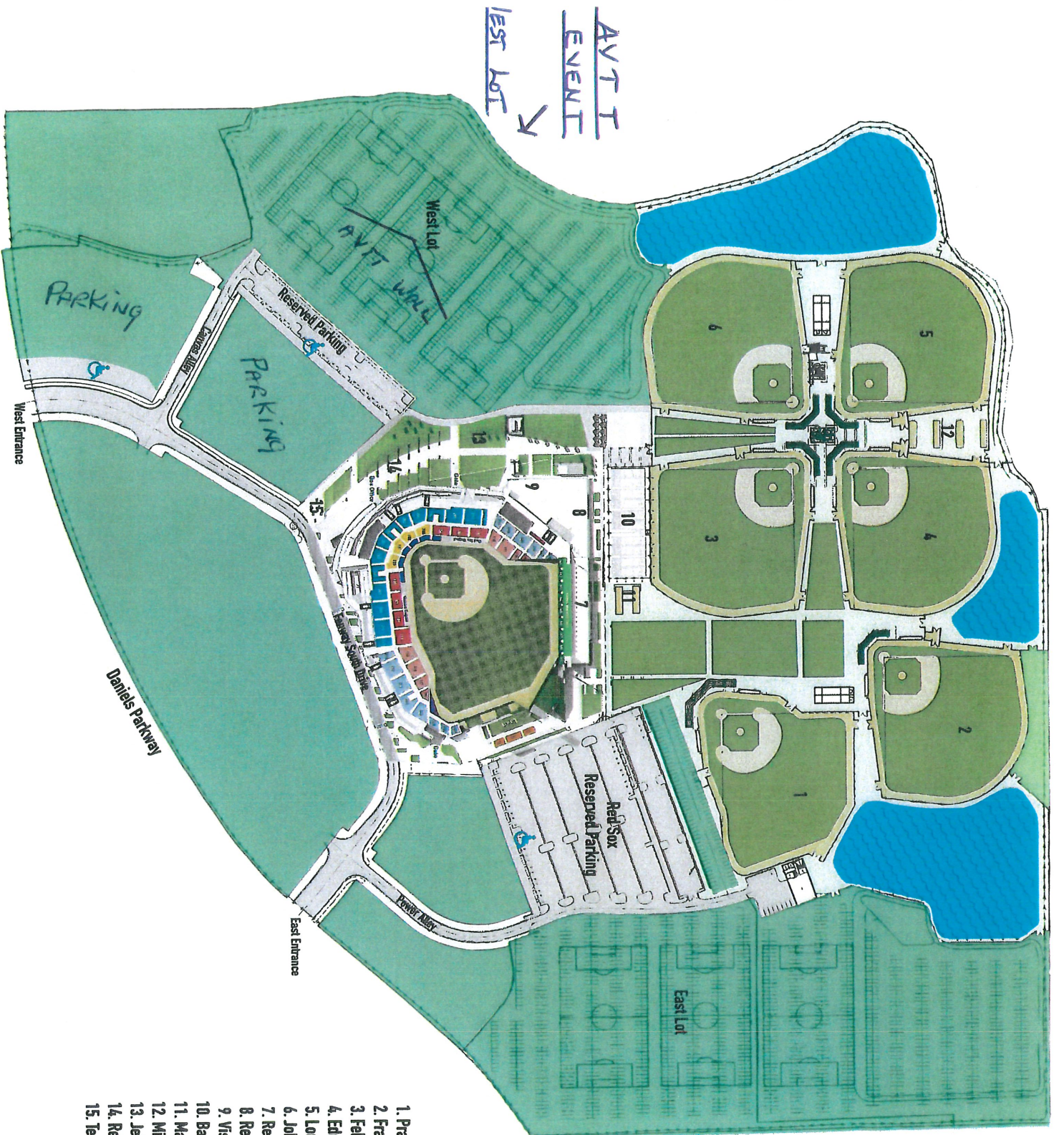

**LEGEND**

1. Practice Field #1
2. Frank Malzone Field
3. Felix Maldonado Field (Practice Field #3)
4. Eddie Popowski Field (Practice Field #4)
5. Lou Gorman Field (Practice Field #5)
6. Johnny Pesky Field (Practice Field #6)
7. Red Sox Major League Clubhouse
8. Red Sox Minor League Clubhouse
9. Visitors Locker Room
10. Batting Cages
11. Major League Pitching Mounds
12. Minor League Pitching Mounds
13. JetBlue Tail Fin Sun Dial
14. Red Sox Retired Numbers
15. Ted Williams Statue



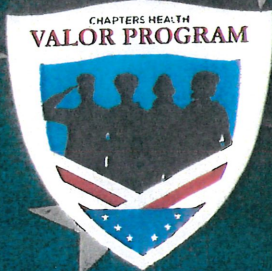

# AMERICAN VETERANS TRAVELING TRIBUTE



Open  
to the  
public

**MARCH 25-29, 2025**

**JETBLUE PARK**

**11581 DANIELS PKWY, FORT MYERS | OPEN 9AM-5:30PM**

**A FREE 5-day  
Celebration  
of Service!**



**Daily viewing  
open to  
the public**



**Family  
friendly  
event!**

**View an 80% scale replica of the Vietnam Veterans Memorial  
in Washington D.C., plus individual tributes for every U.S.-involved  
conflict since WWI including a special 9/11 memorial.**

**Field trips and  
large groups  
welcome**



**Sponsorship  
opportunities  
available**



**Support our  
mission as a  
volunteer**

Scan this QR code  
for programming,  
guest speakers, and  
sponsorship details!



**HOPE  
HOSPICE**  
A Chapters Health® Affiliate  
Licensed Since 1984



**CHAPTERS  
HEALTH®**  
Foundation  
In Support of Hope Hospice

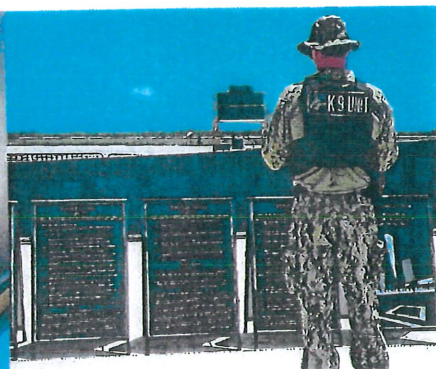
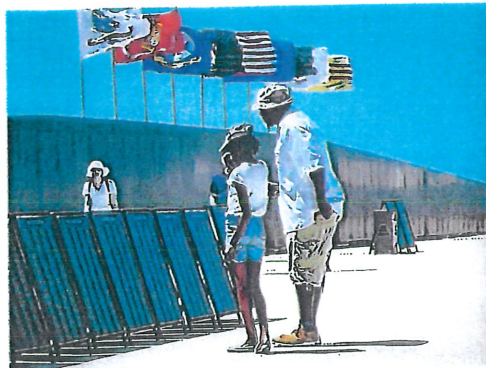

**For detailed information contact Bob Sheehan  
(239) 489-9188 | [SheehanB@chaptershealth.org](mailto:SheehanB@chaptershealth.org)**

Lee County Event Permit Application



LEE COUNTY SHERIFF'S DEPARTMENT  
14750 SIX MILE CYPRESS PARKWAY  
FORT MYERS, FLORIDA 33912  
(239) 477-1199

Check the appropriate box(es) below:

- ☒ SPECIAL EVENT PERMIT  
☒ USE OF COUNTY PROPERTY PERMIT  
☐ PERMIT TO SELL AND CONSUME ALCOHOLIC BEVERAGES WITHIN LEE COUNTY FACILITIES  
☐ FILM PERMIT

AFTER REVIEWING THE APPLICATION, PLEASE INDICATE BELOW WHAT ARRANGEMENTS YOUR ORGANIZATION WILL REQUIRE THE APPLICANT TO COMPLY WITH FOR THEIR EVENT.

Parking:

All parking for event will be on site and in authorized areas only. It is understood through this application process that volunteers will be handling all parking. Anyone handling parking must use proper safety equipment while parking vehicles to include safety vests and flags.

Deputies (How Many?):

As a condition of the use of the property, overnight security will be required. Extra duty detail deputies will need to be scheduled nightly while event area is set up.

Fee for Services:

Contact Details Unit 239-477-1171 for further information.

Special Arrangements:

If there is amplified sound, it must adhere to the Lee County Noise Ordinances.

Print Name:

P. Cummins

Signature:

[Handwritten Signature]

Title:

Support Services

Date:

2 28 25



## Lee County Event Permit Application



### FIRE DEPARTMENT

*The Fire Department serving the area where the event is to be held signs this form.  
Please see User's Guide for contact information and Fire District Map.*

*Check the appropriate box(es) below:*

- ☒ SPECIAL EVENT PERMIT  
☒ USE OF COUNTY PROPERTY PERMIT  
☐ FILM PERMIT

AFTER REVIEWING THE APPLICATION, PLEASE INDICATE BELOW WHAT ARRANGEMENTS YOUR ORGANIZATION WILL REQUIRE THE APPLICANT TO COMPLY WITH FOR THEIR EVENT.

Fire Guards (How Many?)

N/A

Fee for Services:

PAID

Flammable Vegetation:

N/A

First Aid Equipment:

CALL 911 IF NEEDED

Fire Extinguishing:

N/A

Special Arrangements:

N/A

Print Name: Nate Burley

Signature: **Nate Burley**

Digitally signed by Nate Burley  
Date: 2025.03.03 08:10:28 -05'00'

Title: Division Chief - Fire & Life Safety

Date: March 3, 2025

## Lee County Event Permit Application



**EMERGENCY MEDICAL SERVICES / PUBLIC SAFETY**  
**2000 Main St., Suite #100**  
**FORT MYERS, FL 33901**  
**(239) 533-3911**

Check the appropriate box(es) below:

- ☐ SPECIAL EVENT PERMIT  
☒ USE OF COUNTY PROPERTY PERMIT  
☐ PERMIT TO SELL AND CONSUME ALCOHOLIC BEVERAGES WITHIN LEE COUNTY FACILITIES  
☐ FILM PERMIT

AFTER REVIEWING THE APPLICATION, PLEASE INDICATE BELOW WHAT ARRANGEMENTS YOUR ORGANIZATION WILL REQUIRE THE APPLICANT TO COMPLY WITH FOR THEIR EVENT.

Treatment Facilities:

None necessary.

Medical Personnel:

None necessary.

Medical Supplies /  
Equipment:

None necessary.

Safety Requirements:

Applicants shall follow all CDC and FDOH directives, and the Florida Governor's Executive Orders concerning health and safety.

Fee for Services

Not applicable.

Special Arrangements:

Please call 911 in the event of an emergency. To arrange special event coverage, contact our office at EMSDetail@leegov.com.

Print Name: Douglas B. Higgins

Signature:

Digitally signed by Captain Douglas B.  
Higgins  
Date: 2025.02.18 17:52:07 -05'00'

Title:

Captain, EMS Operations

Date:

February 18, 2025



## Lee County Event Permit Application



DEPARTMENT OF TRANSPORTATION  
1500 MONROE STREET  
FORT MYERS, FL 33901  
(239) 533-8580

Check the appropriate box(es) below:

- ☒ SPECIAL EVENT PERMIT  
☐ USE OF COUNTY PROPERTY PERMIT  
☐ PERMIT TO SELL AND CONSUME ALCOHOLIC BEVERAGES WITHIN LEE COUNTY FACILITIES  
☐ FILM PERMIT

AFTER REVIEWING THE APPLICATION, PLEASE INDICATE BELOW WHAT ARRANGEMENTS YOUR ORGANIZATION WILL REQUIRE THE APPLICANT TO COMPLY WITH FOR THEIR EVENT.

Parking:

No event parking is permitted in Lee County maintained road right of ways.

Ingress and Egress:

Please use all established means of ingress and egress.

Special Arrangements:

Shall use Lee County Sheriff's Office for assistance with traffic control as needed.  
Emergency vehicle access and public vehicular access shall be maintained on all surrounding Lee County maintained roads.

Print Name: Nathan Thoman

Signature: Nathaniel C. Thoman

Digitally signed by Nathaniel C. Thoman  
Date: 2025.02.26 07:52:36 -05'00'

Title: Project Manager

Date: 02/26/2025

Lee County Event Permit Application



LEE COUNTY PARKS AND RECREATION  
3410 PALM BEACH BOULEVARD  
FORT MYERS, FLORIDA 33916  
(239) 533-7275

Check the appropriate box(es) below:

- ☒ SPECIAL EVENT PERMIT  
☒ USE OF COUNTY PROPERTY PERMIT  
☐ PERMIT TO SELL AND CONSUME ALCOHOLIC BEVERAGES WITHIN LEE COUNTY FACILITIES  
☐ FILM PERMIT

AFTER REVIEWING THE APPLICATION, PLEASE INDICATE BELOW WHAT ARRANGEMENTS YOUR ORGANIZATION WILL REQUIRE THE APPLICANT TO COMPLY WITH FOR THEIR EVENT.

Illumination:

All illuminations must follow county ordinance and FAA regulations. Event organizer must provide their own temporary lighting as needed for safety during event set up and breakdown.

Parking Areas:

Event organizer is responsible to direct patrons to the designated parking locations. Must work with on-site staff to ensure that vehicles do not block driveways and private roadways so emergency vehicles have clear access. Organizer must provide adequate staff/volunteers along with directional signage for the event.

Special Arrangements:

Event organizer is responsible to provide adequate staff/volunteers throughout the event for litter control and debris clean up during and after the event. Work with Red Sox staff and the on-site park staff to designate the debris/trash collection area during and after the event.

Participants and spectators must disperse and leave the park area to seek safe shelter in their vehicles during lightning alerts and threatening weather.

Print Name: Colleen Via

Signature:

*Colleen Via*

Title:

Countywide Service Manager

Date:

2/27/2025

*Jet Blue - American Veterans Traveling Tribute*

*3/26 - 3/29/2025*



## Lee County Event Permit Application



LEE COUNTY RISK MANAGEMENT  
COUNTY ADMINISTRATION BUILDING - 4<sup>TH</sup> FLOOR  
2115 SECOND STREET  
FORT MYERS, FLORIDA 33901  
(239) 533-2221

Check the appropriate box(es) below:

- ☒ SPECIAL EVENT PERMIT  
☒ USE OF COUNTY PROPERTY PERMIT  
☐ PERMIT TO SELL AND CONSUME ALCOHOLIC BEVERAGES WITHIN LEE COUNTY FACILITIES  
☐ FILM PERMIT

AFTER REVIEWING THE APPLICATION, PLEASE INDICATE BELOW WHAT ARRANGEMENTS YOUR ORGANIZATION WILL REQUIRE THE APPLICANT TO COMPLY WITH FOR THEIR EVENT.

Insurance Requirements: Commercial general liability insurance with minimum limits of One Million Dollars (\$1,000,000) per occurrence to protect against bodily injury and/or property damage relative to applicants use of aforementioned event within Lee County.

Certificate Must Read As:

Lee County, a political subdivision and Charter County of the State of Florida, its agents, employees, and public officials are automatic additional insureds and includes an automatic waiver of subrogation with regard to general liability. The certificate holder is an additional insured on a primary and noncontributory basis with regards to general liability.

Special Arrangements: A Certificate of Insurance shall be submitted as evidence of the required coverage listing Lee County, a political subdivision and Charter County of the State of Florida, P.O. Box 398, Fort Myers, FL 33902 as the certificate holder and as an additional insured as listed above.

Subject to proof of insurance.

Print Name: Mike Figueroa

Signature:

Title:

Risk Program Manager

Date:

February 28, 2025



# CERTIFICATE OF LIABILITY INSURANCE

DATE (MM/DD/YYYY)

2/20/2025

THIS CERTIFICATE IS ISSUED AS A MATTER OF INFORMATION ONLY AND CONFERS NO RIGHTS UPON THE CERTIFICATE HOLDER. THIS CERTIFICATE DOES NOT AFFIRMATIVELY OR NEGATIVELY AMEND, EXTEND OR ALTER THE COVERAGE AFFORDED BY THE POLICIES BELOW. THIS CERTIFICATE OF INSURANCE DOES NOT CONSTITUTE A CONTRACT BETWEEN THE ISSUING INSURER(S), AUTHORIZED REPRESENTATIVE OR PRODUCER, AND THE CERTIFICATE HOLDER.

IMPORTANT: If the certificate holder is an ADDITIONAL INSURED, the policy(ies) must have ADDITIONAL INSURED provisions or be endorsed. If SUBROGATION IS WAIVED, subject to the terms and conditions of the policy, certain policies may require an endorsement. A statement on this certificate does not confer rights to the certificate holder in lieu of such endorsement(s).

<b>PRODUCER</b> Marsh & McLennan Agency LLC 110 Franklin Road SE Roanoke VA 24011	<b>CONTACT NAME:</b> <b>PHONE (A/C, No, Ext):</b> 800-283-1478 <b>FAX (A/C, No):</b> <b>E-MAIL ADDRESS:</b> certificates@MarshMMA.com
<b>INSURED</b> Hope Hospice and Community Services, Inc. 27200 Imperial Parkway Bonita Springs FL 34135	<b>INSURER(S) AFFORDING COVERAGE</b> <b>INSURER A:</b> Coverys Specialty Insurance Company <b>INSURER B:</b> Zurich American Ins Co of Illinois <b>INSURER C:</b> <b>INSURER D:</b> <b>INSURER E:</b> <b>INSURER F:</b>

**COVERAGES**

CERTIFICATE NUMBER: 647318219

REVISION NUMBER:

THIS IS TO CERTIFY THAT THE POLICIES OF INSURANCE LISTED BELOW HAVE BEEN ISSUED TO THE INSURED NAMED ABOVE FOR THE POLICY PERIOD INDICATED. NOTWITHSTANDING ANY REQUIREMENT, TERM OR CONDITION OF ANY CONTRACT OR OTHER DOCUMENT WITH RESPECT TO WHICH THIS CERTIFICATE MAY BE ISSUED OR MAY PERTAIN, THE INSURANCE AFFORDED BY THE POLICIES DESCRIBED HEREIN IS SUBJECT TO ALL THE TERMS, EXCLUSIONS AND CONDITIONS OF SUCH POLICIES. LIMITS SHOWN MAY HAVE BEEN REDUCED BY PAID CLAIMS.

INSR LTR	TYPE OF INSURANCE	ADDL INSD	SUBR WVD	POLICY NUMBER	POLICY EFF (MM/DD/YYYY)	POLICY EXP (MM/DD/YYYY)	LIMITS
A	<input checked="" type="checkbox"/> COMMERCIAL GENERAL LIABILITY <input type="checkbox"/> CLAIMS-MADE <input type="checkbox"/> OCCUR 10,000 GEN'L AGGREGATE LIMIT APPLIES PER: <input checked="" type="checkbox"/> POLICY <input type="checkbox"/> PRO-JECT <input type="checkbox"/> LOC OTHER:	Y		005FL000030392	2/17/2025	3/1/2026	EACH OCCURRENCE \$ 1,000,000 DAMAGE TO RENTED PREMISES (Ea occurrence) \$ 50,000 MED EXP (Any one person) \$ 5,000 PERSONAL & ADV INJURY \$ 1,000,000 GENERAL AGGREGATE \$ 3,000,000 PRODUCTS - COMP/OP AGG \$ 3,000,000 \$
B	<input type="checkbox"/> AUTOMOBILE LIABILITY <input type="checkbox"/> ANY AUTO <input type="checkbox"/> OWNED AUTOS ONLY <input type="checkbox"/> HIRED AUTOS ONLY <input checked="" type="checkbox"/> SCHEDULED AUTOS <input type="checkbox"/> NON-OWNED AUTOS ONLY			PRA594778210	2/17/2024	3/1/2025	COMBINED SINGLE LIMIT (Ea accident) \$ 1,000,000 BODILY INJURY (Per person) \$ BODILY INJURY (Per accident) \$ PROPERTY DAMAGE (Per accident) \$ \$
A	<input checked="" type="checkbox"/> UMBRELLA LIAB <input checked="" type="checkbox"/> EXCESS LIAB <input type="checkbox"/> DED <input type="checkbox"/> RETENTION \$ <input checked="" type="checkbox"/> OCCUR <input type="checkbox"/> CLAIMS-MADE			005FL000030392	2/17/2025	3/1/2026	EACH OCCURRENCE \$ 5,000,000 AGGREGATE \$ 5,000,000 \$
	<b>WORKERS COMPENSATION AND EMPLOYERS' LIABILITY</b> ANY PROPRIETOR/PARTNER/EXECUTIVE OFFICER/MEMBER EXCLUDED? (Mandatory in NH) If yes, describe under DESCRIPTION OF OPERATIONS below	Y/N	N/A				PER STATUTE <input type="checkbox"/> OTH-ER <input type="checkbox"/> E.L. EACH ACCIDENT \$ E.L. DISEASE - EA EMPLOYEE \$ E.L. DISEASE - POLICY LIMIT \$
A	Healthcare Professional Liability	Y		005FL000030392	2/17/2025	3/1/2026	Aggregate Limit \$3,000,000 Occurrence Limit \$1,000,000

DESCRIPTION OF OPERATIONS / LOCATIONS / VEHICLES (ACORD 101, Additional Remarks Schedule, may be attached if more space is required)

Boston Red Sox Baseball Club Limited Partnership; New England Sports Ventures LLC; Fenway Sports Group, LLC; N.E.S.V. II, LLC; N.E.S.V. IV, LLC; NESV Florida Real Estate, LLC; and Lee County Board of County Commissioners are listed as Additional Insured under the General Liability as per written contract.

OK 02/28/2025

**CERTIFICATE HOLDER****CANCELLATION**

The Lee County Board of Commissioners  
2115 Second Street  
Fort Myers FL 33901

SHOULD ANY OF THE ABOVE DESCRIBED POLICIES BE CANCELLED BEFORE THE EXPIRATION DATE THEREOF, NOTICE WILL BE DELIVERED IN ACCORDANCE WITH THE POLICY PROVISIONS.

AUTHORIZED REPRESENTATIVE

© 1988-2015 ACORD CORPORATION. All rights reserved.

ACORD 25 (2016/03)

The ACORD name and logo are registered marks of ACORD