

LEE COUNTY
 DEPARTMENT OF TRANSPORTATION
CONTRACT PLANS

FINANCIAL PROJECT ID 442123-1-58-01
 (FEDERAL FUNDS)

BUCKINGHAM RD AND GUNNERY RD ROUNDABOUT - LAP

LANDSCAPE PLANS

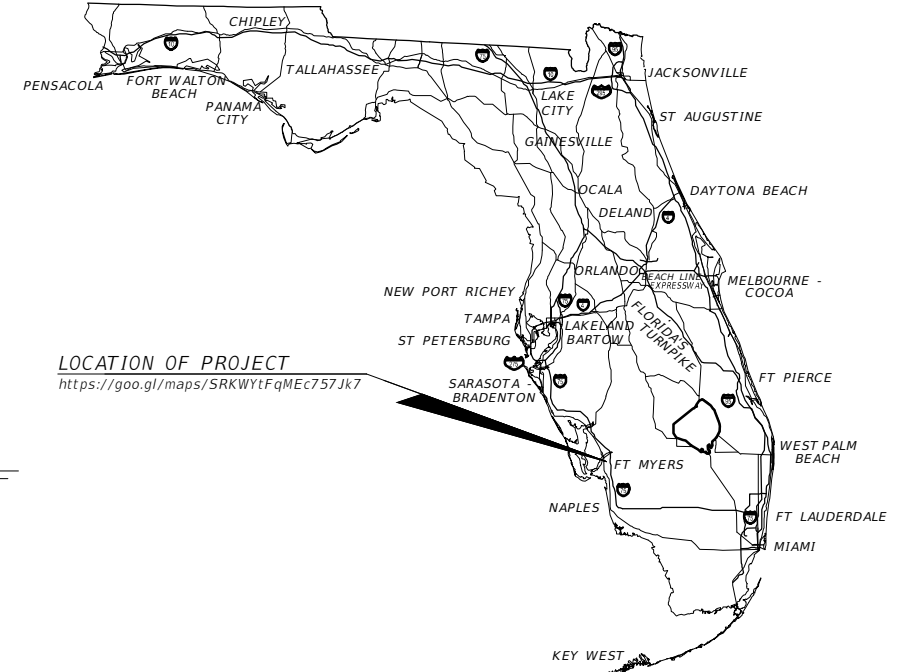

LOCATION OF PROJECT
<https://goo.gl/maps/SRKWYtFqMEc757Jk7>

INDEX OF LANDSCAPING PLANS

SHEET NO.	SHEET DESCRIPTION
LD-1	KEY SHEET
LD-2	PROJECT LAYOUT
LD-3	GENERAL NOTES & MAINTENANCE NOTES
LD-4	LANDSCAPE PLAN (1)
LD-5	LANDSCAPE PLAN (2)
LD-6	LANDSCAPE PLAN (3)
LD-7	LANDSCAPE PLAN (4)
LD-8	LANDSCAPE DETAILS (1)
LD-9	LANDSCAPE DETAILS (2)
LD-10	TABULATION OF QUANTITIES AND PLANT SCHEDULE

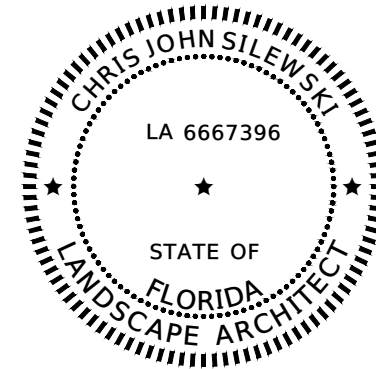

THE SEAL APPEARING ON THIS DOCUMENT WAS AUTHORIZED BY:

PRINTED COPIES OF THIS DOCUMENT ARE NOT CONSIDERED SIGNED AND SEALED AND THE SIGNATURE MUST BE VERIFIED ON ANY ELECTRONIC COPIES.

**LANDSCAPING PLANS
 LANDSCAPE ARCHITECT OF RECORD:**

CHRIS JOHN SILEWSKI, PLA.
 L.A. LICENSE NUMBER 6667396
 AYRES ASSOCIATES
 8875 HIDDEN RIVER PKWY., SUITE 200
 TAMPA, FL 33637
 813-978-8688

LCDOT PROJECT MANAGER:
 KEITH RIDDLE, CGC _____

CONSTRUCTION CONTRACT NO.	FISCAL YEAR	SHEET NO.
	24	LD-1

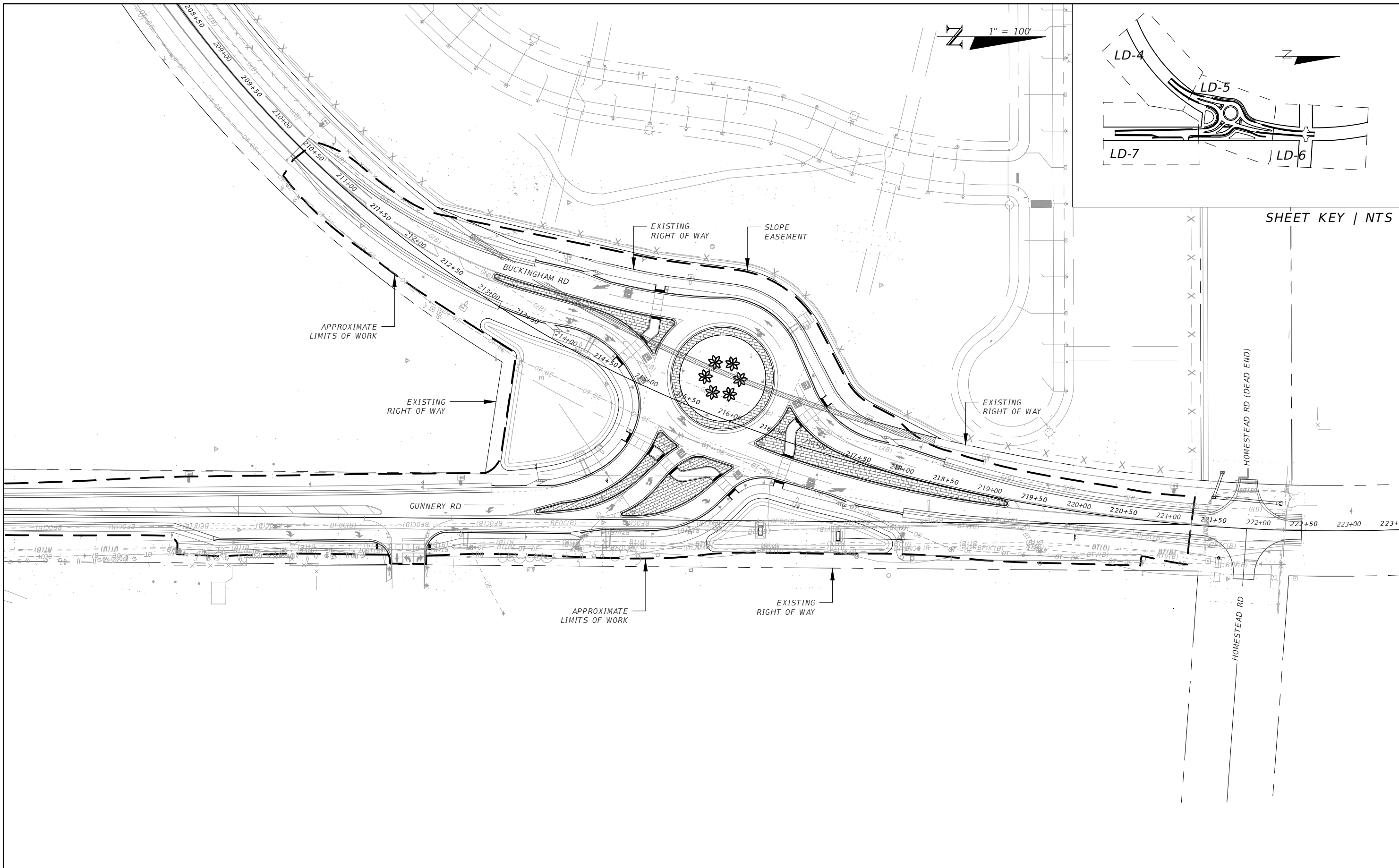

1" = 100'

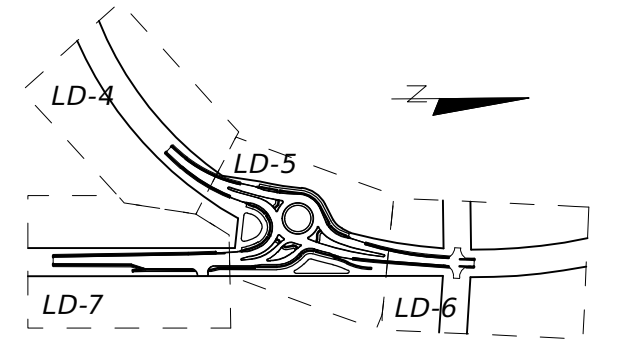

SHEET KEY | NTS

REVISIONS			
DATE	DESCRIPTION	DATE	DESCRIPTION
---	---	---	---

CHRIS JOHN SILEWSKI, PLA
L.A. LICENSE NUMBER 6667396
AYRES
8875 HIDDEN RIVER PKWY,
SUITE 200
TAMPA, FL 33637



BUCKINGHAM RD AND GUNNERY RD
ROUNDBOUT
FINANCIAL PROJECT ID
442123-1-58-01

**PROJECT LAYOUT
BUCKINGHAM RD AND
GUNNERY RD ROUNDBOUT**

SHEET NO.
LD-2

THE OFFICIAL RECORD OF THIS SHEET IS THE ELECTRONIC FILE DIGITALLY SIGNED AND SEALED UNDER RULE 61G10-11.011, F.A.C.

GENERAL LANDSCAPE NOTES

1. Roadway design speed planting limits are based on existing project design speed and required setbacks as found in FDOT Design Manual and FDOT Standard Plans:
2. Criteria based on the FDOT 2024-2025 design manual and the 2011 AASHTO "Green Book".
3. No vegetation shall be placed in a manner where by official departmental traffic control signing would be discerned as being screened.
4. Prior to submission of bid, the contractor shall visit the site and fully inform themselves of the conditions, under which the work is to be accomplished.
5. The contractor to verify all utility locations, paving, and elevations, prior to start of work. Notify Lee County, in writing, of unsatisfactory conditions prior to start of work. Start of work will indicate acceptance of conditions and full responsibility for completing work.
6. Verify underground and above ground utility locations prior to any excavation. If underground utilities or obstructions maybe and/or are encountered during excavation of planting areas or pits, immediately inform Lee County. Alternate locations will be selected by Lee County. Such changes in location should be made by the contractor without additional compensation.
7. The contractor will bear sole responsibility for any and all damages that results from activities or work due to improper verification of utilities and/or operator error.
8. No plant material substitution should be made on this project without explicit written approval from LCDOT.
9. Installation of palms and plants must not screen the vision of drivers and pedestrians, see FDOT FY2024-25 Standard Plans and Current Design Manual for Clear Site Limits or site visibility triangles at intersections. Coordinate so as not to obstruct the visibility of directional, informational, or traffic control signs as well as traffic signals. Field adjust Palms and Palm locations with Lee County construction representative as required to avoid conflict with light poles, sign supports, utility poles, walls and fences, etc.
10. Lee County construction representatives reserve the right to make minor adjustments, in the field, to the locations of palms and shrubs in ground covers. All areas with in the drip line of a protected tree should maintain their original grade and soil compaction.
11. The contractor shall be responsible for providing proper drainage for all palms and plant materials. Palms set too high or too low may be rejected. Verify proposed finish grades with Lee County and set palms accordingly.
12. The contractor shall be responsible for properly securing all palms and large shrubs immediately after planting. All guy wires shall be flagged, and all stakes shall be driven flush with surrounding grade for Public Safety.
13. Landscape contractor shall be responsible for maintaining and watering required for the establishment and proper maintenance of plant materials from the date of installation to the date of final warranty.
14. Bed lines shall have well-defined trench edges to contain mulch. Bed lines shall be laid out with string line for straight lines, curved bed edges are to be smooth and continues per plan layout. Palms or shrubs shown in a line on the plans shall have the trunks/canopies in proper alignment upon visual inspection after installation.
15. At the time of substantial approval the contractor shall provide Lee County, with a maintenance manual containing instructions for the proper care of all material specified to the job, and any pertinent manufactures literature to Lee County.
16. All landscape materials must be installed and maintained in accordance with FDOT Standard Plans, FDOT Design Manual and all other applicable FY2024-25 department standards, plans and regulations.
17. Application of herbicides shall be performed by a person possessing a current Florida Restricted Use Pesticide License in the Core Curriculum, right of way and aquatic categories.

REVISIONS				CHRIS JOHN SILEWSKI, PLA L.A. LICENSE NUMBER 6667396 AYRES 8875 HIDDEN RIVER PKWY, SUITE 200 TAMPA, FL 33637		BUCKINGHAM RD AND GUNNERY RD ROUNDABOUT FINANCIAL PROJECT ID 442123-1-58-01	GENERAL NOTES & MAINTENANCE NOTES BUCKINGHAM RD AND GUNNERY RD ROUNDABOUT	SHEET NO.
DATE	DESCRIPTION	DATE	DESCRIPTION					LD-3
---	---							

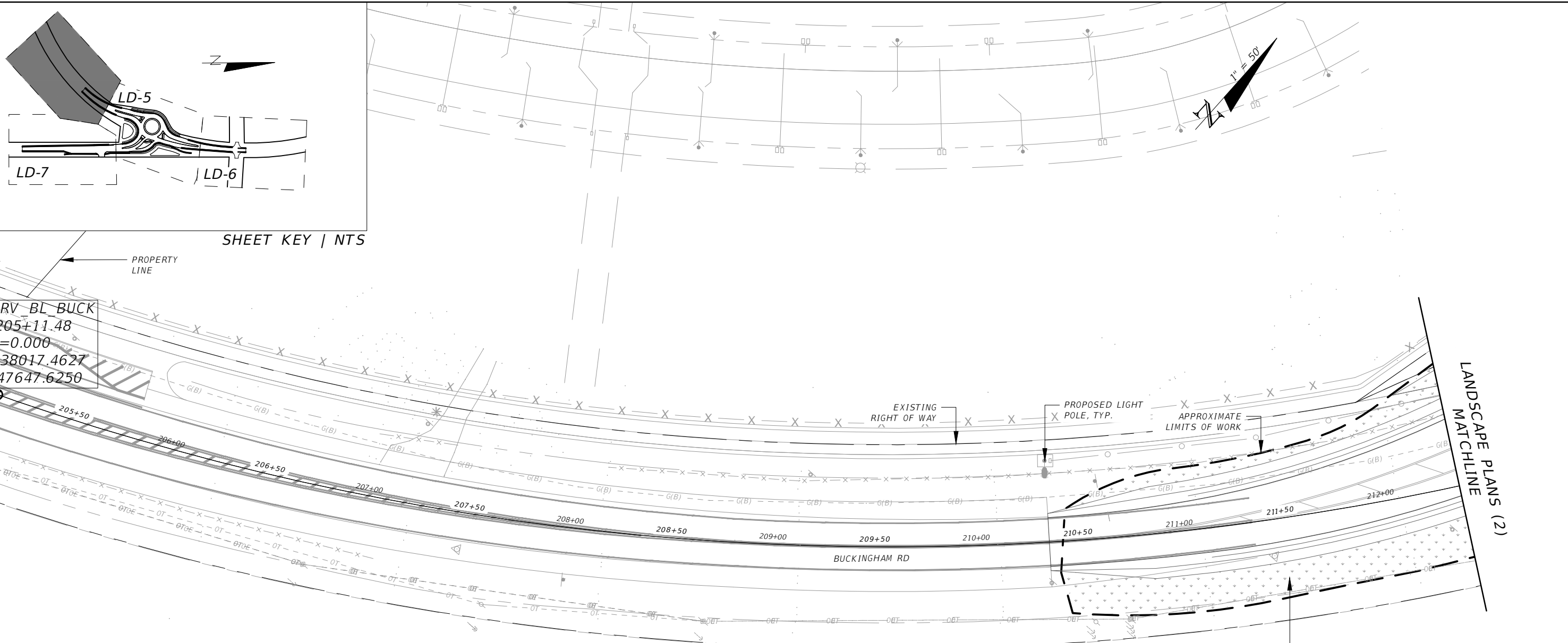

RV BL BUCK
 205+11.48
 =0.000
 38017.4627
 47647.6250

SHEET KEY | NTS

LANDSCAPE PLANS (2)
 MATCHLINE

TREE SCHEDULE

PALM TREES	BOTANICAL / COMMON NAME
PS	PHOENIX SYLVESTRIS / WILD DATE PALM

SHRUB SCHEDULE

SHRUBS	BOTANICAL / COMMON NAME
Se	SERENOA REPENS / SAW PALMETTO

PLANT SCHEDULE

GROUND COVERS	BOTANICAL / COMMON NAME
	BAHIA SOD

LEGEND

EXISTING RIGHT-OF-WAY	---
PROPOSED RIGHT-OF-WAY	---
APPROX. LIMITS OF WORK	---
EXISTING WATER MAIN	---W(D)---
EXISTING SANITARY	---S(D)---
EXISTING GAS	---G(D)---
EXISTING OVERHEAD TELEPHONE	---OT---
EXISTING BURIED TELEPHONE	---BT(D)---
EXISTING OVERHEAD ELECTRIC	---OE---
EXISTING BURIED ELECTRIC	---BE---
EXISTING BURIED FIBER OPTIC	---BF(D)---
EXISTING BURIED CABLE TV	---BTV(B)---
SHELL MULCH	[Symbol]

REVISIONS			
DATE	DESCRIPTION	DATE	DESCRIPTION

CHRIS JOHN SILEWSKI, PLA
 L.A. LICENSE NUMBER 6667396
 AYRES
 8875 HIDDEN RIVER PKWY,
 SUITE 200
 TAMPA, FL 33637



BUCKINGHAM RD AND GUNNERY RD
 ROUNDABOUT
 FINANCIAL PROJECT ID
 442123-1-58-01

LANDSCAPE PLANS (1)
BUCKINGHAM RD AND
GUNNERY RD ROUNDABOUT

SHEET NO.
 LD-4

THE OFFICIAL RECORD OF THIS SHEET IS THE ELECTRONIC FILE DIGITALLY SIGNED AND SEALED UNDER RULE 61G10-11.011, F.A.C.

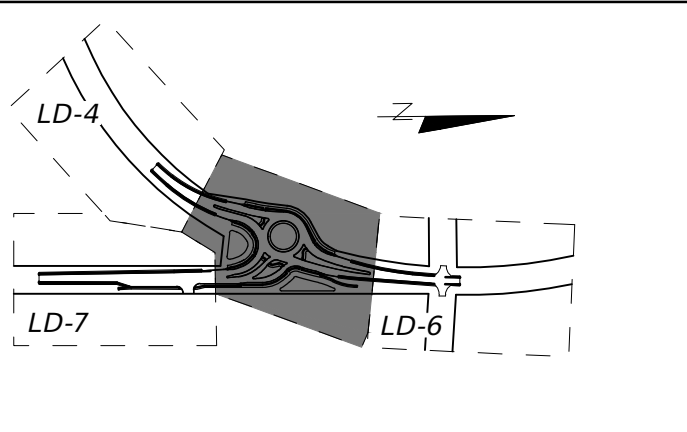

TREE SCHEDULE	
PALM TREES	BOTANICAL / COMMON NAME
PS	PHOENIX SYLVESTRIS / WILD DATE PALM

SHRUB SCHEDULE	
SHRUBS	BOTANICAL / COMMON NAME
Se	SERENOA REPENS / SAW PALMETTO

PLANT SCHEDULE	
GROUND COVERS	BOTANICAL / COMMON NAME
	BAHIA SOD

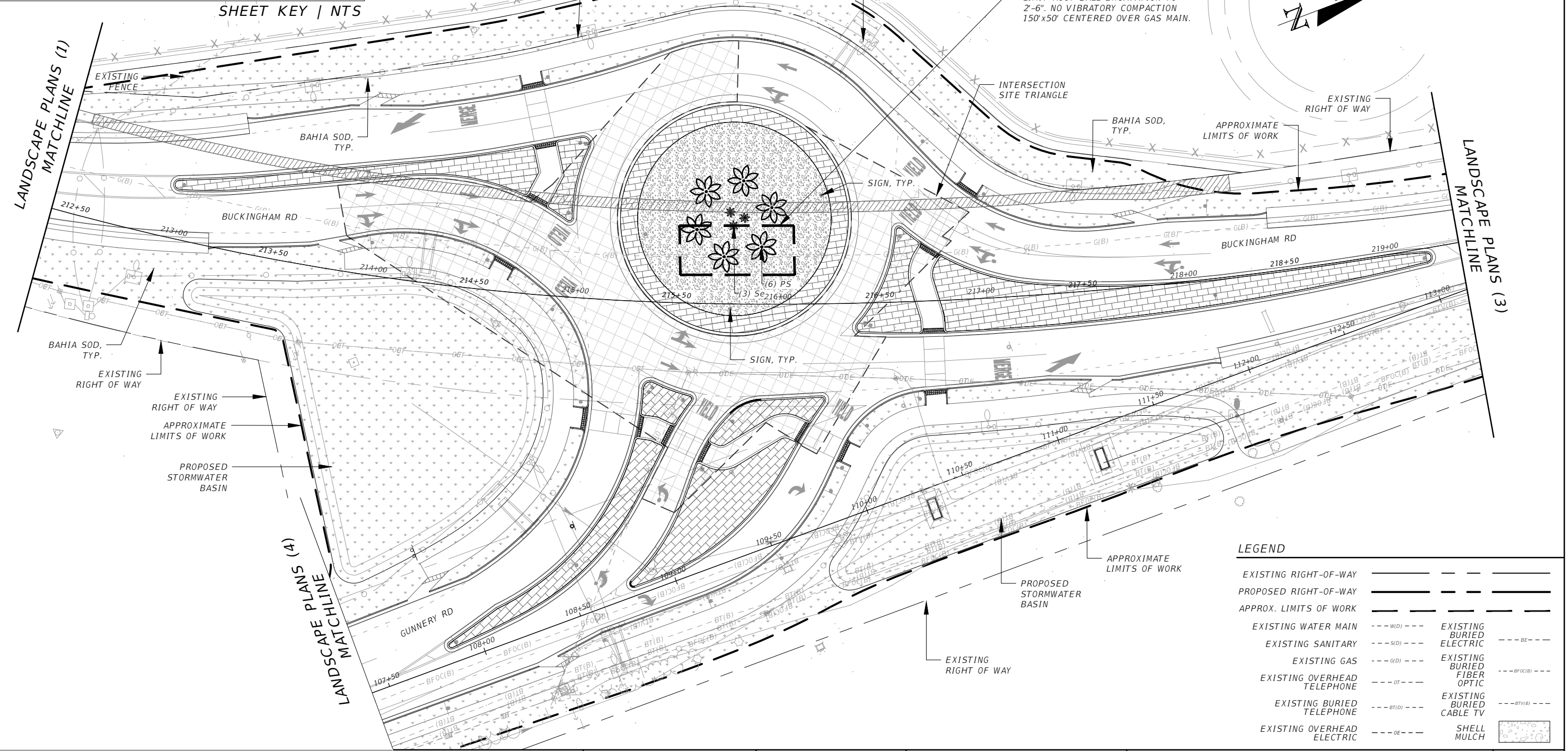

LEGEND

EXISTING RIGHT-OF-WAY	---
PROPOSED RIGHT-OF-WAY	---
APPROX. LIMITS OF WORK	---
EXISTING WATER MAIN	---W(D)---
EXISTING SANITARY	---S(D)---
EXISTING GAS	---G(D)---
EXISTING OVERHEAD TELEPHONE	---OT---
EXISTING BURIED TELEPHONE	---BT(D)---
EXISTING OVERHEAD ELECTRIC	---OE---
EXISTING BURIED ELECTRIC	---BE---
EXISTING BURIED FIBER OPTIC	---BFOC(B)---
EXISTING BURIED CABLE TV	---BTV(B)---
SHELL MULCH	[Symbol]

REVISIONS			
DATE	DESCRIPTION	DATE	DESCRIPTION

CHRIS JOHN SILEWSKI, PLA
 L.A. LICENSE NUMBER 6667396
 AYRES
 8875 HIDDEN RIVER PKWY,
 SUITE 200
 TAMPA, FL 33637



BUCKINGHAM RD AND GUNNERY RD
 ROUNDABOUT
 FINANCIAL PROJECT ID
 442123-1-58-01

**LANDSCAPE PLANS (2)
 BUCKINGHAM RD AND
 GUNNERY RD ROUNDABOUT**

SHEET NO.
 LD-5

THE OFFICIAL RECORD OF THIS SHEET IS THE ELECTRONIC FILE DIGITALLY SIGNED AND SEALED UNDER RULE 61G10-11.011, F.A.C.

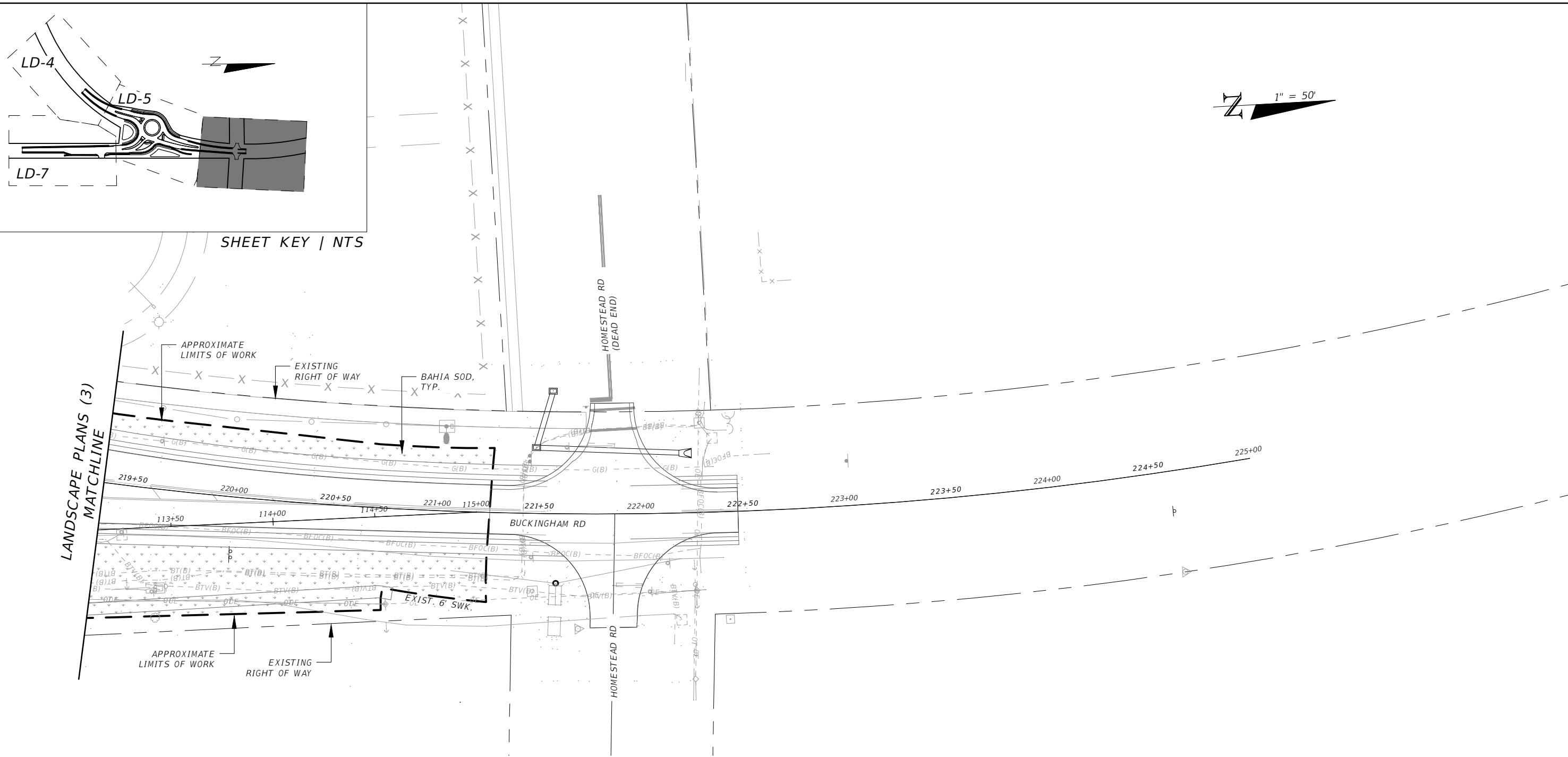

LANDSCAPE PLANS (3)
MATCHLINE

SHEET KEY | NTS

1" = 50'

TREE SCHEDULE	
PALM TREES	BOTANICAL / COMMON NAME
PS	PHOENIX SYLVESTRIS / WILD DATE PALM

SHRUB SCHEDULE	
SHRUBS	BOTANICAL / COMMON NAME
Se	SERENOA REPENS / SAW PALMETTO

PLANT SCHEDULE	
GROUND COVERS	BOTANICAL / COMMON NAME
	BAHIA SOD

LEGEND			
EXISTING RIGHT-OF-WAY	---		
PROPOSED RIGHT-OF-WAY	---		
APPROX. LIMITS OF WORK	---		
EXISTING WATER MAIN	---	EXISTING BURIED ELECTRIC	---
EXISTING SANITARY	---	EXISTING BURIED FIBER OPTIC	---
EXISTING GAS	---	EXISTING BURIED CABLE TV	---
EXISTING OVERHEAD TELEPHONE	---	SHELL MULCH	---
EXISTING BURIED TELEPHONE	---		
EXISTING OVERHEAD ELECTRIC	---		

REVISIONS			
DATE	DESCRIPTION	DATE	DESCRIPTION

CHRIS JOHN SILEWSKI, PLA
L.A. LICENSE NUMBER 6667396
AYRES
8875 HIDDEN RIVER PKWY,
SUITE 200
TAMPA, FL 33637



BUCKINGHAM RD AND GUNNERY RD
ROUNDAABOUT
FINANCIAL PROJECT ID
442123-1-58-01

LANDSCAPE PLANS (3)
BUCKINGHAM RD AND
GUNNERY RD ROUNDAABOUT

SHEET NO.
LD-6

THE OFFICIAL RECORD OF THIS SHEET IS THE ELECTRONIC FILE DIGITALLY SIGNED AND SEALED UNDER RULE 61G10-11.011, F.A.C.

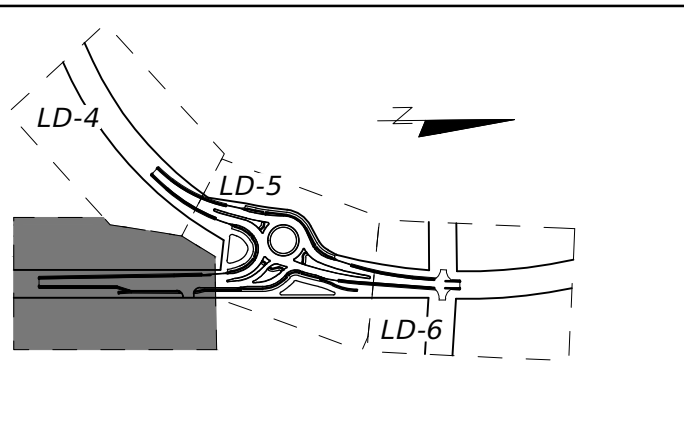

SHEET KEY | NTS

1" = 50'

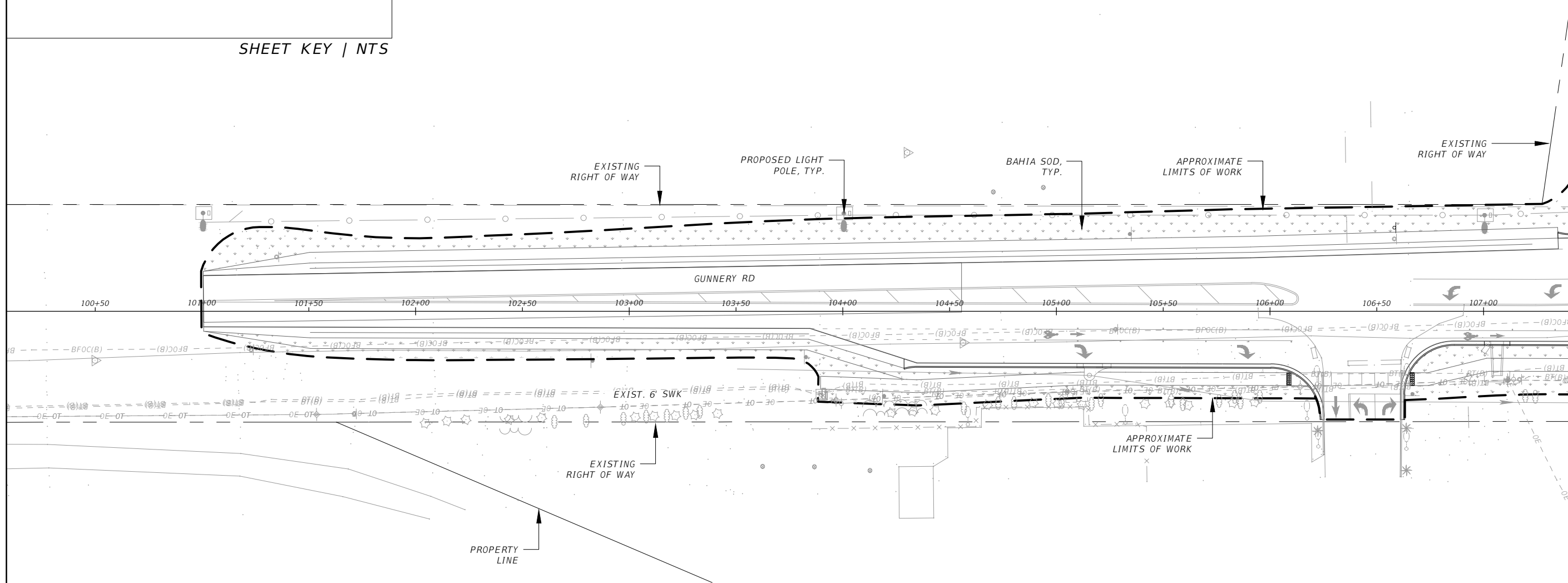

LANDSCAPE PLANS (2)
MATCHLINE

TREE SCHEDULE	
PALM TREES	BOTANICAL / COMMON NAME
PS	PHOENIX SYLVESTRIS / WILD DATE PALM

SHRUB SCHEDULE	
SHRUBS	BOTANICAL / COMMON NAME
Se	SERENOA REPENS / SAW PALMETTO

PLANT SCHEDULE	
GROUND COVERS	BOTANICAL / COMMON NAME
	BAHIA SOD

LEGEND	
EXISTING RIGHT-OF-WAY	---
PROPOSED RIGHT-OF-WAY	---
APPROX. LIMITS OF WORK	---
EXISTING WATER MAIN	---W(D)---
EXISTING SANITARY	---S(D)---
EXISTING GAS	---G(D)---
EXISTING OVERHEAD TELEPHONE	---OT---
EXISTING BURIED TELEPHONE	---BT(D)---
EXISTING OVERHEAD ELECTRIC	---OE---
EXISTING BURIED ELECTRIC	---BE---
EXISTING BURIED FIBER OPTIC	---BF(D)---
EXISTING BURIED CABLE TV	---BTV(B)---
SHELL MULCH	[Symbol]

REVISIONS			
DATE	DESCRIPTION	DATE	DESCRIPTION

CHRIS JOHN SILEWSKI, PLA
L.A. LICENSE NUMBER 6667396
AYRES
8875 HIDDEN RIVER PKWY,
SUITE 200
TAMPA, FL 33637



BUCKINGHAM RD AND GUNNERY RD
ROUNDBOUT
FINANCIAL PROJECT ID
442123-1-58-01

LANDSCAPE PLANS (4)
BUCKINGHAM RD AND
GUNNERY RD ROUNDBOUT

SHEET NO.
LD-7

THE OFFICIAL RECORD OF THIS SHEET IS THE ELECTRONIC FILE DIGITALLY SIGNED AND SEALED UNDER RULE 61G10-11.011, F.A.C.



A VERTICAL CLEARANCE FOR PALMS
 1/4" = 1'-0" P-BU-11

NOTE:
 WHEN TREE GROWS OVER TRAVEL LANE IT SHALL BE PRUNED TO KEEP CLEAR ABOVE PAVEMENT SURFACE BY A MIN OF 14.5' AS PER FDOT REGULATIONS

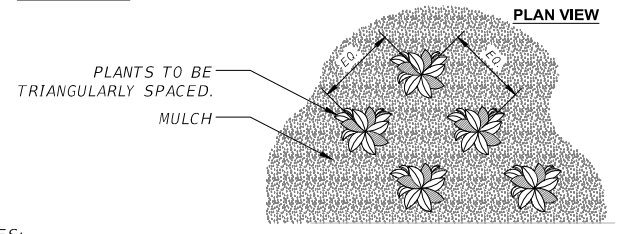
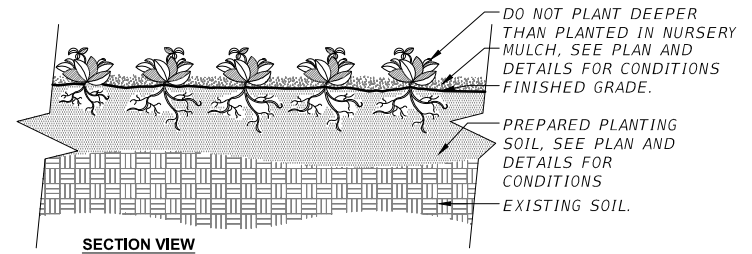

NOTES:
 1- SEE PLANTING SCHEDULE FOR PLANT SPECIES, SIZE, AND SPACING DIMENSION.
 2- SMALL ROOTS (1/4" OR LESS) THAT GROW AROUND, UP, OR DOWN THE ROOT BALL PERIPHERY ARE CONSIDERED A NORMAL CONDITION IN CONTAINER PRODUCTION AND ARE ACCEPTABLE HOWEVER THEY SHOULD BE ELIMINATED AT THE TIME OF PLANTING. ROOTS ON THE PERIPHERY CAN BE REMOVED AT THE TIME OF PLANTING.
 3- SETTLE SOIL AROUND ROOT BALL OF EACH PLANT PRIOR TO MULCHING.

B SHRUB AND PERENNIAL CONTAINER PLANTING
 3/4" = 1'-0"

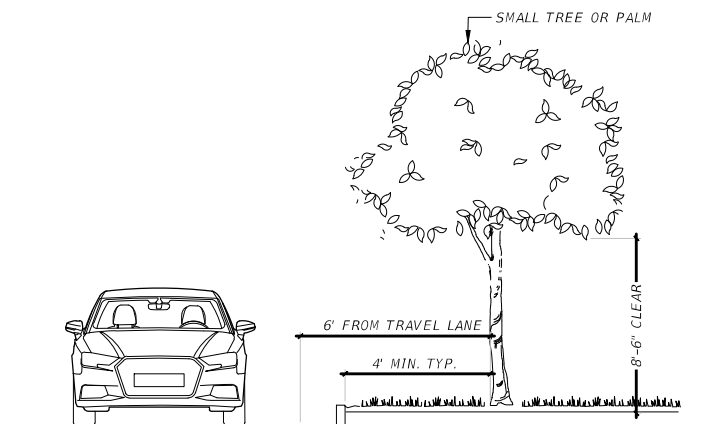

C LATERAL OFFSET TO TREES IN MEDIAN
 NTS P-BU-08

REVISIONS				CHRIS JOHN SILEWSKI, PLA L.A. LICENSE NUMBER 6667396 AYRES 8875 HIDDEN RIVER PKWY, SUITE 200 TAMPA, FL 33637		BUCKINGHAM RD AND GUNNERY RD ROUNDABOUT FINANCIAL PROJECT ID 442123-1-58-01	LANDSCAPE DETAILS (1) BUCKINGHAM RD AND GUNNERY RD ROUNDABOUT	SHEET NO.
DATE	DESCRIPTION	DATE	DESCRIPTION					LD-8
---	---	---	---					

GENERAL NOTES:

1. Staking guidelines are based on standard horticultural requirements and are provided for plant establishment purposes only. Details not intended to apply when bracing is intended to address safety considerations. When bracing for safety, refer to Designer generated signed and sealed details. These guidelines are not intended to apply when the tree or palm is within falling distance of a roadway, pedestrian or bicycle route, under extreme wind loads, non-standard soil properties, non-standard plant dimensions, or when rootball is anticipated to be greater than 4 feet diameter and planted on 1:3 slope or steeper.
2. All dimensions 6" and less are exaggerated for illustrative purposes only. Dimensions shown for wood materials are nominal. Slopes shown are Vertical:Horizontal.
3. Remove plant containers prior to planting. Remove a minimum of the top 1/3 of burlap, fabric, or wire mesh for plants not grown in containers.
4. Allow no more than 1" of soil to cover the uppermost root on all trees. Set the top of rootball 1"-2" above finish grade after settling and set plumb to the horizon.
5. Backfill with loosened existing soil or as shown in the plans. Remove rocks, sticks, or other deleterious material greater than 1" in any direction prior to backfilling. Water and tamp to remove air pockets. Contact the Engineer prior to planting if existing soils contain excessive sand, clay, or other material not conducive to proper plant growth.
6. Construct soil rings at the outer edge of the planting pit with a height of 3" and gently sloping sides unless a permanent, subsurface or drip irrigation system is provided. Do not pile soil on top of rootball.
7. Construct a 3" deep layer of mulch placed 2" off the edge of the trunk flare, around the base of shrub, or solidly around ground cover. Never pile mulch against the tree trunk.
8. Install guying with minimum 1" wide nylon or polypropylene straps with a minimum 600 lb. break strength. Check straps monthly and adjust as required to eliminate girdling of tree. Locate all wood stakes beyond the edge of soil ring in existing soil and embed a minimum of 18" below finished grade unless otherwise specified. Alternate tree bracing and guying systems specified or approved by the Engineer may be used in lieu of the tree bracing and guying methods detailed on the Index.
9. Relocated Trees and Palms: Brace relocated trees and palms in accordance with the Contract Documents. Remove bracing at the conclusion of the contract or as directed by the Engineer. Bracing or straps must not damage or become embedded in the tree bark.
10. Use 2" x 2" minimum wood stakes unless otherwise shown in the Plans or directed by the Engineer. Use wood meeting #2 Common or better in accordance with the Standard Grading Rules for Southern Pine.
11. Drive stakes into existing, undisturbed soil. Localized compaction may be provided to prevent displacement of the stakes for previously disturbed existing soils that do not provide sufficient stability.

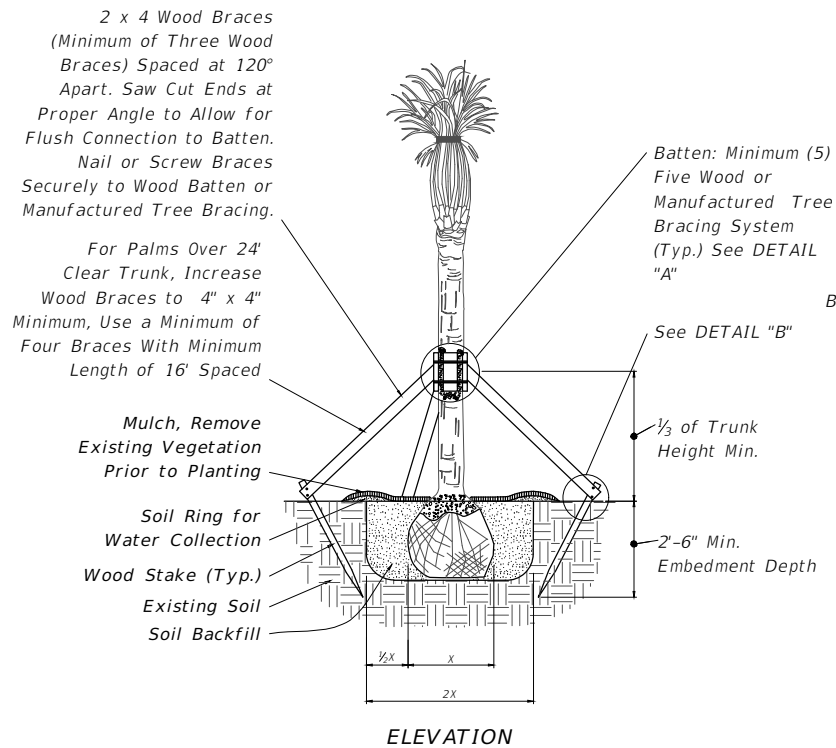

NOTE: May be used on large caliper canopy trees, adjust banding every 6 months or as needed (for fast growing species) to prevent girdling.

PALM PLANTING

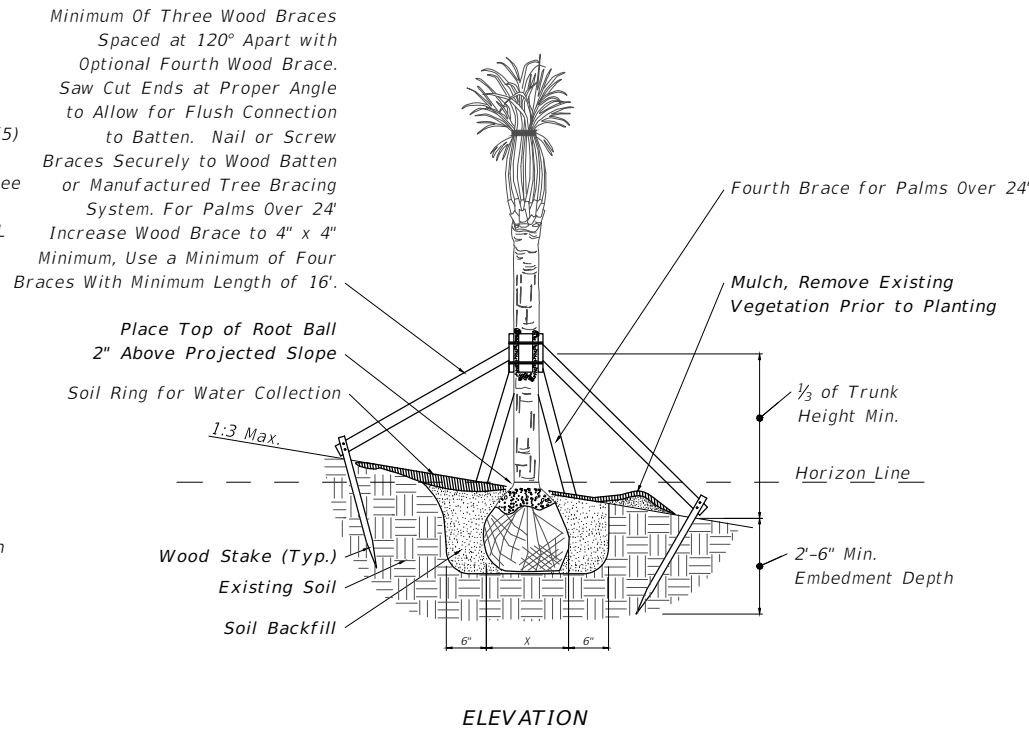

NOTE: May be used on large caliper canopy trees pending slope and rootball width, adjust banding every 6 months or as needed (for fast growing species) to prevent girdling.

PALM PLANTING ON SLOPE

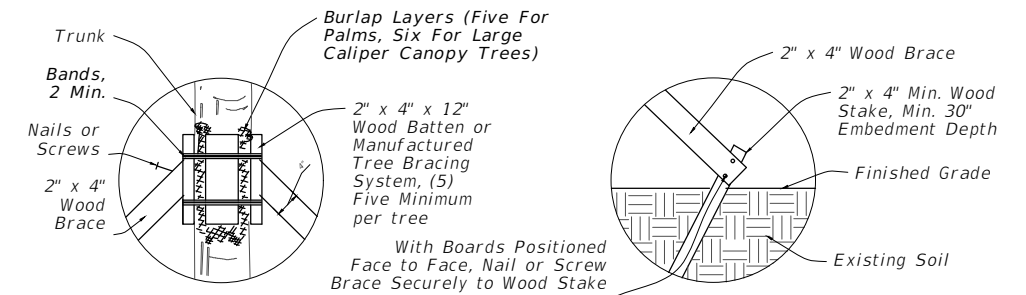

NOTE: Install bands and couplings that are rated a min. 900 lb. tensile strength, and are corrosion and UV resistant.

NOTE: Stake Into Firm, Existing Soil.

DETAIL "A"

DETAIL "B"

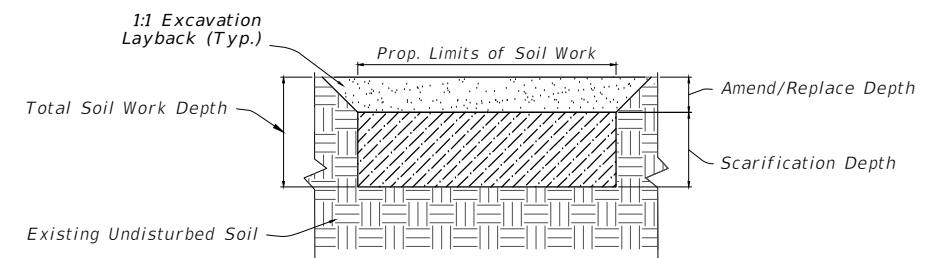

NOTE: Soil is incidental to the plant type.

(Typical Section)

LANDSCAPE SOIL WORK

REVISIONS			
DATE	DESCRIPTION	DATE	DESCRIPTION
---	---	---	---

CHRIS JOHN SILEWSKI, PLA
L.A. LICENSE NUMBER 6667396
AYRES
8875 HIDDEN RIVER PKWY,
SUITE 200
TAMPA, FL 33637



BUCKINGHAM RD AND GUNNERY RD
ROUNDBOUT
FINANCIAL PROJECT ID
442123-1-58-01

LANDSCAPE DETAILS (2)
BUCKINGHAM RD AND
GUNNERY RD ROUNDBOUT

SHEET NO.
LD-9

GENERAL BID ITEMS

PAY ITEM NO.	Description	NOTES	UNIT	TOTAL
0580 12 10	Shell Mulch (3" Depth)	SEE PLANS, DETAILS AND SPECIFICATIONS	CY	66

TABULATION OF QUANTITIES FOR PLANT MATERIAL

PAY ITEM NO.	SYM.	BOTANICAL NAME	COMMON NAME	INSTALLED SIZE	MAX. MAINTAINED SIZE	SPACING	REMARKS	UNIT	TOTAL	SHEET NUMBERS							
										LD-4		LD-5		LD-6		LD-7	
										PLAN	FINAL	PLAN	FINAL	PLAN	FINAL	PLAN	FINAL
0570 1 2	PLAN	ARGENTINE BAHIA	BAHIA SOD	SOD	N/A	SOD	SOD	SY	SEE ROADWAY	-	-	-	-	-	-	-	-
0580 1 1	Se	SERENOA REPENS	SAW PALMETTO	36" HT MIN.	N/A	5' O.C.	15 GAL.	EA	6	-	-	6	-	-	-	-	-
0580 4223	PS	PHOENIX SYLVESTRIS	WILD DATE PALM	12'-16' HT.	N/A	SEE PLAN	16" CAL. MIN., FG, Maintain to single trunk	EA	6	-	-	6	-	-	-	-	-

REVISIONS

DATE	DESCRIPTION	DATE	DESCRIPTION
---	---	---	---

CHRIS JOHN SILEWSKI, PLA
L.A. LICENSE NUMBER 6667396
AYRES
8875 HIDDEN RIVER PKWY,
SUITE 200
TAMPA, FL 33637



BUCKINGHAM RD AND GUNNERY RD
ROUNDAABOUT
FINANCIAL PROJECT ID
442123-1-58-01

**TABULATION OF QUANTITIES
AND PLANT SCHEDULE
BUCKINGHAM RD AND
GUNNERY RD ROUNDAABOUT**

SHEET NO.
LD-10

THE OFFICIAL RECORD OF THIS SHEET IS THE ELECTRONIC FILE DIGITALLY SIGNED AND SEALED UNDER RULE 61G15-23.004, F.A.C.