

**Lee County Board Of County Commissioners  
Agenda Item Summary**

**Blue Sheet No. 20031325**

**1. REQUESTED MOTION:**

**ACTION REQUESTED:** BoCC approval for the Chairman to execute the attached Resolution and State of Florida Department of Transportation (FDOT) Highway Landscaping Installation and Maintenance Agreement.

**WHY ACTION IS NECESSARY:** BoCC approval is required for the execution of the Resolution and Agreement.

**WHAT ACTION ACCOMPLISHES:** Adopts a Resolution, authorizing the Chairman to execute the Resolution and Agreement, allowing FDOT to issue a permit for the County to install and maintain landscaping and irrigation improvements within FDOT's jurisdiction at the Bayshore Road and Interstate 75 interchange.

**2. DEPARTMENTAL CATEGORY: 9  
COMMISSION DISTRICT # 4**

*C9A*

**3. MEETING DATE:**

*11-25-2003*

**4. AGENDA:**

- CONSENT ADMINISTRATIVE APPEALS
- PUBLIC WALK ON
- TIME REQUIRED:

**5. REQUIREMENT/PURPOSE:  
(Specify)**

- STATUTE
- ORDINANCE
- ADMIN. CODE
- OTHER

**FL AC  
14-40**

**6. REQUESTOR OF INFORMATION:**

- A. COMMISSIONER**
- B. DEPARTMENT** Transportation
- C. DIVISION** Operations
- BY:** Scott M. Gilbertson, P.E., Director

**7. BACKGROUND:**

Staff is working with the Lee County Roadway Landscape Advisory Committee (RLAC) and the Florida Department of Transportation (FDOT) to landscape each of the four quadrants of the interchange at Bayshore Road and I-75, which is in FDOT's jurisdiction. This project is a former Community Redevelopment Agency (CRA) project that Lee County Department Of Transportation (DOT) took over when Lee County Economic Development transferred the remaining CRA projects to DOT for completion.

FDOT requires an executed resolution and agreement with the County before they will issue a permit to us for the project's installation.

This landscape and irrigation project was reviewed and approved by the Lee County Roadway Landscape Advisory Committee on October 1, 2002.

**8. MANAGEMENT RECOMMENDATIONS:**

**9. RECOMMENDED APPROVAL:**

A Department Director	B Purchasing or Contracts	C Human Resources	D Other	E County Attorney	F Budget Services				G County Manager
<i>11/10/03</i> <i>[Signature]</i>	<i>N/A Pur.</i> <i>[Signature]</i>	<i>N/A</i>	<i>N/A</i>	<i>Andrea Jester</i>	<i>OA</i> <i>[Signature]</i>	<i>OM</i> <i>[Signature]</i>	<i>Risk</i> <i>[Signature]</i>	<i>GC</i> <i>[Signature]</i>	<i>11/10/03</i> <i>[Signature]</i>

**10. COMMISSION ACTION:**

- APPROVED
- DENIED
- DEFERRED
- OTHER

Rec. by CoAtty  
Date: *11/13/03*  
Time: *8:00 am*  
Forwarded To: *[Signature]*  
*11/13/03 8:47 AM*

RECEIVED BY  
COUNTY ADMIN. *[Signature]*  
*11/13/03*  
COUNTY ADMIN  
FORWARDED TO:  
*[Signature]*

LEE COUNTY RESOLUTION NO: \_\_\_\_\_

A RESOLUTION OF THE BOARD OF COUNTY COMMISSIONERS FOR LEE COUNTY, AUTHORIZING THE CHAIRMAN TO ENTER INTO A HIGHWAY LANDSCAPE INSTALLATION AND MAINTENANCE MEMORANDUM OF AGREEMENT WITH THE FLORIDA DEPARTMENT OF TRANSPORTATION FOR A PORTION OF STATE HIGHWAY 93 (INTERSTATE 75), STATE ROADWAY SECTION 12075 FROM MILEPOST 28.030 TO MILEPOST 28.719 (BAYSHORE ROAD) WITHIN LEE COUNTY, FLORIDA; PROVIDING AN EFFECTIVE DATE.

**WHEREAS**, roadside areas within the Department of Transportation, State Road 93 [(Interstate 75) at the Bayshore Road Interchange] right-of-way are capable of receiving and sustaining landscape beautification features; and

**WHEREAS**, the Board of County Commissioners desire that Lee County participate in the beautification of this highway's right-of-way within Lee County through landscape development; and

**WHEREAS**, the Board of County Commissioners intends, by the adoption of this Resolution, to authorize the Chairman of the Board of County Commissioners, to enter into a Highway Landscape Installation and Maintenance Memorandum of Agreement between Lee County, Florida, and the Florida Department of Transportation.

**NOW, THEREFORE, BE IT RESOLVED** by the Board of County Commissioners of Lee County, Florida:

Section 1. The Board of County Commissioners hereby authorizes the Chairman of the Lee County Board of County Commissioners to enter into a Landscape Installation and Maintenance Memorandum of Agreement between the Florida Department of Transportation and Lee County, Florida, pertaining to the State Roadway 93 right-of-way

between Milepost 28.030 and Milepost 28.719 within Lee County, Florida.

Section 2. The Clerk of the Circuit Court of Lee County, Florida, is hereby directed to forward four (4) certified copies of this Resolution and the Highway Landscaping Installation and Maintenance Agreement to the Florida Department of Transportation, Bartow, as a condition for receiving a Department General Use Permit.

Section 3. This Resolution shall take effect immediately upon adoption.

The foregoing Resolution was offered by Commissioner \_\_\_\_\_, who moved its adoption. The motion was seconded by Commissioner \_\_\_\_\_ and, being put to a vote, the vote was as follows:

John Albion	_____
Doug St. Cerny	_____
Ray Judah	_____
Andrew W. Coy	_____
Bob Janes	_____

DULY PASSED AND ADOPTED this \_\_\_\_\_ day of \_\_\_\_\_, 2003.

ATTEST:  
CHARLIE GREEN, CLERK

BOARD OF COUNTY COMMISSIONERS  
OF LEE COUNTY, FLORIDA

By: \_\_\_\_\_  
Deputy Clerk

By: \_\_\_\_\_  
Chairman

APPROVED AS TO FORM:

By: \_\_\_\_\_  
Assistant County Attorney

**STATE OF FLORIDA DEPARTMENT OF TRANSPORTATION  
HIGHWAY LANDSCAPING INSTALLATION  
AND MAINTENANCE AGREEMENT**

**THIS AGREEMENT**, made and entered into this \_\_\_\_ day of \_\_\_\_\_, 20 \_\_, by and between the **STATE OF FLORIDA DEPARTMENT OF TRANSPORTATION**, hereinafter referred to as the “**DEPARTMENT**”, and **LEE COUNTY BOARD OF COUNTY COMMISSIONERS**, hereinafter referred to as the “**AGENCY**”.

**WITNESSETH**

**WHEREAS**, the **DEPARTMENT** has jurisdiction over and maintains State Road 93 (also known as Interstate 75) as part of the State Highway System; and

**WHEREAS**, the **AGENCY** seeks to install and maintain certain landscape development improvements within the unpaved areas within the right-of-way of State Road 93/I-75, at the interchange with Bayshore Road (State Road 78); Section 12075 from Mile Post 28.030 to Mile Post 28.719, hereinafter referred to as the “**PROJECT**”; and

**WHEREAS**, the parties hereto mutually recognize the need for entering into an Agreement designating and setting forth the responsibilities of each party; and

**WHEREAS**, the **AGENCY** by Resolution dated \_\_\_\_\_, a copy of which is attached hereto and made a part hereof, has authorized its \_\_\_\_\_ to enter into this Agreement on behalf of the **AGENCY**;

**NOW, THEREFORE**, for and in consideration of the mutual benefits to flow each to the other, the parties covenant and agree as follows:

1. The **AGENCY** hereby assures the **DEPARTMENT**, that prior to submitting this Agreement, it has:

- (a) Ascertained the location of all existing utilities, both aerial and underground. A letter of notification and plan of the landscape development improvements was mailed on \_\_\_\_\_, to the following utilities/municipalities:

\_\_\_\_\_  
N/A  
\_\_\_\_\_  
\_\_\_\_\_

- (b) Complied with all permit requirements from the appropriate agencies (county,

municipality, etc.) in connection with the activities described hereunder.

Outdoor advertising is specifically excluded from this Agreement in accordance with Section 479.11, Florida Statutes.

2. The **AGENCY** hereby agrees to install the landscape improvements in accordance with the Landscape Development Plan included as **Exhibit "A"**, attached hereto and by this reference made a part hereof. Such installation shall be in conformance with Rule 14-40, Florida Administrative Code, and the Highway Landscape Beautification and Plan Review Procedure (Topic 650-050-001-c), as they may be amended from time to time.

3. The **AGENCY** agrees to maintain the landscape improvements in accordance with the Technical Maintenance Plan included as **Exhibit "B"**, attached hereto and by this reference made a part hereof.

4. Designated personnel as directed by the District Secretary or his designee may inspect and evaluate this project and issue a written report if a deficiency or unsatisfactory condition is noted. If deficiencies and/or unsatisfactory conditions are not corrected within thirty (30) days, the District Secretary or his designee shall have the option to do one of two things:

- (a) Correct and maintain the landscape improvements with **DEPARTMENT's** contractor or **DEPARTMENT's** personnel and charge the **AGENCY** for the reasonable value of said work.
- (b) Remove by **DEPARTMENT's** contractor or **DEPARTMENT's** personnel all landscape improvements, return the right-of-way to its original condition and charge the **AGENCY** the reasonable value for such work.

5. To the extent permitted by Section 768.28, Florida Statutes, the **AGENCY** shall indemnify, defend, save and hold harmless, the **DEPARTMENT** and all of its officers, agents or employees from all suits, actions, claims, demands, liability of any nature whatsoever arising out of, because of, or due to breach of this Agreement by the **AGENCY**, its officers, agents, or employees or due to any negligent act or occurrence of omission or commission of the **AGENCY**, its officers, agents, or employees. Neither the **AGENCY**, nor any of its officers, agents, or employees will be liable under this section for damages arising out of injury or damage to persons or property directly caused or resulting from the negligence of the **DEPARTMENT** or any of its officers, agents or employees.

6. The **AGENCY** covenants to keep in force during the period of this Agreement public liability insurance, property damage insurance and worker's compensation insurance through an insurance policy(ies) or the **AGENCY's** self insurance program.

7. This Agreement shall remain in effect until such time the **AGENCY** or **DEPARTMENT** wishes to cancel said agreement and this shall be done in writing giving the **AGENCY** or **DEPARTMENT** thirty (30) days notice. All landscape improvements shall be removed by the **AGENCY** and the **DEPARTMENT's** right-of-way returned to its original condition.

If, after thirty (30) days, the landscape improvements have not been removed, the **DEPARTMENT** may, at its option, proceed as follows:

- (a) Maintain the landscape improvements within the limits of said project with **DEPARTMENT's** contractor or personnel and charge the **AGENCY** for the reasonable value of said work;  
OR
- (b) Remove by **DEPARTMENT's** contractor or personnel all of the landscape improvements, return the right-of-way to its original condition, and charge the **AGENCY** for the reasonable value of such work.

8. The term of this Agreement commences upon execution by both parties.

9. This writing embodies the entire Agreement and understanding between the parties hereto and there are no other agreements and understanding, oral or written, with reference to the subject matter hereof that are not merged herein and superseded hereby.

10. This Agreement may not be assigned or transferred by the **AGENCY** in whole or part without the consent of the **DEPARTMENT**.

11. This Agreement shall be governed by and construed in accordance with the laws of the state of Florida. In the event of a conflict between any portion of the Agreement and Florida law, the laws of Florida shall prevail.

**IN WITNESS WHEREOF**, the parties hereto have caused these presents to be executed the day and year first above written.

BOARD OF COUNTY COMMISSIONERS  
OF LEE COUNTY, FLORIDA

STATE OF FLORIDA  
DEPARTMENT OF TRANSPORTATION

BY: \_\_\_\_\_  
TITLE: \_\_\_\_\_

BY: \_\_\_\_\_  
District Secretary

ATTEST: \_\_\_\_\_ (SEAL)  
TITLE: \_\_\_\_\_

ATTEST: \_\_\_\_\_  
Executive Secretary

Legal Review:

\_\_\_\_\_  
District Legal Counsel

# S.R 78 & I-75 INTERCHANGE HIGHWAY BEAUTIFICATION PLANS

NOTE: FDOT STANDARD SPECIFICATIONS FOR  
ROAD AND BRIDGE CONSTRUCTION, 1991 EDITION  
USED IN PLAN SET

UTILITIES TO BE NOTIFIED:

LEE COUNTY UTILITIES	479-8532
COMCAST CABLE	479-8532
LEE COUNTY ELECTRIC CO-OP	995-2183
LEE COUNTY UTILITIES	936-0247
FLORIDA POWER & LIGHT	1-800-432-4770

SR 78 AT I-75  
SECTION \* 12075  
M.P. 28.030 - M.P. 28.719  
POSTED SPEED LIMITS  
SR 78 - 50 mph  
I-75 - 70 mph  
RAMP SPEED- 50 mph



PROJECT

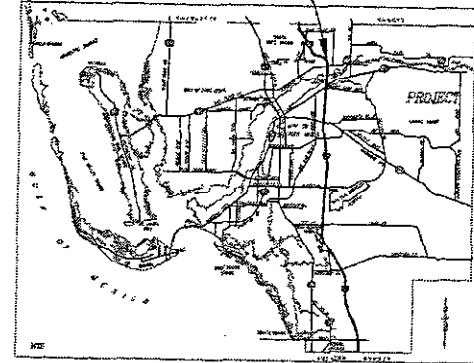

LOCATION MAP

TOTAL LANDSCAPE AREA= 0.25 ACRE,  
PROJECT AREA LESS THAN 1 ACRE.  
NO EPA NPDES PERMIT REQUIRED.

PREPARED FOR:

DEPARTMENT OF TRANSPORTATION  
5560 ZIP DRIVE  
FORT MYERS, FLORIDA 33905  
TEL: (239) 694-3334

PREPARED BY:

DAVID M. JONES, JR. AND ASSOCIATES, INC.  
2221 MCGREGOR BOULEVARD  
FORT MYERS, FLORIDA 33901  
TEL: (239) 337-5525

INVESTIGATE BEFORE YOU  
EXCAVATE

"CALL SUNSHINE STATE ONE"  
1-800-432-4770  
TOLL FREE

FLORIDA STATUTE REQUIRES MIN.  
OF 2 DAYS & MAX. OF 5 DAYS  
NOTICE BEFORE YOU EXCAVATE

FDOT MAINTENANCE FORT MYERS  
TO BE CONTACTED 72 HOURS PRIOR  
TO BEGINNING CONSTRUCTION

239/656-7800

SHEET #	SHEET INDEX	APPROVED FOR PERMITTING
L-1	COVER SHEET	BY <u>Byron L. Dennis</u> DATE <u>8/22/13</u> District LANDSCAPE MANAGER
L-2	KEY SHEET	
L-3-6	LANDSCAPE PLANS	
L-7	TECHNICAL MAINTENANCE AND LANDSCAPE NOTES	
L-8-9	LANDSCAPE NOTES AND DETAILS	
L-10	IRRIGATION SHEET KEY	
L-11-14	IRRIGATION PLANS	
L-15-16	IRRIGATION NOTES AND DETAILS	
L-17-28 <b>29</b>	MAINTENANCE OF TRAFFIC PLANS	

REGISTERED L.A.

DATE

LICENSE #

8/18/03  
840

REVISED DATE:



DAVID M. JONES JR. AND ASSOCIATES, INC.  
LANDSCAPE ARCHITECTS AND PLANNERS  
2221 MCGREGOR BOULEVARD FORT MYERS, FLORIDA 33901  
(941) 337-5525 FAX (941) 337-4884

DEPARTMENT  
OF  
TRANSPORTATION  
LEE COUNTY  
ROUTE 1815 PALM BAY, FLORIDA (239) 694-3334

LANDSCAPE ARCHITECTURAL PLANS FOR  
**SR 78 & I-75  
INTERCHANGE**  
NORTH FORT MYERS  
LEE COUNTY, FLORIDA

PROJECT NO.  
578-01-065

DATE  
8-9-03

SHEET DESCRIPTION:  
COVER

SHEET NUMBER  
L-1



DAVID M. JONES JR. AND ASSOCIATES, INC.  
 LANDSCAPE ARCHITECTS AND PLANNERS  
 2221 MADREPOR BLVD. FORT MYERS, FLORIDA, 38901  
 (813) 937-6565 FAX (813) 937-4494

DEPARTMENT OF TRANSPORTATION  
 LEIC COUNTY  
 SOUTH FLORIDA (239) 694-9394

LANDSCAPE ARCHITECTURAL PLANS FOR  
 SR 78 & I-75 INTERCHANGE  
 North Fort Myers  
 LEE COUNTY, FLORIDA

PROJECT NO. 578-01-065  
 DATE 6-9-03

SHEET INFORMATION  
 Landscape Key Sheet

SHEET NUMBER  
 L-2

REVISED DATE



SCALE 1" = 100'

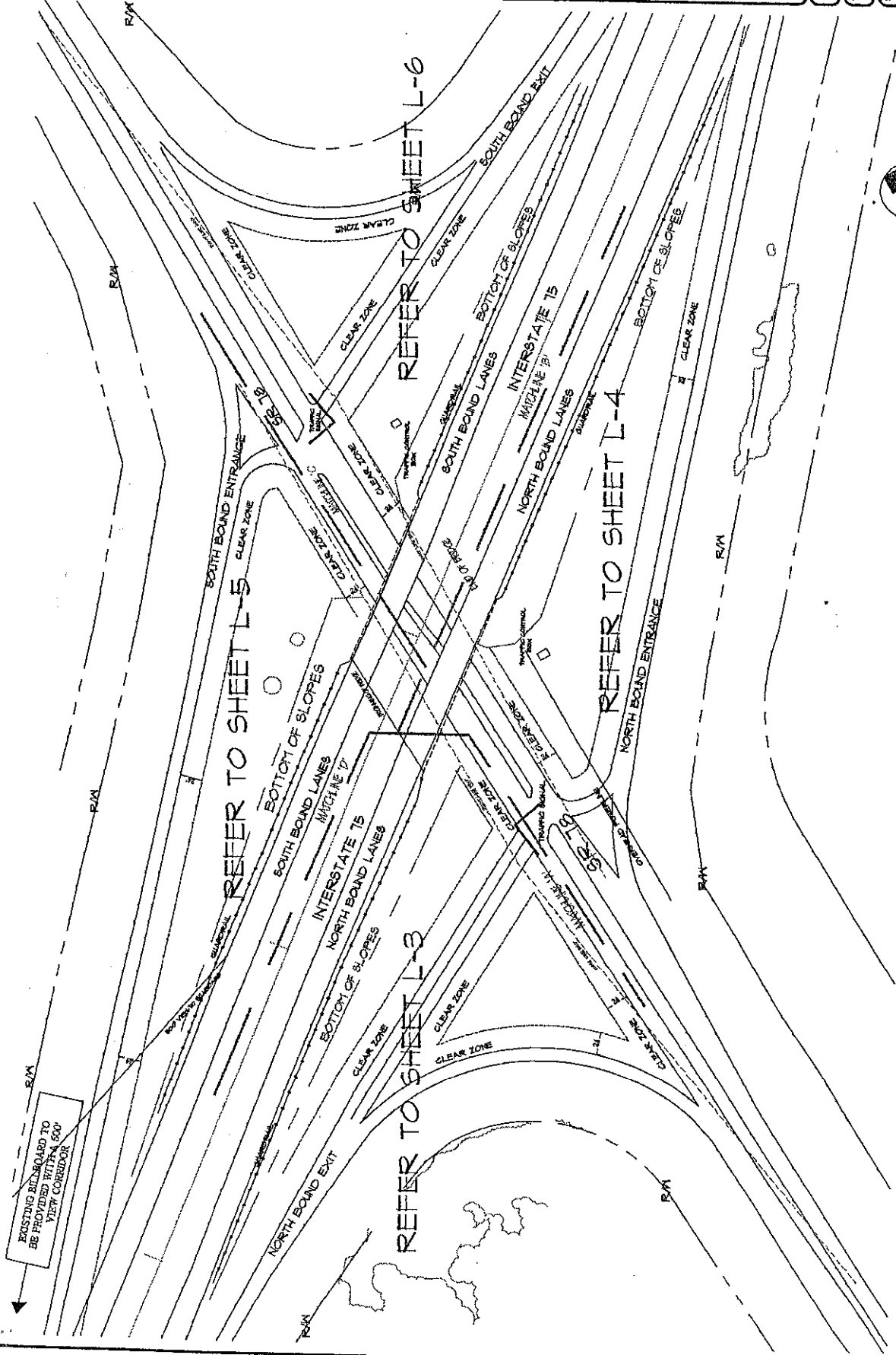

EXHIBIT A PAGE 2 OF 29





DAVID M. JONES JR. AND ASSOCIATES, INC.  
 LANDSCAPE ARCHITECTS AND PLANNERS  
 221 MAGNOLIA BLVD., FORT MYERS, FLORIDA, 33901  
 (813) 337-5025 FAX (813) 337-4764

DEPARTMENT OF TRANSPORTATION  
 LEE COUNTY  
 FORT MYERS, FLORIDA (238) 684-3534

LANDSCAPE ARCHITECTURAL PLANS FOR  
**SR 78 & I-75 INTERCHANGE**  
 Fort Myers, Florida  
 LEE COUNTY, FLORIDA

PROJECT NO. 578-01-065

DATE: 6-9-03

DIST DESCRIPTION: Landscape

REVISED DATE: SHEET NUMBER: L-3

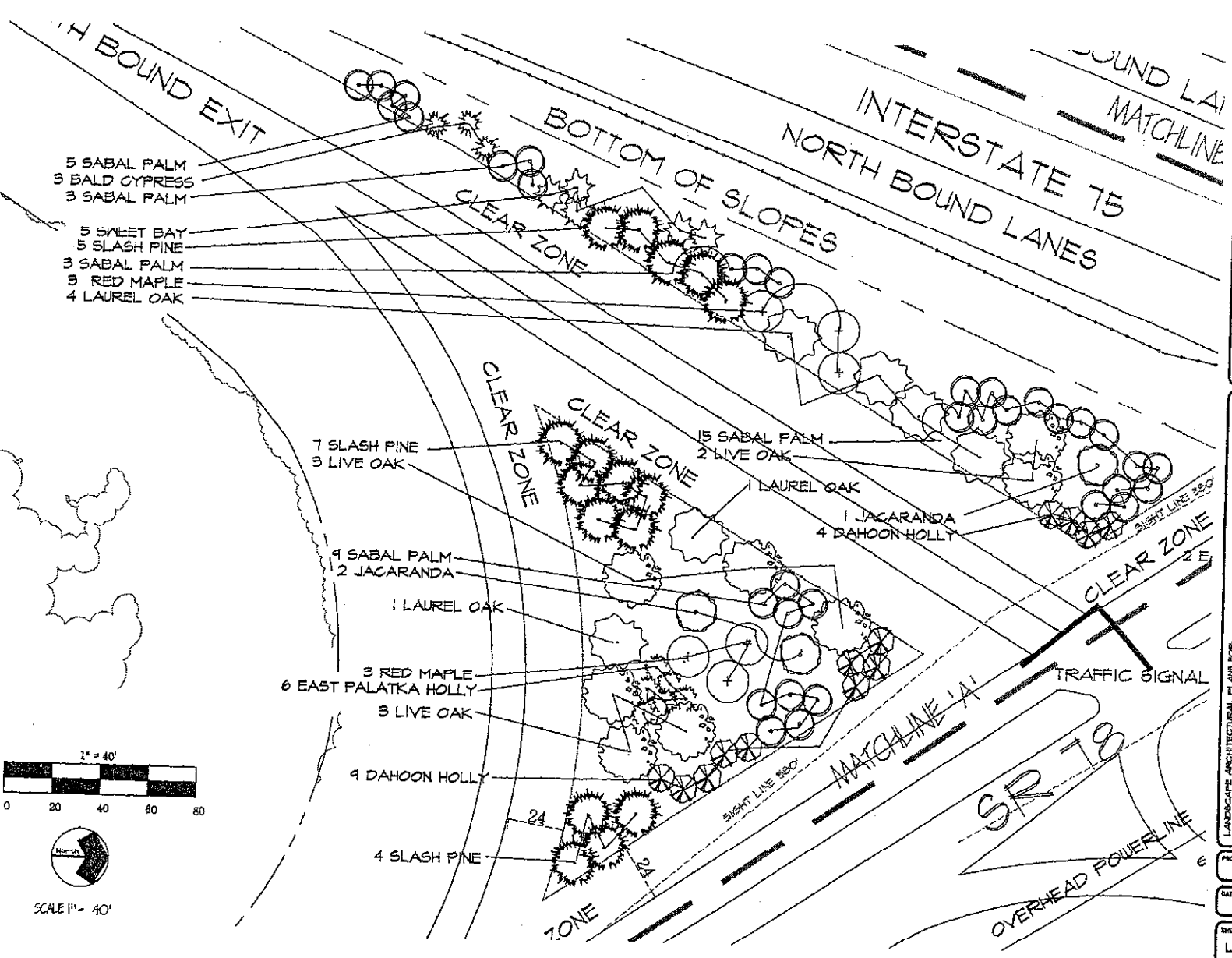

- 5 SABAL PALM
- 3 BALD CYPRESS
- 3 SABAL PALM
- 5 SHEET PINE
- 5 SLASH PINE
- 3 SABAL PALM
- 3 RED MAPLE
- 4 LAUREL OAK

- 7 SLASH PINE
- 3 LIVE OAK

- 9 SABAL PALM
- 2 JACARANDA

- 1 LAUREL OAK

- 3 RED MAPLE
- 6 EAST PALATKA HOLLY
- 3 LIVE OAK

- 9 DAHOON HOLLY

- 4 SLASH PINE

- 15 SABAL PALM
- 2 LIVE OAK

- 1 LAUREL OAK

- 1 JACARANDA
- 4 DAHOON HOLLY

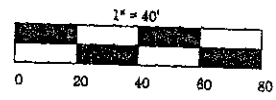

SCALE 1" = 40'

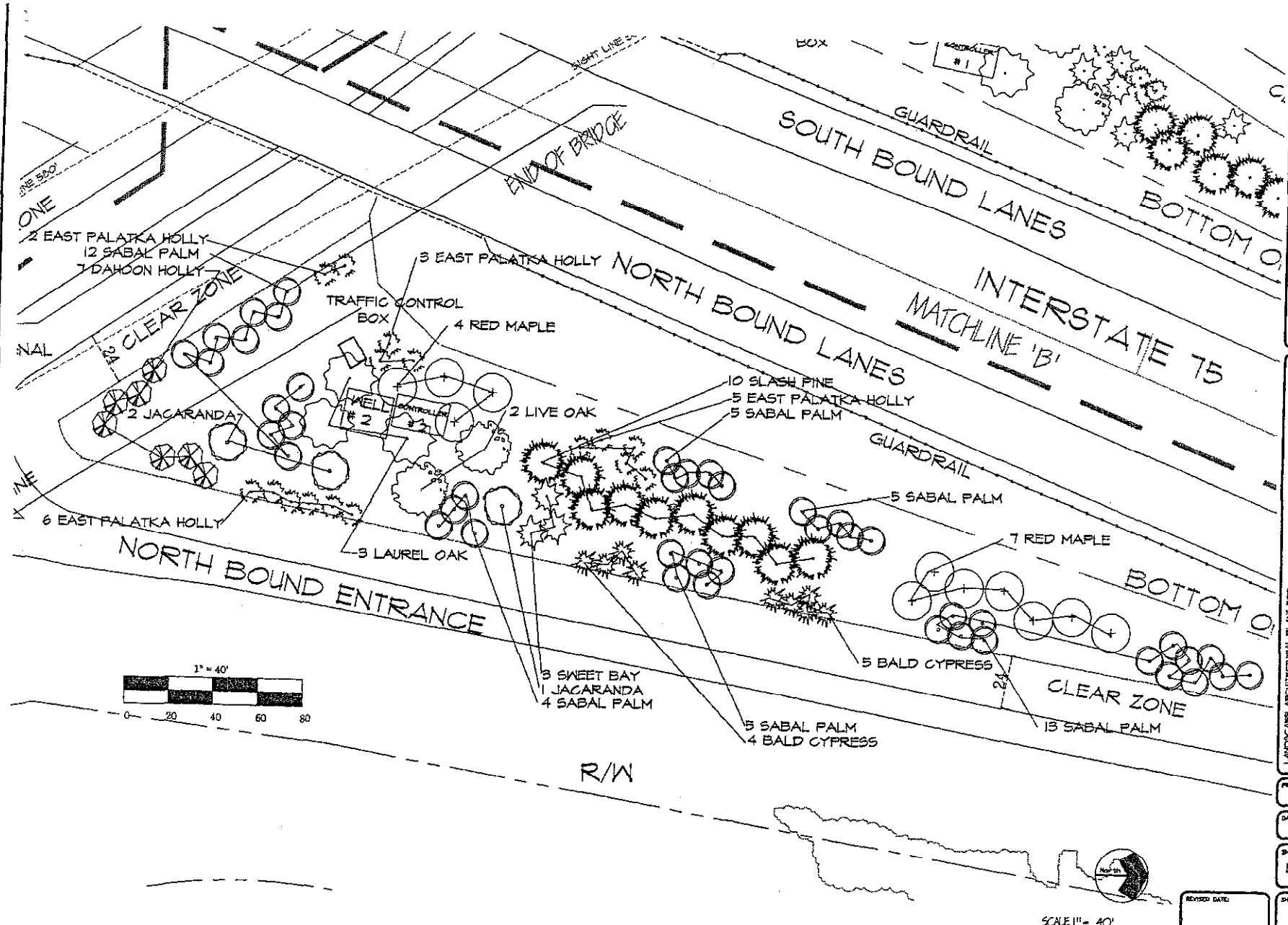

DAVID M. JONES JR. AND ASSOCIATES, INC.  
 LANDSCAPE ARCHITECTS AND PLANNERS  
 221 MARLBOROUGH COLLEGE ROAD, SUITE 100  
 FORT LAUDERDALE, FLORIDA 33401  
 (813) 357-4844 FAX (813) 357-4844

DEPARTMENT OF TRANSPORTATION  
 FLORIDA  
 LEON COUNTY  
 100 WEST FLORIDA (209) 694-3334

LANDSCAPE ARCHITECTURAL PLANS FOR  
**SR 78 & I-75 INTERCHANGE**  
 North Fort Myers  
 LEON COUNTY, FLORIDA

PROJECT NO. 576-01-085
DATE 6-9-03
SHEET DESCRIPTION Landscape
REVISION DATE
SHEET NUMBER L-4

EXHIBIT A PAGE 4 OF 29

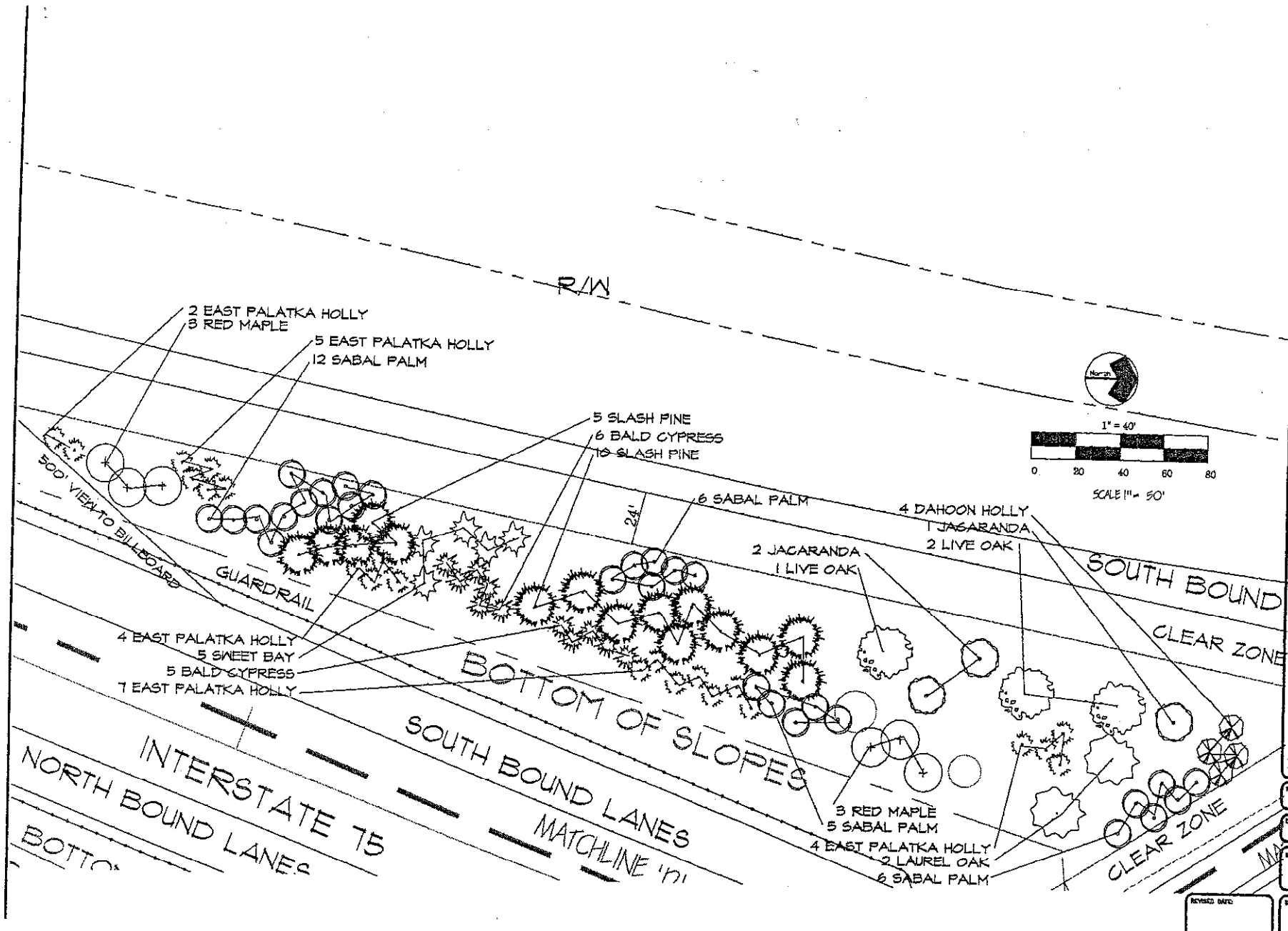

  
 DAVID M. JONES JR. AND ASSOCIATES, INC.  
 LANDSCAPE ARCHITECTS AND PLANNERS  
 221 MACGREGOR BOULEVARD FORT MYERS FLORIDA, 33901  
 813-337-4825 FAX 813-337-4824

DEPARTMENT  
 OF  
 TRANSPORTATION  
 LEES COUNTY  
 SOUTHFLORIDA (239) 884-8834

LANDSCAPE ARCHITECTURAL PLANS FOR  
**SR 78 & I-75 INTERCHANGE**  
 North Fort Myers  
 LEE COUNTY, FLORIDA

PROJECT NO.	575-01-065
DATE	6-9-03
SHEET DESCRIPTION	Landscape
REVISION DATE	
SHEET NUMBER	L-5

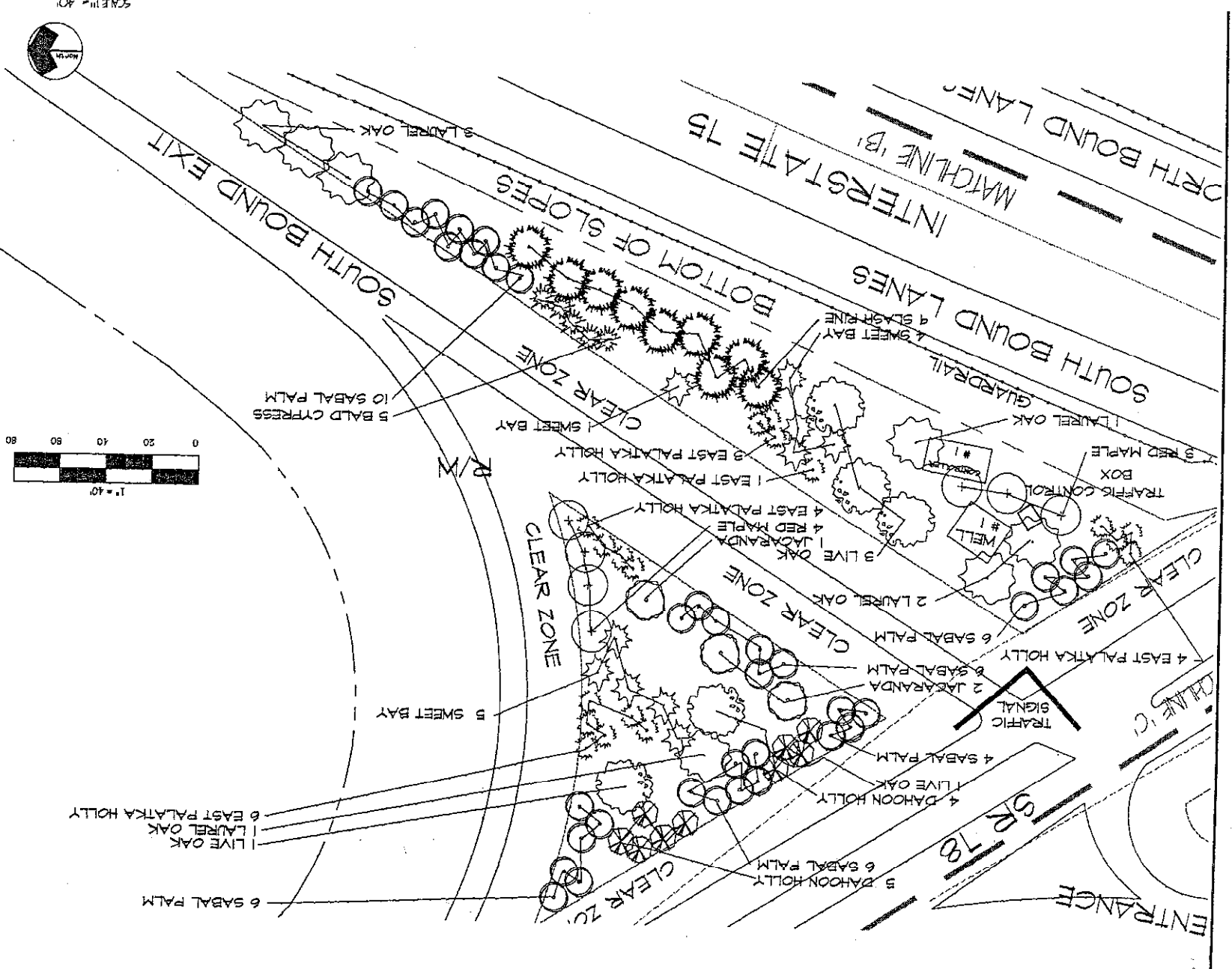

REVISED DATE: L-6  
 SHEET NUMBER: L-6

DATE: 5-9-03  
 PROJECT NO: 576-01-065  
 BEST PRACTICES: Landscape

LANDSCAPE ARCHITECTURAL PLANS FOR  
**SR 78 & I-75 INTERCHANGE**  
 North Fort Myers  
 LEE COUNTY, FLORIDA

DEPARTMENT OF TRANSPORTATION  
 LEE COUNTY  
 FORT MYERS, FLORIDA (239) 694-8334

DAVID M. JONES JR. AND ASSOCIATES, INC.  
 LANDSCAPE ARCHITECTS AND PLANNERS  
 2211 MACDONALD BOULEVARD, FORT MYERS, FLORIDA 33901  
 (813) 337-9225 FAX (813) 337-4364



SR 78 & I-75 INTERCHANGE												
CORE LEVEL MAINTENANCE MATRIX - LEVEL ONE												
MAINTENANCE OPERATION	MAINTENANCE FREQUENCIES ARE MINIMUMS											
	JAN	FEB	MARCH	APRIL	MAY	JUNE	JULY	AUG.	SEPT.	OCT.	NOV.	DEC.
MOWING 3-4" HEIGHT	X	X	X	X	XX	XX	XX	XX	XX	XX	X	X
	MOW ON A BI-WEEKLY BASIS FROM MAY THROUGH OCTOBER AND MONTHLY FROM NOVEMBER THROUGH APRIL											
WATERING	PLANT MATERIAL		DAY		FREQUENCY			NUMBER OF APPLICATIONS				
	ALL		1-60		DAILY			60				
	ALL		61-150		3 TIMES/WEEK			36				
	ALL		151-365		WEEKLY			28				
IRRIGATION	MAINTAIN THE IRRIGATION SYSTEM IN AN OPERABLE CONDITION AT ALL TIMES. CHECK SYSTEM FOR LINE BREAKS AND CLOGGING OF HEADS AND BUBBLERS EACH WEEK.											
FERTILIZATION	X				X			X				X
WEEDING	LANDSCAPED BEDS AND MULCHED AREAS SHALL BE KEPT WEED FREE.											
PRUNING	PRUNE AS NECESSARY TO REMOVE ALL SUCKERS, DEAD, DISEASED, OR BROKEN BRANCHES, FRONDS AND SEED HEADS.											
MULCHING	MAINTAIN A CONTINUOUS 3" LAYER OF MULCH IN ALL PLANTED AND MULCHED AREAS. MULCH ENTIRE SITE IN MONTH TWELVE OF MAINTENANCE CONTRACT.											
EDGING	X	X	X	X	XX	XX	XX	XX	XX	XX	X	X
GENERAL	RESTORE ALL SAUCERS AND CONTROL ANTS, INSECTS AND DISEASE AS THEY APPEAR.											
LITTER REMOVAL	WEEKLY IN ALL MULCHED AREAS AND JUST BEFORE EACH MOWING.											
	REFER TO SITE MAINTENANCE SPECIFICATIONS FOR DETAILS. LEE COUNTY RESERVES THE RIGHT TO ADJUST FREQUENCIES AS NECESSARY.											

- \* Mowing should be as needed in dry season (May through October) at a height of 4" to 6" to prevent grass death during this period
- \* Mowing to include clear zone areas identified on plan sheets
- \* Shrubs planted within clear sight limits shall be maintained at 24" ht. maximum
- \* Accent Trees within limits of clear sight shall be maintained with 8'-6" clear trunks.
- \* Trees within limits of clear sight shall be maintained with 8'-6" clear trunks.

Signature: Paul W. Loyal

Lee County Department of Transportation

Date: 6/19/03

#### TYPICAL LANDSCAPE NOTES

Installation of work shall be coordinated with other contractors in such a manner as to allow for a speedy and orderly completion of all work on the site.

Contractors are advised to refer to the specifications, contract documents, and plan sheets for a more detailed disclosure of performance standards and requirements.

The contractor is cautioned to be aware of underground utilities. Prior to excavation, the contractor shall check with the job site superintendent, "No Cuts", and Lee County utilities for location of all utilities a minimum of 48 hours before beginning work.

Contractor to provide agricultural certification for sod to be weed free.

All sod shall be sand grown. The contractor shall be responsible for all finish grading in sod areas. Hand rake prior to installing sod. Stagger and kick all joints tight. All sod to be rolled immediately after installation.

Contractor shall apply minimum 2 applications of roundup herbicide (or approved equal) on existing turf where it is required to be removed for planting. Roundup must be sprayed prior to commencing any grading operations. Contractor shall review turf kill with landscape architect or owner representative for approval. All herbicides must be applied by licensed applicators per manufacturers recommended rates and instructions. Post all applications.

Contractor shall install all fill to construct berming to blend in with existing grade. Fill material shall be second cut clean fill suitable for plant growth. Submit sample of second cut clean fill to landscape architect for review. All existing turf areas to be tractor graded to a smooth uniform grade. No fill is to be placed around the existing trees.

Any excess soil or debris from construction shall be removed from the site and taken to the county land fill or other lawful disposal site.

Mulch all new planting with 3" (or as noted otherwise on plan) of specified recycled mulch. State policy prohibits cypress mulch on all state roads.

The landscape contractor shall hand water all plant material daily until substantial completion. The landscape contractor shall be liable for replacing trees and shrubs experiencing transplant shock due to lack of water at any time during the course of the contract period.

All trees and palms within sod areas shall be mulched 3" deep within a 6' min. diameter ring. Stakes shall be within mulch rings.

The landscape contractor shall be responsible for removal of all existing sod, debris, weeds, and handwork in preparation for any planting.

Contractor shall repair any areas disturbed during the completion of work including resodding or irrigation trenches and planting pits resulting from material relocations.

An automatic irrigation system will be installed to provide 100% coverage on all new plant material.

All new plant materials used shall conform to the standards for Florida No. 1 or better as established in "Grades and Standards for Nursery Plants" State of Florida Department of Agriculture.

All plant material shall be subject to approval by the landscape architect prior to purchase by contractor.

Contractor shall stake all trees as per details.

All plant material shall be fertilized according to the chart as shown on this sheet.

All tree rings evidencing weed growth shall be sprayed with Roundup at the mfg recommended application rate. Tree rings and all beds are to remain weed free until final inspection for acceptance.

Contractor is responsible for restoring all disturbed areas created by the construction. This shall include all sod and hand raking to restore a smooth uniform surface. Also removal of any debris encountered or created from construction operations. Any material removed from the site shall be taken to a sanitary landfill or other approved location.

The owner reserves the right to modify tree placement in the field as conditions dictate. Plant material shall be installed prior or concurrent with the irrigation bubbler system.

The contractor is responsible for obtaining all necessary permits prior to commencing any work.

The first emerging root of the root ball shall be at finish grade and visible at inspection.



DAVID M. JONES JR. AND ASSOCIATES, INC.  
LANDSCAPE ARCHITECTS AND PLANNERS  
2201 HARBOR BOULEVARD FORT MYERS, FLORIDA 36601  
(813) 337-5525 FAX (813) 337-4404

DEPARTMENT OF TRANSPORTATION  
LEE COUNTY  
SOUTH FLORIDA (239) 694-9394

LANDSCAPE ARCHITECTURAL PLANS FOR  
SR 78 & I-75 INTERCHANGE  
North Fort Myers  
LEE COUNTY, FLORIDA

PROJECT NO.  
578-01-055

DATE  
6-9-03

SHEET DESCRIPTION  
Maintenance

REVISED DATE

SHEET NUMBER  
1-7

EXHIBIT A PAGE 7 OF 29



DAVID M. JONES JR. AND ASSOCIATES, INC.  
 LANDSCAPE ARCHITECTS AND PLANNERS  
 2221 MACGROVER BOULEVARD, FORT MYERS, FLORIDA 33901  
 (941) 337-5525 FAX (941) 337-4194

DEPARTMENT OF TRANSPORTATION  
 SR 78 & I-75 INTERCHANGE  
 LEHIGH COUNTY, FLORIDA  
 (209) 894-3334

LANDSCAPE ARCHITECTURAL PLANS FOR  
 SR 78 & I-75 INTERCHANGE  
 NORTH FORT MYERS  
 LEHIGH COUNTY, FLORIDA

PROJECT NO. 578-01-1065

DATE: 6-9-03

SHEET DESCRIPTION: LANDSCAPE NOTES AND DETAILS

SHEET NUMBER: 1-8

REVISED DATE:

EXHIBIT A PAGE 8 OF 29

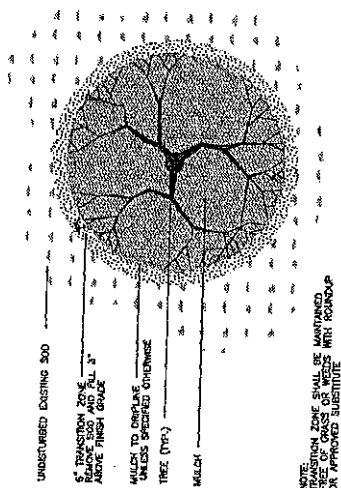

UNDISTURBED EXISTING SOIL  
 4" TRANSITION ZONE  
 8" TRANSITION ZONE  
 ABOVE FINISH GRADE  
 MULCH TO DRAINAGE  
 UNLESS SPECIFIED OTHERWISE  
 TREE (TYP.)  
 MULCH  
 NOTE: TRANSITION ZONE SHALL BE LARGER THAN  
 PIECE OF GRASS OR WEEDS WITH ROUNDUP  
 OR APPROVED SUBSTITUTE

MULCHING DETAIL PLAN  
 N.T.S.

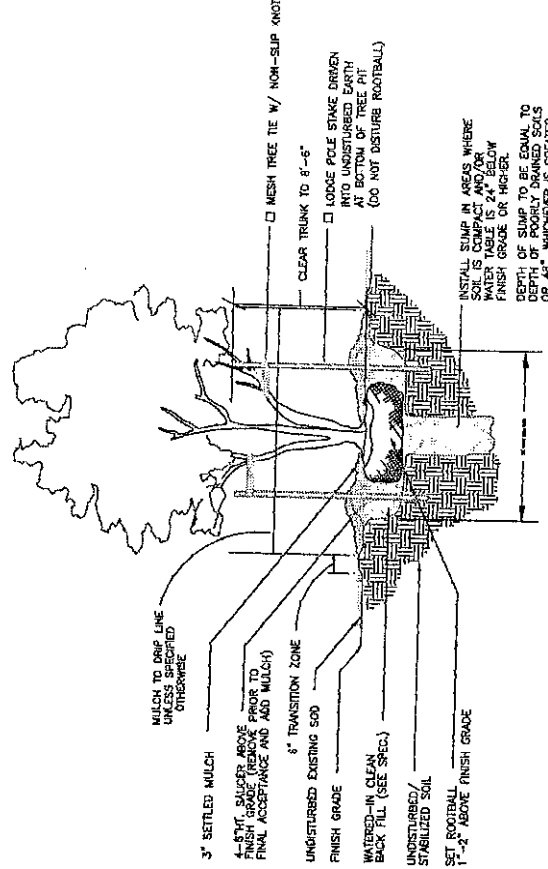

MULCH TO DRIP LINE  
 UNLESS SPECIFIED OTHERWISE  
 3" SETTLED MULCH  
 4-8" T. SALICER ABOVE  
 FINISH GRADE (REMOVE PRIOR TO  
 FINAL ACCEPTANCE AND ADD MULCH)  
 UNDISTURBED EXISTING SOIL  
 FINISH GRADE  
 8" TRANSITION ZONE  
 WATERSHED-IN CLEAN  
 BACK FILL (SEE SPEC.)  
 UNDISTURBED/  
 STABILIZED SOIL  
 SET ROOTBALL  
 1'-2' ABOVE FINISH GRADE  
 CLEAR TRUNK TO 8'-6"  
 LODGE POLE STAKE DRIVEN  
 INTO UNDISTURBED EARTH  
 AT BOTTOM OF TREE PIT  
 (DO NOT DISTURB ROOTBALL)  
 INSTALL SUMP IN AREAS WHERE  
 SOIL IS COMPACT AND/OR  
 WATER TABLE IS 2" BELOW  
 FINISH GRADE OR HIGHER.  
 DEPTH OF SUMP TO BE EQUAL TO  
 DEPTH OF POORLY DRAINED SOILS  
 OR 48", WHICHEVER IS GREATER.

MULTI-TRUNK TREE DETAIL  
 N.T.S.

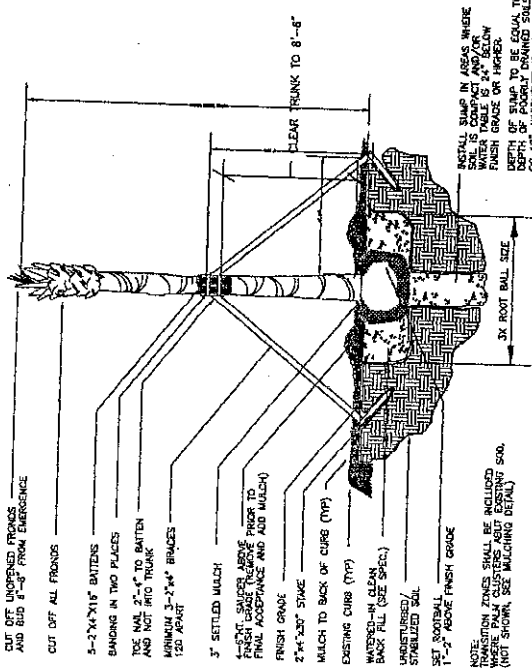

CUT OFF UNDESIRABLE FRONDS  
 AND 80% 2'-4" FROM EMERGENCE  
 CUT OFF ALL FRONDS  
 5-2"x4"x16" BATTENS  
 BANDING IN TWO PLACES  
 THE MAX. 2'-4" TO BATTEN  
 AND MAX. 16" TRUNK  
 BETWEEN 3'-2"x4" BRACES  
 (SEE PAGE)  
 3" SETTLED MULCH  
 4-8" T. SALICER ABOVE  
 FINISH GRADE (REMOVE PRIOR TO  
 FINAL ACCEPTANCE AND ADD MULCH)  
 FINISH GRADE  
 2"x4" X20" STAKE  
 MULCH TO BACK OF CURB (TYP.)  
 EXISTING CURB (TYP.)  
 WATERSHED-IN CLEAN  
 BACK FILL (SEE SPEC.)  
 UNDISTURBED/  
 STABILIZED SOIL  
 SET ROOTBALL  
 1'-2' ABOVE FINISH GRADE  
 CLEAR TRUNK TO 8'-6"  
 INSTALL SUMP IN AREAS WHERE  
 SOIL IS COMPACT AND/OR  
 WATER TABLE IS 2" BELOW  
 FINISH GRADE OR HIGHER.  
 DEPTH OF SUMP TO BE EQUAL TO  
 DEPTH OF POORLY DRAINED SOILS  
 OR 48", WHICHEVER IS GREATER.  
 3X FOOT BALL SIZE

PALMATE PALM DETAIL: CIGAR CUT  
 N.T.S.

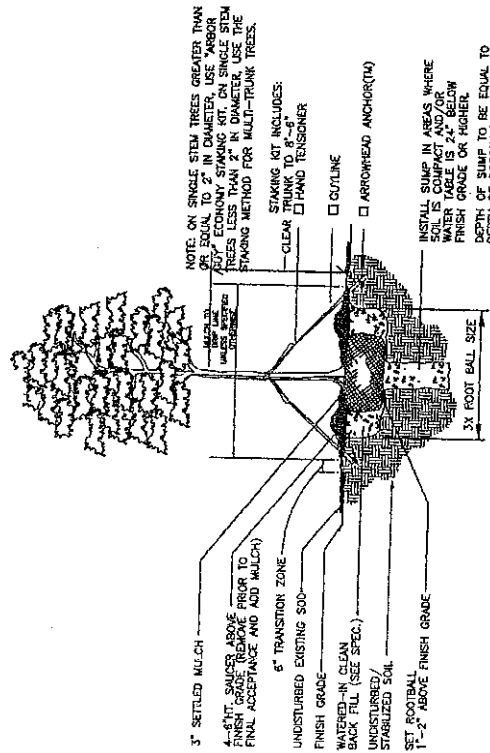

NOTE: ON SINGLE STEM TREES GREATER THAN  
 OR EQUAL TO 2" IN DIAMETER, USE YARNS  
 AND ECONOMY STAKING KIT. ON SINGLE STEM  
 TREES LESS THAN 2" IN DIAMETER, USE THE  
 STAKING METHOD FOR MULTI-TRUNK TREES.  
 STAKING KIT INCLUDES:  
 CLEAR TRUNK TO 8'-6"  
 HAND TENSIONER  
 CUTLINE  
 ARROWHEAD ANCHOR(T4)  
 3" SETTLED MULCH  
 4-8" T. SALICER ABOVE  
 FINISH GRADE (REMOVE PRIOR TO  
 FINAL ACCEPTANCE AND ADD MULCH)  
 UNDISTURBED EXISTING SOIL  
 FINISH GRADE  
 WATERSHED-IN CLEAN  
 BACK FILL (SEE SPEC.)  
 UNDISTURBED/  
 STABILIZED SOIL  
 SET ROOTBALL  
 1'-2' ABOVE FINISH GRADE  
 CLEAR TRUNK TO 8'-6"  
 INSTALL SUMP IN AREAS WHERE  
 SOIL IS COMPACT AND/OR  
 WATER TABLE IS 2" BELOW  
 FINISH GRADE OR HIGHER.  
 DEPTH OF SUMP TO BE EQUAL TO  
 DEPTH OF POORLY DRAINED SOILS  
 OR 48", WHICHEVER IS GREATER.  
 3X FOOT BALL SIZE

SINGLE TRUNK TREE STAKING & PLANTING DETAIL  
 NOT TO SCALE

PLANT & MATERIAL LIST		LOCATION								TOTALS	NOTES
DESCRIPTION		SHEET 3	SHEET 4	SHEET 5	SHEET 6						
COMMON NAME / SCIENTIFIC NAME	SIZE										
TREES / PALMS											
Laurel Oak - <i>Quercus laurifolia</i>	12-14' ht, 3" - 3-1/2" caliper, 5' - 6' spread	6	3	2	7					18	straight trunks, full dense crown
Live Oak - <i>Quercus virginiana</i>	12-14' ht, 3" - 3-1/2" caliper, 5' - 6' spread	8	2	3	5					18	straight trunks, full dense crown
Jacaranda - <i>Jacaranda mimosifolia</i>	12-14' ht, 3" - 3-1/2" caliper, 5' - 6' spread	3	3	3	3					12	straight trunks, full dense crown
Sabal Palm - Sabal palmetto	10' - 16', staggered min. diam. 15"	35	44	28	38					145	straight trunks, fully booted
Slash Pine - <i>Pinus elliotti</i> 'Densa'	12-14' ht, 3" - 3-1/2" caliper, 48"-54" spread	16	10	15	9					49	straight trunks, full dense crown
Dahoon Holly - <i>Ilex cassine</i>	10-12' ht, 2-1/2" caliper, 36"-42" spread	13	7	4	9					31	straight trunks, full dense crown
Red Maple - <i>Acer rubrum</i>	12-14' ht, 3" - 2-1/2" caliper, 36"-42" spread	6	11	6	7					30	straight trunks, full dense crown porties originating from Florida seed
Bald Cypress - <i>Taxodium distichum</i>	12-14' ht, 3" - 3-1/2" caliper, 48"-54" spread	3	9	11	5					28	straight trunks, full dense crown
East Palatka Holly - <i>Ilex x attenuata</i>	10-12' ht, 2-1/2" caliper, 38"-44" spread	8	16	22	18					62	straight trunks, full dense crown
Sweet Bay Magnolia virginiana	10-12' ht, 2-1/2" caliper, 36"-42" spread	5	3	5	10					23	straight trunks, full dense crown
Pine Bark Mulch	2 cu. feet bag 2 bags per tree	292	216	200	216					834	

- \* Tree height, spread, and caliper should be consistent with "Grades and Standards"
- \* Shrubs planted within clear sight limits shall be maintained at 24" ht. maximum
- \* Accent trees within limits of clear sight shall be maintained with 8'-5" clear trunks.
- \* Trees within limits of clear sight shall be maintained with 8'-6" clear trunks.
- \* Comparable field grown plant material of the same species may be substituted for container grown material and vice versa with the Landscape Supervisor's approval
- \* Any species substitution of plant material will need to be approved by the Department and/or District Landscape Manager

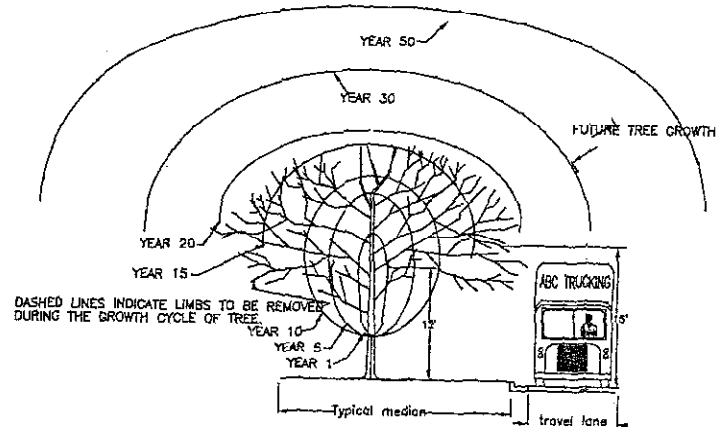

### BROAD SPREADING TREE PLANTING AND MAINTENANCE FOR ROADSIDE PLANTING ON ROADWAYS

1. SELECT SINGLE LEADER TREES WITH UPRIGHT GROWTH HABIT IN YOUNG TREES.
2. PRUNE LOWER LIMBS AS TREE MATURES TO REMOVE BRANCHES FROM LOWER PORTION OF TREE, UP TO A HEIGHT OF TWELVE FEET (12').
3. AS TREE MATURES REMOVE ALL DOWNWARD GROWING LIMBS AS DEPICTED BY DASHED LINES IN GRAPHICS ABOVE.
4. INSPECT AND PRUNE TREES EACH YEAR FOR FIRST FIVE (5) YEARS OF PROGRAM PLANTING. INSPECT AND PRUNE EVERY OTHER YEAR THEREAFTER AS REQUIRED. MAINTAIN FIFTEEN (15') FEET OF CLEARANCE OVER TRAVEL LANES FOR LIFE OF THE TREE.



DAVID M. JONES JR. AND ASSOCIATES, INC.  
LANDSCAPE ARCHITECTS AND PLANNERS  
221 MAGNOLIA BOULEVARD NORTH MYRTLE BEACH, FLORIDA 33901  
(813) 681-3022 FAX (813) 681-4494

DEPARTMENT OF TRANSPORTATION  
LEE COUNTY  
SOUTHWEST FLORIDA (239) 694-3834

LANDSCAPE ARCHITECTURAL PLAN FOR  
SR 78 & I-75 INTERCHANGE  
North Fort Myers  
LEE COUNTY, FLORIDA

PROJECT NO.  
575-01-055

DATE  
6-9-03

SHEET DESCRIPTION:  
LANDSCAPE NOTES AND DETAILS

REVISED DATE:

SHEET NUMBER:  
1-9

EXHIBIT A PAGE 9 OF 29

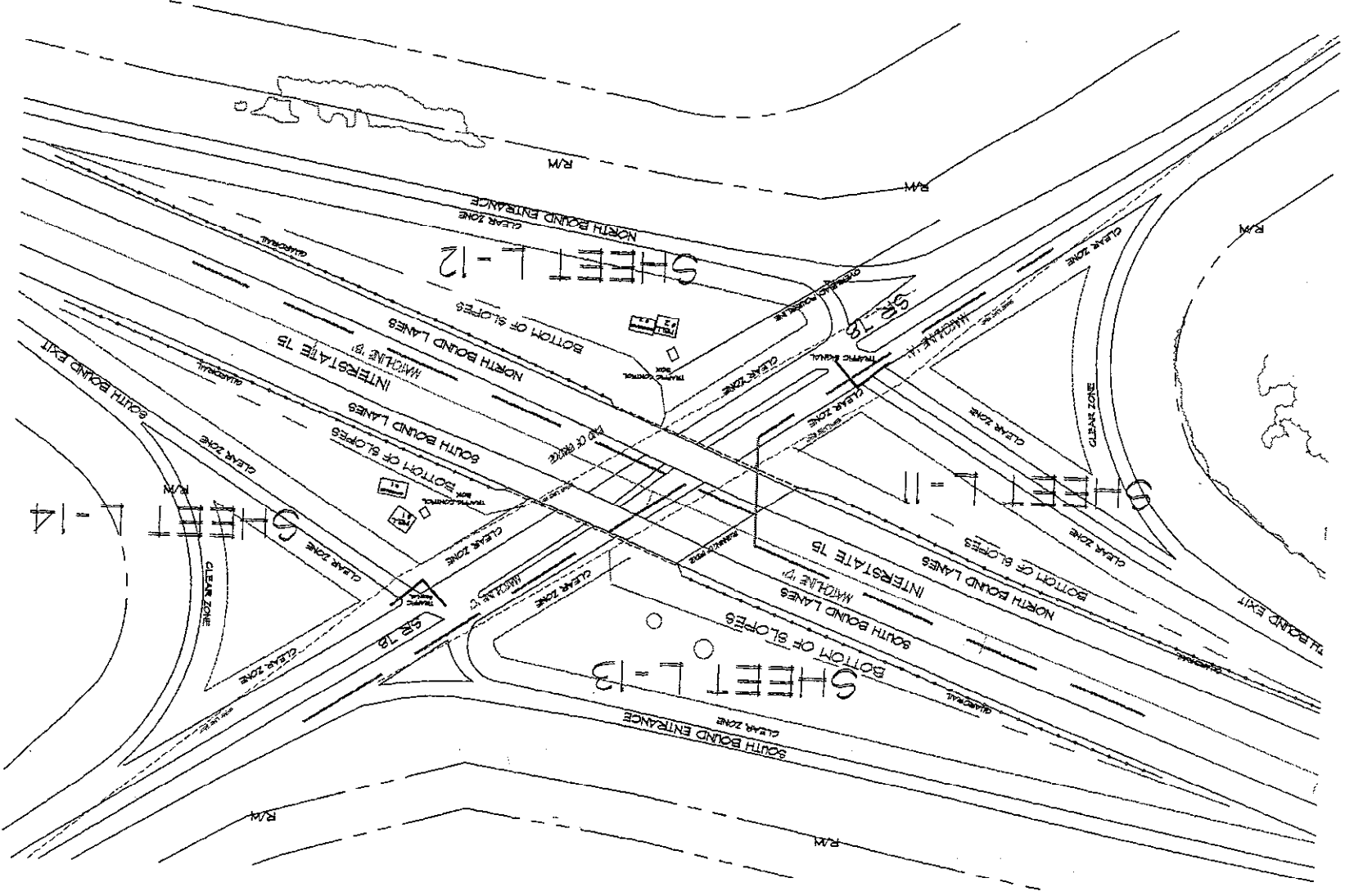

SCALE 1" = 100'



REVISION DATA

PROJECT NO. 576-01-045  
 DATE 6-9-03  
 SHEET DESCRIPTION Interchange  
 Key

LANDSCAPE ARCHITECTURAL PLANS FOR  
**SR 78 & I-75 INTERCHANGE**  
 North Fort Myers  
 LEWIS COUNTY, FLORIDA

DEPARTMENT OF TRANSPORTATION  
 LEWIS COUNTY  
 SOUTH WEST FLORIDA (250) 964-3334

DAVID M. JONES JR. AND ASSOCIATES, INC.  
 LANDSCAPE ARCHITECTS AND PLANNERS  
 221 WILSON BLVD. SUITE 200  
 FORT WORTH, TEXAS 76102  
 (817) 337-5502 FAX (817) 337-4784







DAVID M. JONES JR. AND ASSOCIATES, INC.  
 LANDSCAPE ARCHITECTS AND PLANNERS  
 2221 MCGONSON BLVD. FORT MYERS, FLORIDA, 33901  
 (813) 337-5525 FAX (813) 337-4944

DEPARTMENT OF TRANSPORTATION  
 LIBR COUNTY  
 WESTWEST FLORIDA (239) 884-2334

LANDSCAPE ARCHITECTURAL PLANS FOR  
 SR 78 & I-75 INTERCHANGE  
 North Fort Myers  
 LEE COUNTY, FLORIDA

PROJECT NO. 518-01-06S

DATE: 6-9-03

SHEET DESCRIPTION: Irrigation Plan

SHEET NUMBER: L-11

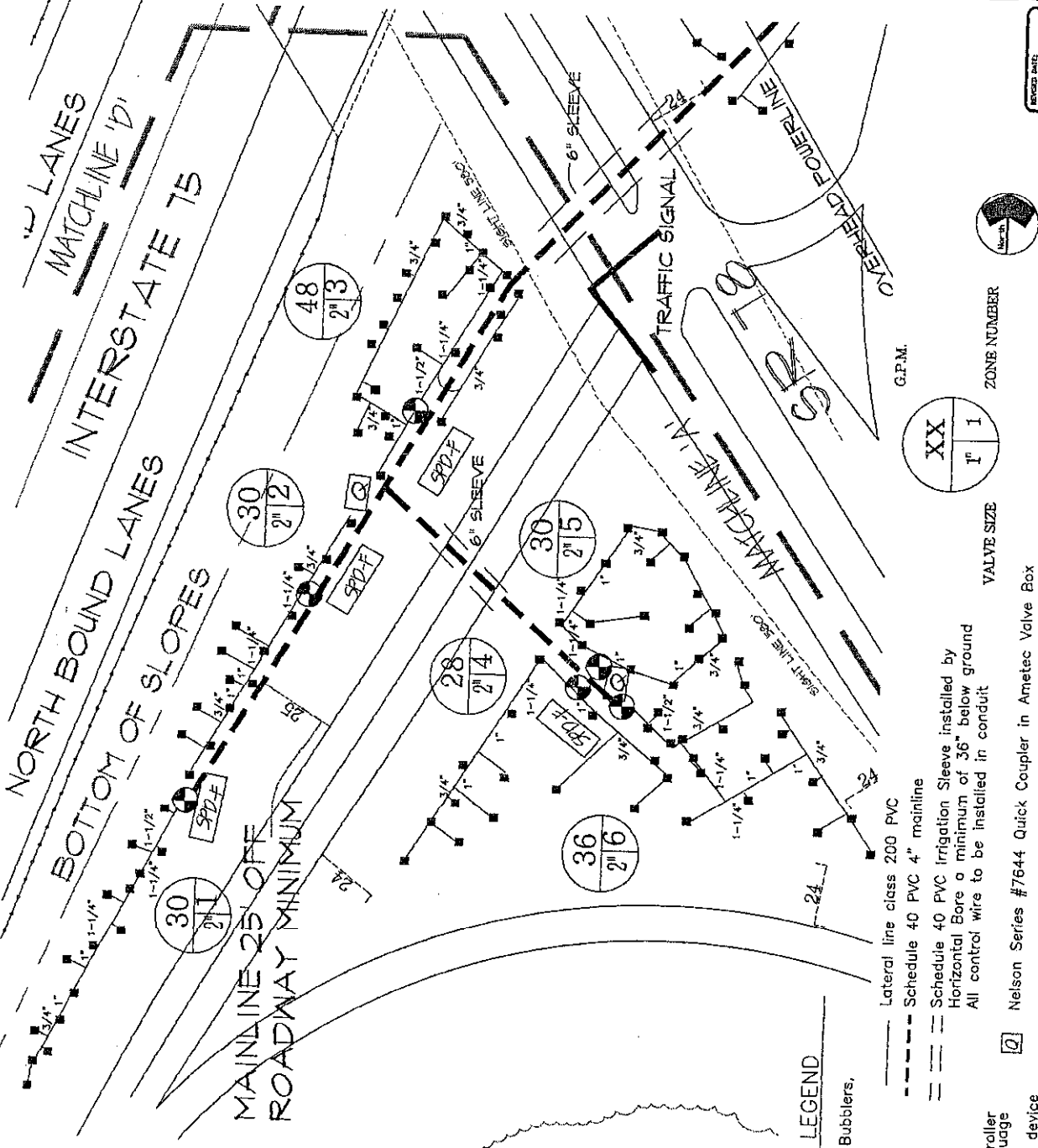

RECORD DATE:

SCALE 1" = 40'

G.P.M.

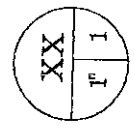

ZONE NUMBER

VALVE SIZE

IRRIGATION LEGEND

- Qual. tree bubbler
- Rainbird UX8-360-050 Bubbler, 35 gph @ 30 psi
- Rainbird 200-PEB Series Remote Control Valve w/ HIT LOGIC decoder in Ametec valve Box
- Irrigation Wells providing 50 gpm 3 HP Submersible
- Hit Logic 2, Two Wire, Controller with Rainswitch and Rain Gauge
- Hit SPD-F surge protection device
- Lateral line class 200 PVC
- Schedule 40 PVC 4" mainline
- Schedule 40 PVC Irrigation Sleeve installed by Horizontal Bore a minimum of 36" below ground
- All control wire to be installed in conduit
- Nelson Series #7644 Quick Coupler in Ametec Valve Box

EXHIBIT A PAGE 11 OF 29

IRRIGATION LEGEND

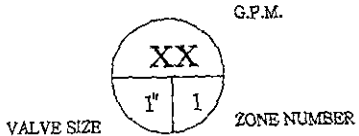

G.P.M. ZONE NUMBER

- Dual tree bubbler
- Rainbird UXB-360-050 Bubblers, 35 gph @ 30 psi
- Rainbird 100-PEB Series Remote Control Valve w/ HIT LOGIC decoder in Ametec Valve Box
- W1 W2 Irrigation Wells providing 50 gpm 3 HP Submersible
- C1 C2 Hit Logic 2, Two Wire Controller with Rainswitch and Rain Gauge
- SPD-F Hit SPD-F surge protection device
- Nelson Series #7644 Quick Coupler in Ametec Valve Box
- Lateral line class 200 PVC
- - - - Schedule 40 PVC 4" mainline
- == == == Schedule 40 PVC Irrigation Sleeve installed by Horizontal Bore a minimum of 36" below ground. All control wire to be installed in conduit.

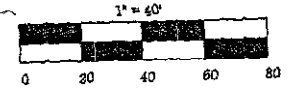
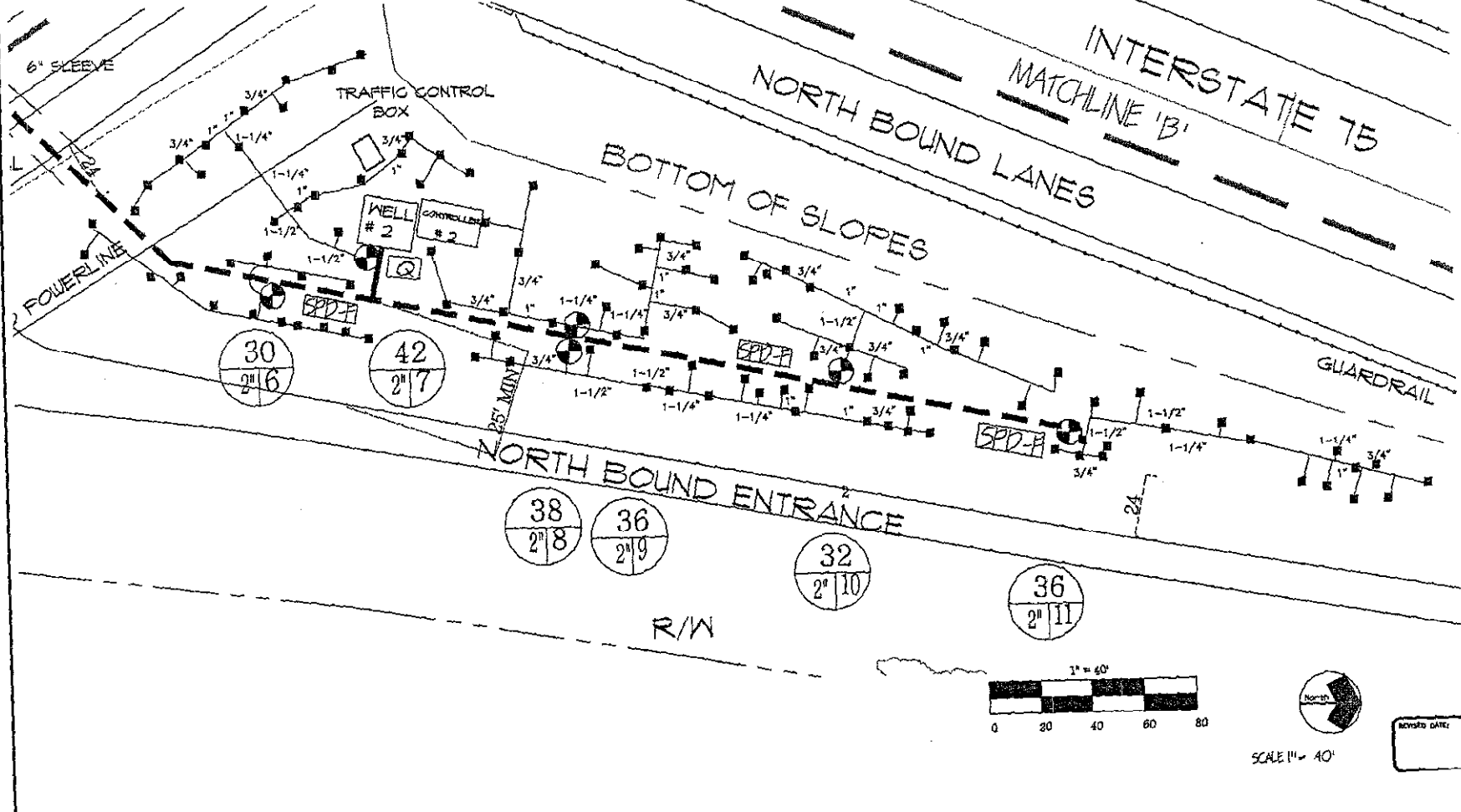

SCALE 1" = 40'



DAVID M. JONES JR. AND ASSOCIATES, INC.  
 LANDSCAPE ARCHITECTS AND PLANNERS  
 10000 W. BAYVIEW BLVD., SUITE 100  
 MIAMI, FLORIDA 33147  
 (305) 371-0000 FAX (305) 371-0000

DEPARTMENT OF TRANSPORTATION  
 FLORIDA COUNTY  
 SOUTH WEST FLORIDA (CSB) 984-3884

LANDSCAPE ARCHITECTURAL PLANS FOR  
 S.R. 78 & I-75 INTERCHANGE  
 North Fort Myers  
 LEE COUNTY, FLORIDA

PROJECT NO. 575-11-02











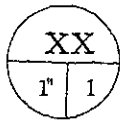

DATE 6-9-03

SHEET DESCRIPTION Irrigation Plan

SHEET NUMBER L-12

REVISED DATE:

IRRIGATION LEGEND

-  VALVE SIZE  
 ZONE NUMBER
-  G.P.M.
-  Dual tree bubbler  
 2-Rainbird UXB-360-050 Bubblers, 35 gph @ 30 psi
-  Rainbird 200-PEB Series Remote Control Valve w/ HIT LOGIC decoder in Ametec Valve Box
-  Irrigation Wells providing 50 gpm 3 HP Submersible
-  Hit Logic 2, Two Wire Controller with Rainswitch and Rain Gauge
-  Hit SPD-F surge protection device
-  Nelson Series #7644 Quick Coupler in Ametec Valve Box
-  Lateral line class 200 PVC
-  Schedule 40 PVC 4" mainline
-  Schedule 40 PVC Irrigation Sleeve installed by Horizontal Bore a minimum of 36" below ground  
 All control wire to be installed in conduit

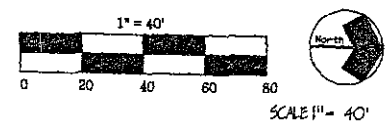
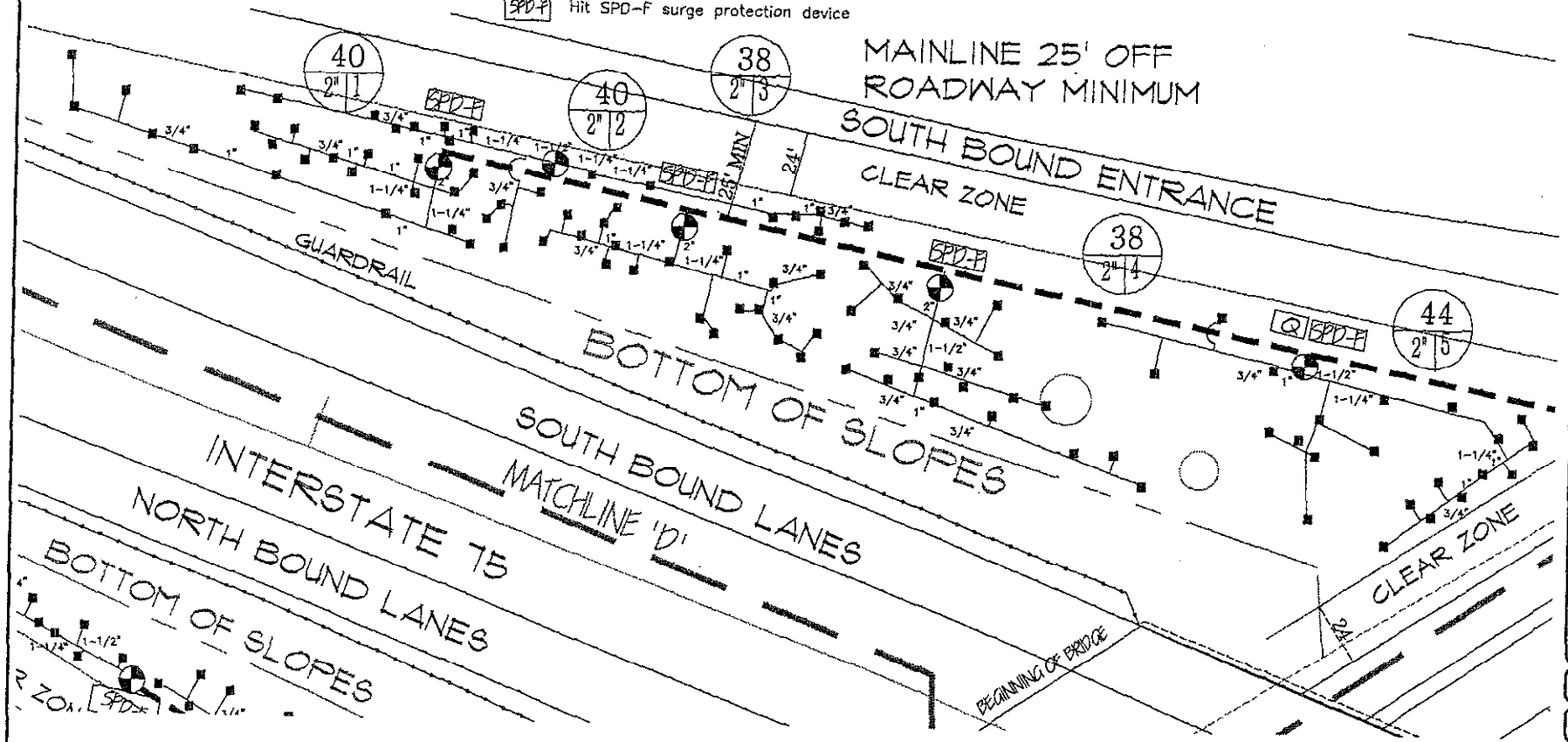

DAVID M. JONES JR. AND ASSOCIATES, INC.  
 LANDSCAPE ARCHITECTS AND PLANNERS  
 221 MADRIDOR BOULEVARD, FORT MYERS, FLORIDA 33901  
 (813) 387-4525 FAX (813) 387-4484

DEPARTMENT OF TRANSPORTATION  
 LEE COUNTY  
 100 STATE STREET, FORT MYERS, FLORIDA 33901  
 (239) 894-3384

LANDSCAPE ARCHITECTURAL PLANS FOR  
 S.R. 78 & I-75 INTERCHANGE  
 NORTH FORT MYERS, LEE COUNTY, FLORIDA

PROJECT NO.	575-01-065
DATE	6-9-03
SHEET DESCRIPTION	Irrigation Plan
REVISION DATE:	
SHEET NUMBER	L-13

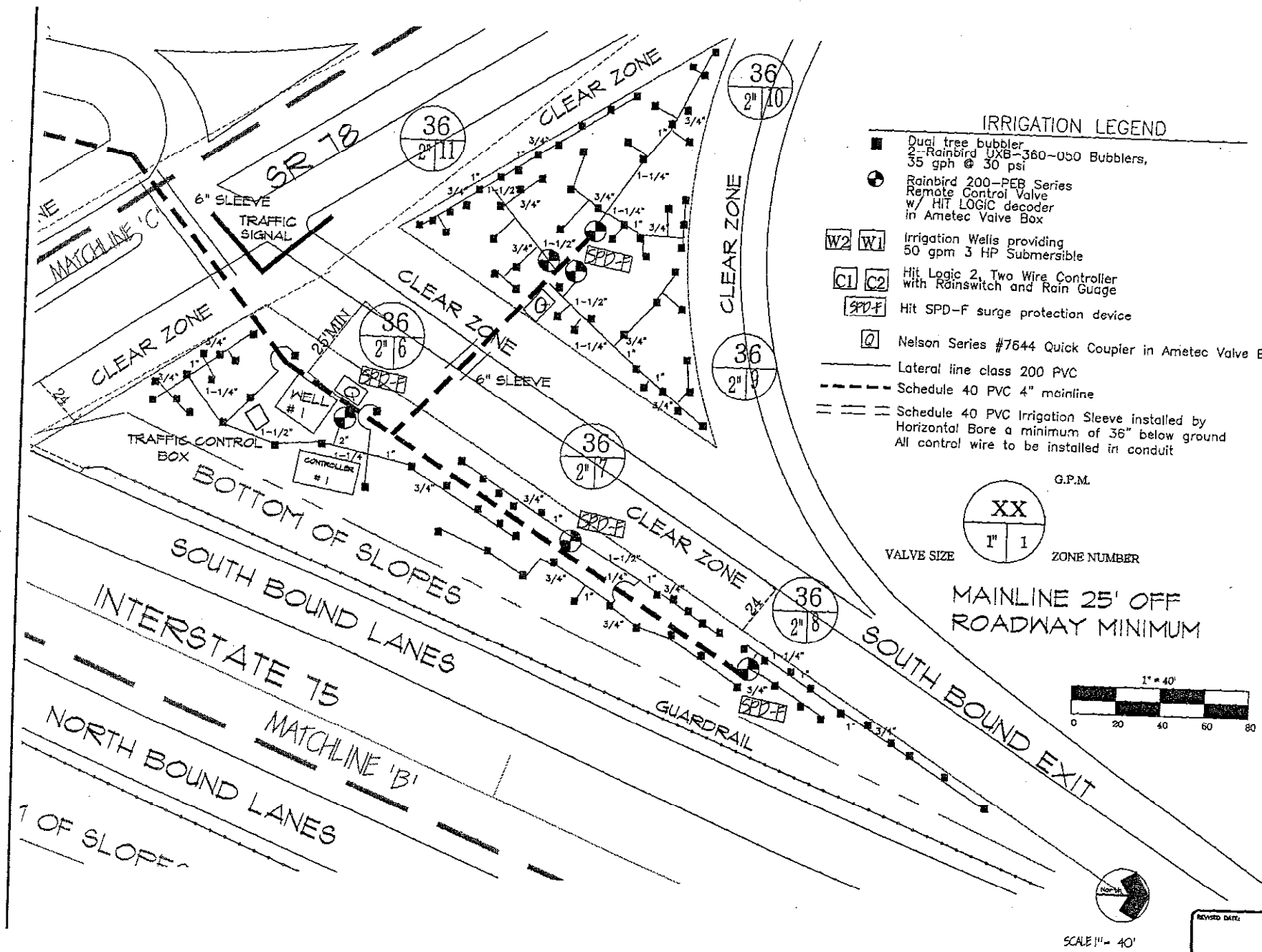

**IRRIGATION LEGEND**

- Dual tree bubbler
- Rainbird UXB-360-050 Bubblers, 35 gph @ 30 psi
- ⊕ Rainbird 200-PEB Series Remote Control Valve w/ HIT LOGIC decoder in Ametec Valve Box
- W2 W1 Irrigation Wells providing 50 gpm 3 HP Submersible
- C1 C2 Hit Logic 2, Two Wire Controller with Rainswitch and Rain Gauge
- SPD-F Hit SPD-F surge protection device
- Q Nelson Series #7644 Quick Coupler in Ametec Valve Box

- Lateral line class 200 PVC
- - - Schedule 40 PVC 4" mainline
- Schedule 40 PVC Irrigation Sleeve installed by Horizontal Bore a minimum of 36" below ground
- All control wire to be installed in conduit

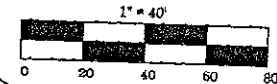
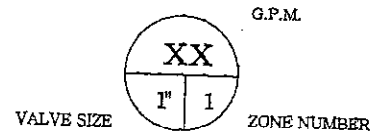

**DAVID M. JONES JR. AND ASSOCIATES, INC.**  
 LANDSCAPE ARCHITECTS AND PLANNERS  
 2211 MACDONALD BOULEVARD, FORT MYERS, FLORIDA, 33901  
 (813) 337-8525 FAX (813) 337-4464

DEPARTMENT  
 OF  
 TRANSPORTATION  
 LEE COUNTY  
 SOUTH WEST FLORIDA (888) 894-3534

LANDSCAPE ARCHITECTURAL PLANS FOR  
**S.R. 78 & I-75 INTERCHANGE**  
 North Fort Myers  
 LEE COUNTY, FLORIDA

PROJECT NO. 576-01-065  
 DATE: 6-9-03  
 SHEET DESCRIPTION: Irrigation Plan  
 SHEET NUMBER: L-14



DAVID M. JONES JR. AND ASSOCIATES, INC.  
 LANDSCAPE ARCHITECTS AND PLANNERS  
 2221 MADISON BLVD., SUITE 100  
 FORT MYERS, FLORIDA 33901  
 (889) 337-6525 FAX (889) 337-4494

DEPARTMENT OF TRANSPORTATION  
 LEES COUNTY  
 SOUTHWEST FLORIDA (889) 684-3334

LANDSCAPE ARCHITECTURAL PLANS FOR  
 SR 78 & I-75 INTERCHANGE  
 North Fort Myers  
 LEES COUNTY, FLORIDA

PROJECT No. 576-01-065

DATE 6-9-03

SHEET INFORMATION  
 NOTES AND DETAILS

SHEET NUMBER  
 L-15

REVISED DATE

SLEEVE DETAIL  
 NOT TO SCALE

WELL NOTE: 2 WELLS 120"-140" DEEP, SANDSTONE  
 AQUIFER, CASING DEPTH 80"-100"  
 REFER TO PUMP DETAIL

NOTE: CONTRACTOR SHALL REFER TO IRRIGATION PLANS  
 FOR BUBBLER LOCATIONS AND REFERENCED IRRIGATION  
 AS-BUILT DRAWINGS.

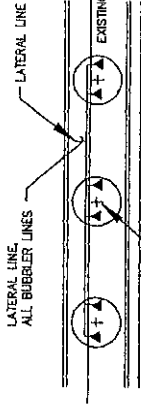

BUBBLER LINE INSTALLATION  
 NOT TO SCALE

SECURE TWO BUBBLERS IN CENTER OF ROOT BALL  
 AND 180° APART WITH XERT-STAKE ON UPHILL SIDE.

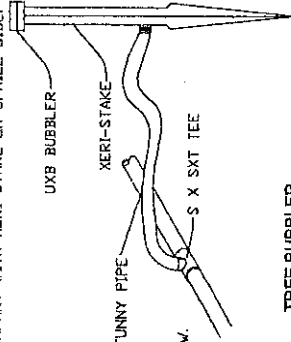

TREE BUBBLER  
 NOT TO SCALE

ADJUST BUBBLER  
 FOR PROPER FLOW.

PULSE & COMMON CONTROL WIRES  
 PVC INNER CONDUIT FOR  
 PULSE & COMMON WIRES  
 IRRIGATION MAIN LINE  
 SLEEVE AS NOTED ON PLANS

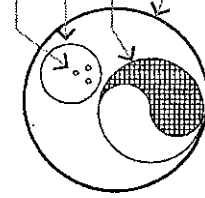

NOTE:  
 PVC WIRE CONDUIT SHALL BE ONE CONTINUOUS RUN LENGTH FOR  
 IRRIGATION RUNS LESS THAN 20'. RUNS OF GREATER THAN 20' SHALL  
 HAVE SOLVENT WELD JOINTS.

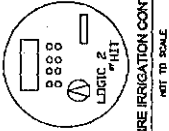

TWO WIRE IRRIGATION CONTROLLER  
 NOT TO SCALE

KEY	DESCRIPTION	LOCATION				NOTES
		SECT 11	SECT 12	SECT 13	TRAILS	
1	Dual Tree bubbler 2-Rainbird UNB-350-050 Bubblers, 35 GPH @ 30 PSI	10	100	III		417
2	Rainbird 200-PEB Series Remote Control Valve w/ HIT LOGIC decoder in Anetec Valve Box	6	5	6		25
3	Irrigation Valve providing 50 gpm at 50 psi	1	1	1		2
4	HIT Logic 2, Two Wire Controller with Rainswitch and Rain Gauge	1	1	1		2
5	Nelson Series #7644 Quick Coupler in Anetec Valve Box	2	1	2		6
6	Lateral line class 200 PVC					
7	Schedule 40 PVC 4" mainline					
8	Schedule 40 PVC Irrigation Sleeve provided by HPC. Install bore a minimum of 3/8" below ground.					
9	HIT SPD-F surge protector, one at each end and at least every 300' in between.	4	3	4	4	15
10	All control wire to be installed in conduit.					

NOTE: MAINLINE TO HAVE METAL DETECTION TAPE  
 INSTALLED IN TRENCH PER FOOT'S UTILITY  
 ACCOMMODATION MANUAL

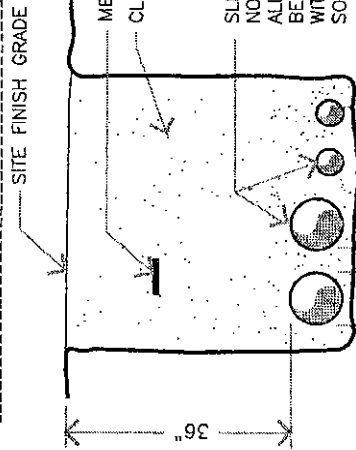

METAL DETECTION TAPE  
 CLEAN BACKFILL

SLEEVES - SIZE AS  
 NOTED ON PLANS.  
 ALL SLEEVES SHALL  
 BE SCH. 40 PVC  
 WITH ALL JOINTS  
 SOLVENT WELDED.

MAINTAIN MIN. 4" OF CLEAN BACKFILL  
 SEPARATING ALL SLEEVES.

SET TOP OF SLEEVES 3/8" BELOW SITE FINISH GRADE  
 AT SLEEVE LOCATION. BACKFILL TRENCH WITH CLEAN  
 FILL MATERIAL FREE OF ORGANIC MATERIAL AND ROCK.

EXTEND SLEEVES 3/8" BEYOND THE OUTSIDE  
 EDGE OF PAVEMENT OR BACK OF CURB. STAKE EACH

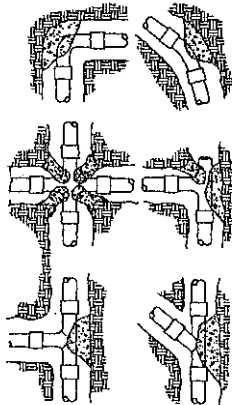

THRUST BLOCKS SHALL BE CONSTRUCTED BEHIND  
 ALL MAIN LINE FITTINGS, TEES, BENDS, REDUCERS,  
 LINE VALVES, PLUGS, CAPS, ETC., IN ACCORDANCE  
 WITH PIPE MANUFACTURERS RECOMMENDATIONS.  
 THRUST BLOCK SHALL BEAR AGAINST UNDISTURBED  
 EARTH AND IN CASE THIS IS NOT POSSIBLE, THEY  
 SHALL BE MADE CORRESPONDINGLY LARGER.  
 THRUST BLOCKS SHALL BE SO PLACED AS NOT TO  
 INTERFERE WITH REPAIR TO JOINTS AND COUPLINGS  
 AND SHALL BE A CONCRETE MIX CONSISTING OF  
 ONE PART CEMENT, TWO PARTS SAND, AND 5 PARTS  
 GRAVEL, MIXED AND PLACED FAIRLY DRY SO THEY  
 MAY BE SHAPED EASILY. NO PRECAST UNITS SHALL  
 BE USED.

PROVIDE & INSTALL 15# ROOFING FELT AS A SEPARATOR  
 BETWEEN PIPE, FITTINGS & THRUST BLOCKS; PLACE  
 CONCRETE DIRECTLY AGAINST FELT BUT NOT AGAINST  
 PVC.

THRUST BLOCKS SHALL BE  
 INSPECTED PRIOR TO BACKFILLING.

THRUST BLOCKING  
 NOT TO SCALE

EXHIBIT A PAGE 15 OF 29



DAVID M. JONES, R.R. AND ASSOCIATES, INC.  
 LANDSCAPE ARCHITECTS AND PLANNERS  
 2221 MACDONALD BLVD., SUITE 200  
 FORT MYERS, FLORIDA 33901  
 (813) 537-8822 FAX (813) 537-4434

DEPARTMENT OF TRANSPORTATION  
 LEE COUNTY  
 (SOUTHWEST FLORIDA 229) 694-3304

LANDSCAPE ARCHITECTURAL PLANS FOR  
 SR 78 & I-75 INTERCHANGE  
 NORTH FORT MYERS  
 LEE COUNTY, FLORIDA

PROJECT NO. 578-01-069

DATE 6-9-03

SHEET INFORMATION NOTES AND DETAILS

SHEET NUMBER  
 T-16

REVISED DATE

TYPICAL IRRIGATION NOTES

- All valves, splices within valve control lines, and quick couplers shall be located within specified valve boxes as follows: section valves, quick couplers and/or hose bibs - 10" circular valve box; gate valves - 7" circular valve box; filters and other installations requiring more space - rectangular 12" x 17".
- Verify locations of all underground utilities prior to installation of irrigation system. Main line, pump station and controller shall not be located without prior approval of the project construction manager and the landscape architect. All utilities and structures may not be shown on these plans - contractor shall verify.
- All pressurized main lines under asphalt pavement shall be within sleeves as noted where electric or hydraulic valve control lines pass through a sleeve with other main or lateral lines they shall be contained within a separate, smaller conduit.
- All irrigation heads shall be directly responsible for all alleaving and directional bores.
- All irrigation heads shall be located 18 inches from back of curb when next to roadway.
- Locate all valves in planting beds or matched areas beyond the required horizontal clearance distance at a minimum.
- All unsize pipe shall be 3/4" unless otherwise noted.
- Each tree and palm (as shown on the plans) shall have two (2) adjustable flood bubblers. Such heads shall be on a minimum 5'-0" length of flexible pipe to allow its positioning at the tree. Locate bubblers on the uphill side of trees on all slopes. Locate bubblers in the center of the roadball and 180° apart.
- Number the top of all valve box lids with a minimum 1" height block letters to correspond to automatic and gate valve designations. All hose bibb or quick coupler valve boxes shall be labeled in a similar manner with the designation "HG" or "QC". Label inside of time clock cabinet door to correspond with irrigation clock program designation.
- All 24 volt wiring shall be UF direct burial copper wire as follows:  
 Pulse Wires - #10 gauge red color  
 Common Wires - #10 gauge white color
- Control wiring for valves shall be laid in trenches beneath mainline.
- During installation and upon completion of the irrigation system valves shall be wired to controller station as per the irrigation program.
- One (1) foot below site finish grade, and above all mains, the irrigation contractor shall install a color coded metal detectable marking tape which clearly notes "Caution: Irrigation Line Buried Below." Tape as manufactured by Lineguard, Inc. Wheaton, IL 60187.
- Contractors are advised to refer to the specifications, contract documents, and plan sheets for a more detailed disclosure of performance standards and requirements.
- Mainline and valves are shown in schematic form. Locate as noted on plans.
- Irrigation mainline and lateral line to be buried at a depth of 24" minimum unless noted otherwise.
- All alleaves utilized by the irrigation contractor, whether used by him or not, shall be located on the "as built" drawings. The depth below finish grade, to the nearest foot of each end of each sleeve, shall be noted at each sleeve location on the "as built" drawings.
- Irrigation contractor shall secure any and all necessary permits for the work prior to commencement of his operations on site. Copies of the permits shall be sent to the landscape supervisor. Work in the R.O.W. shall conform to the standards and specifications of local and/or state highway jurisdiction.
- Contractor shall provide and coordinate all work involving well installation.
- Installation of work shall be coordinated with other contractors in such a manner as to allow for a speedy and orderly completion of all work on the site.
- Restore all disturbed areas. Seed areas that are less than 12" wide with Argentine Bahia Grass at the rate of 10 lbs. per 1000 square feet. Sod areas 12" or wider with Argentine Bahia Grass Sod. Provide a smooth transition between the repaired disturbed areas and the undisturbed areas.
- Contractor shall install a Hit SPD-F Surge Protection Device at each end of the wires and at least every 300' in between. With each surge protection device, contractor shall install a grounding rod, using appropriate ground rod parameters for the soil type and location.
- Contractor shall completely solder wires together in all 24 volt electrical wire splice connections before applying wire nuts and dry type connectors (3M DBY or Hit DBC Seal Pack Connectors).
- Contractor shall install each controller with two 8" copper clad rods with #6 solid copper wire. Copper clamps will be used to attach the wire to the rods.
- The pump station equipment shall be protected by a fence or contained within a locking covered enclosure.
- All proposed sleeves to conform to FDOT's utility accommodation manual, latest edition.

EXHIBIT A PAGE 16 OF 29

NOTE: DISCHARGE PIPES & HOVER TO IRRIGATION MAIN SHALL BE SCHEDULE 40  
 X PRESSURE CONTROL VALVE LOGIC 12 STATIONS WITH RAIN SENSOR  
 X PRESSURE TANK FOR PRESSURE DEMAND SYSTEMS  
 X PRESSURE TANK FOR PRESSURE DEMAND SYSTEMS

SAFETY FEATURES ARE INCLUDED IF MARKED WITH AN "X"  
 X PRESSURE CONTROL VALVE LOGIC 12 STATIONS WITH RAIN SENSOR  
 X PRESSURE TANK FOR PRESSURE DEMAND SYSTEMS  
 X PRESSURE TANK FOR PRESSURE DEMAND SYSTEMS

SAFETY FEATURES:  
 PRESSURE DEMAND  
 FIBERGLASS ENCLOSED  
 LOW PRESSURE  
 SERVICE REQUIRED

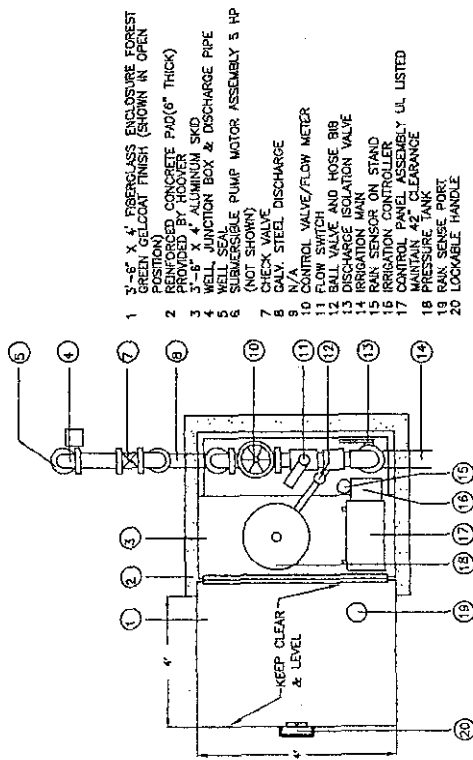

PLAN VIEW HTS  
 PUMP PERFORMANCE  
 30 GPM @ 180 TSD

FILE PN4973.DWG 05/03  
 LEE CO. SR78 & I-75 INTERCHANGE  
 SUBMERSIBLE PUMP SYSTEM DETAIL  
 FIBERGLASS ENCLOSED SINGLE WELL SUCTION  
 PRESSURE DEMAND  
 #2 REQUIRED

HOVER PUMPING MODEL - HSF-SPDAE-12.M.V.Z  
 Pompano Beach, Florida, Tel: 954-971-7350



DAVID M. JONES JR. AND ASSOCIATES, INC.  
LANDSCAPE ARCHITECTS AND PLANNERS  
2227 W. HORTON BLVD., SUITE 200  
FORT WORTH, TEXAS 76102  
(817) 337-5525  
(817) 337-5525 FAX

DEPARTMENT OF TRANSPORTATION  
SR 78 & I-75 INTERCHANGE  
LANDSCAPE ARCHITECTURAL PLANS FOR  
North Fort Myers  
LEE COUNTY, FLORIDA  
SOUTHWEST FLORIDA (888) 684-0334

PROJECT NO. 576-01-066  
DATE: 5-30-03

SHEET DESCRIPTION:  
MAINTENANCE OF TRAFFIC PLANS  
SHEET NUMBER: 1-17

**SYMBOLS**

The symbols shown are found in the Traffic Control Zone Cell Library (TCZCell) on the CAD system. Symbols assigned to the 600 series Roadway Design Standards are applicable to traffic control plans, unless otherwise identified in the plans, are as follows:

- Work Area, Hazard Or Work Phase (Any pattern within a boundary)
- Sign With 18" x 18" (Min.) Orange Flag And Type B Light
- Type I Or Type II Barricade Or Vertical Panel Or Drum
- Type I Or Type II Barricade Or Vertical Panel Or Drum (With Flashing Light At Night Only)
- Type I Or Type II Barricade Or Vertical Panel Or Drum (With Steady Burning Light At Night Only)
- Cone Or Tubular Marker
- Type I, Type II Or Type III Barricade Or Vertical Panel Or Drum (With Flashing Light)
- Type I, Type II Or Type III Barricade Or Vertical Panel Or Drum (With Steady Burning Light)
- Type III Barricade (With Flashing Light)
- Type III Barricade (With Steady Burning Light)
- Flagger
- Traffic Signal
- Advance Warning Arrow Panel
- Portable Signal
- Crash Cushion
- Slip Bar
- Work Vehicle With Flashing Beacon
- Shadow (S) Or Advance Warning (AW) Vehicle With Advance Warning Arrow Panel And Warning Sign
- Track Mounted Attenuator (TMA)
- Orange Flag For TCZ Signs
- Type B Light For TCZ Signs
- Law Enforcement Officer
- Portable Regulatory Sign
- Radar Speed Display Unit
- Variable Message Sign

**PREFACE**

All projects and works on highways, roads and streets shall have a traffic control plan. All work shall be executed under the established and approved procedures. This plan contains the specific details for the execution of traffic control in work zones, for construction, and maintenance operations and utility work on highways, roads and streets.

Index 600 provides Department policy and standards. Changes are only to be made thru Department approved procedures. Index 600 thru 665 provide the application for various situations. Identification can be made to these index numbers as the various empty with the MUTCD, and Department Design Standards.

The sign spacings shown on the indexes are typical (recommended) dimensions. These distances may be increased or decreased based on field conditions, in order to avoid conflicts or to improve site specific traffic controls.

**MANUAL ON UNIFORM TRAFFIC CONTROL DEVICES**

The Florida Department of Transportation has adopted the "Manual On Uniform Traffic Control Devices For Streets And Highways" (MUTCD) and subsequent revisions and addendums, as published by the U.S. Department of Transportation, Federal Highway Administration, as mandatory use on the State Maintained Highway System whenever there exists the need for construction, maintenance operations or utility work.

**ABBREVIATIONS**

Abbreviations assigned to the 600 series Roadway Design Standards and applicable to traffic control plans, unless otherwise identified in the plans, are as follows:

- COMU Traffic Control Standards Committee
- DOTC District Traffic Operations Engineer
- FOOT Florida Department Of Transportation
- HAR Highway Advisory Radio
- L Taper Length, Buffer Length Or Taper Length Plus Buffer Space
- LED Low Enforcement Officer
- MOT Maintenance Of Traffic
- MUTCD Manual On Uniform Traffic Control Devices For Streets And Highways
- PRS Portable Regulatory Sign
- R Radius
- RPW Retard Reflective Pavement Marker
- RSOU Radar Speed Display Unit
- S Posted Speed Or Off-Peak 85 Percentile Speed (M.P.H.)
- TCZ Traffic Control Plan's
- TCZ Traffic Control Through Work Zones
- TMA Track Mounted Attenuator
- VMS Variable Message Sign
- VECP Value Engineering Change Proposal
- W Width Of Taper Transition In Feet (i.e., Lateral Offset)

**CONTENTS**

- Preface
- Manual On Uniform Traffic Control Devices
- Abbreviations
- Symbols
- Definitions
- Temporary Traffic Control Devices
- Pedestrians And Bicyclists
- Railroads
- Overhead Work
- Overhead/Over-size Vehicles
- Lane Widths
- Sight Distances To Belonged Devices
- Above Ground Hazard
- Clear Zone Widths
- Superelevation
- Regulatory Speeds In Work Zones
- Flagger Control
- Survey Work Zones
- Sign Placement
- Sign Covering And/Or Overlapping Work Zone Signage
- Sign Materials
- Work Zone Sign Supports
- Signing For Detours, Lane Shifts & Diversions
- Extended Distances Advance Warning Signs
- Speeding Fines Disabled When Workers Present Sign
- Length Of Road Work Sign
- Intersecting Road Signage
- End Road Work Signs
- Variable Message Signs (VMS)
- Channelizing And Lighting Devices
- Channelizing And Lighting Devices Consistency
- Repeating Pavement Markings
- Signage
- Warning Lights
- Roadside Barriers
- Track Mounted Attenuators
- Manholes/Crosswalks
- Dropoffs In Work Zones
- Temporary Curb
- Identifications-Channelizing And Lighting Devices And Advance Warning Arrow Panel Modes
- Commonly Used Warning And Regulatory Signs In Work Zones
- Pavement Markings

STATE OF FLORIDA DEPARTMENT OF TRANSPORTATION	
TRAFFIC CONTROL THROUGH WORK ZONES	
GENERAL INFORMATION FOR	
Project No.	576-01-066
Sheet No.	1 of 6
Scale	As Shown
Drawn By	[Signature]
Checked By	[Signature]
Approved By	[Signature]
Date	5/30/03

EXHIBIT A PAGE 17 OF 29

**DEFINITIONS**

**Regulatory Speed (in Work Zones)**  
 The maximum permitted travel speed posted for the work zone as indicated by the regulatory speed limit signs. The posted speed must be shown or noted in the plans. This speed shall be used as the minimum design speed to determine amount of sight triangle lengths, crash attenuation requirements, marker spacings, super-elevation and other similar features.

**Advisory Speed**  
 The maximum recommended travel speed through a curve or a hazardous area.

**Travel Way**

The intended path for vehicular traffic through or around obstructions in construction, including trees, utility and other work zones on highways, roads and streets. For traffic control through work zones, travel way limits shall be clearly marked with cones, barrels and any other permanent or temporary devices for the path of vehicular traffic.

**Diver, Lane Shift, and Diversion**

A diver is the redirection of traffic onto another roadway to bypass the temporary traffic control zone. A lane shift is the restriction of traffic onto a different, a lane shift into the original pavement. A diversion is the restriction of traffic recovery and within the limits of the right-of-way.

**Above Ground Hazard**

An above ground hazard is any object, material or equipment that protrudes from traffic control devices that encroach upon the travel way or that is located within the clear zone when the height of the object is greater than 4' in height and is firm and unyielding or doesn't meet breakaway requirements.

**TEMPORARY TRAFFIC CONTROL DEVICES**

All temporary traffic control devices shall be removed as soon as practical when they are no longer needed. When work is suspended for short periods of time, temporary traffic control devices that are no longer appropriate shall be removed or covered.

**PEDESTRIANS AND BICYCLIST**

When an existing pedestrian way or bicycle way is located within a traffic control zone, a provision must be maintained and included provision for the clearance.

Only approved temporary traffic control devices may be used to delineate a temporary traffic control zone pedestrian walkway. Advanced notification of sidewalk closures and detours marked shall be provided by appropriate signs.

**RAILROADS**

Railroad crossings affected by a construction project should be protected for traffic control to reduce queuing on the tracks. The protection should include an minimum traffic volume, distance from the tracks to the intersection, lane closure or taper locations, signal timing, etc.

**OVERHEAD WORK**

No work shall be allowed over a traffic lane using a bucket truck, unless a lane closure has been set up in accordance with the appropriate index.

**OVERWEIGHT/OVERSIZE VEHICLES**

Restrictions to Lane Widths, Heights or Load Capacity can greatly impact the movement of over dimensioning loads. The contractor shall notify the Engineer who in turn shall notify the State Penalties Office, phone no. (850) 468-4851, of least seven calendar days in advance of implementing a maintenance of traffic plan which will require the use of over-weight restricted vehicles. Information provided shall include: location, type of restriction, height, width or weight and restriction location. When the roadway is returned to normal service the State Penalties Office shall be notified immediately.

**LANE WIDTHS**

Lane widths of through roadways should be maintained through work zone travel ways whenever possible. The minimum widths for work zone travel lanes shall be as follows: If a Interstate with at least one 12' lane provided in each direction, unless expressly exempt by the Federal Highway Administration; If for Freeways and 10' for all other facilities.

**RIGHT DISTANCE TO DELINEATION DEVICES**

Transition tapers should be obvious to drivers. If restricted sight distance is not seen (e.g., a sharp vertical or horizontal curve), the taper should begin well in advance of the view obstruction. The beginning of tapers should not be hidden behind curves.

**ABOVE GROUND HAZARD**

Above ground hazards (see definitions) are to be considered work areas during working hours and treated with appropriate work zone traffic control procedures. Above ground hazards, all objects, materials and equipment that constitute a safety hazard must be stored, placed outside the travel way and clear zone or be shielded by a barrier or crash cushion.

For above ground hazards within a work zone the clear zone required should be based on the regulatory speed posted during construction.

**CLEAR ZONE WIDTHS**

The term "clear zone" describes the unobstructed relatively flat area, free of construction, extending outward from the travel lane. The clear zone should extend outward from the travel lane and roadside shoulder areas clear zone widths in work zones. The clear zone widths are to conform with the provisions to provide as described in Volume 2 of 4, sec 4.2 and Exhibit 4-A and 4-B of the Plans Preparation Manual.

WORK ZONE SPEED (MPH)	WIDTHS (feet)
60-70	30
55	24
45-50	18
30-40	14

ALL SPEEDS  
 CURB & GUTTER 4' BESHING FACE OF CURB

**SUPERELEVATION**

Horizontal curves constructed in conjunction with work zone traffic control should have the required super-elevation applied to the design width. Other conditions where normal cross slope control is required, the minimum trail that can be applied are listed in the table below.

DESIGN SPEED (MPH)	MINIMUM SUPERELEVATION (%)
10	1.5
20	2.0
30	2.5
40	3.0
50	3.5
60	4.0
70	4.5
80	5.0
90	5.5
100	6.0

Source: Florida Dept. of Transportation

STATE OF FLORIDA DEPARTMENT OF TRANSPORTATION  
 TRAFFIC CONTROL THROUGH WORK ZONES  
 GENERAL INFORMATION FOR  
 TRAFFIC CONTROL THROUGH WORK ZONES

DATE: 8/17/03  
 PROJECT NO.: 800

EXHIBIT A PAGE 18 OF 29

LANDSCAPE ARCHITECTURAL PLANS FOR  
**SR 78 & I-75 INTERCHANGE**  
 North Fort Myers  
 LEE COUNTY, FLORIDA

DEPARTMENT OF TRANSPORTATION  
 LEE COUNTY  
 239) 864-3334

PROJECT NO. 800  
 DATE: 8-30-03

DESIGN ASSUMPTIONS  
 MAINTENANCE OF TRAFFIC PLANS  
 SAFETY INCREASE

**DAVID M. JONES JR. AND ASSOCIATES, INC.**  
 LANDSCAPE ARCHITECTS AND PLANNERS  
 2221 MCGREGOR BLVD. FORT MYERS, FLORIDA 33901  
 (813) 337-5525 FAX (813)



### REGULATORY SPEEDS IN WORK ZONES

Traffic Control Plans (TCPs) for all projects must include specific regulatory speeds for each phase of work. This can either be the posted speed or a reduced speed. The speed shall be noted in the TCPs; this includes indicating the existing speed if no reduction is to be made. Regulatory speeds are to be uniformly established through each phase.

In general, the regulatory speed should be established to route vehicles safely through the work zone as close to normal highway speed as possible. The regulatory speed should not be reduced more than 10 mph below the posted speed and never below the minimum statutory speed for the class of facility. When a speed reduction greater than 10 mph is imposed, the reduction is to be done in 10 mph per 500' increments.

Temporary regulatory speed signs shall be removed as soon as the conditions requiring the reduced speed no longer exist. Once the work zone regulatory speeds are removed, the regulatory speed existing prior to construction will automatically go back into effect unless new speed limit signing is provided for in the plans.

On projects with interspaced work activities, speed reductions should be located in proximity to those activities which merit a reduced speed, and not "blanketed" for the entire project. At the departure of such activities, the normal highway speed should be posted to give the motorist notice that normal speed can be resumed.

If the existing regulatory speed is to be used, consideration should be given to supplementing the existing signs when the construction work zone is between existing regulatory speed signs. For projects where the reduced speed conditions exist for greater than 1 mile in rural areas (non-interstate) and on rural or urban interstate, additional regulatory speed signs are to be placed at no more than 1 mile intervals. Engineering judgement should be used in placement of the additional signs. Locating these signs beyond ramp entrances and beyond major intersections are examples of proper placement. For urban situations (non-interstate), additional speed signs are to be placed at a maximum of 1000' apart.

When field conditions warrant speed reductions different from those shown in the TCP, the contractor may submit to the project engineer for approval by the Department, a signed and sealed study to justify the need for further reducing the posted speed, or, the engineer may request the District Traffic Operations Engineer (DTE) to investigate the need. It will not be necessary for the DTE to issue regulations for regulatory speeds in work zones due to the revised provisions of F.S. 316.074(5)(2) (b). Advisory Speed plates will be used at the option of the field engineer for temporary use while processing a request to change the regulatory speed specified in the plans when deemed necessary. Advisory speed plates cannot be used alone but must be placed below the construction warning sign for which the advisory speed is required.

For additional information refer to the FDOT Roadway Plans Preparation Manual, Volume I, Chapter 10.

### FLAGGER CONTROL

Where flaggers are used, a FLAGGER symbol or legend sign must replace the WORKERS symbol or legend sign.

The flagger must be clearly visible to approaching traffic for a distance sufficient to permit proper response by the motorist to the flagging instructions, and to permit traffic to reduce speed or to stop as required before entering the work site. Flaggers shall be positioned to maintain maximum color contrast between the flagger's reflective garments and equipment and the work area background.

### HIGH-VISIBILITY CLOTHING

For daytime work, the flagger's vest, shirt, or jacket shall be either orange, yellow, yellow-green, or a fluorescent version of these colors. For nighttime work, similar outside garments shall be retroreflective. The retroreflective material shall be either orange, yellow, white, silver, yellow-green, or a fluorescent version of these colors, and be visible at a minimum distance of 1,000 ft. The retroreflective clothing shall be designed to clearly identify the wearer as a person.

### HAND-SIGNALING DEVICES

STOP/SLOW paddles are the primary hand-signaling device. The STOP/SLOW paddle shall have an octagonal shape on a rigid handle. STOP/SLOW paddles shall be at least 26 inches wide with letters at least 6 inches high and should be fabricated from light semi-rigid material. The background of the STOP face shall be red with white letters and border. The background of the SLOW face shall be orange with black letters and border. When used at nighttime, the STOP/SLOW paddle shall be retroreflectORIZED.

Flag use is limited to immediate emergencies, intersections, and when working on centerline or shared left turn lanes where two (2) flaggers are required and there is opposing traffic in the adjacent lanes. Flags, when used, shall be a minimum of 24 inches square, made of a good grade of red material, and securely fastened to a staff that is approximately 36 inches in length. When used at nighttime, flags shall be retroreflectORIZED red.

Fleshlight, lantern or other lighted signal that will display a red warning light shall be used at night.

### FLAGGER STATIONS

Flagger stations shall be located far enough in advance of the work space so that approaching road users will have sufficient distance to stop before entering the work space. When used at nighttime, the flagger station should be illuminated.

### SURVEY WORK ZONES

The SURVEY CREW AHEAD symbol or legend sign shall be the principal Advance Warning Sign used for Traffic Control Through Survey Work Zones and may replace the ROAD WORK AHEAD sign when lane closures occur, at the discretion of the Party Chief. Type B Light or dual orange flags shall be used at all times to enhance the SURVEY CREW AHEAD sign, even with mesh signs.

When Traffic Control Through Work Zones is being used for Survey purposes only, the END ROAD WORK sign as called for on certain 600 Series Indexes should be omitted.

### Survey Between Active Traffic Lanes or Shared Left Turn Lanes

The following provisions apply to Main Roadway Traffic Control Work Zones. These provisions must be adjusted by the Party Chief to fit roadway and traffic conditions when the Survey Work Zone includes intersections.

- (A) A STAY IN YOUR LANE (MOT-1) sign shall be added to the Advance Warning Sign sequence as the second most immediate sign from the work area.
- (B) Elevation Surveys-Cones may be used at the discretion of the Party Chief to protect prism holder and flagger(s). Cones, if used, may be placed at up to 50' intervals along the break line throughout the work zone.
- (C) Horizontal Control-With traffic flow in the same direction, cones shall be used to protect the backsight tripod and/or instrument. Cones shall be placed at the equipment, and up to 50' intervals for at least 200' towards the flow of traffic.
- (D) Horizontal Control-With traffic flow in opposite directions, cones shall be used to protect the backsight tripod and/or instrument. Cones shall be placed at the equipment, and up to 50' intervals for at least 200' in both directions towards the flow of traffic.

STATE OF FLORIDA DEPARTMENT OF TRANSPORTATION					
TRAFFIC CONTROL THROUGH WORK ZONES					
GENERAL INFORMATION FOR					
TRAFFIC CONTROL THROUGH WORK ZONES					
Designed By	DATE	APPROVED BY	DATE	SCALE	SECTION NO.
Drawn By	DATE	DATE	DATE	DATE	600
Checked By	DATE	DATE	DATE	DATE	5 of 10

### NOTES:

1. Posted speed limits shall be utilized through the work zone.
2. The construction activity shall be limited to the hours of 9:00 am to 4:00 pm.

REVISED DATE:  
Notes: 8-8-03



DAVID M. JONES JR. AND ASSOCIATES, INC.  
LANDSCAPE ARCHITECTS AND PLANNERS  
FORT LAUDERDALE, FLORIDA 33301  
2221 INGLEWOOD BLVD., SUITE 200  
FORT LAUDERDALE, FLORIDA 33301

DEPARTMENT OF TRANSPORTATION  
LEWIS COUNTY



LANDSCAPE ARCHITECTURAL PLANS FOR  
SR 78 & I-75 INTERCHANGE  
North Fort Myers

PROJECT NO.  
576-01-01

DATE  
5-30-03

SHEET DESCRIPTION:  
MAINTENANCE OF TRAFFIC PLANS

SHEET NUMBER:  
1-19

STATE OF FLORIDA DEPARTMENT OF TRANSPORTATION	DATE	5-30-05
GENERAL INFORMATION FOR TRAFFIC CONTROL THROUGH WORK ZONES	PROJECT NO.	578-01-065
TRAFFIC CONTROL THROUGH WORK ZONES	DATE	5-30-05
APPROVED BY	DATE	5-30-05
DESIGNED BY	DATE	5-30-05
CHECKED BY	DATE	5-30-05
DATE	DATE	5-30-05
600		

**END ROAD WORK SIGNS**  
 The END ROAD WORK sign (2D-2A) should be erected approximately 500 feet beyond the end of a construction or maintenance project unless other signs and street signs shall be adequate to make drivers aware of work zone conditions. Under no condition will intersecting leg signing be less than a ROAD WORK AHEAD sign, including light and flag, for approaching vehicles.

**INTERSECTING ROAD SIGNING**  
 Signing for the control of traffic entering and leaving work zones by way of intersecting highways, roads and streets shall be adequate to make drivers aware of work zone conditions. Under no condition will intersecting leg signing be less than a ROAD WORK AHEAD sign, including light and flag, for approaching vehicles.

**LENGTH OF ROAD WORK SIGN**  
 The length of road work sign (2D-1) bearing the legend ROAD WORK NEXT MILES is required for all projects of more than 2 miles in length. The number of miles entered should be rounded up to the nearest mile. The sign shall be located at begin construction points.

**WORKERS PRESENT SIGN**  
 The SPEEDING FINES DOUBLED WHEN WORKERS PRESENT sign should be installed on all projects. The placement should be 500 ft beyond the ROAD WORK AHEAD sign or midway to the next sign whichever is less.

SUPPORTS FOR MAINTENANCE OF TRAFFIC SIGNS

SGN SIZE	SGN	ROUND	DEPTH IN STEEL	DEPTH IN ALUMINUM	DEPTH IN GROUND
64" x 36"	2-I	NPS 2.0" x 1/2"	2'-0"	2'-0"	3'-0"
48" x 48"	1-II	NPS 3.5" x 1/2"	3'-4"	**	3'-0"
60" x 48"	3-I	NPS 3.5" x 1/2"	3'-4"	**	3'-0"
48" x 30"	2-I	NPS 2.0" x 1/2"	2'-0"	**	3'-0"
48" x 48"	2-II	NPS 3.0" x 1/2"	2'-6"	**	3'-0"
60" x 24"	3-I	NPS 3.0" x 1/2"	2'-6"	3.0 lb F/W*	3'-0"
60" x 36"	3-I	NPS 3.5" x 1/2"	3'-4"	4.0 lb F/W*	3'-0"

**WORK ZONE SIGN SUPPORTS**  
 Signs mounted on temporary supports or brackets, and brackets/sign combination shall be crumpleworthy in accordance with NCHRP 350 requirements and included on the Qualified Products List (QPL). All post mounted Work Zone signs shall be installed on either round aluminum or steel channel post as specified in the table below.

**SGN MATERIALS**  
 Mesh signs may be used only for Daylight Operations as noted in the standards. Type B Lights and Orange Flags are not required. Vinyl signs may be used for Day or Night Operations. Not to exceed 12 hours except as noted in the standards. Type B Lights and Orange Flags are not required. All signs shall be post mounted if operation exceeds 12 hours except as noted in the standards.

**SKN PLACEMENT**  
 Post-mounted signs installed on the side of the road shall be mounted at a height of least 7 feet measured from the bottom of the sign to a horizontal line extended from the top of the pavement. Signs mounted on brackets, or other portable supports shall be no less than 1 foot above the travel way.

**SKN COVERING AND INTERRUPT**  
**WORK STORAGE SIGNING**  
 Existing signs that conflict with temporary work zone signing shall be removed or covered as approved by the Engineer. Traffic control signs that require covers when work is being performed in a work area shall be fully covered with a durable opaque sheet material. Plastic film and woven fabrics including tarpaulin will not be permitted. Reflecting covers will not be permitted. Hinged signs designed to cover when folded and sign blanks will be permitted. Covers, blanks, hinged work storage shields and plaques are incidental to work operation signs and are not to be paid for separately.

**EXTENDED DISTANCE ADVANCE WARNING SIGNS**  
 Advance Warning signs shall be used at extended distance of one-half mile or more when limited sight distance or the nature of the obstruction may require a motorist to bring their vehicle to a stop. Extended distance Advance Warning signs may be required on any type roadway, but particularly be considered on multi-lane divided highways where vehicle speed is generally in the higher range (45 M.P.H. or more).

**SKN COVERING AND INTERRUPT**  
 (a) For scheduled projects the engineer in responsible charge of project design will resolve anticipated work zone conflicts during the development of the project traffic control plan. This may entail revision of plans on preceding projects and coordination of plans on concurrent projects.  
 (b) Highway construction projects will be resolved by the Resident Engineer for projects under his residency and by the District Construction Engineer for in progress projects under adjoining residences.  
 (c) The District Maintenance Engineer will resolve anticipated and occurring conflicts within scheduled maintenance operations.  
 (d) The Unit Maintenance Engineer will resolve conflicts that occur within routine maintenance work, unscheduled work, and between unit controlled maintenance work and highway construction projects.

**ADJOINING AND/OR OVERLAPPING WORK ZONE SIGNING**  
 Adjacent work zones may not have sufficient spacing for standard placement of signs and other traffic control devices in their advance warning areas or in some cases other areas within their traffic control zones. Where such restrictions or conflicts occur or likely to occur, one of the following methods will be employed to avoid conflicts and prevent conditions that could be misunderstood on the part of the traveling public as to the intended travel way by the traffic control procedure applied.

**ADJOINING AND/OR OVERLAPPING WORK ZONE SIGNING**  
 The Unit Maintenance Engineer will resolve anticipated and occurring conflicts within scheduled maintenance operations.  
 (c) The District Maintenance Engineer will resolve anticipated and occurring conflicts that occur within routine maintenance work, unscheduled work, and between unit controlled maintenance work and highway construction projects.

REVISIONS DATE: \_\_\_\_\_

SHEET NO. 578-01-065

DATE: 5-30-05

SHEET DESCRIPTION: MAINTENANCE OF TRAFFIC PLANS

SHEET NUMBER: L-20

LANDSCAPE ARCHITECTURAL PLAN FOR  
**SR 78 & I-75 INTERCHANGE**  
 North Fort Myers  
 LEE COUNTY, FLORIDA  
 PROJECT NO. 578-01-065

DEPARTMENT OF TRANSPORTATION  
 LANDSCAPE ARCHITECTS AND PLANNERS  
**DAVID M. JONES JR. AND ASSOCIATES, INC.**  
 221 W. WASHINGTON AVENUE, 6TH FLOOR, SUITE 600  
 TAMPA, FLORIDA 33602  
 (813) 337-5525 FAX (813) 337-5525



**VARIABLE MESSAGE SIGNS (VMS)**

The VMS can be used for:  
 (1) Supplement standard signing in construction/maintenance work zones.  
 (2) Reinforce static advance warning messages.  
 (3) Provide motorists with updated guidance information.

The message should be visible and legible at a minimum distance of 500 feet. All messages should be cycled so that two message cycles are displayed to a driver while approaching the sign from 500 feet or 55 mph.

VMS should be placed approx. 500 to 800 feet in advance of the work zone conflicts or 1.5 to 2 miles in advance of complex traffic control schemes which require new and/or unusual traffic maneuvers.

If VMS are to be used at night, the intensity of the flashers shall be reduced during darkness when lower intensities are desirable.  
 For additional information refer to the FOOT Roadway Plans Preparation Manual, Volume 1, Chapter 10.

**CHANNELIZING AND LIGHTING DEVICES**

Channelizing and lighting devices for work zone traffic control shall be as prescribed in Part VI of the MUTCD, subject to supplemental revisions provided in the contract documents.

Primary work zone traffic control devices are shown on Sheet 6 for the purpose of ready identification. Approved devices are listed on the Department's Qualified Product List.

**CHANNELIZING AND LIGHTING DEVICE CONSISTENCY**

Barriercast, vertical panels, cones, tubular markers and drums shall not be intermixed within either the lateral transition or within the hazard delineation.

**REMOVING PAVEMENT MARKINGS**

Existing pavement markings that conflict with temporary work zone delineation shall be removed by any method approved by the Engineer, where operations exceed one daylight period; however, painting of existing pavement markings will not be permitted. Full pavement overlay of either asphalt concrete SP 9.5 or FC-6 is a positive means to ensure obliteration.

**SIGNALS**

Existing traffic signal operations that require modification in order to carry out work zone traffic control shall be included in the TDP and be approved by the District Traffic Operations Engineer.  
 All existing color-coded or traffic responsive mode signal operations for the site or street segments for the duration of the Contract and include the following:  
 1. The Contract and include the following:  
 a. The duration of the operation within 12 hours. The contractor shall submit only details of the operation on the Department's Approved Products List (APL) and approved by the Engineer to restore detection capabilities. The plans should identify the intersections where Temporary Traffic Detection is required.

**WARNING LIGHTS**

Warning lights shall be in accordance with Section 6E-5 of the MUTCD except for the application limitations stipulated below:

**Flashing**

Type A Low Intensity Flashing Warning Lights are to be mounted on barricades, drums, vertical panels or advance warning signs (except as noted below) and are intended to continually warn drivers that they are approaching or proceeding in a hazardous area. Flashing lights are used to delineate the intended path of travel, and shall be placed with cones and tubular markers at the beginning and end of the intended travel way. Type A lights shall not be used in conjunction with the first advance warning sign nor the second advance warning sign when used.

Type B High Intensity Flashing Warning Lights shall be mounted on the first advance warning sign and on the first advance warning sign approaches to any work zone.

**Steady-Burn**

Type C Steady-Burn Lights are to be mounted on barricades, drums, concrete barrier walls or vertical panels and used in conjunction with these devices to delineate the travel way on lane closures, lane changes, diversion curves and other similar conditions. Steady-Burn Lights are intended to be placed in a line to delineate the traveled way through and around obstructions in the transition, buffer, work and termination areas of the traffic control zone. Their intended purpose is not for hazard delineation but rather they are approaching or proceeding through a hazardous area.

**ROADSIDE BARRIERS**

When connecting temporary concrete barrier wall to general the connection shall be made in accordance with the Florida Department of Transportation Manual. All guardrail end treatments to be included in the cost of Temporary Guardrail.

**TRUCK MOUNTED ATTENUATORS**

Truck-mounted attenuators (TMAs) can be used for moving operations and short-term stationary operations. For moving operations, see Index No. 627. For short-term stationary operations, see Part VI of the MUTCD.

**MANHOLES/CROSSWALKS**

Manholes extending 1' or more above the travel lane and crosswalks having manhole covers greater than 1' shall have a temporary asphalt apron constructed as shown in the diagram below.



The apron is to be removed prior to constructing the next lift of asphalt. The cost of the temporary asphalt shall be included in the Contract Unit Price for Maintenance of Traffic, L.S.

STATE OF FLORIDA DEPARTMENT OF TRANSPORTATION			
TRAFFIC CONTROL THROUGH WORK ZONES			
Checked by	Approved by	Checked by	Checked by
DATE	DATE	DATE	DATE
5/13/03	5/13/03	5/13/03	5/13/03
5 of 13	5 of 13	5 of 13	5 of 13

EXHIBIT A PAGE 21 OF 29

REVISED DATE

SHEET NUMBER  
L-21

SHEET DESCRIPTION  
MAINTENANCE OF TRAFFIC PLANS

DATE  
5-30-03

PROJECT NO.  
576-01-065

LANDSCAPE ARCHITECTURAL PLANS FOR  
 SR 78 & I-75  
 INTERCHANGE  
 North Fort Myers  
 LEE COUNTY, FLORIDA



DEPARTMENT OF TRANSPORTATION  
 LEE COUNTY  
 (SOUTHWEST FLORIDA 239) 894-3334

DAVID M. JONES JR. AND ASSOCIATES, INC.  
 LANDSCAPE ARCHITECTS AND PLANNERS  
 2221 McREGOR BOULEVARD FORT MYERS, FLORIDA, 33901  
 (813) 337-5525 FAX (813)





DAVID M. JONES JR. AND ASSOCIATES, INC.  
 LANDSCAPE ARCHITECTS AND PLANNERS  
 2221 McCRECKEN BLDG. (SUITE 200)  
 FORT MYERS, FLORIDA 33901  
 (813) 337-5525  
 (813) 337-5525

DEPARTMENT OF TRANSPORTATION  
 LEES COUNTY  
 SOUTH WEST FLORIDA (239) 894-3334

SR 78 & I-75 INTERCHANGE  
 North Fort Myers  
 LEE COUNTY, FLORIDA  
 LANDSCAPE ARCHITECTURAL PLANS FOR

PROJECT NO. 218-01-065

DATE: 5-30-03

SHEET NO. 218-01-065-03  
 MAINTENANCE OF TRAFFIC PLANS

SHEET NUMBER: L-22

REVISED DATE

**SHOULDER TREATMENT**

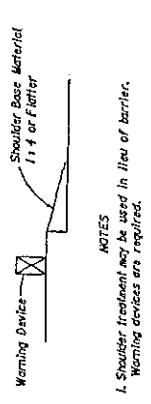

NOTES  
 1. Shoulder treatment may be used in lieu of barrier. Warning devices are required.  
 2. Daily inspections shall be conducted to assure that no erosion, excessive slopes, rutting, or other adverse conditions exist. Any deficiencies shall be repaired immediately.  
 3. Compensation for the placement and removal of the material required for the shoulder treatment shall be included in the cost for bid purposes or treated as a separate treatment in lieu of a barrier is not eligible for "ECP" consideration.

**TRAVEL LANE TREATMENT FOR MILLING OR RESURFACING**

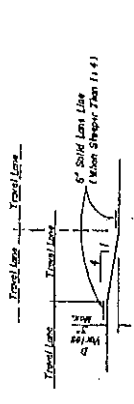

NOTES  
 1. This treatment applies to resurfacing or milling operations between adjacent travel lanes.  
 2. Whenever there is a difference in elevation between adjacent travel lanes, the W8-9A sign with "UNEVEN PAVEMENT" plaque is required at intervals of 1/4 mile maximum.  
 3. If D is 1/2" or less, no treatment is required.  
 4. Treatment allowed only when D is 3" or less.  
 5. If the slope is steeper than 1:4 (not to be steeper than 1:1), the R4-1 and M4-1 signs shall be used as a supplement to the W8-9A. This condition should never exceed 3 miles in length.

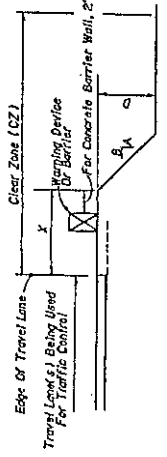

**DROPOFF PROTECTION REQUIREMENTS**

ALL SPEEDS  
 NO CURB AND BUTTER

X (ft)	D (in)	Device Required
0-12	≤ 3	Sign W8-9A/S
12-15	3-4	Barrier
15-22	4-5	Warning Device
22-62	5-8	Barrier

For Clear Zone Widths, see Index No. 600 sheet 4.

**DROPOFF CONDITION**

- A dropoff is defined as a drop in elevation, parallel to the adjacent travel lanes, greater than 3" with slopes (A/B) steeper than 1:4. When dropoffs occur within the clear zone due to construction or maintenance activities, protection devices are required, see sheet.
- Distance X is to be the maximum practical under project conditions.
- Distance from the travel lane to the barrier or warning device should be maximum practical for project conditions.
- Any dropoff condition that is created and restored within the same work period will be subject to the use of barriers; however, warning devices will be required.
- When permanent curb heights are ≥ 6", no warning device will be required. For curb heights < 6", see sheet.

**DROPOFF NOTES**

- These conditions and treatments can be applied only in work areas that fall within a properly signed work zone.
- The following are defined as acceptable warning devices:
  - Vertical Panels
  - Type I Or Type II Barricades
  - Cones (where allowed)
  - Tubular Marker (where allowed)
- Where a barrier is specified any of the types below may be used as shown in the plans:
  - Concrete temporary barrier walls
  - Temporary guardrail and end anchorages
  - Temporary Curb
  - Temporary water filled barriers.
- On Allogments  
 Maximum spacing between cones or tubular markers shall be 25', and for Type I or Type II barricades, vertical panels or drums is 50' on center for the first 250', thereafter, cones or tubular markers at 50' on center and Type I or Type II barricades drums or vertical panels at 100' on center.
- On Topes  
 Maximum spacing shall be as follows:  
 A. On Topes  
 Maximum spacing between cones and tubular markers shall be 25', Minimum spacing between Type I or Type II barricades or vertical panels or drums shall be based on the speed limit as follows:  
 15' up to 25 MPH, 30' for 30 - 40 MPH,  
 50' for 45 MPH and greater.  
 B. On Allogments  
 Maximum spacing between cones or tubular markers shall be 25', and for Type I or Type II barricades, vertical panels or drums is 50' on center for the first 250', thereafter, cones or tubular markers at 50' on center and Type I or Type II barricades drums or vertical panels at 100' on center.

STATE OF FLORIDA DEPARTMENT OF TRANSPORTATION  
 TRAFFIC CONTROL TYPICAL WORK ZONES  
 GENERAL INFORMATION FOR TRAFFIC CONTROL THROUGH WORK ZONES

DESIGNED BY	DATE	SCALE	NO. OF SHEETS
APPROVED BY	DATE	SCALE	NO. OF SHEETS
CHECKED BY	DATE	SCALE	NO. OF SHEETS
PROJECT NO.	DATE	SCALE	NO. OF SHEETS

**DROPOFFS IN WORK ZONES**

EXHIBIT A PAGE 22 OF 29





DAVID M. JONES JR. AND ASSOCIATES, INC.  
 LANDSCAPE ARCHITECTS AND PLANNERS  
 2211 W. GORGE BLVD., SUITE 100  
 FORT WORTH, TEXAS 76102  
 (817) 357-5526 FAX (817) 357-5526

DEPARTMENT OF TRANSPORTATION  
 SR 78 & I-75 INTERCHANGE  
 NORTH FORT WORTH, FORT WORTH, TEXAS  
 (817) 357-5526 FAX (817) 357-5526

LANDSCAPE ARCHITECTURAL PLANS FOR  
 SR 78 & I-75 INTERCHANGE  
 NORTH FORT WORTH, FORT WORTH, TEXAS  
 (817) 357-5526 FAX (817) 357-5526

PROJECT NO. 576-10-065  
 DATE 6-03-03

SHEET DESCRIPTION: MAINTENANCE OF TRAFFIC PLANS

SHEET NUMBER: L-24

REVISED DATE:

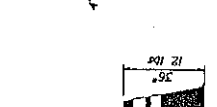
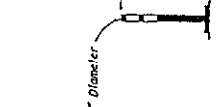
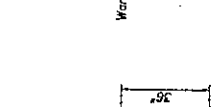
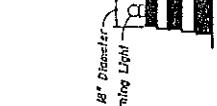
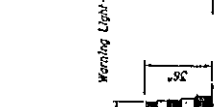
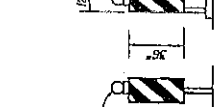
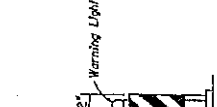
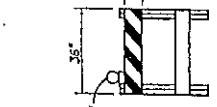
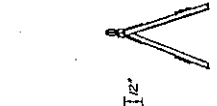
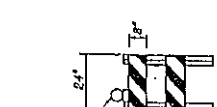
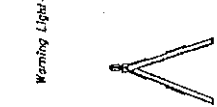
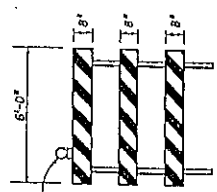

TYPE III BARRICADE

TYPE II BARRICADE

TYPE I BARRICADE

VERTICAL PANEL

PLASTIC DRUMS

TUBULAR MARKER

CONES

TUBULAR MARKERS MUST BE USED IN THE MANNER SHOWN.

TYPE III BARRICADE

TYPE II BARRICADE

TYPE I BARRICADE

VERTICAL PANEL

PLASTIC DRUMS

TUBULAR MARKER

CONES

TUBULAR MARKERS MUST BE USED IN THE MANNER SHOWN.

CHANNELIZING AND LIGHTING DEVICE AND ADVANCE WARNING ARROW PANEL NOTES

1. Only approved traffic control devices included on the Qualified Products List (QPL) may be used.
2. The FDOT approval number shall be engraved on the device at a convenient and readily visible location. Where engraving is not practical a water-resistant type label may be used.
3. The details shown on this sheet are for the following purposes: (a) For ease of identification and (b) To provide information that supplements or supersedes that provided by the MUTCD.
4. The Type III Barricade shall have a unit length of 6'-0" only. When barricades of greater lengths are required these lengths shall be in multiples of the 6'-0" unit. Signs used in conjunction with Type III Barricades may be mounted on or above the barricade. These signs should not cover more than 50 percent of the top, two rails or 35 percent of the total area of the three rails.
5. During hours of darkness, warning lights shall be used on advance warning panels. Type I, Type II and Type III barricades in accordance with "Warning Lights" Sheet 5.

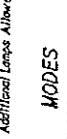
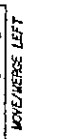
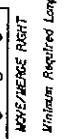
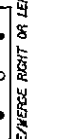
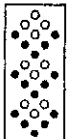
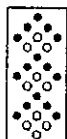
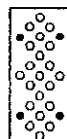

CAUTION

Minimum Required Lenses

Additional Lenses Allowed

MODES

ADVANCE WARNING ARROW PANELS

ADVANCE WARNING ARROW PANELS

IDENTIFICATIONS - CHANNELIZING AND LIGHTING DEVICES AND ADVANCE WARNING ARROW PANEL MODES

STATE OF FLORIDA DEPARTMENT OF TRANSPORTATION  
 TRAFFIC CONTROL THROUGH WORK ZONES  
 GENERAL INFORMATION FOR  
 TRAFFIC CONTROL THROUGH WORK ZONES

DESIGNED BY	DATE	SCALE	SHEET NO.	TOTAL SHEETS
APPROVED BY				
APPROVED BY: [Signature]				
DATE	SCALE	SHEET NO.	TOTAL SHEETS	
6-03-03		1	8 of 10	600

EXHIBIT A PAGE 24 OF 29

**COMMONLY USED WARNING AND REGULATORY SIGNS IN WORK ZONES**

**LEGEND AND SYMBOLS**

- O-Orange (Reflectorized)
- B-Black (Non-Reflectorized)
- Y-Yellow (Reflectorized)
- R-Red (Reflectorized)
- G-Green (Reflectorized)

**COLOR CODES**

- Legend and/or Symbol / Background
- O-Orange (Reflectorized)
- B-Black (Non-Reflectorized)
- Y-Yellow (Reflectorized)
- R-Red (Reflectorized)
- G-Green (Reflectorized)

**Notes:**

- When standard orange flags or flashing warning lights are used in conjunction with signs, they shall not block the sign face.
- The sign exhibits, symbols and messages contained on this sheet are provided for ready reference to those signs used in the development of the 600 series Design Standards and are commonly used in the development of traffic control plans.

For additional signs and sign detail information refer to the STANDARD HIGHWAY SIGNS MANUAL use approved by the State Traffic Plans Engineer. The sign codes shown on this sheet are for the purpose of identifying call names found in the Traffic Control Call Library (TCL.Cal). THE STANDARD HIGHWAY SIGNS MANUAL should be referenced for the official sign codes for use in the development of traffic control plans. See sheet No. 17555 for 600 sign details.

EXHIBIT A PAGE 25 OF 29





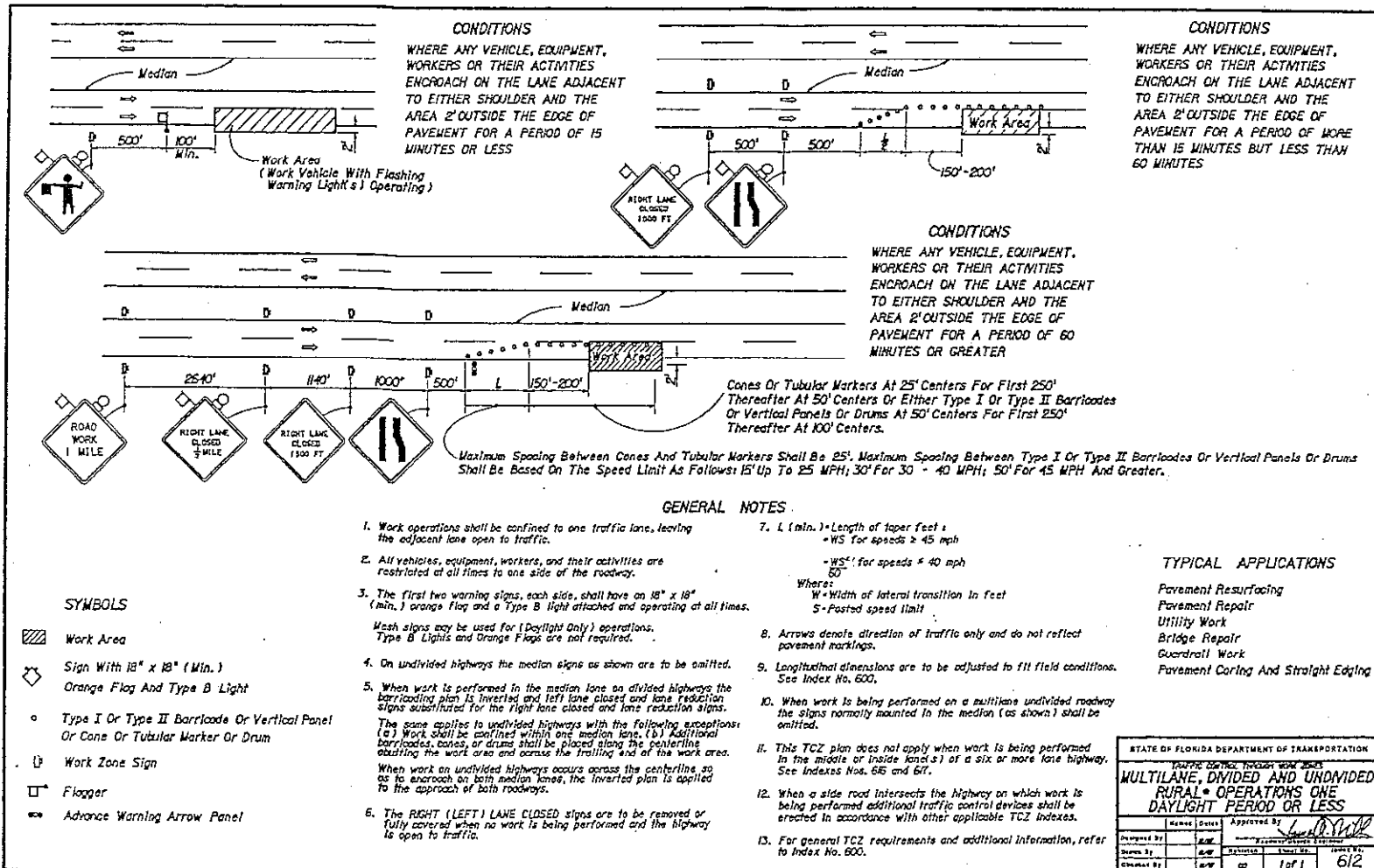

DAVID M. JONES JR. AND ASSOCIATES, INC.  
LANDSCAPE ARCHITECTS AND PLANNERS  
2225 WOODCROFT BLVD. #100  
FORT WORTH, TEXAS 76107  
(817) 337-5525 FAX (817) 337-5525

DEPARTMENT OF TRANSPORTATION  
LEE COUNTY  
SOUTHWEST FLORIDA 259 894-0354  
SR 78 & I-75 INTERCHANGE  
North Fort Myers  
LEE COUNTY, FLORIDA

PROJECT NO. 576-01-065  
DATE: 5-30-03  
SHEET DESCRIPTION: MAINTENANCE OF TRAFFIC PLANS  
SHEET NUMBER: L-27

EXHIBIT A PAGE 27 OF 29

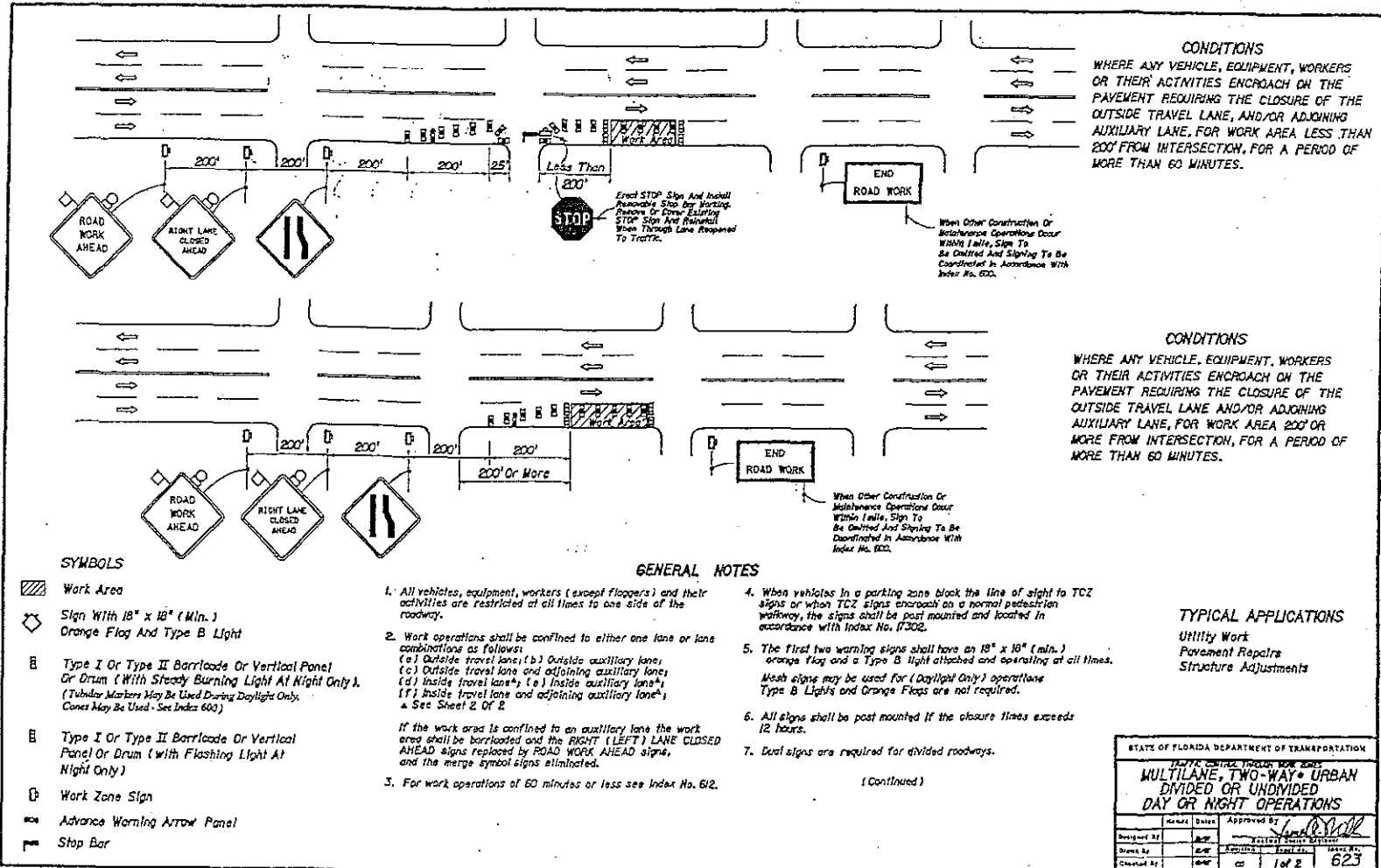

**CONDITIONS**  
 WHERE ANY VEHICLE, EQUIPMENT, WORKERS OR THEIR ACTIVITIES ENCRUCH ON THE PAVEMENT REQUIRING THE CLOSURE OF THE OUTSIDE TRAVEL LANE AND/OR ADJOINING AUXILIARY LANE, FOR WORK AREA LESS THAN 200' FROM INTERSECTION, FOR A PERIOD OF MORE THAN 60 MINUTES.

**CONDITIONS**  
 WHERE ANY VEHICLE, EQUIPMENT, WORKERS OR THEIR ACTIVITIES ENCRUCH ON THE PAVEMENT REQUIRING THE CLOSURE OF THE OUTSIDE TRAVEL LANE AND/OR ADJOINING AUXILIARY LANE, FOR WORK AREA 200' OR MORE FROM INTERSECTION, FOR A PERIOD OF MORE THAN 60 MINUTES.

- SYMBOLS**
- Work Area
  - Sign With 18" x 18" (Min.) Orange Flag And Type B Light
  - Type I Or Type II Barricade Or Vertical Panel Or Drum (With Steady Burning Light At Night Only). (Tubular Markers May Be Used During Daylight Only, Cones May Be Used - See Index 603)
  - Type I Or Type II Barricade Or Vertical Panel Or Drum (With Flashing Light At Night Only)
  - Work Zone Sign
  - Advance Warning Arrow Panel
  - Stop Bar

**GENERAL NOTES**

1. All vehicles, equipment, workers (except flaggers) and their activities are restricted at all times to one side of the roadway.
2. Work operations shall be confined to either one lane or lane combinations as follows:
  - (a) Outside travel lane; (b) Outside auxiliary lane;
  - (c) Outside travel lane and adjoining auxiliary lane;
  - (d) Inside travel lane; (e) Inside auxiliary lane; (f) Inside travel lane and adjoining auxiliary lane;
  - \* See Sheet 2 Of 2.
 If the work area is confined to an auxiliary lane the work area shall be barricaded and the RIGHT (LEFT) LANE CLOSED AHEAD signs replaced by ROAD WORK AHEAD signs, and the merge symbol signs eliminated.
3. For work operations of 60 minutes or less see Index No. 612.
4. When vehicles in a parking zone block the line of sight to TCZ signs or when TCZ signs encroach on a normal pedestrian walkway, the signs shall be post mounted and located in accordance with Index No. 17302.
5. The first two warning signs shall have an 18" x 18" (min.) orange flag and a Type B light attached and operating at all times. Mesh signs may be used for (Daylight Only) operations. Type B Lights and Orange Flags are not required.
6. All signs shall be post mounted if the closure times exceeds 12 hours.
7. Dual signs are required for divided roadways.

(Continued)

**TYPICAL APPLICATIONS**  
 Utility Work  
 Pavement Repairs  
 Structure Adjustments

STATE OF FLORIDA DEPARTMENT OF TRANSPORTATION			
MULTILANE, TWO-WAY* URBAN DIVIDED OR UNDIVIDED DAY OR NIGHT OPERATIONS			
Designed By	DATE	Approved By	
Checked By	DATE	DATE	6/23

**DAVID M. JONES JR. AND ASSOCIATES, INC.**  
 LANDSCAPE ARCHITECTS AND PLANNERS  
 FORT LINDERS, FLORIDA 33501  
 2221 WOODCROFT BOULEVARD  
 (813) 357-6525 FAX (813)

DEPARTMENT OF TRANSPORTATION  
 LEE COUNTY  
 SR 78 & I-75 INTERCHANGE  
 North Fort Myers  
 LEE COUNTY, FLORIDA

PROJECT NO. 576-01-065

DATE: 5-30-03

SHEET DESCRIPTION: MAINTENANCE OF TRAFFIC PLANS

REVISED DATE: SHEET NUMBER: L-28

EXHIBIT A PAGE 28 OF 29



DAVID M. JONES JR. AND ASSOCIATES, INC.  
 LANDSCAPE ARCHITECTS AND PLANNERS  
 2211 WOODCOCK BLVD., SUITE 100  
 FORT MYERS, FLORIDA 33708  
 (813) 337-5525 FAX (813) 337-5526

DEPARTMENT OF TRANSPORTATION  
 LEES COUNTY  
 SOUTH WEST FLORIDA 209 884-8394

SR 78 & 1-75 INTERCHANGE  
 LANDSCAPE ARCHITECTURAL PLANS FOR  
 NORTH FORT MYERS, FLORIDA

PROJECT NO. 575-01-065

DATE: 5-30-03

SHEET DESCRIPTION: MAINTENANCE & TRAFFIC PLANS

SHEET NUMBER: L-29

RECORD DATE:

**CONDITIONS**

WHERE ANY VEHICLE, EQUIPMENT, WORKERS OR THEIR ACTIVITIES ENCRUGH ON THE PAVEMENT REQUIRING THE CLOSURE OF THE INSIDE TRAVEL LANE AND/OR ADJOINING AUXILIARY LANE, FOR WORK AREA LESS THAN 200' FROM INTERSECTION, FOR A PERIOD OF MORE THAN 60 MINUTES.

**CONDITIONS**

WHERE ANY VEHICLE, EQUIPMENT, WORKERS OR THEIR ACTIVITIES ENCRUGH ON THE PAVEMENT REQUIRING THE CLOSURE OF THE INSIDE TRAVEL LANE AND/OR ADJOINING AUXILIARY LANE, FOR WORK AREA 200' OR MORE FROM INTERSECTION, FOR A PERIOD OF MORE THAN 60 MINUTES.

**TYPICAL APPLICATIONS**

Utility Work  
 Pavement Repairs  
 Structure Adjustments

STATE OF FLORIDA DEPARTMENT OF TRANSPORTATION	
MULTILANE, TWO-WAY, URBAN DIVIDED OR UNDIVIDED DAY OR NIGHT OPERATIONS	
DESIGNED BY	DATE
CHECKED BY	DATE
APPROVED BY	DATE
SCALE	NO. OF SHEETS
1" = 40'	2 OF 2
PROJECT NO.	623

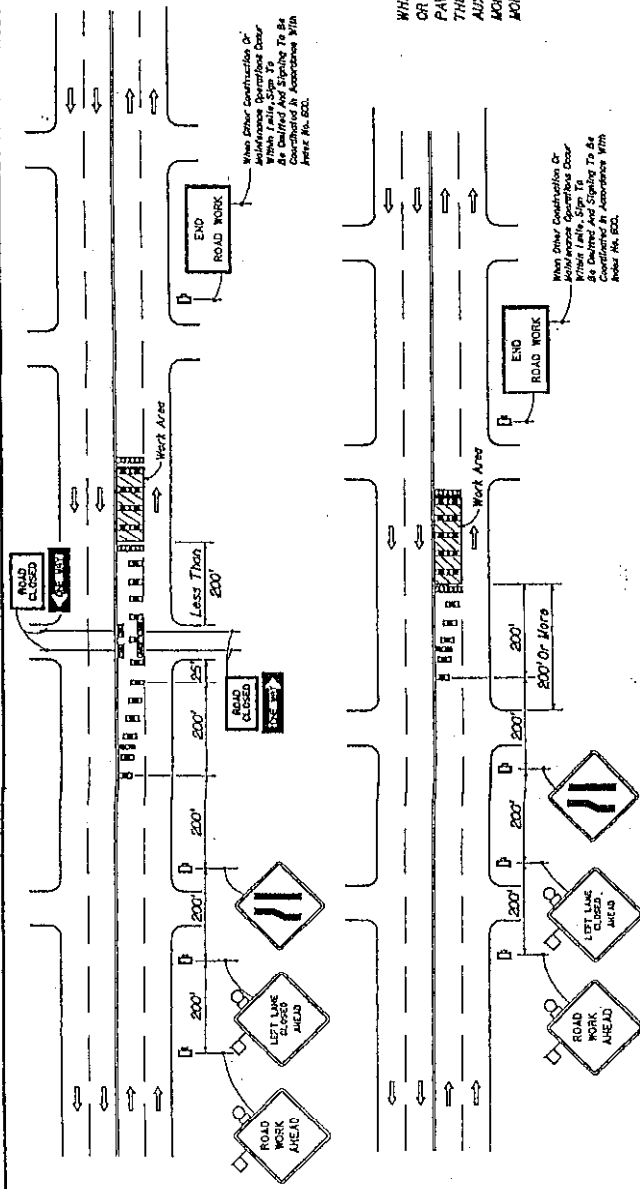

**SYMBOLS**

- Work Area
- Sign With 16" x 16" (Min.) Orange Flag And Type B Light
- Type I Or Type II Barricade Or Vertical Panel Or Drum (With Steady Burning Light At Night Only). (Tubular Markers May Be Used During Daylight Only. Cones May Be Used. See Index 600).
- Type I Or Type II Barricade Or Vertical Panel Or Drum (With Flashing Light At Night Only)
- Type III Barricade
- Work Zone Sign
- Advance Warning Arrow Panel

**GENERAL NOTES (CONT.)**

8. Within the lateral transitions, the maximum spacing between cones and tubular markers shall be 25'. Maximum spacing between Type I or Type II barricades or vertical panels or drums shall be based on the speed limit as follows: 15 to 25 MPH: 50' for 30-40 MPH.
9. Spacing for devices parallel to the travel lanes shall be 25' centers for cones or tubular markers and 50' centers for Type I or Type II barricades or vertical panels or drums for 250' thereafter cones or tubular markers at 50' centers and Type I or Type II barricades or vertical panels or drums at 100' centers.
10. Arrows denote direction of traffic only and do not reflect pavement markings.
11. Longitudinal dimensions are to be adjusted to fit field conditions. See Index No. 600.
12. For general TCE requirements and additional information refer to Index No. 600.

EXHIBIT A PAGE 29 OF 29



DAVID M. JONES, JR. AND ASSOCIATES, INC.  
 LANDSCAPE ARCHITECTS AND PLANNERS  
 2201 MCKENNA BOULEVARD  
 FORT MYERS, FLORIDA 33901  
 (813) 337-5525 FAX (813) 337-4444

DEPARTMENT OF TRANSPORTATION  
 LEES COUNTY  
 NORTH FORT MYERS  
 LEES COUNTY, FLORIDA  
 (239) 694-3334

SR 78 & I-75 INTERCHANGE  
 PROJECT NO. 576-01-068  
 DATE 6-9-03  
 SHEET INFORMATION Maintenance  
 SHEET NUMBER 1-7

TYPICAL LANDSCAPE NOTES

Installation of work shall be coordinated with other contractors in such a manner as to allow for a speedy and orderly completion of all work on the site.

Contractors are advised to refer to the specifications, contract documents, and plan sheets for a more detailed disclosure of performance standards and requirements.

The contractor is cautioned to be aware of underground utilities. Prior to excavation, the contractor shall check with the job site superintendent, "No Cuts", and Lee County utilities for location of all utilities a minimum of 48 hours before beginning work.

Contractor to provide agricultural certification for sod to be weed free.

All sod shall be sand grown. The contractor shall be responsible for all finish grading in sod areas. Hand rake prior to installing sod. Stagger and kick all joints tight. All sod to be rolled immediately after installation.

Contractor shall apply minimum 2 applications of roundup herbicide (or approved equal) on existing turf where it is required to be removed for planting. Roundup must be sprayed prior to commencing any grading operations. Contractor shall review turf fill with landscape architect or owner representative for approval. All herbicides must be applied by licensed applicators per manufacturers recommended rates and instructions. Post all applications.

Contractor shall install all fill to construct berming to blend in with existing grade. Fill material shall be second cut clean fill suitable for plant growth. Submit sample of second cut clean fill to landscape architect for review. All existing turf areas to be tractor graded to a smooth uniform grade. No fill is to be placed around the existing trees.

Any excess soil or debris from construction shall be removed from the site and taken to the county land fill or other lawful disposal site.

Mulch all new planting with 3" (or as noted otherwise on plan) of specified recycled mulch. State policy prohibits express mulch on all state roads.

The landscape contractor shall hand water all plant material daily until substantial completion. The landscape contractor shall be liable for replacing trees and shrubs experiencing transplant shock due to lack of water at any time during the course of the contract period.

All trees and palms within sod areas shall be mulched 3" deep within a 6' min. diameter ring. Stakes shall be within mulch rings.

The landscape contractor shall be responsible for removal of all existing sod, debris, weeds, and handwork in preparation for any planting.

Contractor shall repair any areas disturbed during the completion of work including reseedling or irrigation trenches and planting pits resulting from material relocations.

An automatic irrigation system will be installed to provide 100% coverage on all new plant material. All new plant materials used shall conform to the standards for Florida No. 1 or better as established in 'Grades and Standards for Nursery Plants' State of Florida Department of Agriculture.

All plant material shall be subject to approval by the landscape architect prior to purchase by contractor.

Contractor shall stake all trees as per details.

All plant material shall be fertilized according to the chart as shown on this sheet.

All trees evidencing weed growth shall be sprayed with Roundup at the final inspection for acceptance. Application rate. Tree rings and all beds are to remain weed free until final inspection for acceptance.

Contractor is responsible for restoring all disturbed areas created by the construction. This shall include all sod and hand raking to restore a smooth uniform surface. Also removal of any debris encountered or created from construction operations. Any material removed from the site shall be taken to a sanitary landfill or other approved location.

The owner reserves the right to modify tree placement in the field as conditions dictate. Plant material shall be installed prior or concurrent with the irrigation bubbler system.

The contractor is responsible for obtaining all necessary permits prior to commencing any work.

The first emerging root of the root ball shall be at finish grade and visible at inspection.

EXHIBIT B PAGE 1 OF 2

SR 78 & I-75 INTERCHANGE												
CORE LEVEL MAINTENANCE MATRIX - LEVEL ONE												
MAINTENANCE OPERATION	MAINTENANCE FREQUENCIES ARE MINIMUMS											
	JAN	FEB	MARCH	APRIL	MAY	JUNE	JULY	AUG	SEPT.	OCT.	NOV.	DEC
MOWING 3-4" HEIGHT	X	X	X	X	XX	XX	XX	XX	XX	XX	XX	X
MOW ON A BI-WEEKLY BASIS FROM MAY THROUGH OCTOBER AND MONTHLY FROM NOVEMBER THROUGH APRIL												
WATERING	PLANT MATERIAL DAY											
	ALL 1-50 DAILY 60											
	ALL 61-150 3 TIMES/WEEK 86											
	ALL 151-365 WEEKLY 28											
IRRIGATION	MAINTAIN THE IRRIGATION SYSTEM IN AN OPERABLE CONDITION AT ALL TIMES. CHECK SYSTEM FOR LINE BREAKS AND CLOGGING OF HEADS AND BUBBLERS EACH WEEK.											
FERTILIZATION	X	X	X	X	X	X	X	X	X	X	X	X
WEEDING	LANDSCAPED BEDS AND MULCHED AREAS SHALL BE KEPT WEED FREE											
PRUNING	PRUNE AS NECESSARY TO REMOVE ALL SUCKERS, DEAD, DISEASED, OR BROKEN BRANCHES, FRONDS AND SEED HEADS.											
MULCHING	MAINTAIN A CONTINUOUS 3" LAYER OF MULCH IN ALL PLANTED AND MULCHED AREAS. MULCH ENTIRE SITE IN MONTH TWELVE OF MAINTENANCE CONTRACT.											
EDGING	X	X	X	X	XX	XX	XX	XX	XX	XX	XX	X
GENERAL	RESTORE ALL SAUCERS AND CONTROL ANTS, INSECTS AND DISEASE AS THEY APPEAR WEEKLY IN ALL MULCHED AREAS AND JUST BEFORE EACH MOWING.											
LITTER REMOVAL	REFER TO SITE MAINTENANCE SPECIFICATIONS FOR DETAILS. LEE COUNTY RESERVES THE RIGHT TO ADJUST FREQUENCIES AS NECESSARY.											

- \* Mowing should be as needed in dry season (May through October) at a height of 4" to 6" to prevent grass death during this period
- \* Mowing to include clear zone areas identified on plan sheets
- \* Shrubs planted within clear sight limits shall be maintained at 24" ht. maximum
- \* Accent Trees within limits of clear sight shall be maintained with 8'-6" clear trunks.
- \* Trees within limits of clear sight shall be maintained with 8'-6" clear trunks.

Signature: *Paul X. X. X.*

Lee County Department of Transportation

Date: 6/19/03



DAVID M. JONES, JR. AND ASSOCIATES, INC.  
 LANDSCAPE ARCHITECTS AND PLANNERS  
 FORT MYERS, FLORIDA 33901  
 221 MADRID BOULEVARD  
 (813) 337-6606 FAX (813) 337-4404

DEPARTMENT OF TRANSPORTATION  
 LEE COUNTY  
 SOUTH WEST FLORIDA (239) 894-3334

LANDSCAPE ARCHITECTURAL PLANS FOR  
**SR 78 & I-75 INTERCHANGE**  
 North Fort Myers  
 LEE COUNTY, FLORIDA

PROJECT NO.  
576-01-065

DATE  
6-9-03

SHEET DESCRIPTION  
Landscape Key Sheet

REVISED DATE SHEET NUMBER

