

Agenda Item Summary

**1. ACTION REQUESTED/PURPOSE:** Authorize the Division of County Lands to make a binding offer to property owner in the amount of \$3,170 for Parcel 118, Plantation Road Extension, Project No. 4065, pursuant to the Purchase Agreement; authorize the Division of County Lands to handle all documentation necessary to complete transaction.

**2. FUNDING SOURCE:** Fund – Central District Road Impact Fees; Program: Capital Projects; Project: Plantation Road Extension.

**3. WHAT ACTION ACCOMPLISHES:** Authorizes binding offer to property owner.

**4. MANAGEMENT RECOMMENDATION:** Approve.

**5. Departmental Category:** 06

*CLA*

**6. Meeting Date:** MAR 13 2007

**7. Agenda:**

- Consent
- Administrative
- Appeals
- Public
- Walk-On

**8. Requirement/Purpose: (specify)**

- Statute 125
- Ordinance
- Admin. Code
- Other BS 20061315  
RSN # 06-10-34

**9. Request Initiated:**

Commissioner \_\_\_\_\_  
 Department Independent  
 Division County Lands 2-16-07  
 By: Karen Forsyth, Director *KF*

**10. Background:**

**Negotiated for:** Department of Transportation  
**Interest to Acquire:** 1,950 square foot Slope Easement  
**Property Details:**

Owner: Emil Weiman, Inc.  
 STRAP: 06-45-25-03-00021.0090  
 Site Address: 6524 Fairview Street

**Purchase Details:**

**Purchase Price:** \$3,170  
**Costs to Close:** \$750

In order to expedite acquisition efforts, staff recommends Board make a binding offer in the amount of \$3,170 (appraised value), and commence Eminent Domain procedures.

**Appraisal Information:**

**Appraised Value/Date:** \$3,170 as of November 22, 2006  
**Company:** Diversified Appraisal, Inc.

**Staff Recommendation:** Staff recommends Board approve the Requested Motion.

**Account:** 20406518823.506110

**Attachments:** Purchase and Sale Agreement, In-House Title Search, Appraisal Summary, Location Map, Sales History

**11. Review for Scheduling:**

Department Director	Purchasing or Contracts	Human Resources	Other	County Attorney	Budget Services				County Manager/P.W. Director
					Analyst	Risk	Grants	Mgt.	
<i>K Forsyth</i>			<i>sent 2/22/07</i>	<i>2-21-07</i>	<i>2-22-07</i>	<i>2/22/07</i>	<i>2/22/07</i>	<i>2/22/07</i>	<i>2-22-07</i>

**12. Commission Action:**

- Approved
- Deferred
- Denied
- Other

RECEIVED BY COUNTY ADMIN: *EW*  
 2/ 11:30 AM  
 122  
 COUNTY ADMIN FORWARDED TO: *KL*  
 2/23/07  
 11:30 AM

Rec. by CoAtty  
 Date: *2/21/07*  
 Time: *3:20pm*  
 Forwarded To: *Admin*

*2/22/07*  
*10:34*

**EASEMENT PURCHASE AGREEMENT**

This Agreement made and entered into this \_\_\_\_ day of \_\_\_\_\_, 2007, by and between **Emil Weiman, Inc., a Florida corporation**, whose address is 4727 Del Prado Blvd., Cape Coral, FL 33904, hereinafter referred to as Owner, and **LEE COUNTY**, a political subdivision of the State of Florida, for the use and benefit of said County, hereinafter referred to as Purchaser.

Whereas, Purchaser requires a perpetual, nonexclusive slope easement located and described as set forth in Exhibit "A", attached hereto and made a part hereof by reference.

- a) Owner will grant said easement to Purchaser for the sum of \$3,170.00; Purchaser to pay recording costs, and title insurance, if desired by Purchaser.
- b) Owner agrees that said easement will be granted to Purchaser by execution of a slope easement in form and substance as provided by Purchaser and set forth in Exhibit "X".
- c) Purchaser will pay Owner the amount agreed upon in item (a) of this agreement by County Warrant within 60 days of the execution and acceptance of this Easement Purchase Agreement and the Slope Easement instrument by Purchaser.
- d) Owner agrees that Purchaser, his successors and assigns will be allowed to use said slope easement area as specified in the Slope Easement instrument.
- e) Purchaser agrees to complete construction within the easement area in a timely manner.
- f) This voluntary sale and purchase is considered by Florida law to be exempt from the payment of Documentary Stamp Taxes because this transaction was made under the threat of an eminent domain proceeding by the Purchaser.

IN WITNESS WHEREOF, the parties have caused these presents to be executed in their respective names on the date first above written.

**SIGNED, SEALED AND DELIVERED  
IN THE PRESENCE OF:**

WITNESSES:

SELLER:  
Emil Weiman, Inc., a Florida Corporation

\_\_\_\_\_  
  
\_\_\_\_\_

\_\_\_\_\_  
John Weiman, President

Parcel: 118  
Project: Plantation Extension Project No. 4065  
STRAP No.: 06-45-25-03-00021.0090  
Page 2 of 2

CHARLIE GREEN, CLERK

BUYER:  
**LEE COUNTY, FLORIDA, BY ITS  
BOARD OF COUNTY COMMISSIONERS**

BY: \_\_\_\_\_  
DEPUTY CLERK (DATE)

BY: \_\_\_\_\_  
CHAIRMAN OR VICE CHAIRMAN

APPROVED AS TO LEGAL FORM  
AND SUFFICIENCY

\_\_\_\_\_  
COUNTY ATTORNEY (DATE)

# Exhibit "X"

**This instrument prepared by:**

Lee County  
Division of County Lands  
Post Office Box 398  
Fort Myers, Florida 33902-0398

Parcel: 118

Project: **Plantation Road Extension Project, No. 4065**

STRAP No.: 06-45-25-03-00021.0090

## SLOPE/RESTORATION EASEMENT

This INDENTURE, made and entered into this \_\_\_\_\_ day of \_\_\_\_\_ 2007, between Emil Weiman, Inc., a Florida corporation, whose address is 4727 Del Prado Blvd., Cape Coral, FL 33904, (Grantor), and LEE COUNTY, a political subdivision of the State of Florida, whose address is Post Office Box 398, Fort Myers, Florida 33902-0398, (Grantee):

### WITNESSETH:

1. For good and valuable consideration, receipt of which is hereby acknowledged, Grantor grants to the Grantee, its successors and assigns, a slope/restoration easement situated in Lee County, Florida, and located and described as set forth in attached Exhibit "A" (Easement Parcel).
2. Grantee, its successors and assigns, are granted the right, privilege, and authority to construct, replace, repair, remove, extend, and maintain a slope/restoration easement on the Easement Parcel to support, reinforce, and stabilize the adjacent public roadway.
3. The improvements that may be placed within the Easement Parcel for roadway slope/restoration purposes are not limited to a particular type, style, material or design. These improvements may include the use of foliage.
4. Grantor may not construct or place any structures or foliage within the Easement Parcel.
5. Title to the improvements constructed by the Grantee within the Easement Parcel will remain in the Grantee, it's successors or assigns.
6. Subject to any existing easements for public highways or roads, railroads, laterals, ditches, pipelines and electrical transmission or distribution lines and telephone and cable television lines covering the land herein described, Grantors covenant they are lawfully seized and possessed of the real property described in Exhibit "A", have good and lawful right and power to convey it, and that the property is free and clear of all liens and encumbrances, except as herein stated, and accordingly, Grantor will forever warrant and defend the title and terms to this said easement and the quiet possession thereof against all claims and demands of all other entities.

**Slope/Restoration Easement**

**Project: Plantation Road Extension Project, No. 4065**

**Page 2 of 2**

7. Grantee has a reasonable right of access across Grantor's property for the purposes of reaching the Easement Parcel on either paved or unpaved surfaces. Any damage to Grantor's property or permitted improvements thereon resulting from Grantee's use of this access right will be restored by the Grantee, to the condition in which it existed prior to the damage.

8. This easement runs with the land and is binding upon the parties, their successors and assigns.

IN WITNESS WHEREOF, Grantor, has caused this document to be signed on the date first above written.

TWO SEPARATE WITNESSES:

Emil Weiman, Inc., a Florida corporation

\_\_\_\_\_  
1st Witness Signature

\_\_\_\_\_  
John Weiman, President

\_\_\_\_\_  
Printed name of 1st Witness

\_\_\_\_\_  
2nd Witness Signature

\_\_\_\_\_  
Printed name of 2nd Witness

**STATE OF  
COUNTY OF**

The foregoing instrument was acknowledged before me this \_\_\_\_\_ day of \_\_\_\_\_, 20\_\_\_, by John Weiman, President of Emil Weiman, Inc., a Florida corporation, on behalf of the

(name of person acknowledged)

Corporation. He/she is personally known to me or who has produced \_\_\_\_\_ as Identification.

(type of identification)

\_\_\_\_\_  
(Signature of Notary Public)

\_\_\_\_\_  
(Name typed, printed or stamped)  
(Title or Rank)  
(Serial Number, if any)

# Exhibit "A"

**PARCEL 118A-SE  
PLANTATION EXTENSION PROJECT**

**(15 FEET WIDE SLOPE EASEMENT)**

A TRACT OR PARCEL OF LAND SITUATED IN THE STATE OF FLORIDA, COUNTY OF LEE, LYING IN SECTION 6, TOWNSHIP 45 SOUTH, RANGE 25 EAST, OF SAID LEE COUNTY, FLORIDA, BEING FURTHER BOUND AND DESCRIBED AS FOLLOWS:

THE WEST FIFTEEN FEET (15') OF LOT 12, BLOCK 21, FLORIMOND MANOR, AS RECORDED IN PLAT BOOK 7, AT PAGE 6 OF THE PUBLIC RECORDS OF SAID LEE COUNTY

SLOPE EASEMENT PARCEL CONTAINS 1950 SQUARE FEET, MORE OR LESS.

**Division of County Lands**

**Ownership and Easement Search**

Search No. 06-45-25-03-00021-0090

Date: April 8, 2005

Parcel: 118

Project: Plantation Extension, Project #4065

To: Michele S. McNeill SR/WA  
Property Acquisition Agent

From: Kenneth Pitt  
Real Estate Title Examiner

*JP*

STRAP: 06-45-25-03-00021.0090

Effective Date: March 14, 2005, at 5:00 p.m.

*No other changes as of  
2/14/07  
Michele S. McNeill*

**Subject Property:** Lots 9, 10, 11 & 12, in Block 21 on the plat of Florimond Manor, recorded in Plat Book 7 Page 6, Public Records of Lee County, Florida.

Title to the subject property is vested in the following:

**Emil Weiman, Inc., (a Florida Corporation)**

By that certain instrument dated November 5, 1971, recorded November 5, 1971, in Official Record Book 748 Page 94, Public Records of Lee County, Florida.

**Easements: 1): Subject to an Easement reserved over the Southerly 5 feet of the subject property for Public Utilities, as shown on the plat of Florimond Manor, recorded in Plat Book 7 Page 6, Public Records of Lee County, Florida.**

**2): Subject to Restrictions contained in a deed recorded in Deed Book 121 Page 322, Public Records of Lee County, Florida.**

**3): Subject to a Deed of Restrictions recorded in Official Record Book 1759 Page 989, which was amended by Official Record Book 1833 Page 1787, Official Record Book 2030 Page 3485, Official Record Book 2156 Page 2642 and Official Record Book 2561 Page 3498, Public Records of Lee County, Florida. Note the Declarant never owned the subject property.**

**Note 1): Subject property is not encumbered by a mortgage found of record.**

**Note 2): Subject to Lee County Ordinance No. 86-14, relating to garbage and solid waste collection, recorded in Official Record Book 2189 Page 3281 and amended by Official Record Book 2189 Page 3334, Public Records of Lee County, Florida.**

*Taxes paid for Tax Year 2006*

**Tax Status: ~~\$533.12 paid on 11-5-04 for Tax Year 2004.~~**

*(The end user of this report is responsible for verifying tax and/or assessment information.)*

**The Division of County Lands has made a diligent search of the Public Record. However, this report contains no guarantees nor warranty as to its accuracy.**

EXECUTIVE SUMMARY

PROJECT NAME: Plantation Road Extension

PARCEL #: 118

PROJECT NUMBER: 4065

OWNER OF RECORD: Emil Weiman, Inc.

STRAP NUMBER: 06-45-25-03-00021.0090

LOCATION: 6524 Fairview Street

PARENT TRACT: 26,731.9 s.f.

PART TAKEN: 1,950 square foot slope easement

IMPROVEMENTS: None

ZONING/LAND USE: AG-2/Wetlands

HIGHEST AND BEST USE: Residential Development

ESTIMATE OF VALUE - COST APPROACH: N/A

ESTIMATE OF MARKET VALUE: Slope Easement - \$3,170.00

ESTIMATE OF VALUE - INCOME APPROACH: N/A

JUST COMPENSATION DUE PROPERTY OWNER: \$3,170.00

PRICE PER SQUARE FOOT: \$6.50 (parent tract) \$1.63 (slope easement)

INTEREST APPRAISED: 15' Slope Easement

DATE OF VALUATION: 22 November 2006

APPRAISER: Mr. David C. Vaughan, MAI



Location Map

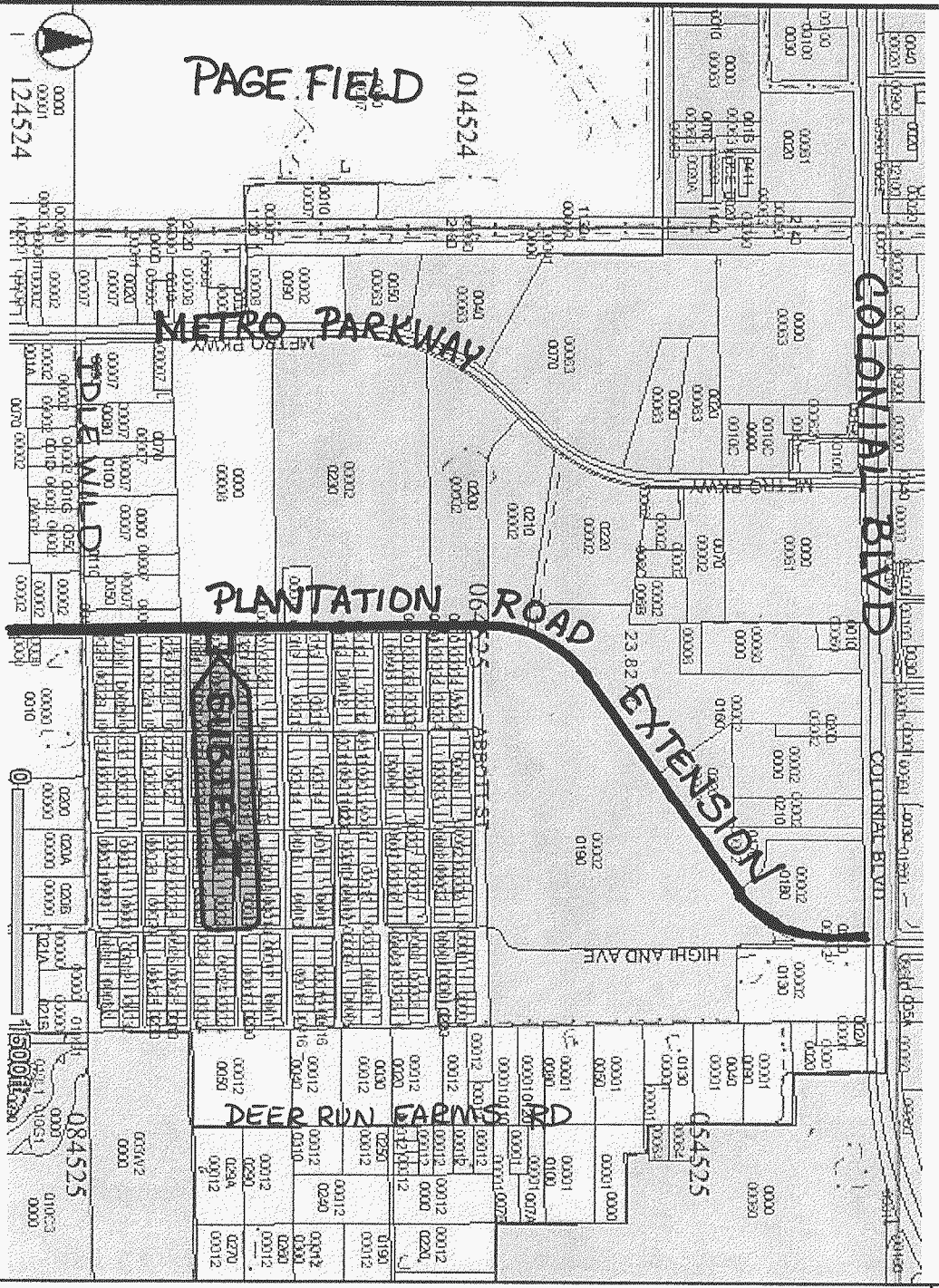

PAGE FIELD

014524

METRO PARKWAY

COLONIAL BLVD

PLANTATION ROAD

DEER RUN FARM ROAD

HIGH AND AVE

124524

084525

054525

# 5-Year Sales History

Parcel No. 118

Plantation Road Extension Project, No. 4065

NO SALES in PAST 5 YEARS

**NOTE: Sale(s) relate to "parent tract" of the subject parcel.**