

# MILL/OVERLAY AND PHASE I FINAL PAVEMENT LIFT PLANS

## THREE OAKS PARKWAY EXTENSION ALICO ROAD TO STA 288+36.50 (PHASE I END)

LEE COUNTY PROJECT NO. CN160642/ANB

**BOARD OF LEE COUNTY COMMISSIONERS**

District ONE <i>Kevin Ruane</i>	District TWO <i>Cecil Pendergrass</i>	District THREE <i>Ray Sandelli</i>	District FOUR <i>Brian Hamman</i>	District FIVE <i>Mike Greenwell</i>
------------------------------------	------------------------------------------	---------------------------------------	--------------------------------------	----------------------------------------

**LEE COUNTY MANAGER**

*Dave Harner*

**LEE COUNTY DEPARTMENT OF TRANSPORTATION**

*Robert Price, Director  
Vincent Miller, Project Manager*

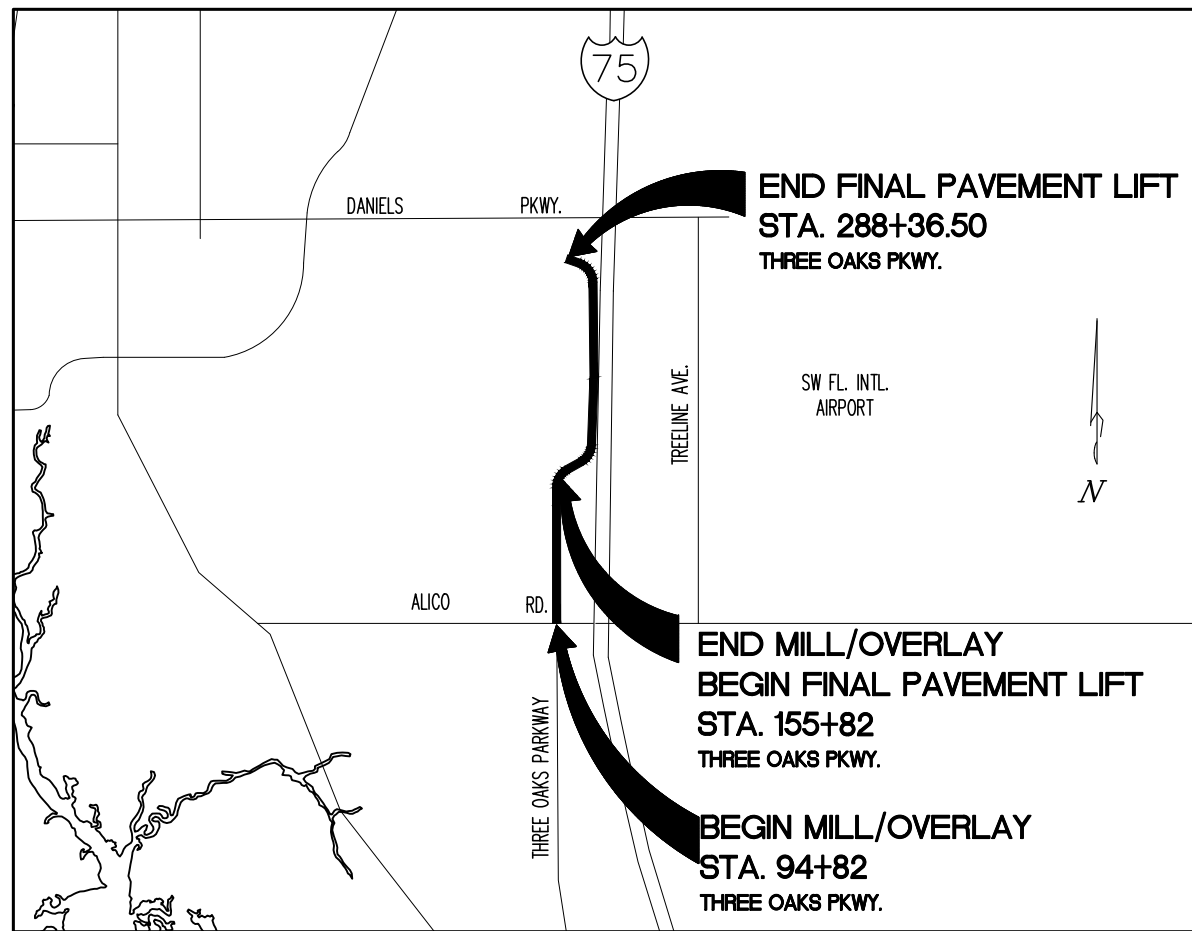
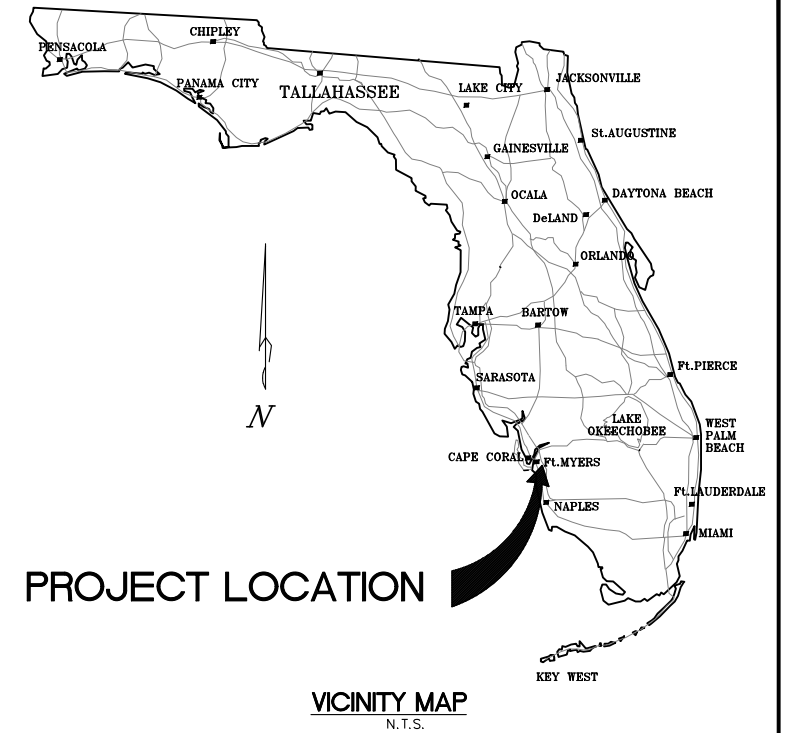

**INDEX OF MILLING AND OVERLAY PLANS**

1	COVER SHEET
2	SUMMARY OF PAY ITEMS
3	GENERAL NOTES
4-5	TYPICAL SECTIONS
6	PROJECT LAYOUT
7-12	MILL-OVERLAY AND PAVEMENT PLANS
13	EROSION CONTROL DETAILS

ATTENTION IS DIRECTED TO THE FACT THAT THESE PLANS MAY HAVE BEEN REDUCED IN SIZE BY REPRODUCTION. THIS MUST BE CONSIDERED WHEN OBTAINING SCALED DATA.

EXCEPT WHERE OTHERWISE INDICATED BY SPECIAL PROVISION. THE GOVERNING SPECIFICATIONS SHALL BE: STATE OF FLORIDA, DEPARTMENT OF TRANSPORTATION, STANDARD SPECIFICATIONS FOR ROAD AND BRIDGE CONSTRUCTION FY 2024-2025 STANDARD PLANS FOR ROADWAY FY 2024-2025, AND SUPPLEMENTS THERETO IF NOTED IN THE SPECIAL PROVISIONS FOR THIS PROJECT.

MILL/OVERLAY & FINAL PAVEMENT LIFT PHASE I PLANS  
ENGINEER OF RECORD: BRENDAN D. SLOAN, P.E.  
FL. LICENSE NO. 69978

THIS ITEM HAS BEEN DIGITALLY SIGNED AND SEALED BY BRENDAN D. SLOAN, P.E. ON THE DATE BELOW. PRINTED COPIES OF THIS DOCUMENT ARE NOT CONSIDERED SIGNED AND SEALED AND THE SIGNATURE MUST BE VERIFIED ON ANY ELECTRONIC COPIES.

DATE	BY	REVISION DESCRIPTION

*BID SET PLANS*

AVALON PROJECT: 17-372  
PROJ. MGR. BRENDAN D. SLOAN, P.E.  
LEE COUNTY DOT PROJECT: CN160642/ANB  
LDOT PROJ. MGR. VINCENT MILLER

**AVALON ENGINEERING, INC.**  
2503 DEL PRADO BLVD, SUITE 200  
CAPE CORAL, FLORIDA 33904  
FBPE#3128 (239) 573-2077

**LEE COUNTY DEPARTMENT OF TRANSPORTATION**  
(239) 533-8580

**THREE OAKS PARKWAY EXTENSION**  
*ALICO ROAD TO STA 288+36.50 (PHASE I END)*  
LEE COUNTY, FLORIDA

**COVER SHEET**

SHEET  
1 of 13

P:\CAD\2017\17-372\3-OAKS-MILL-OVERLAY\PILOT\Cover\_MILL-OVERLAY.dwg\_1 COVER -10/14/2024 6:50:14 AM AVALON ENGINEERING, INC.

**PAY ITEM NOTES**

- 104-18 QUANTITY IS BASED UPON USE OF APPROVED EROSION CONTROL METHODS FOR INLET PROTECTION AROUND EACH EXISTING & PROPOSED INLET AND JUNCTION BOX.
- 1050-18-002 UNIT COST TO INCLUDE ALL WORK AND MATERIAL ASSOCIATED WITH PLACEMENT OF A NON-SHRINK GROUT TO PLUG EXISTING 3" DRAIN PIPE AT INLETS IN PHASE I OF THE THREE OAKS EXTENSION.

SUMMARY OF PAY ITEMS				
Item Number	Item Description	QUANTITY	UNIT	NOTES
<b>Roadway Items:</b>				
101-1	MOBILIZATION, SURVEY, LAYOUT, AND RECORD DRAWINGS	1	LS	
102-1	MAINTENANCE OF TRAFFIC	1	LS	
104-18	INLET PROTECTION SYSTEM	130	EA	
104-100	NPDES POLLUTION CONTROL	1	LS	NPDES POLLUTION CONTROL
327-70-6	MILLING EXIST ASPH PAVEMENT (1.5" AVG DEPTH)	74,131	SY	
337-7-83	SUPERPAVE ASPHALTIC CONCRETE, TRAFFIC C, FC-12.5, PG 76-22 (1.5")	12,632.6	TN	FRICITION COURSE
1050-18-002	UTILITY PIPE, PLUG (3" DRAIN PIPE AT P5-P6 INLETS PHASE I)	66	EA	PLUG 3" PIPE WITH NON-SHRINK GROUT

P:\CAD\2017\17-372\8-OAKS-MILL-OVERLAY\PILOT\MO\_SUM\_PAY-ITEMS.dwg 2 SUMMARY OF 10/4/2024 6:50:21 AM Avalon Engineering Inc.

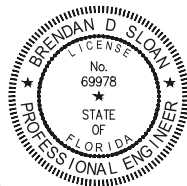

THE OFFICIAL RECORD OF THIS SHEET IS THE ELECTRONIC FILE DIGITALLY SIGNED AND SEALED UNDER RULE 61G15-23.004FAC, ON 10/4/2024

PRINTED COPIES OF THIS DOCUMENT ARE NOT CONSIDERED SIGNED AND SEALED AND THE SIGNATURE MUST BE VERIFIED ON ANY ELECTRONIC COPIES

DATE	BY	REVISION DESCRIPTION

*BID SET PLANS*

AVALON PROJECT: 17-372  
 PROJ. MGR.: BRENDAN D. SLOAN, P.E.  
 LEE COUNTY DOT PROJECT: CN160642/ANB  
 LDOT PROJ. MGR.: VINCENT MILLER

**AVALON ENGINEERING, INC.**  
 2503 DEL PRADO BLVD, SUITE 200  
 CAPE CORAL, FLORIDA 33904  
 FBPE #3128 (239) 573-2077

**LEE COUNTY DEPARTMENT OF TRANSPORTATION**  
 (239) 533-8580

**THREE OAKS PARKWAY EXTENSION**  
 ALICO ROAD TO STA 288+36.50 (PHASE I END)  
 LEE COUNTY, FLORIDA

SUMMARY OF  
PAY ITEMS

SHEET  
2 of 13

**GENERAL CONSTRUCTION NOTES**

- UNLESS OTHERWISE NOTED, ALL ELEVATIONS REFER TO MEAN SEA LEVEL, N.A.V.D. 1988. TO CONVERT TO N.G.V.D. 1929 ADD 1.18 FEET.
- LOCATIONS, ELEVATIONS, AND DIMENSIONS OF EXISTING UTILITIES, STRUCTURES AND OTHER FEATURES ARE SHOWN ACCORDING TO THE BEST INFORMATION AVAILABLE AT THE TIME OF PREPARATION OF THESE PLANS, BUT DO NOT PURPORT TO BE ABSOLUTELY CORRECT. PRIOR TO CONSTRUCTION, THE CONTRACTOR SHALL VERIFY ALL UTILITIES AND BE FULLY RESPONSIBLE FOR ANY AND ALL DAMAGES WHICH MIGHT BE OCCASIONED BY THE FEATURES AFFECTING THEIR WORK. ANYTHING NOT SHOWN ON THESE DRAWINGS THAT WILL CAUSE A CHANGE TO THE CONSTRUCTION PROJECT SHOULD BE BROUGHT TO THE IMMEDIATE ATTENTION OF THE ENGINEER AND SHALL NOT CONSTITUTE AN EXTRA, UNLESS APPROVED BY THE ENGINEER.
- THE CONTRACTOR SHALL PROVIDE AT LEAST 48 HOURS NOTICE TO THE INDIVIDUAL UTILITY COMPANIES, LEE COUNTY UTILITIES (LCU) AND L.C.D.O.T. PRIOR TO CONSTRUCTION.
- ALL MATERIALS AND WORKMANSHIP UNDER THIS PROJECT SHALL BE IN STRICT ACCORDANCE WITH THE CURRENT CONSTRUCTION STANDARDS AND SPECIFICATIONS OF LEE COUNTY DEVELOPMENT STANDARDS, LEE COUNTY DEPARTMENT OF TRANSPORTATION (LCDOT), FLORIDA DEPARTMENT OF TRANSPORTATION (FDOT) STANDARD SPECIFICATIONS FOR ROAD AND BRIDGE CONSTRUCTION DATED JULY 2022 AND STANDARD PLANS FOR ROADWAY FY 2023-2024, UNLESS OTHERWISE NOTED.
- ALL CONSTRUCTION WITHIN THE COUNTY RIGHT-OF-WAY SHALL BE IN STRICT ACCORDANCE WITH THE CURRENT LEE COUNTY DEPARTMENT OF TRANSPORTATION STANDARDS AND ALL REQUIRED INSPECTIONS PERFORMED AS REQUIRED BY THEM. CONTRACTOR SHALL PROVIDE BOND AND PERMIT FEE AS REQUIRED.
- PAVEMENT MARKINGS AND SIGNS SHALL BE IN STRICT ACCORDANCE WITH THE "MANUAL ON UNIFORM TRAFFIC CONTROL DEVICES FOR STREETS AND HIGHWAYS", FDOT STANDARD PLANS AND LEE COUNTY DOT TRAFFIC SECTION DESIGN STANDARD FOR SIGN INSTALLATION 2021.
- ALL PERVIOUS AREAS WITHIN THE PROJECT CONSTRUCTION LIMITS SHALL BE GRASSED, SODDED OR MULCHED; OR IN ACCORDANCE WITH THE APPROVED LANDSCAPE PLAN IF INCLUDED WITH THIS PLAN SET OR PROVIDED SEPARATELY AS PART OF CONTRACT.
- CONTRACTOR SHALL VERIFY ALL QUANTITIES SHOWN ON THE PLANS. IF ANY DISCREPANCIES IN QUANTITIES ARE FOUND, THE CONTRACTOR SHALL NOTIFY THE PROJECT ENGINEER AND/OR L.C.D.O.T.
- ALL REGULATORY AND PERMITTING AGENCIES' REQUIREMENTS SHALL BE COMPLIED WITH.
- APPROPRIATE TURBIDITY CONTROL DEVICES (E.G. SILT FENCES, SYNTHETIC BAILS) WILL BE UTILIZED DURING ALL PHASES OF INSTALLATION AND GRADING. CONTRACTOR IS RESPONSIBLE FOR SUBMITTING THE NPDES NOTICE OF INTENT, NOTICE OF TERMINATION, AND LEE COUNTY RIGHT OF WAY PERMITS. NOI MUST BE FILED WITH FDEP IN ACCORDANCE WITH DEP DOCUMENT NO. 62-621 AT LEAST 48 HOURS PRIOR TO THE START OF CONSTRUCTION. CONTRACTOR IS RESPONSIBLE FOR DEVELOPING AND MAINTAINING AN EFFECTIVE STORMWATER POLLUTION PREVENTION PLAN.
- TRAFFIC MUST BE MAINTAINED AT ALL TIMES AS PER LEE COUNTY DEPARTMENT OF TRANSPORTATION (L.C.D.O.T.) AND PER FLORIDA DEPARTMENT OF TRANSPORTATION (F.D.O.T.) STANDARD SPECIFICATIONS FOR ROAD AND BRIDGE CONSTRUCTION, LATEST EDITION.
- THE CONTRACTOR SHALL REPLACE ALL PAVEMENT, CURBS, DRIVEWAYS, SIDEWALKS, FENCES, ETC., WITH THE SAME TYPE OF MATERIAL THAT WAS REMOVED DURING CONSTRUCTION OR AS DIRECTED BY THE ENGINEER. THE CONTRACTOR SHALL RESTORE ALL AREAS AFFECTED BY THE CONSTRUCTION TO ITS ORIGINAL CONDITION, OR BETTER.
- WITHIN THE L.C.D.O.T. RIGHT-OF-WAY, ALL DISTURBED AREAS SHALL RECEIVE SODDING MATERIALS IN ACCORDANCE WITH F.D.O.T. SPECIFICATIONS. THOSE AREAS THAT ARE CLASSIFIED AS DRAINAGE DITCHES SHALL RECEIVE FULL SOLID SOD.
- THE INFORMATION PROVIDED IN THESE PLANS IS SOLELY TO ASSIST THE CONTRACTOR IN ASSESSING THE NATURE AND EXTENT OF CONDITIONS WHICH MAY BE ENCOUNTERED DURING THE COURSE OF WORK. ALL CONTRACTORS ARE DIRECTED, PRIOR TO BIDDING, TO CONDUCT WHATEVER INVESTIGATIONS THEY MAY DEEM NECESSARY TO ARRIVE AT THEIR OWN CONCLUSION REGARDING THE ACTUAL CONDITIONS THAT WILL BE ENCOUNTERED, AND UPON WHICH THEIR BIDS WILL BE BASED.
- ALL FRAMES, COVERS, VALVE BOXES, METER BOXES, AND MANHOLES SHALL BE ADJUSTED TO FINISHED GRADE UPON COMPLETION OF PAVING OR RELATED CONSTRUCTION. ALL VALVE PADS SHALL BE POURED IN PLACE. NO PRE-FORMED VALVE PADS ALLOWED.
- CONTRACTOR IS REQUIRED TO SUBMIT MAINTENANCE OF TRAFFIC (M.O.T.) PLANS FOR REVIEW AND APPROVAL BY L.C.D.O.T. PRIOR TO CONSTRUCTION. M.O.T. PLANS SHALL BE IN ACCORDANCE WITH THE LATEST VERSION (2023-2024) OF FDOT DESIGN STANDARDS.
- COST OF FILTER FABRIC TO BE INCLUDED IN THE COST OF RIPRAP.
- ANY CONSTRUCTION ACTIVITY OUTSIDE OF THE R/W LINES SHALL BE COORDINATED BY THE CONTRACTOR WITH THE ADJACENT PROPERTY OWNER IN WRITING AND A COPY OF THE APPROVAL SHALL BE PROVIDED TO L.C.D.O.T.

**UTILITY INFORMATION:**

TELEPHONE: CENTURY LINK  
2820 CARGO STREET  
FORT MYERS, FL 33916  
(239) 332-0841

REFUSE: WASTE PRO  
13110 RICKENBACKER PARKWAY  
FORT MYERS, FL 33913  
(239) 337-0800

WATER/SEWER: LEE COUNTY UTILITIES  
1500 MONROE STREET  
FORT MYERS, FL 33901  
(239) 533-8160

CABLE: COMCAST  
26100 BONITA GRANDE DRIVE  
BONITA SPRINGS, FL 34135  
(855) 616-9200





ELECTRIC: FLORIDA POWER AND LIGHT  
15834 WINKLER ROAD  
FORT MYERS, FL 33908  
(239) 267-0974

FIRE DISTRICT: SAN CARLOS PARK FIRE PROTECTION & RESCUE SERVICE DISTRICT  
19591 BEN HILL GRIFFIN PARKWAY  
FORT MYERS, FL 33913  
(239) 267-7525

**ABBREVIATIONS**

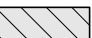
ABD.	ABANDONED	MOD.	MODIFIED
AC.	ACRE	N	NORTH
AH	AHEAD	NAVD	NORTH AMERICAN VERTICAL DATUM
ALT.	ALTERNATE	NO.	NUMBER
AL.	ALUMINUM	NGVD	NATIONAL GEODETIC VERTICAL DATUM
ANSI	AMERICAN NATIONAL STANDARDS INSTITUTE	NPT	NATIONAL PIPE THREAD
AOR	AXIS OF ROTATION	NE	NORTHEAST
ARV	AIR RELEASE VALVE	NLY.	NORTHERLY
ASPH.	ASPHALT	NW	NORTHWEST
ASSEM.	ASSEMBLY	OC	ON CENTERS
ASTM	AMERICAN SOCIETY FOR TESTING MATERIALS	O/E	OR EQUAL
AWWA	AMERICAN WATER WORKS ASSOCIATION	O/O	OUTSIDE TO OUTSIDE
AVE	AVENUE	PKWY	PARKWAY
BK	BACK	PAVT.	PAVEMENT
BLVD.	BOULEVARD	PEN.	PENETRATION
BM	BENCH MARK	PI	POINT OF INTERSECTION
BOT.	BOTTOM	PL	PLACE
BO	BLOW OFF	PRM	PERMANENT REFERENCE MONUMENT
BTFLY.	BUTTERFLY	PT	POINT OF TANGENCY
CAP	CORRUGATED ALUMINUM PIPE	PROP. PGL	PROPOSED PROFILE GRADE LINE
CATV	CABLE TELEVISION	PS	PUMP STATION
CB	CATCH BASIN	PSI	POUNDS PER SQUARE INCH
C & G	CURB AND GUTTER	PVC	POLYVINYL CHLORIDE
C/C	CENTER TO CENTER	PW	POTABLE WATER
CF	CUBIC FOOT	P/L	PROPERTY LINE
CL	CENTER LINE	PUE	PUBLIC UTILITY EASEMENT
CMP	CORRUGATED METAL PIPE	R.	RADIUS
CO	CLEAN OUT	RCP	REINFORCED CONCRETE PIPE
COR.	CORNER	RDWY.	ROADWAY
CONC.	CONCRETE	RED.	REDUCER
CORP.	CORPORATION	REF.	REFERENCE
CT	COURT	REINF.	REINFORCED
DIA.	DIAMETER	RELOC.	RELOCATION
DIM.	DIMENSION	REM.	REMOVAL
DRWY	DRIVEWAY	REPL.	REPLACE
DWG.	DRAWING	REQ.	REQUIRED
DIP	DUCTILE IRON PIPE	R/W	RIGHT OF WAY
E	EAST	ROW	RIGHT OF WAY
EW	EACH WAY	RT	RIGHT
EOP	EDGE OF PAVEMENT	R/W	RIGHT OF WAY
EOTW	EDGE OF TRAVEL WAY	SAN.	SANITARY
EL.	ELEVATION	SEW.	SEWER
ELEC.	ELECTRICAL	SCH.	SCHEDULE
ELEV.	ELEVATION	S	SOUTH
ESMT	EASEMENT	SD	STORM DRAIN
ERCP	ELLIPTICAL REINFORCED CONCRETE PIPE	SE	SOUTHEAST
EX.	EXISTING	SECT.	SECTION
EXIST.	EXISTING	SHLDR.	SHOULDER
EXIST. PGL	EXISTING PROFILE GRADE LINE	SLY.	SOUTHERLY
FAC	FLORIDA ADMINISTRATIVE CODE	SPEC.	SPECIFICATION
FDOT	FLORIDA DEPARTMENT OF TRANSPORTATION	SQ. FT.	SQUARE FOOT
FH	FIRE HYDRANT	SQ. IN.	SQUARE INCH
FL	FLOW LINE	SS	SANITARY SEWER
FO	FIBER OPTIC	STD.	STANDARD
FOC	FIBER OPTIC CABLE	ST.	STREET
FLG.	FLANGED	STA.	STATION
FT	FOOT	SW	SOUTHWEST
FM	FORCE MAIN	SWK	SIDEWALK
GALV.	GALVANIZED	TEL.	TELEPHONE
GAL.	GALLON	TB	TELEPHONE BOX
GM	GAS MAIN	TER	TERRACE
IN.	INCH	TYP.	TYPICAL
INC.	INCORPORATED	USF	UNITED STATES FOUNDRY
INV	INVERT	UTS	UNITED TELEPHONE SERVICE
IRR.	IRRIGATION LINE	UTIL.	UTILITIES
JB	JUNCTION BOX	VAR.	VARIES
LB.	POUND	VOL.	VOLUME
LBR	LIMEROCK BEARING RATIO	WM	WATER MAIN
LCDOT	LEE COUNTY DEPARTMENT OF TRANSPORTATION	W	WEST
LCU	LEE COUNTY UTILITIES	W/	WITH
LF	LINEAR FOOT	XSEC	CROSS SECTION
LN	LANE		
LT	LEFT		
MAX.	MAXIMUM		
MH	MANHOLE		
MIN.	MINIMUM		
MISC.	MISCELLANEOUS		
MJ	MECHANICAL JOINT		
MV	MEDIUM VOLTAGE		
MOT	MAINTENANCE OF TRAFFIC		

**LEGEND**

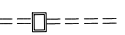
-  MAINLINE & TURNOUT MILL/OVERLAY
-  SHOULDER MILL/OVERLAY
-  PHASE I FINAL PAVEMENT LIFT
-  INLET/MES PROTECTION
-  EXIST. STORM DRAIN & INLET

**NOTE:**  
1.) ALL EXISTING AND PROPOSED GRADES SHOWN REFER TO N.A.V.D. 1988. TO CONVERT TO N.G.V.D. 1929 ADD 1.18 FT.

P:\CAD\2017\17-372\8-OAKS-MILL-OVERLAY\PILOT\17-372\_M.O.-GEN.NOTES.dwg - 3.GENERAL NOTES - 10/14/2024 6:50:25 AM - Avalon Engineering, Inc.



THE OFFICIAL RECORD OF THIS SHEET IS THE ELECTRONIC FILE DIGITALLY SIGNED AND SEALED UNDER RULE 61G15-23.004FAC, ON 10/14/2024

PRINTED COPIES OF THIS DOCUMENT ARE NOT CONSIDERED SIGNED AND SEALED AND THE SIGNATURE MUST BE VERIFIED ON ANY ELECTRONIC COPIES

DATE	BY	REVISION DESCRIPTION

**BID SET PLANS**

AVALON PROJECT: 17-372  
PROJ. MGR. BRENDAN D. SLOAN, P.E.  
LEE COUNTY DOT PROJECT: CN160642/ANB  
LDOT PROJ. MGR. VINCENT MILLER

**AVALON ENGINEERING, INC.**  
2503 DEL PRADO BLVD, SUITE 200  
CAPE CORAL, FLORIDA 33904  
FBPE#3128 (239) 573-2077

**LEE COUNTY DEPARTMENT OF TRANSPORTATION**  
(239) 533-8580

**THREE OAKS PARKWAY EXTENSION**  
ALICO ROAD TO STA 288+36.50 (PHASE I END)  
LEE COUNTY, FLORIDA

**GENERAL NOTES AND LEGEND**

SHEET  
3 of 13

**THREE OAKS PKWY PAVEMENT**

TRAFFIC 'C'

**SURFACE COURSES**

TYPE "SP-12.5" FRICTION COURSE (1.5") THIS CONTRACT

**SURFACE COURSES**

1" TYPE S-III ASPHALTIC CONCRETE, SKID RESISTANT WEARING SURFACE COURSE (EXISTING)  
2.5" TYPE S-I ASPHALTIC CONCRETE SURFACE COURSE (EXISTING)

**BASE COURSE**

10" COMPACTED BASEROCK- PRIMED (LBR100, 98% MODIFIED PROCTOR) (EXISTING)

**SUBGRADE**

12" STABILIZED SUBGRADE (LBR40, 95% MODIFIED PROCTOR) (EXISTING)

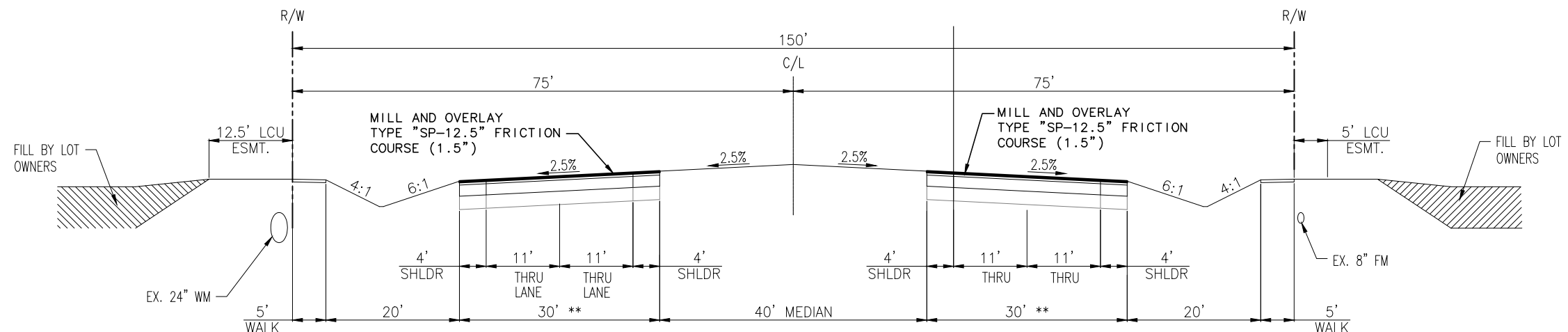

\*\* TOTAL WIDTH VARIES REFER TO MILL/OVERLAY PLAN SHEETS

**THREE OAKS PARKWAY  
TYPICAL SECTION  
STA 152+64 TO STA 156+00  
N.T.S.**

**ASPHALT PAVEMENT REPAIR NOTE:**

PRIOR TO THE MILLING OF THE EXISTING PAVEMENT, LEE COUNTY'S REPRESENTATIVE WILL IDENTIFY ANY AREAS OF PAVEMENT NEEDING REPAIR. CONTRACTOR SHALL PERFORM THE PAVEMENT REPAIRS PER DETAILS BELOW. PAYMENT FOR ASPHALT AND BASE COURSE REMOVAL/DISPOSAL TO BE INCLUDED IN SAW CUT UNIT PRICE.

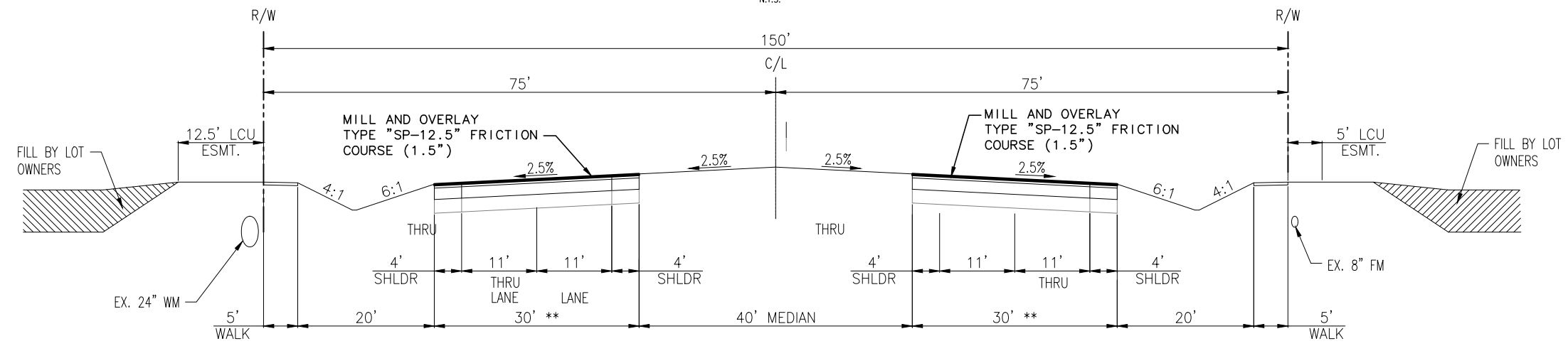

\*\* TOTAL WIDTH VARIES REFER TO MILL/OVERLAY PLAN SHEETS

**THREE OAKS PARKWAY  
TYPICAL SECTION  
STA 105+22 TO STA 152+64  
N.T.S.**

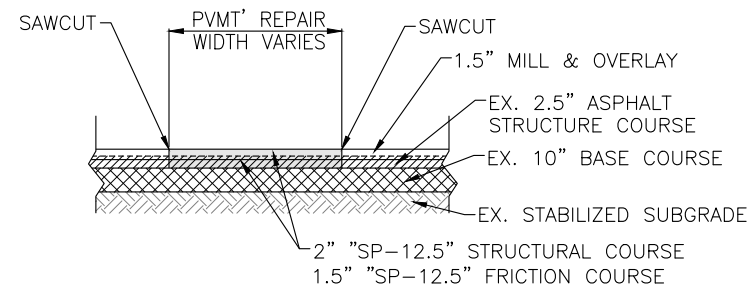

**ASPHALT PAVEMENT REPAIR DETAIL**

N.T.S.

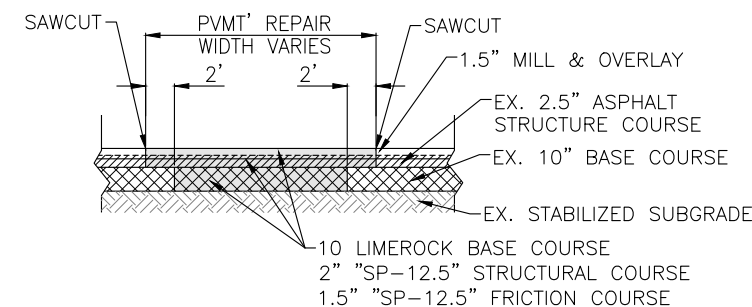

**ASPHALT PAVEMENT REPAIR DETAIL  
WITH BASE COURSE REPLACEMENT**

N.T.S.

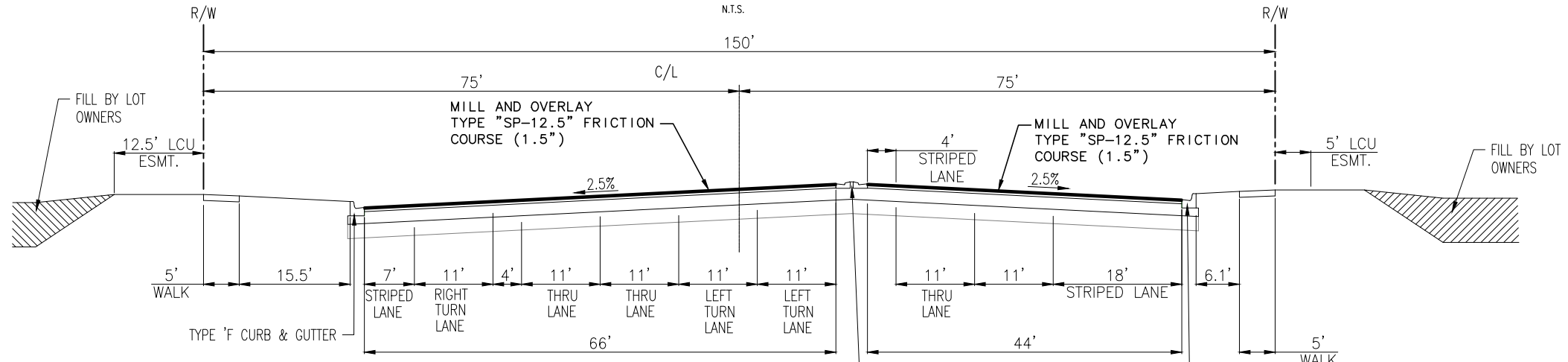

**THREE OAKS PARKWAY  
TYPICAL SECTION  
STA 94+82 TO STA 105+22  
N.T.S.**

P:\CAD\2017\17-372\3-OAKS-MILL-OVERLAY\PILOT\MO\_TYP-SECT\_ALICO.dwg 4 TYPICAL SECTIONS 10/14/2024 6:50:30 AM Avalon Engineering, Inc.

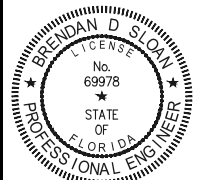

THE OFFICIAL RECORD OF THIS SHEET IS THE ELECTRONIC FILE DIGITALLY SIGNED AND SEALED UNDER RULE 61G15-23.004FAC, ON 10/14/2024	PRINTED COPIES OF THIS DOCUMENT ARE NOT CONSIDERED SIGNED AND SEALED AND THE SIGNATURE MUST BE VERIFIED ON ANY ELECTRONIC COPIES	DATE BY REVISION DESCRIPTION

BID SET PLANS

AVALON PROJECT: 17-372  
PROJ. MGR. BRENDAN D. SLOAN, P.E.  
LEE COUNTY DOT PROJECT: CN160642/ANB  
LOOT PROJ. MGR. VINCENT MILLER

**AVALON ENGINEERING, INC.**  
2503 DEL PRADO BLVD, SUITE 200  
CAPE CORAL, FLORIDA 33904  
FBPE #3128 (239) 573-2077

LEE COUNTY DEPARTMENT OF TRANSPORTATION  
(239) 533-8580

THREE OAKS PARKWAY EXTENSION  
ALICO ROAD TO STA 288+36.50 (PHASE I END)  
LEE COUNTY, FLORIDA

TYPICAL SECTIONS  
STA 94+36 TO 156+00

SHEET  
4 of 13

**ASPHALT PAVEMENT REPAIR NOTE:**

PRIOR TO THE MILLING OF THE EXISTING PAVEMENT, LEE COUNTY'S REPRESENTATIVE WILL IDENTIFY ANY AREAS OF PAVEMENT NEEDING REPAIR. CONTRACTOR SHALL PERFORM THE PAVEMENT REPAIRS PER DETAILS ON SHEET 4. PAYMENT FOR ASPHALT AND BASE COURSE REMOVAL/DISPOSAL TO BE INCLUDED IN SAW CUT UNIT PRICE.

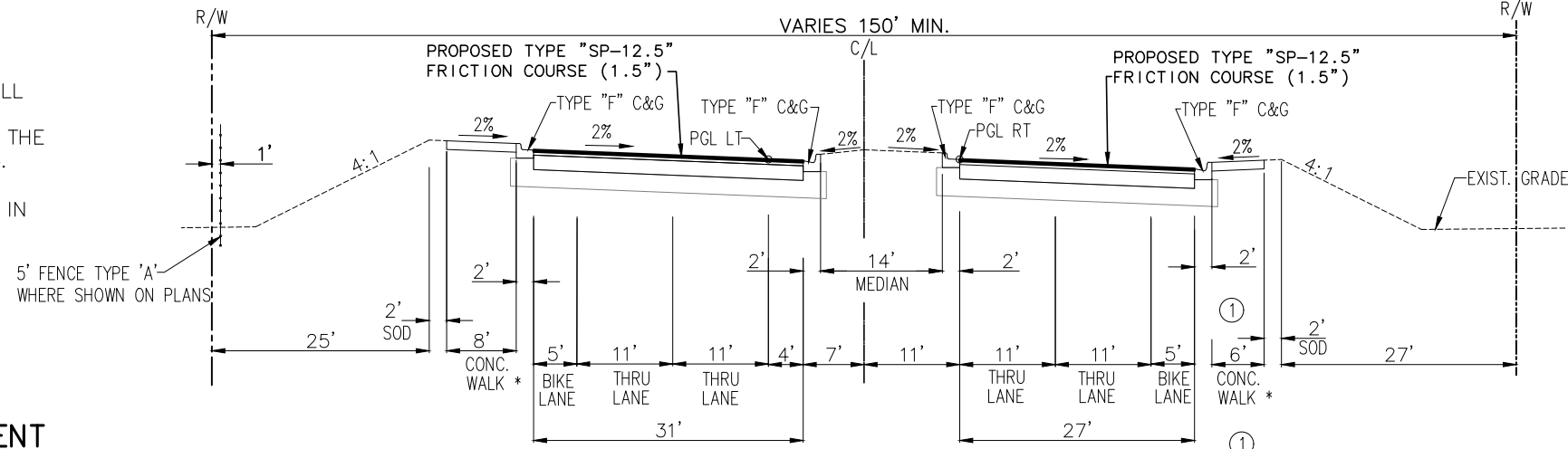

**THREE OAKS PARKWAY  
TYPICAL SECTION  
(SUPER ELEVATION - REVERSE CROWN)**  
STA 156+61.94 - 170+02.74 \*\*  
STA 175+32.74 - 188+24.60  
STA 265+49.63 - 281+97.31  
N.T.S.

CONCRETE WALK WIDTH:  
6' WIDE STA 256+00 - 273+94.44  
8' WIDE STA 273+94.44 - 288+36.50

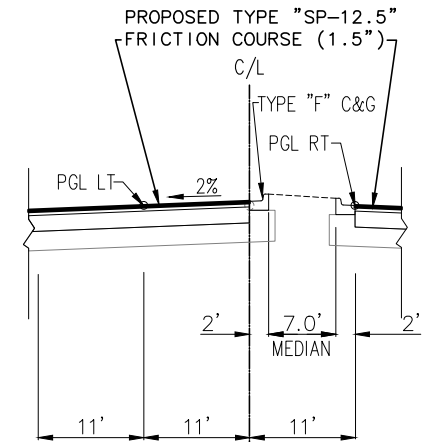

**THREE OAKS PARKWAY  
LEFT TURN LANE ALTERNATE**  
STA 282+47.50 - 287+47.50  
N.T.S.

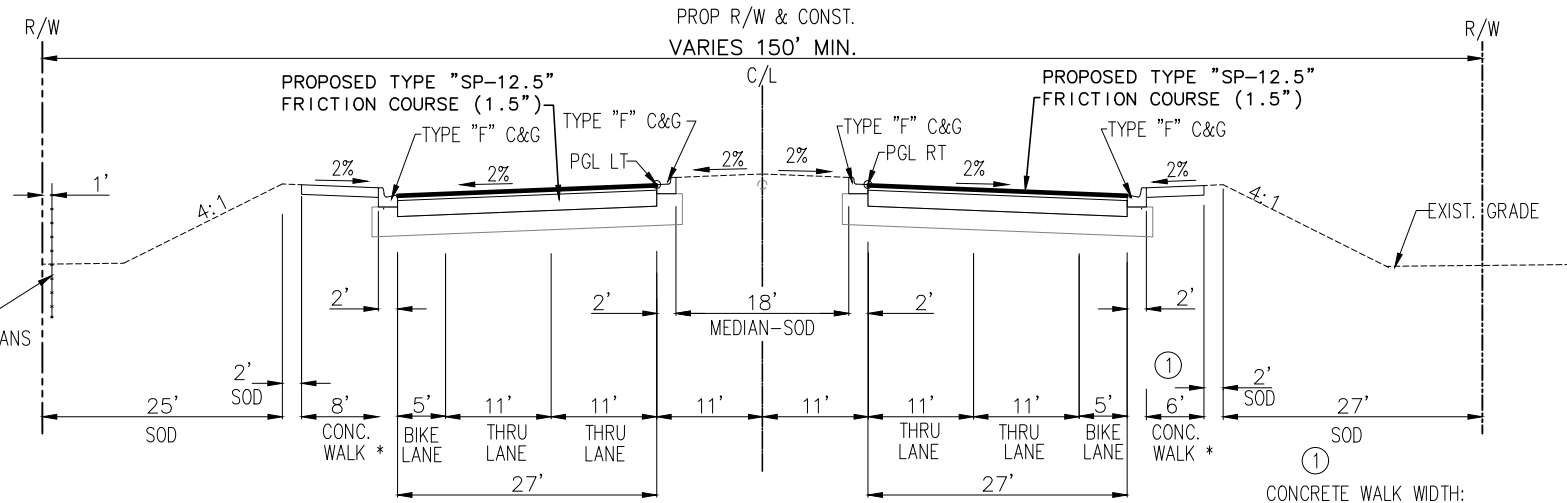

**THREE OAKS PARKWAY  
TYPICAL SECTION  
(NORMAL CROWN)**  
N.T.S.

STA 156+00 - 156+61.94  
STA 170+02.74 - 175+32.74  
STA 188+24.60 - 265+49.63  
STA 281+97.32 - 288+36.50

CONCRETE WALK WIDTH:  
6' WIDE STA 256+00 - 273+94.44  
8' WIDE STA 273+94.44 - 288+36.50

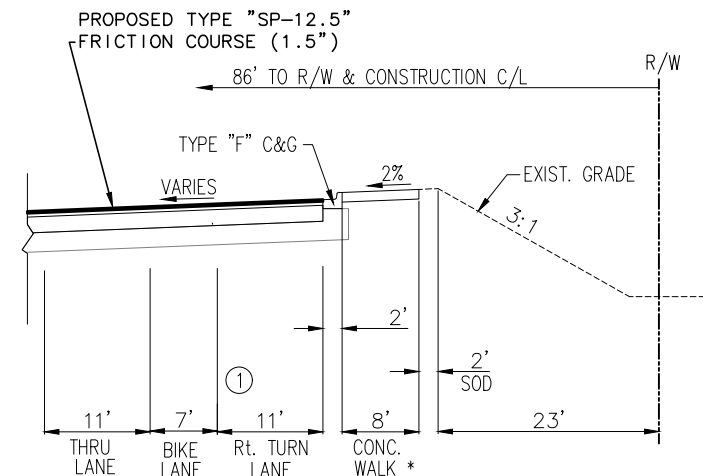

**THREE OAKS PARKWAY  
RIGHT TURN LANE ALTERNATE**  
STA 275+95.50 - 280+95.50  
N.T.S.

**THREE OAKS PKWY EXISTING PAVEMENT  
TRAFFIC 'C'**

**SURFACE COURSES**

TYPE "SP-12.5" FRICTION COURSE (1.5") - THIS CONTRACT  
TYPE "SP-12.5" STRUCTURAL COURSE (2.5") (EXISTING)

**BASE COURSE PERMITTED**

OPTIONAL BASE GROUP 9 (EXISTING)

**SUBGRADE**

12" TYPE B STABILIZATION MIN. LBR 40 (EXISTING)

FOR ADDITIONAL DETAILS SEE FDOT STANDARD PLANS INDEX  
NO.S 000-510, 000-515, 120-002, 120-001, 160-001,  
430-001, 522-001, 522-002, 522-003, AND 524-001.

**TRAFFIC DATA:**

THREE OAKS PARKWAY TO DANIELS PARKWAY INTERSECTION

DESIGN YEAR EST. 2040 A.A.D.T. = 27,520  
DESIGN SPEED = 45 MPH (THREE OAKS PARKWAY)

\* ALL CONCRETE WALK SHALL BE 6" THICK

MINIMUM PAVEMENT ELEVATIONS AT PROFILE GRADE LINE (PGL) FOR SPWMD PERMITTING		
BASIN	25 YEAR-3 DAY DESIGN STAGE	MIN. PGL ELEVATION
BASIN A	20.37' NAVD	21.48' NAVD
BASIN B	20.57' NAVD	21.48' NAVD
BASIN C	20.91' NAVD	22.02' NAVD
SOUTH BASIN	20.37' NAVD (BASIN A)	22.80' NAVD

**NOTE:**  
1.) ALL EXISTING AND PROPOSED GRADES SHOWN REFER TO N.A.V.D. 1988. TO CONVERT TO N.G.V.D. 1929 ADD 1.18 FT.

P:\CAD\2017\17-372\8-OAKS-MILL-OVERLAY\PILOT\MO\_TYP-SECT.dwg, 5 TYPICAL SECTIONS, 10/4/2024 6:50:35 AM, Avalon Engineering, Inc.

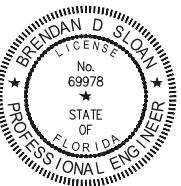

THE OFFICIAL RECORD OF THIS SHEET IS THE ELECTRONIC FILE DIGITALLY SIGNED AND SEALED UNDER RULE 61G15-23.004FAC, ON 10/4/2024

PRINTED COPIES OF THIS DOCUMENT ARE NOT CONSIDERED SIGNED AND SEALED AND THE SIGNATURE MUST BE VERIFIED ON ANY ELECTRONIC COPIES

DATE	BY	REVISION DESCRIPTION

BID SET PLANS

AVALON PROJECT: 17-372  
PROJ. MGR. BRENDAN D. SLOAN, P.E.  
LEE COUNTY DOT PROJECT: CN160642/ANB  
LDOT PROJ. MGR. VINCENT MILLER

AVALON ENGINEERING, INC.  
2503 DEL PRADO BLVD, SUITE 200  
CAPE CORAL, FLORIDA 33904  
FBPE#3128 (239) 573-2077

LEE COUNTY DEPARTMENT OF TRANSPORTATION  
(239) 533-8580

THREE OAKS PARKWAY EXTENSION  
ALICO ROAD TO STA 288+36.50 (PHASE I END)  
LEE COUNTY, FLORIDA

TYPICAL SECTIONS  
STA 156+00 TO 288+36.50

SHEET  
5 of 13

P:\CAD\2017\17-372\8-OAKS-MILL-OVERLAY\PILOT\17-372\_M.O.-PRO-LAYOUT.dwg, 6:50:41 AM, Avalon Engineering, Inc.

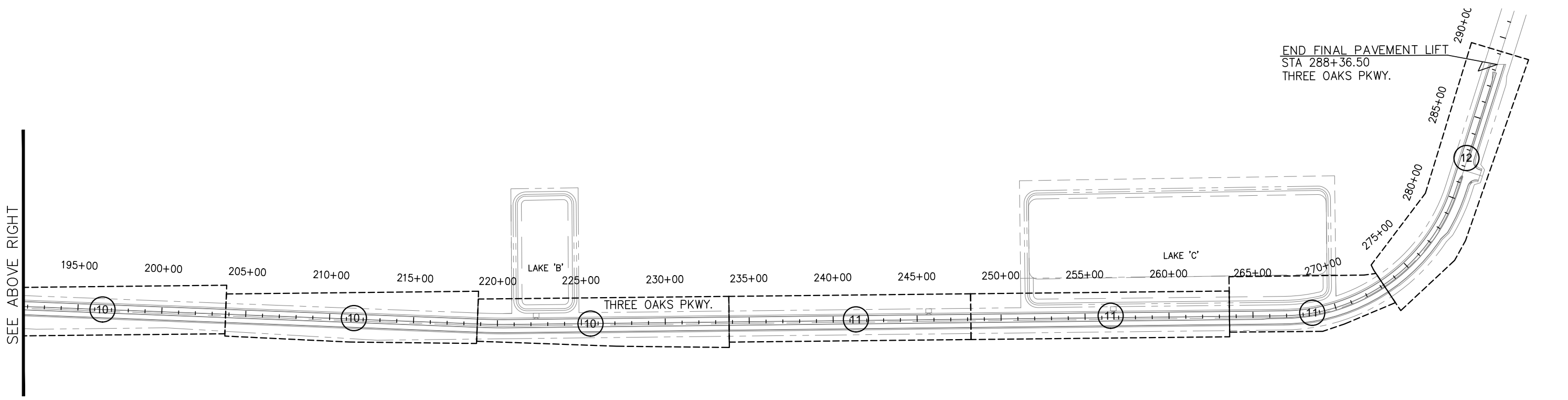
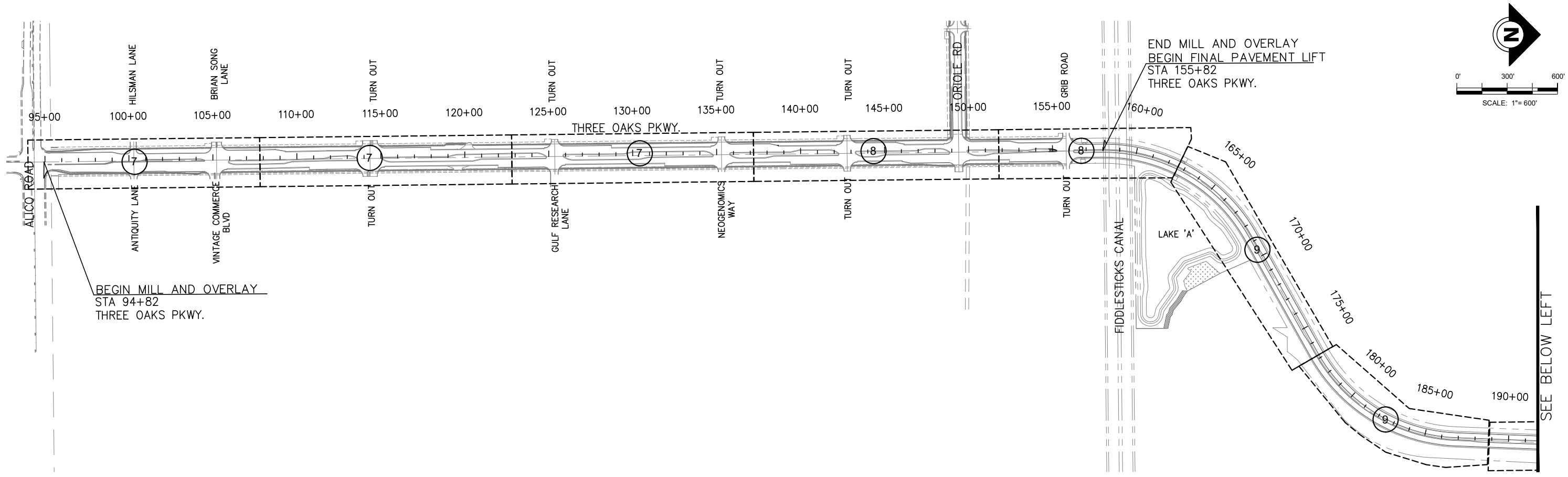

THE OFFICIAL RECORD OF THIS SHEET IS THE ELECTRONIC FILE DIGITALLY SIGNED AND SEALED UNDER RULE 61G15-23.004FAC, ON 10/4/2024

PRINTED COPIES OF THIS DOCUMENT ARE NOT CONSIDERED SIGNED AND SEALED AND THE SIGNATURE MUST BE VERIFIED ON ANY ELECTRONIC COPIES

DATE	BY	REVISION DESCRIPTION

BID SET PLANS

AVALON PROJECT: 17-372  
 PROJ. MGR. BRENDAN D. SLOAN, P.E.  
 LEE COUNTY DOT PROJECT: CN160642/ANB  
 LDOT PROJ. MGR. VINCENT MILLER

**AVALON ENGINEERING, INC.**  
 2503 DEL PRADO BLVD, SUITE 200  
 CAPE CORAL, FLORIDA 33904  
 FBPE #3128 (239) 573-2077

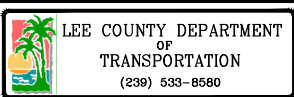

THREE OAKS PARKWAY EXTENSION  
 ALICO ROAD TO STA 288+36.50 (PHASE I END)  
 LEE COUNTY, FLORIDA

PROJECT  
 LAYOUT

SHEET  
 6 of 13

P:\CAD\2017\17-372\8-OAKS-MILL-OVERLAY\PILOT\17-372\_MILL-OVERLAY.dwg, 7 MILL-OVERLAY, 10/4/2024 6:50:56 AM, Avalon Engineering, Inc.

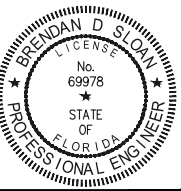
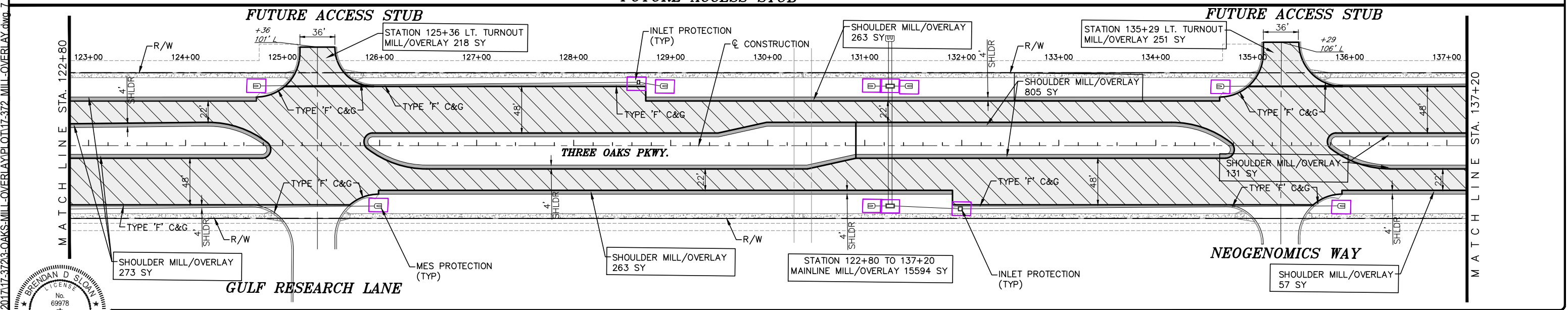
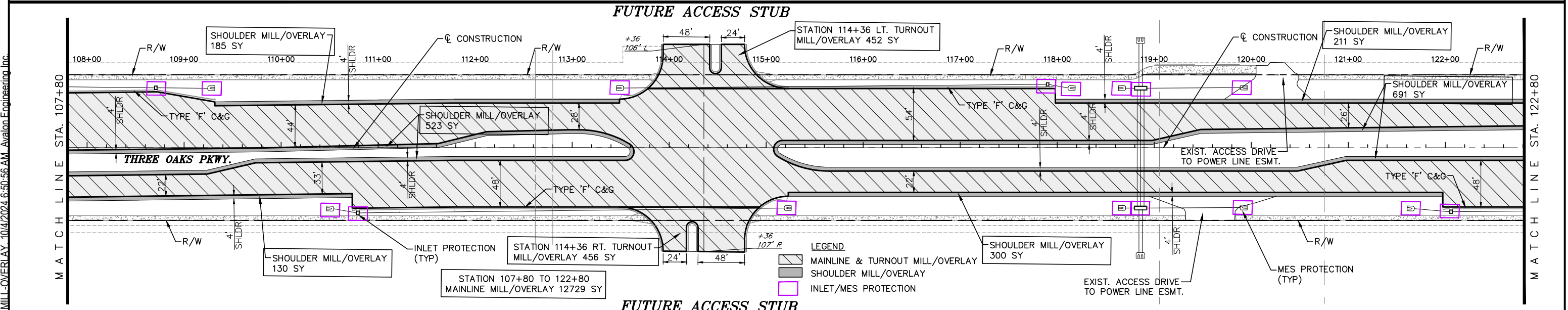
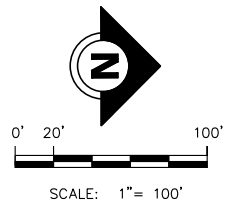
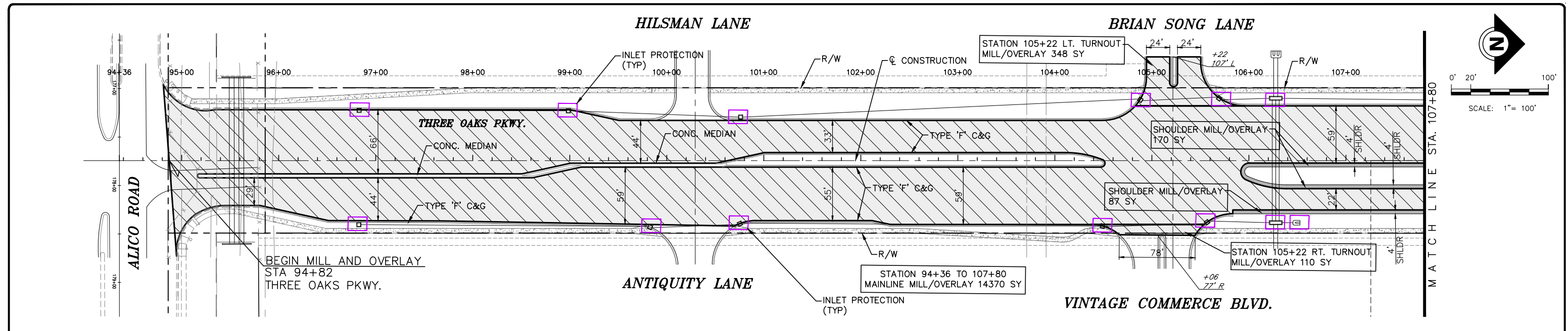

THE OFFICIAL RECORD OF THIS SHEET IS THE ELECTRONIC FILE DIGITALLY SIGNED AND SEALED UNDER RULE 61G15-23.004FAC, ON 10/4/2024

PRINTED COPIES OF THIS DOCUMENT ARE NOT CONSIDERED SIGNED AND SEALED AND THE SIGNATURE MUST BE VERIFIED ON ANY ELECTRONIC COPIES

DATE	BY	REVISION DESCRIPTION

BID SET PLANS

AVALON PROJECT: 17-372  
 PROJ. MGR. BRENDAN D. SLOAN, P.E.  
 LEE COUNTY DOT PROJECT: CN160642/ANB  
 LDOT PROJ. MGR. VINCENT MILLER

AVALON ENGINEERING, INC.  
 2503 DEL PRADO BLVD, SUITE 200  
 CAPE CORAL, FLORIDA 33904  
 FBPE#3128 (239) 573-2077

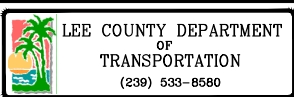

LEE COUNTY DEPARTMENT OF TRANSPORTATION  
 (239) 533-8580

THREE OAKS PARKWAY EXTENSION  
 ALICO ROAD TO STA 288+36.50 (PHASE I END)  
 LEE COUNTY, FLORIDA

MILL-OVERLAY AND PAVEMENT PLANS

SHEET 7 of 13

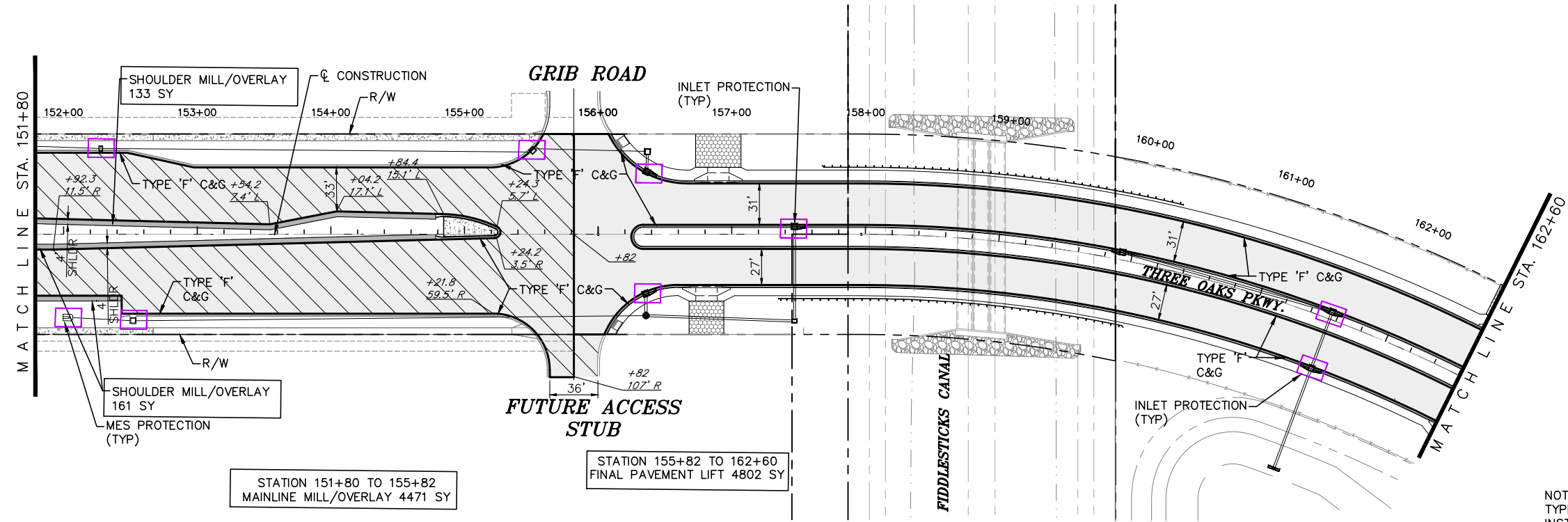
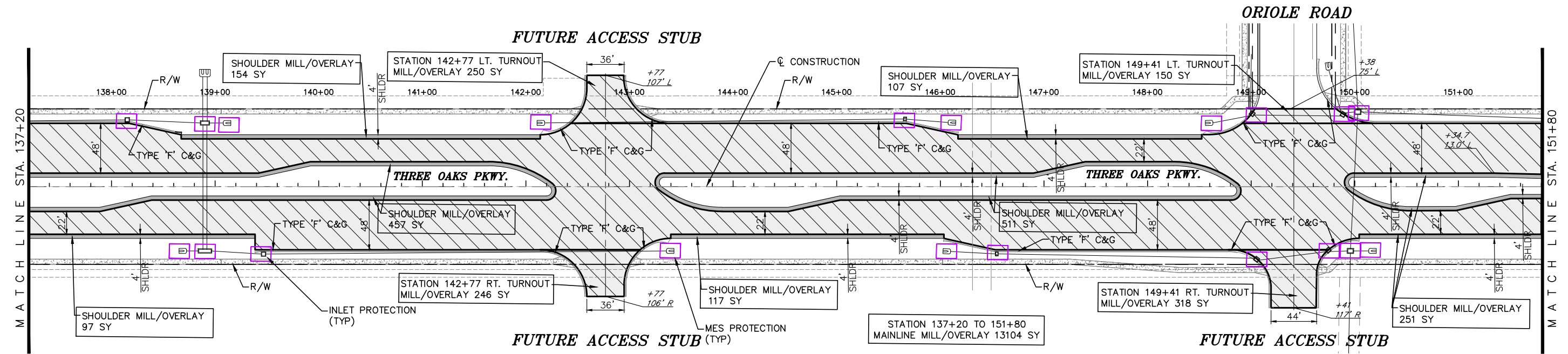
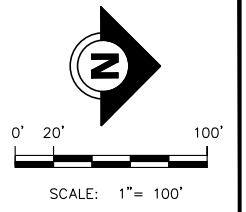

- LEGEND**
- MAINLINE & TURNOUT MILL/OVERLAY
  - SHOULDER MILL/OVERLAY
  - NEW MAINLINE PAVEMENT SECTION
  - NEW SHOULDER PAVEMENT SECTION
  - PHASE I FINAL PAVEMENT LIFT
  - INLET/MES PROTECTION

**NOTE:**  
 TYPE 'S' AND TYPE '6' INLETS HAVE A 3" PVC DRAIN INSTALLED AS PART OF THE PHASE I CONSTRUCTION TO DRAIN THE PAVEMENT ADJACENT TO THE INLETS. THESE DRAINS WILL NEED TO BE PLUGGED PRIOR TO THE FINAL PAVEMENT LIFT PLACEMENT. SEE DETAIL ON SHEET 13.

P:\CAD\2017\17-3728-OAKS-MILL-OVERLAY\PILOT\17-372\_MILL-OVERLAY.dwg, 8 MILL-OVERLAY, 10/4/2024 6:51:04 AM, Avalon Engineering, Inc.

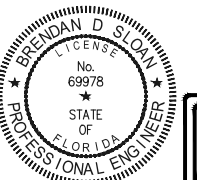

THE OFFICIAL RECORD OF THIS SHEET IS THE ELECTRONIC FILE DIGITALLY SIGNED AND SEALED UNDER RULE 61G15-23.004FAC, ON 10/4/2024		PRINTED COPIES OF THIS DOCUMENT ARE NOT CONSIDERED SIGNED AND SEALED AND THE SIGNATURE MUST BE VERIFIED ON ANY ELECTRONIC COPIES	
DATE	BY	REVISION DESCRIPTION	

**BID SET PLANS**

AVALON PROJECT: 17-372  
 PROJ. MGR. BRENDAN D. SLOAN, P.E.  
 LEE COUNTY DOT PROJECT: CN160642/ANB  
 LDOT PROJ. MGR. VINCENT MILLER

**AVALON ENGINEERING, INC.**  
 2503 DEL PRADO BLVD, SUITE 200  
 CAPE CORAL, FLORIDA 33904  
 FBPE#3128 (239) 573-2077

**LEE COUNTY DEPARTMENT OF TRANSPORTATION**  
 (239) 533-8580

**THREE OAKS PARKWAY EXTENSION**  
 ALICO ROAD TO STA 288+36.50 (PHASE I END)  
 LEE COUNTY, FLORIDA

**MILL-OVERLAY AND PAVEMENT PLANS**

**SHEET**  
 8 of 13



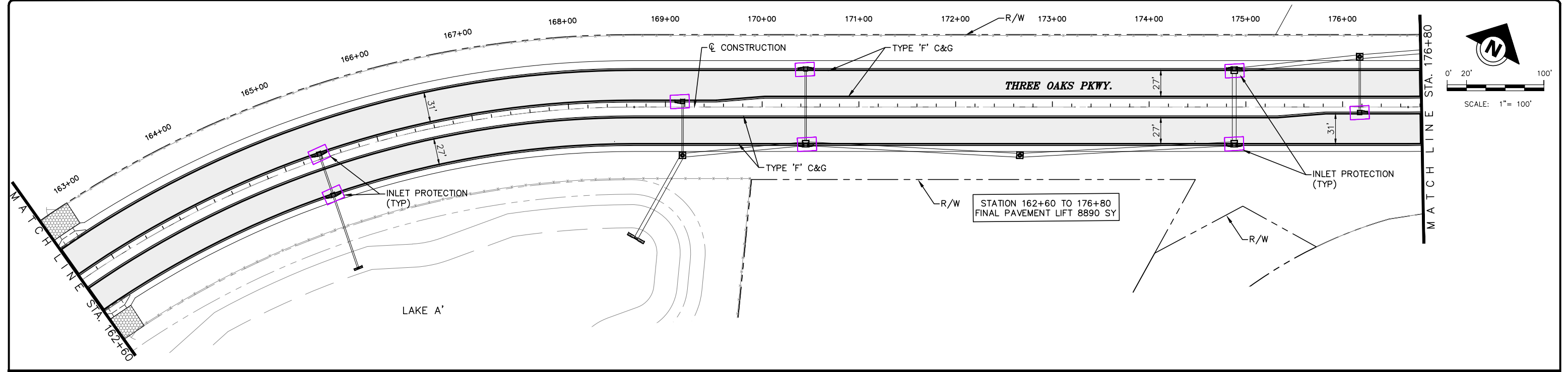

P:\CAD\2017\17-372\8-OAKS-MILL-OVERLAY\PILOT\17-372\_MILL-OVERLAY.dwg, 9 MILL-OVERLAY, 10/4/2024 6:51:09 AM, Avalon Engineering, Inc.

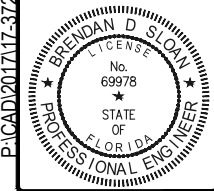

THE OFFICIAL RECORD OF THIS SHEET IS THE ELECTRONIC FILE DIGITALLY SIGNED AND SEALED UNDER RULE 61G15-23.004FAC, ON 10/4/2024

PRINTED COPIES OF THIS DOCUMENT ARE NOT CONSIDERED SIGNED AND SEALED AND THE SIGNATURE MUST BE VERIFIED ON ANY ELECTRONIC COPIES

DATE	BY	REVISION DESCRIPTION

BID SET PLANS

AVALON PROJECT: 17-372  
 PROJ. MGR. BRENDAN D. SLOAN, P.E.  
 LEE COUNTY DOT PROJECT: CN160642/ANB  
 LDOT PROJ. MGR. VINCENT MILLER

**AVALON ENGINEERING, INC.**  
 2503 DEL PRADO BLVD, SUITE 200  
 CAPE CORAL, FLORIDA 33904  
 FBPE#3128 (239) 573-2077

**LEE COUNTY DEPARTMENT OF TRANSPORTATION**  
 (239) 533-8580

**THREE OAKS PARKWAY EXTENSION**  
 ALICO ROAD TO STA 288+36.50 (PHASE I END)  
 LEE COUNTY, FLORIDA

MILL-OVERLAY AND PAVEMENT PLANS

SHEET 9 of 13

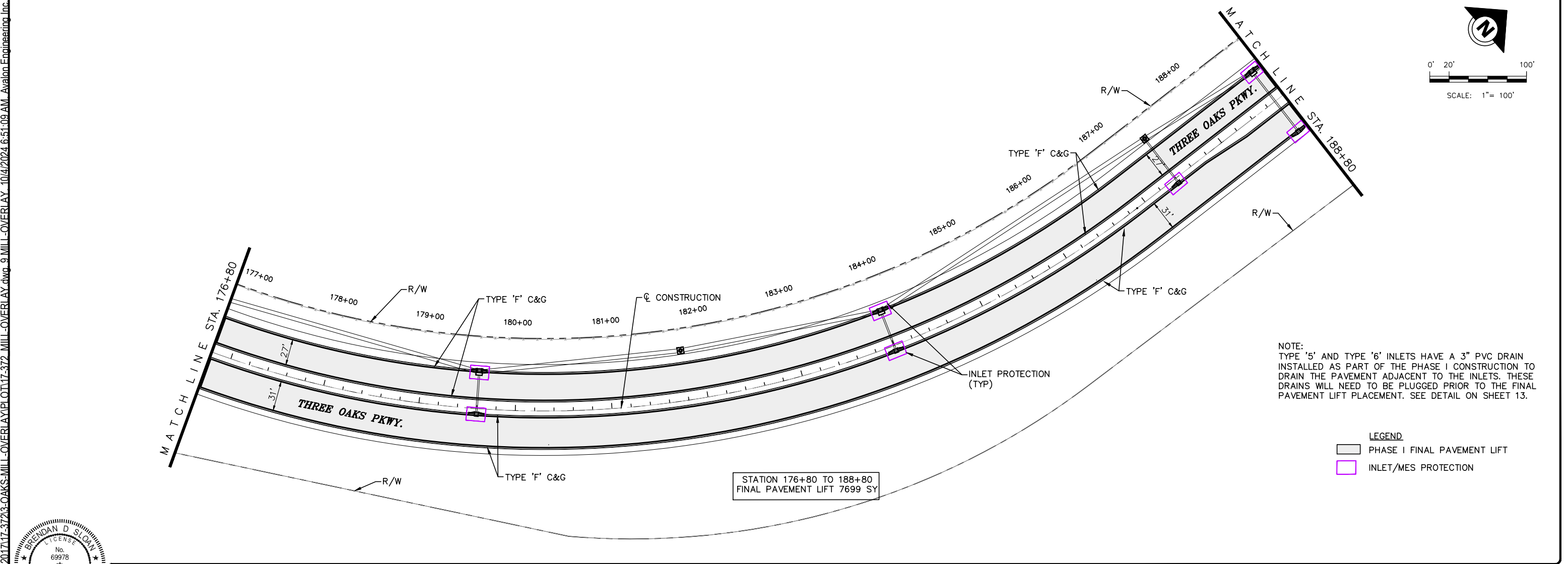

NOTE:  
 TYPE '5' AND TYPE '6' INLETS HAVE A 3" PVC DRAIN INSTALLED AS PART OF THE PHASE I CONSTRUCTION TO DRAIN THE PAVEMENT ADJACENT TO THE INLETS. THESE DRAINS WILL NEED TO BE PLUGGED PRIOR TO THE FINAL PAVEMENT LIFT PLACEMENT. SEE DETAIL ON SHEET 13.

**LEGEND**  
 [Grey Box] PHASE I FINAL PAVEMENT LIFT  
 [Purple Box] INLET/MES PROTECTION

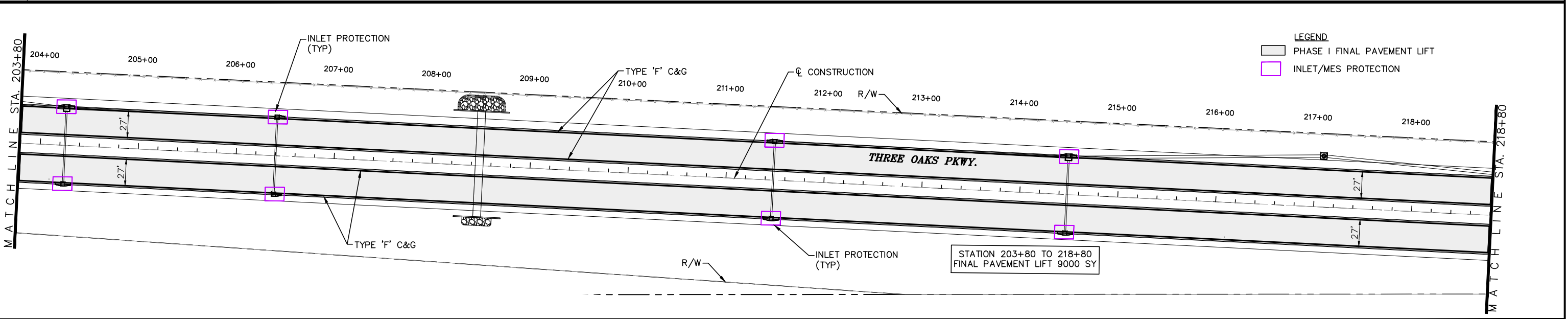
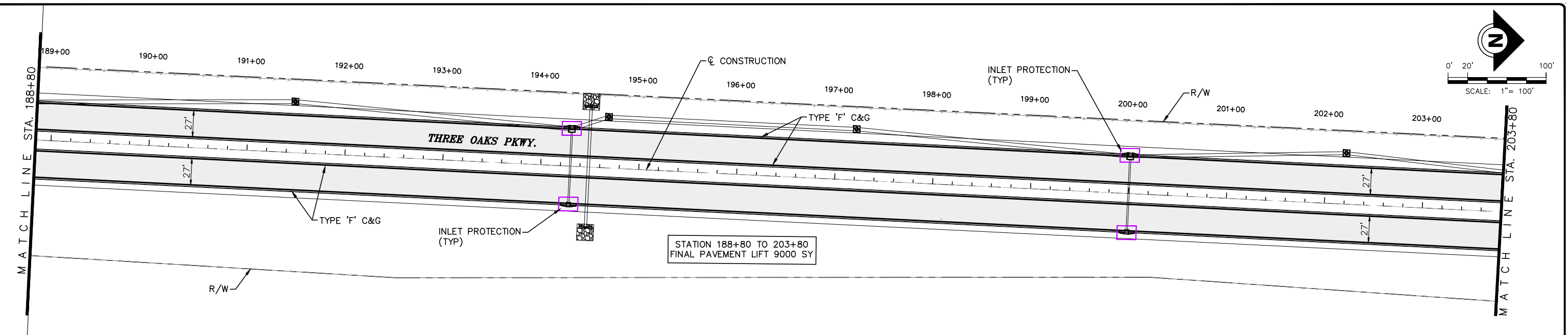
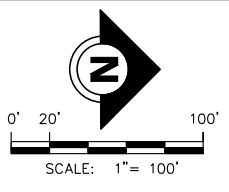

**LEGEND**  
 [Shaded Area] PHASE I FINAL PAVEMENT LIFT  
 [Purple Outline] INLET/MES PROTECTION

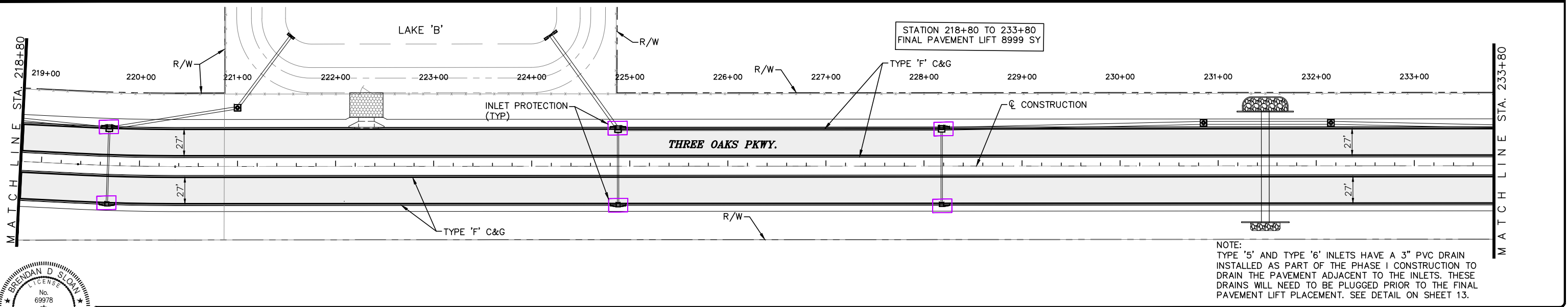

**NOTE:**  
 TYPE '5' AND TYPE '6' INLETS HAVE A 3" PVC DRAIN INSTALLED AS PART OF THE PHASE I CONSTRUCTION TO DRAIN THE PAVEMENT ADJACENT TO THE INLETS. THESE DRAINS WILL NEED TO BE PLUGGED PRIOR TO THE FINAL PAVEMENT LIFT PLACEMENT. SEE DETAIL ON SHEET 13.

P:\CAD\2017\17-372\9-OAKS-MILL-OVERLAY\PILOT\17-372\_MILL-OVERLAY.dwg, 10 MILL-OVERLAY, 10/4/2024 6:51:14 AM, Avalon Engineering, Inc.

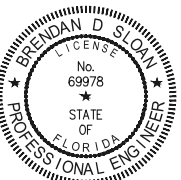

THE OFFICIAL RECORD OF THIS SHEET IS THE ELECTRONIC FILE DIGITALLY SIGNED AND SEALED UNDER RULE 61G15-23.004FAC, ON 10/4/2024

PRINTED COPIES OF THIS DOCUMENT ARE NOT CONSIDERED SIGNED AND SEALED AND THE SIGNATURE MUST BE VERIFIED ON ANY ELECTRONIC COPIES

DATE	BY	REVISION DESCRIPTION

**BID SET PLANS**

AVALON PROJECT: 17-372  
 PROJ. MGR. BRENDAN D. SLOAN, P.E.  
 LEE COUNTY DOT PROJECT: CN160642/ANB  
 LDOT PROJ. MGR. VINCENT MILLER

**AVALON ENGINEERING, INC.**  
 2503 DEL PRADO BLVD, SUITE 200  
 CAPE CORAL, FLORIDA 33904  
 FBPE#3128 (239) 573-2077

**LEE COUNTY DEPARTMENT OF TRANSPORTATION**  
 (239) 533-8580

**THREE OAKS PARKWAY EXTENSION**  
 ALICO ROAD TO STA 288+36.50 (PHASE I END)  
 LEE COUNTY, FLORIDA

**MILL-OVERLAY AND PAVEMENT PLANS**

SHEET 10 of 13

P:\CAD\2017\17-372\8-OAKS-MILL-OVERLAY\PILOT\17-372\_MILL-OVERLAY.dwg, 11 MILL-OVERLAY, 10/4/2024 6:51:24 AM, Avalon Engineering, Inc.

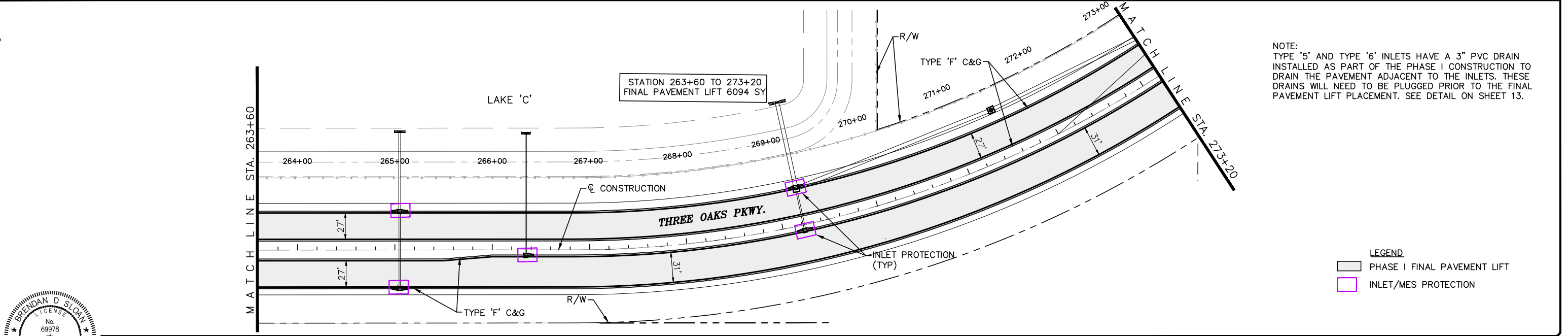
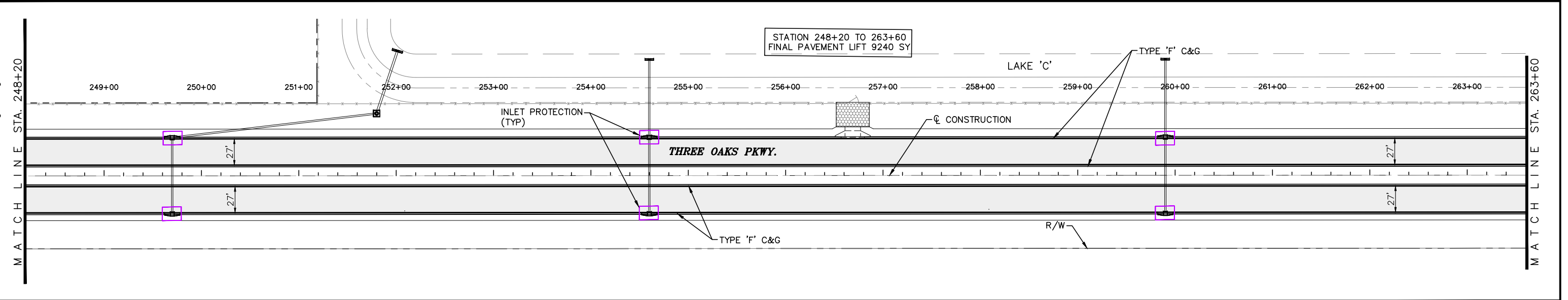
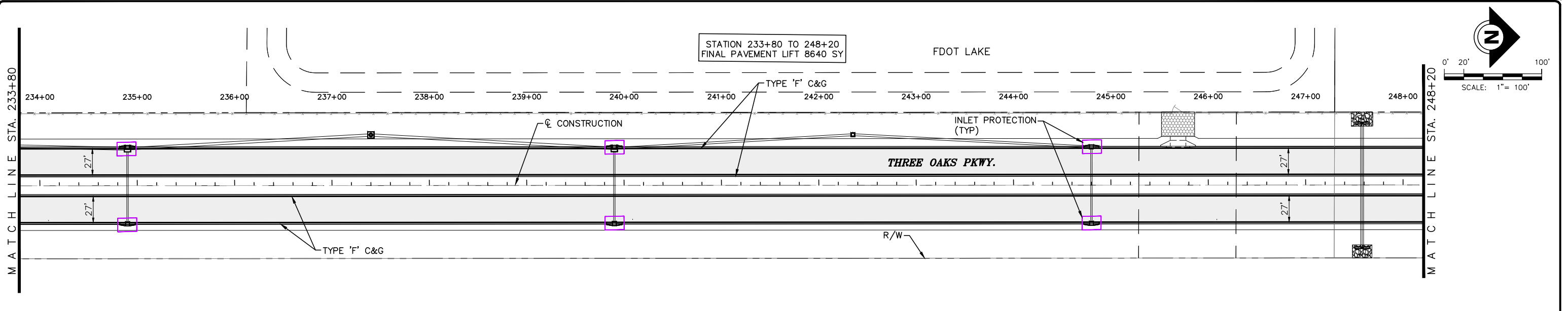

NOTE:  
 TYPE '5' AND TYPE '6' INLETS HAVE A 3" PVC DRAIN  
 INSTALLED AS PART OF THE PHASE I CONSTRUCTION TO  
 DRAIN THE PAVEMENT ADJACENT TO THE INLETS. THESE  
 DRAINS WILL NEED TO BE PLUGGED PRIOR TO THE FINAL  
 PAVEMENT LIFT PLACEMENT. SEE DETAIL ON SHEET 13.

LEGEND  
 [Grey Box] PHASE I FINAL PAVEMENT LIFT  
 [Purple Box] INLET/MES PROTECTION

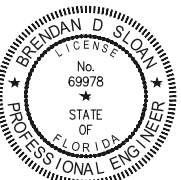

THE OFFICIAL RECORD OF THIS SHEET IS THE ELECTRONIC FILE DIGITALLY SIGNED AND SEALED UNDER RULE 61G15-23.004FAC, ON 10/4/2024

PRINTED COPIES OF THIS DOCUMENT ARE NOT CONSIDERED SIGNED AND SEALED AND THE SIGNATURE MUST BE VERIFIED ON ANY ELECTRONIC COPIES

DATE	BY	REVISION DESCRIPTION

BID SET PLANS

AVALON PROJECT: 17-372  
 PROJ. MGR. BRENDAN D. SLOAN, P.E.  
 LEE COUNTY DOT PROJECT: CN160642/ANB  
 LDOT PROJ. MGR. VINCENT MILLER

AVALON ENGINEERING, INC.  
 2503 DEL PRADO BLVD, SUITE 200  
 CAPE CORAL, FLORIDA 33904  
 FBPE#3128 (239) 573-2077

LEE COUNTY DEPARTMENT OF TRANSPORTATION  
 (239) 533-8580

THREE OAKS PARKWAY EXTENSION  
 ALICO ROAD TO STA 288+36.50 (PHASE I END)  
 LEE COUNTY, FLORIDA

MILL-OVERLAY AND PAVEMENT PLANS

SHEET 11 of 13

P:\CAD\2017\17-372\8-OAKS-MILL-OVERLAY\PILOT\17-372\_MILL-OVERLAY.dwg - 12 MILL-OVERLAY - 10/4/2024 6:51:34 AM Avalon Engineering, Inc.

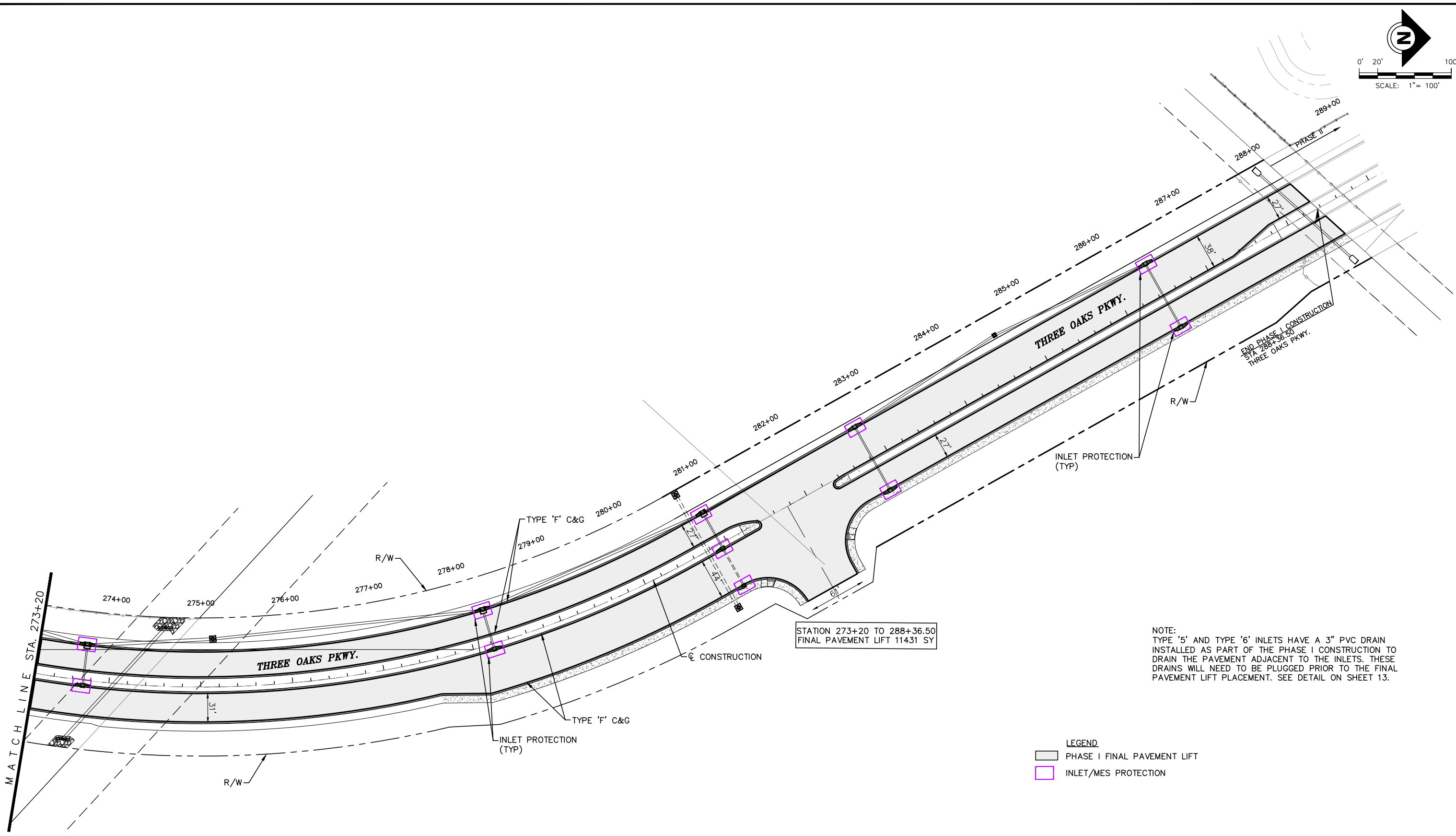
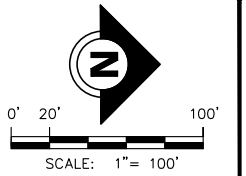

STATION 273+20 TO 288+36.50  
FINAL PAVEMENT LIFT 11431 SY

NOTE:  
TYPE '5' AND TYPE '6' INLETS HAVE A 3" PVC DRAIN  
INSTALLED AS PART OF THE PHASE I CONSTRUCTION TO  
DRAIN THE PAVEMENT ADJACENT TO THE INLETS. THESE  
DRAINS WILL NEED TO BE PLUGGED PRIOR TO THE FINAL  
PAVEMENT LIFT PLACEMENT. SEE DETAIL ON SHEET 13.

- LEGEND**
- PHASE I FINAL PAVEMENT LIFT
  - INLET/MES PROTECTION

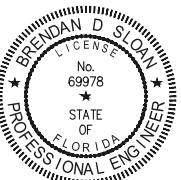

THE OFFICIAL RECORD OF THIS SHEET IS THE ELECTRONIC FILE DIGITALLY SIGNED AND SEALED UNDER RULE 61G15-23.004FAC, ON 10/4/2024

PRINTED COPIES OF THIS DOCUMENT ARE NOT CONSIDERED SIGNED AND SEALED AND THE SIGNATURE MUST BE VERIFIED ON ANY ELECTRONIC COPIES

DATE	BY	REVISION DESCRIPTION

*BID SET PLANS*

AVALON PROJECT: 17-372  
PROJ. MGR. BRENDAN D. SLOAN, P.E.  
LEE COUNTY DOT PROJECT: CN160642/ANB  
LOOT PROJ. MGR. VINCENT MILLER

**AVALON ENGINEERING, INC.**  
2503 DEL PRADO BLVD, SUITE 200  
CAPE CORAL, FLORIDA 33904  
FBPE #3128 (239) 573-2077

**LEE COUNTY DEPARTMENT OF TRANSPORTATION**  
(239) 533-8580

**THREE OAKS PARKWAY EXTENSION**  
ALICO ROAD TO STA 288+36.50 (PHASE I END)  
LEE COUNTY, FLORIDA

**MILL-OVERLAY AND PAVEMENT PLANS**

SHEET  
12 of 13

P:\CAD\2017\17-372\3-OAKS-MILL-OVERLAY\PILOTMO-EROSION-DTL.dwg 13 EROSION CONTROL 10/4/2024 6:51:41 AM Avalon Engineering Inc.

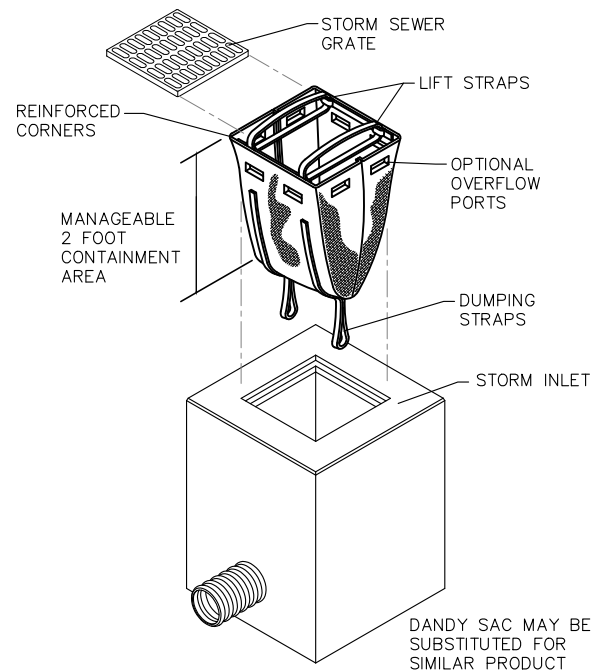

**DANDY SACK INLET PROTECTION**  
N.T.S.

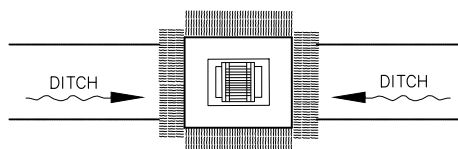
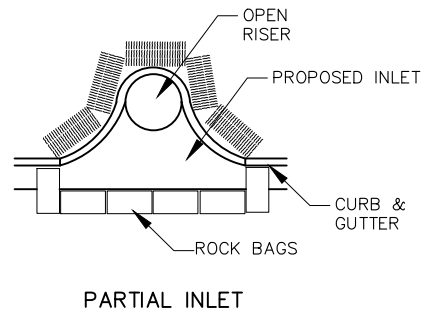
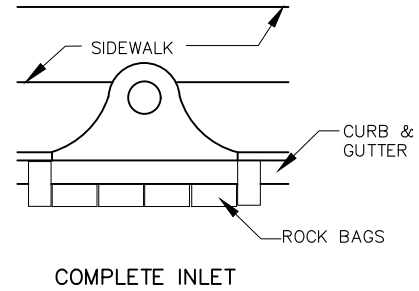

**PROTECTION AROUND INLETS**  
N.T.S.

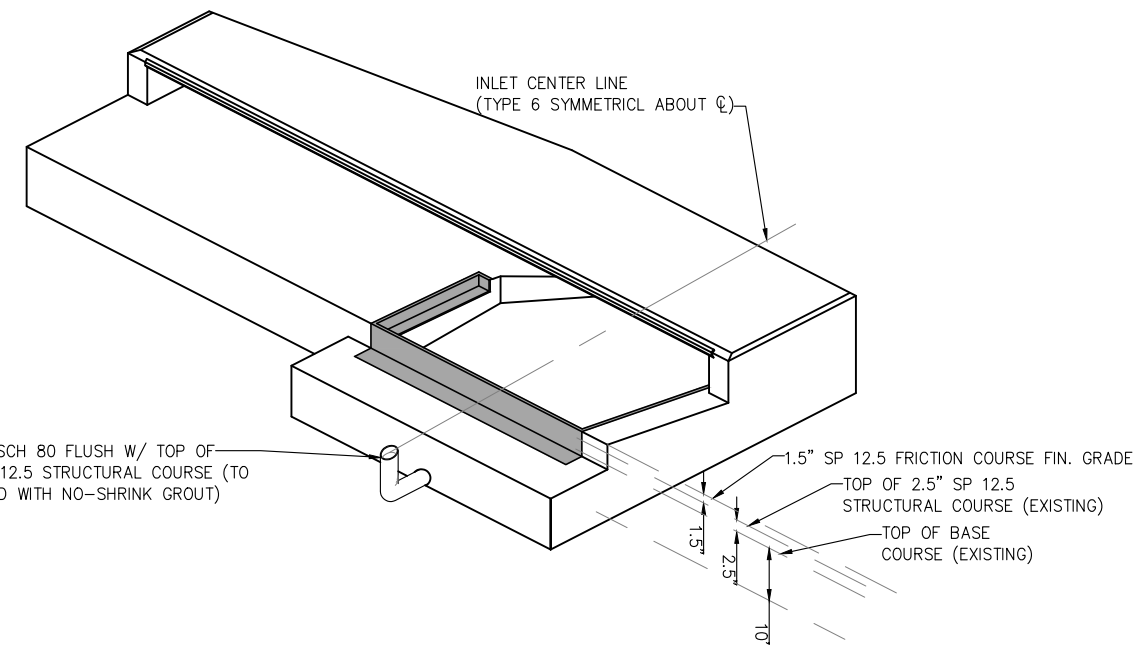

**THREE OAKS PHASE 1  
MOD FDOT TYPE 5 & 6 CURB INLET TOP**  
N.T.S.

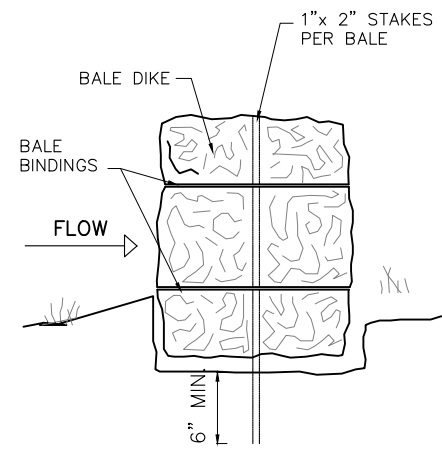

**BEDDING DETAIL**

NOTE: RESTORE ALL INLETS IN R/W WITH SOD ON ALL SIDES (10' TYP.)

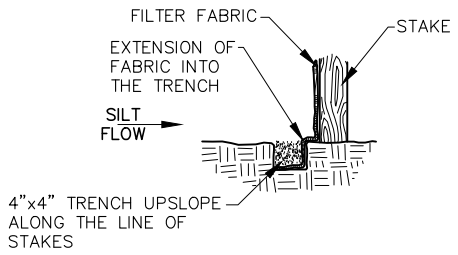

**CONSTRUCTION OF A  
SILT FENCE**

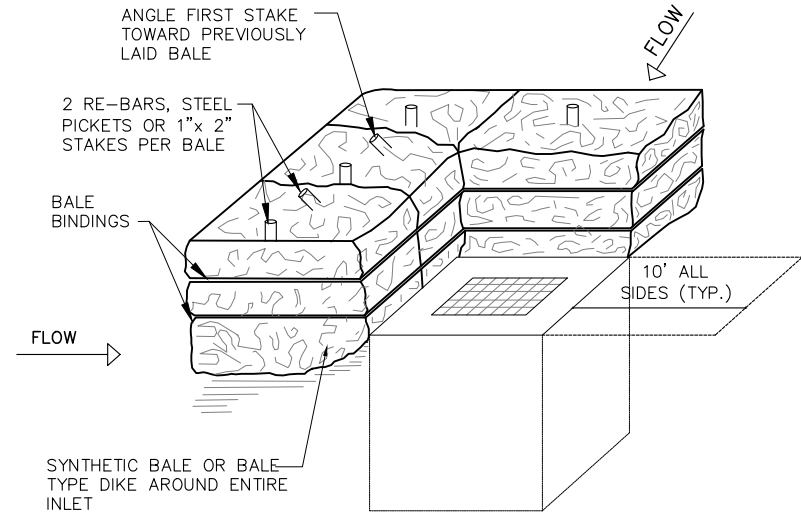

**ANCHORING DETAIL SYNTHETIC BALE  
PLACEMENT**

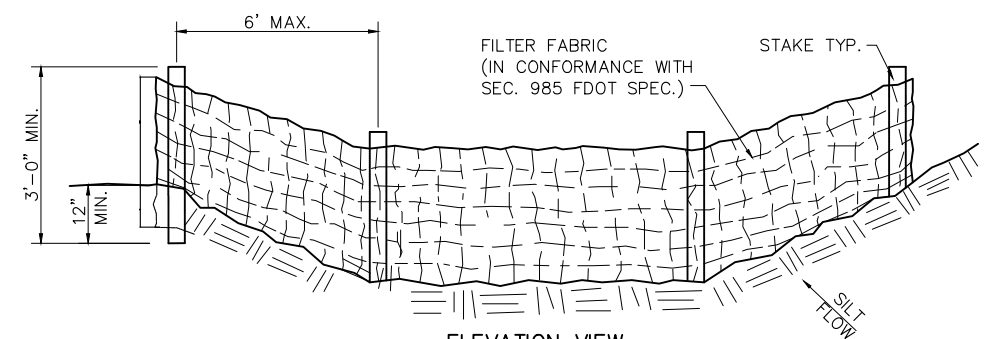

**ELEVATION VIEW  
SILT SCREEN PLACEMENT**

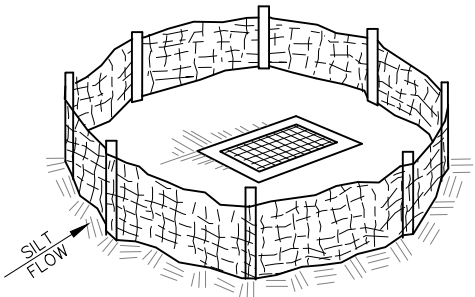

**SILT FENCE PROTECTION  
AROUND DITCH BOTTOM INLETS**

1. PRIOR TO CONSTRUCTION, FILTER FABRIC, SILT SCREENS, SYNTHETIC BALES OR OTHER APPROVED EROSION CONTROL DEVICES SHALL BE INSTALLED ACROSS THE SWALE AT THE LOWEST DISTURBED POINT TO PREVENT EROSION MATERIAL FROM LEAVING THE CONSTRUCTION AREA, INCLUDING ANY VACANT AREAS USED FOR INGRESS AND EGRESS.
2. ALL AFFECTED STORMWATER PIPES, INLETS AND CATCH BASINS SHALL BE PROTECTED BY EROSION CONTROL DEVICES TO PREVENT CONSTRUCTION RELATED EROSION MATERIAL FROM ENTERING THE STORMWATER SYSTEM.
3. THE EROSION CONTROL DEVICES SHALL BE INSTALLED PRIOR TO ANY CONSTRUCTION PROCESS AND SHALL REMAIN IN PLACE UNTIL STABILIZED WITH SOD AND THE VACANT AREAS ARE SEEDED AND MULCHED.

**EROSION CONTROL**  
N.T.S.



THE OFFICIAL RECORD OF THIS SHEET IS THE ELECTRONIC FILE DIGITALLY SIGNED AND SEALED UNDER RULE 61G15-23.004FAC, ON 10/4/2024

DATE	BY	REVISION DESCRIPTION

**BID SET PLANS**

AVALON PROJECT: 17-372  
PROJ. MGR. BRENDAN D. SLOAN, P.E.  
LEE COUNTY DOT PROJECT: CN160642/ANB  
LDOT PROJ. MGR. VINCENT MILLER

**AVALON ENGINEERING, INC.**  
2503 DEL PRADO BLVD, SUITE 200  
CAPE CORAL, FLORIDA 33904  
FBPE#3128 (239) 573-2077

**LEE COUNTY DEPARTMENT OF TRANSPORTATION**  
(239) 533-8580

**THREE OAKS PARKWAY EXTENSION**  
ALICO ROAD TO STA 288+36.50 (PHASE I END)  
LEE COUNTY, FLORIDA

**EROSION CONTROL  
DETAILS**

SHEET  
13 of 13